

expire 9/2/15



PERMIT NO.

24402 A

CITY OF NEW BEDFORD
SEWER AND/OR STORM DRAIN PERMIT

DATE 9/2/14

This certifies that permission is granted to

Sean Adams 22 Pine Ridge St 738 471 7523
Property Owner Address Tel.

To connect a sewer and/or storm drain located at 22 Pine Ridge St (connecting to)

Assessor's Plot 121 Lot 72, to the sewer and/or storm drain in Pine Ridge St Street

To be laid in accordance with the conditions in this application and the City of New Bedford ordinances.

TYPE OF USE: RESIDENTIAL COMMERCIAL INDUSTRIAL FLOW G.P.D.

If applicant other than actual property owner, attach Letter of Authorization from Property Owner.

Name Tel.

Mailing Address

The Bonded Contractor/Drain Layer authorized to perform this work is:

Name JLC Construction Address 415 Lake Rd, Tr. 2 Tel. 774 263 8197

Type of Pipe Required: PVC SDR 35

PERMIT EXPIRES ONE YEAR AFTER DATE OF ISSUE

- Requires separate connections for sewage and storm drain where applicable. Storm water cannot be discharged to a sanitary sewer.
- All work must be inspected and approved by a D.P.I. inspector before backfilling.
- If this connection is to be part of a private service shared jointly with other building owners, attach copy of Recorded Joint Maintenance Agreement.
- Permits can be issued to Industrial and/or Commercial Applicants only upon receipt and approval by the Commissioner of Public Infrastructure of required plans and supplemental information.
- In addition, a City-issued Industrial User Discharge Permit and/or a Sewer Extension/Connection Permit issued by the Commonwealth of Massachusetts D.E.P. shall be required by the City for Industrial Discharge into the sewer system.

Industrial User Discharge Permit No. Date

Comm. Mass. Sewer Conn./Ext. Permit No. 14-09 Date 9/2/14

A Filing and Inspection Fee of \$420, plus an Entrance Fee of \$550, where applicable, must accompany this application.

Bank# Bank Five Check# (sewer) (storm) Date 9/2/14 Receipt# 22702 22963
Total \$1000.00

Other requirements: Home call sheet 24hr for inspection

Connection made to Sewer Part of jointly-shared private line YES NO
Storm Drain

Applicant agrees to abide by the above terms, as well as all pertinent ordinances of the City of New Bedford, and such other special rules as the Commissioner of Public Infrastructure and/or City Engineer may deem necessary

David Decker 9/2/2014
City Engineer

Sean Adams
Signature of Property Owner or Representative

INSPECTOR'S REPORT

INSPECTED BY: _____
DATE: _____
COMMENTS: _____

APPROVED

SEE WHITE SHEET
SIGNATURE

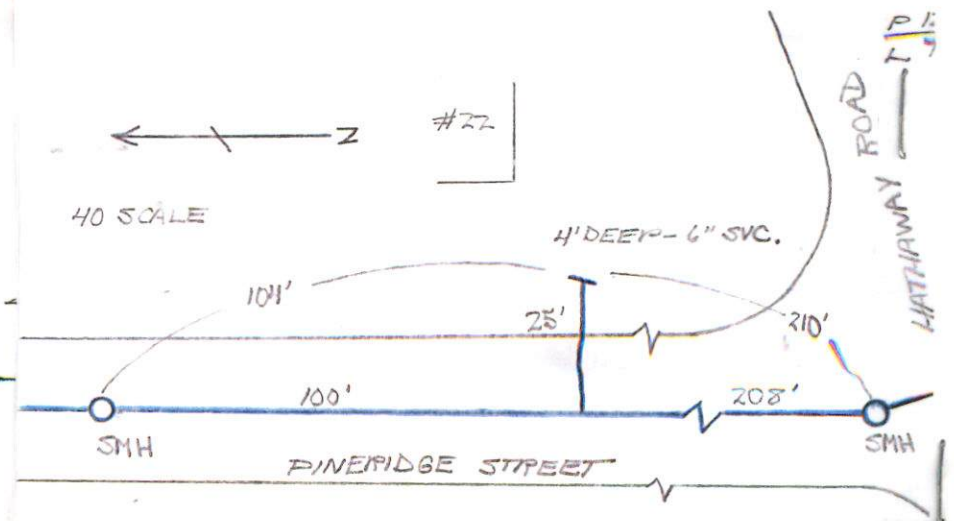



Inspector 9/30/14 Tuesday after lunch before

DATE 9/2/14

PERMIT NO.
24402A

CITY OF NEW BEDFORD
SEWER AND/OR STORM DRAIN PERMIT

This certifies that permission is granted to

Sean Adams 22 PINE RIDGE ST. 508 471 7523
Property Owner Address Tel.

To connect a sewer and/or storm drain located at 22 PINE RIDGE ST (connecting to stubs)

Assessor's Plot 121 Lot 72, to the sewer and/or storm drain in Pine Ridge St. Street

To be laid in accordance with the conditions in this application and the City of New Bedford ordinances.

TYPE OF USE: RESIDENTIAL COMMERCIAL INDUSTRIAL FLOW G.P.D.

If applicant other than actual property owner, attach Letter of Authorization from Property Owner.

Name: N/A Tel.

Mailing Address: N/A

The Bonded Contractor/Drain Layer authorized to perform this work is:

Name JLC Construction Address 415 Lake Rd, W. RI Tel. 774 2638197

Type of Pipe Required: DUC SDR 35

PERMIT EXPIRES ONE YEAR AFTER DATE OF ISSUE

- Requires separate connections for sewage and storm drain where applicable. Storm water cannot be discharged to a sanitary sewer.
 - All work must be inspected and approved by a D.P.I. inspector before backfilling.
 - If this connection is to be part of a private service shared jointly with other building owners, attach copy of Recorded Joint Maintenance Agreement.
 - Permits can be issued to Industrial and/or Commercial Applicants only upon receipt and approval by the Commissioner of Public Infrastructure of required plans and supplemental information.
 - In addition, a City-issued Industrial User Discharge Permit and/or a Sewer Extension/Connection Permit issued by the Commonwealth of Massachusetts D.E.P. shall be required by the City for Industrial Discharge into the sewer system.
- Industrial User Discharge Permit No. Date

Comm. Mass. Sewer Conn./Ext. Permit No. 14-09 Date 9/2/14

A Filing and Inspection Fee of \$450, plus an Entrance Fee of \$550, where applicable, must accompany this application.

Bank# BANK FIVE Check#(sewer) + (stubs) Date 9/2/14 Receipt# 22902 + 2296

Other requirements: here call shed 24hr for inspection

Connection made to Sewer Part of jointly-shared private line YES NO
Storm Drain

Applicant agrees to abide by the above terms, as well as all pertinent ordinances of the City of New Bedford, and such other special rules as the Commissioner of Public Infrastructure and/or City Engineer may deem necessary

City Engineer 9/2/2014

Signature of Property Owner or Representative

INSPECTOR'S REPORT

INSPECTED BY: DATE: 10/2/14
COMMENTS:

APPROVED DISAPPROVED

SIGNATURE

Insp. ENG/12 /DPI

SKETCH PLAN

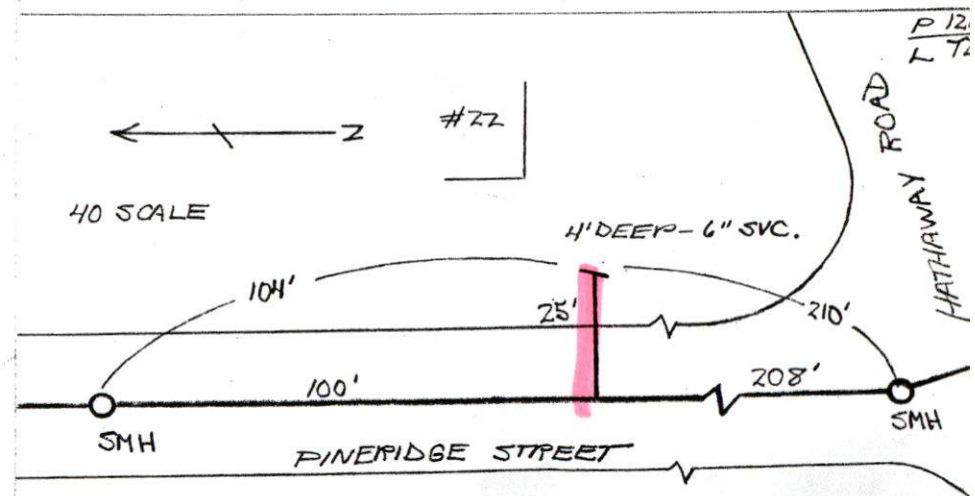

No. 14-09

FEE \$60.00

COMMONWEALTH OF MASSACHUSETTS

Board of Health, NEW BEDFORD, MA.

DISPOSAL SYSTEM CONSTRUCTION PERMIT

Permission is hereby granted to: Construct() Repair() Upgrade(☒) Abandon(☒) an individual sewage disposal system
at 22 Pine Ridge Street as described in the application for

Disposal System Construction Permit No. 14-09, dated 9/2/14.

Provided: Construction shall be completed within three years of the date of this permit. All local conditions must be met.

Form 1255 Rev. 5/96 A.M. Sulkin Co. Boston, MA

Date 9/2/14 Board of Health [Signature]

WOW-14-24

EXPIRES 7/2/15



PERMIT NO.
24402A

CITY OF NEW BEDFORD
SEWER AND/OR STORM DRAIN PERMIT

DATE 9/2/14

This certifies that permission is granted to

Sean Adams 22 Pine Ridge St 508 471 7523
Property Owner Address Tel.

To connect a sewer and/or storm drain located at 22 PINE RIDGE ST (connecting to st 3)

Assessor's Plot 121 Lot 72, to the sewer and/or storm drain in Pine Ridge St Street

To be laid in accordance with the conditions in this application and the City of New Bedford ordinances.

TYPE OF USE: RESIDENTIAL COMMERCIAL INDUSTRIAL FLOW G.P.D.

If applicant other than actual property owner, attach Letter of Authorization from Property Owner.

Name N/A Tel.

Mailing Address N/A

The Bonded Contractor/Drain Layer authorized to perform this work is:

Name JLC Construction Address 415 Lake Rd, Tiv, RI Tel. 774 263 8197

Type of Pipe Required: PVC SDR 35

PERMIT EXPIRES ONE YEAR AFTER DATE OF ISSUE

- Requires separate connections for sewage and storm drain where applicable. Storm water cannot be discharged to a sanitary sewer.
- All work must be inspected and approved by a D.P.I. inspector before backfilling.
- If this connection is to be part of a private service shared jointly with other building owners, attach copy of Recorded Joint Maintenance Agreement.
- Permits can be issued to Industrial and/or Commercial Applicants only upon receipt and approval by the Commissioner of Public Infrastructure of required plans and supplemental information.
- In addition, a City-issued Industrial User Discharge Permit and/or a Sewer Extension/Connection Permit issued by the Commonwealth of Massachusetts D.E.P. shall be required by the City for Industrial Discharge into the sewer system.

Industrial User Discharge Permit No. Date

Comm. Mass. Sewer Conn./Ext. Permit No. 14-09 Date 9/2/14

A Filing and Inspection Fee of \$452 Sewer 90 plus an Entrance Fee of \$550 Stms 91 (28 x 22ft) where applicable, must accompany this application.

Bank# BANK FIVE Check# (Sewer) + (Stms) Date 9/2/14 Receipt# 22962 (Sewer) + 22963 (Stms) TOTAL \$1000.00

Other requirements: please call ahead 24hr for inspection

Connection made to Sewer Part of jointly-shared private line YES NO
Storm Drain

Applicant agrees to abide by the above terms, as well as all pertinent ordinances of the City of New Bedford, and such other special rules as the Commissioner of Public Infrastructure and/or City Engineer may deem necessary

City Engineer 9/2/2014

Signature of Property Owner or Representative

INSPECTOR'S REPORT

INSPECTED BY: _____
DATE: _____
COMMENTS: _____

APPROVED DISAPPROVED

SIGNATURE

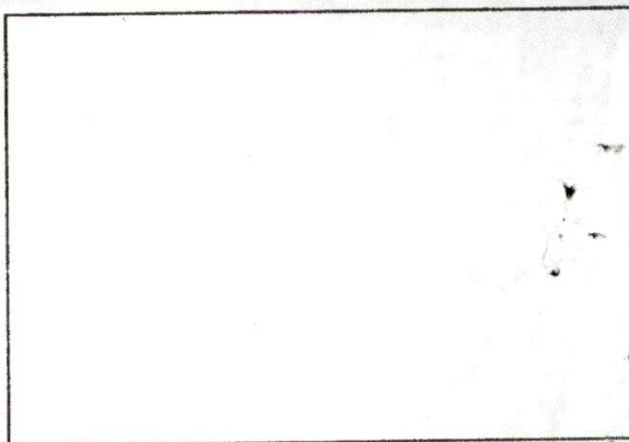

SKETCH PLAN

BK 11149 PG 4
08/15/14 02:11 DOC. 15686
Bristol Co. S.D.

QUITCLAIM DEED

I, Timothy George Greene of Acushnet, Bristol County, Massachusetts

for consideration paid, and in full consideration of One Hundred Seventy Five Thousand One Hundred (\$175,100.00) -----Dollars

grant to Sean M. Adams, a single man, of 22 Pineridge Street, New Bedford, MA 02740

With Quitclaim Covenants

The land in said New Bedford, Bristol County, Commonwealth of Massachusetts, bounded and described as follows:

BEGINNING at the southwest corner of the land to be conveyed in the easterly line of Pineridge Street;

Thence EASTERLY in line of Lot 71 on a plan hereinafter mentioned and land formerly of the grantors 100 feet to other land now or formerly of Edward E. Casey, Rebecca G. Casey, Eliot C. Casey and Doris G. Casey;

Thence NORTHERLY 100 feet in line of last named land 100 feet to Lot 73 on said plan and other land now or formerly of four aforementioned Caseys;

Thence WESTERLY in line of last mentioned land 100 feet to said Pineridge Street;

Thence SOUTHERLY by said Pineridge Street 100 feet to the point of beginning.

Property Address:
22 Pineridge Street
New Bedford, MA

MICHAEL T. FRIAR
ATTORNEY AT LAW
342 UNION STREET
NEW BEDFORD, MASS.

REG OF DEEDS
REG #07
BRISTOL S

08/15/14 2:15PM
000000 #0328

FEE \$800.28

CASH \$800.28

CONTAINING 10,000 square feet more or less and BEING Lot 72 on "PLAN OF LAND IN NEW BEDFORD, MASS., BELONGING TO EDWARD E. AND REBECCA G. CASEY L.L. SEPT. 20, 1960 SCALE 1 IN. = 60 FEET., ABEL E. VALENTE, CIVIL ENGINEER.

For Grantor's title see deed dated December 2, 1998, recorded with the Bristol County S.D. Registry of Deeds in Book 4272, Page 26.

Witness my hand and seal this 15th day of August, 2014.

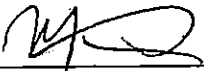

Witness



Timothy George Greene

COMMONWEALTH OF MASSACHUSETTS

BRISTOL, SS.,

On this 15th day of August, 2014, before me, the undersigned notary public, personally appeared Timothy George Greene (name of document signer), proved to me through satisfactory evidence of identification, which was a valid Driver's License, or _____ (source of identification) to be the person whose name is signed on the preceding or attached document, and acknowledged to me that he signed it voluntarily for its stated purposes.



Michael T. Friar, Notary Public
My Commission Expires 3-28-2019

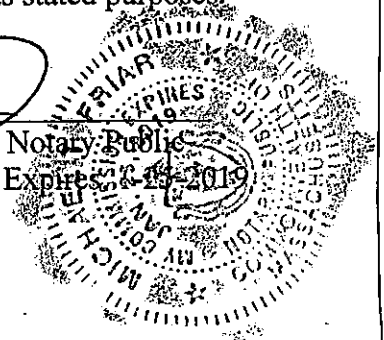

MICHAEL T. FRIAR
ATTORNEY AT LAW
342 UNION STREET
NEW BEDFORD, MASS.

Property Address:
22 Pineridge Street
New Bedford, MA

No. 14-09

FEE \$160.00

COMMONWEALTH OF MASSACHUSETTS

Board of Health, NEW BEDFORD, MA.

DISPOSAL SYSTEM CONSTRUCTION PERMIT

Permission is hereby granted to: Construct () Repair () Upgrade ☒ Abandon ☒ an individual sewage disposal system
at 22 Pine Ridge Street as described in the application for

Disposal System Construction Permit No. 14-09, dated 9/2/14.

Provided: Construction shall be completed within three years of the date of this permit. All local conditions must be met.

Form 1255 Rev. 5/96 A.M. Sulkin Co. Boston, MA

Date 9/2/14 Board of Health Arden J. Manning

Cheveli A. Torres

From: Sarah Porter
Sent: Friday, June 27, 2014 8:24 AM
To: Cheveli A. Torres
Subject: RE: ABANDON SPETIC SYSTEM

Hi Cheveli, this is good to go
Thanks
Sarah

From: Cheveli A. Torres
Sent: Thursday, June 26, 2014 1:45 PM
To: Sarah Porter
Subject: ABANDON SPETIC SYSTEM

Hello, Sarah

Abandonment of septic system, just received a call for 22 Pine Ridge St. Will that be
Good to go when they are ready?.

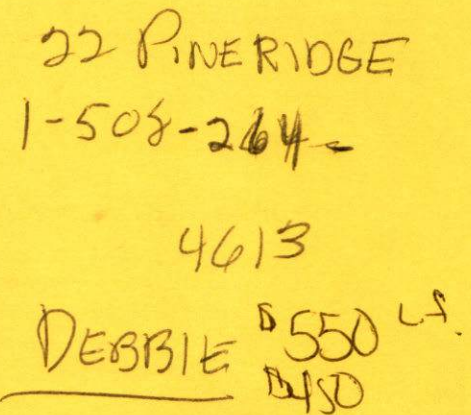

22 PINE RIDGE
1-508-264-
4613
DEBBIE 550 LA.
480

DISPLAY PERMIT IN A CONSPICUOUS PLACE ON THE PREMISES



Commonwealth of Massachusetts

City of New Bedford

133 William Street New Bedford, MA 02740

SEWER PERMIT



Date: **11/6/2014**

No. **WW-14-24**

Sewer Connection Fee: **\$450.00**

Pipe Size: **0.00**

Trench Length: **0.00**

Service Location: **22 PINERIDGE ST**

Owner Name: **GREENE TIMOTHY GEORGE**

Type of Occupancy: **Residential**

Type of Work: **Sewer - New Service Abandon
Septic**

Work Description: **22 PINE RIDGE**

P. 121 L.72

SEWER PERMIT #24402A

PERMIT EXPIRES 9/2/15

**CONNECTING TO STUB,
ABANADONMENT OF SEPITC PERMIT#14-09**

25FT TO STUB

No. of Units : **3** Required Design Daily Flow : **330.00** Provided Daily Flow : **330.00**

The undersigned petitions you to grant permission to ENTER INTO THE MAIN SEWER and, if such permission is granted, hereby agrees to the following:

1. To abide by the conditions and regulations imposed by the Commissioner of Public Works by statute or by ordinance now in force, or as amended from time to time.
2. That the connection of said sewer with the main sewer shall be inspected by an employee of the department of Public Works or by a designated agent of the Town before burial of said connection.
3. That the work shall at all times be under the direction and control of the Commissioner of Public Works or his authorized agent, and that any expense incurred by the Town shall be charged to the permittee, and said permittee agrees to reimburse the Town for said expense.

Installing Company Name: **DEMETRI COSTA**

License Type: **Hoisting Engineer**

Address: **415 LAKE RD**

City/Town/State: **TIVERTON**

RI

Call (781) 942-9077 For Inspection

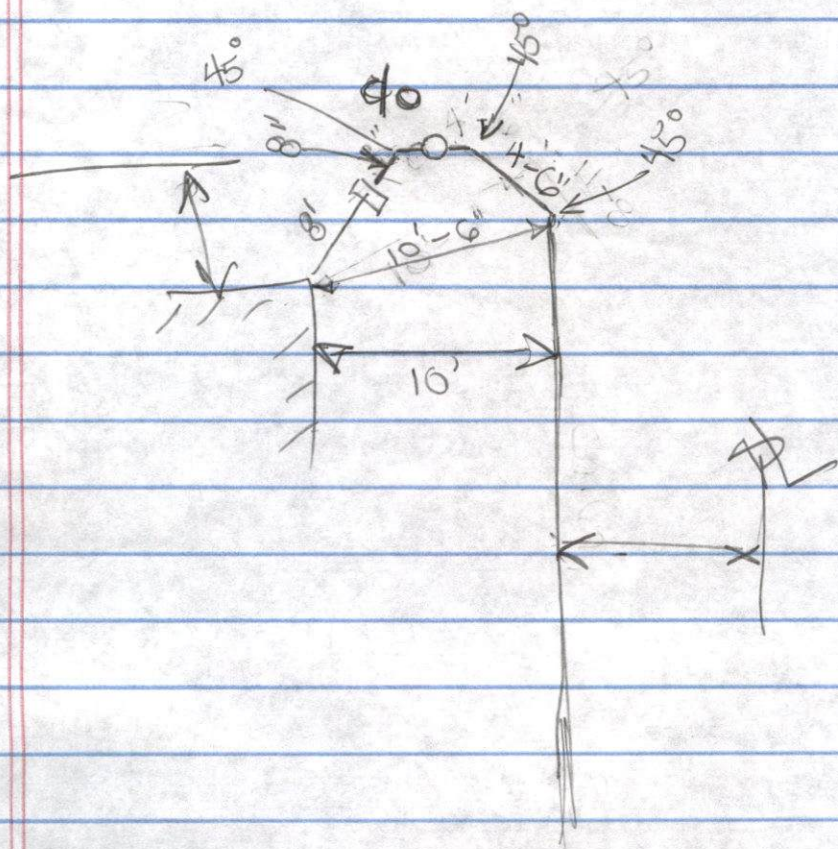

$$\begin{array}{r} 14 \\ \underline{3} \\ 42 \\ 11-6 \\ \underline{53-6} \end{array}$$