



PERMIT NO.

CITY OF NEW BEDFORD
SEWER AND/OR STORM DRAIN PERMITDATE 7/31/14

24395

This certifies that permission is granted to

Property Owner Joe Pechen Address 120 Winston Street Tel. (508) 801-1669To connect a sewer and/or storm drain located at Lucy St. outside 300
Assessor's Plot 18 Lot 46, to the sewer and/or storm drain in Lucy St. into 8th Street

To be laid in accordance with the conditions in this application and the City of New Bedford ordinances.

TYPE OF USE: RESIDENTIAL COMMERCIAL INDUSTRIAL FLOW _____ G.P.D.

If applicant other than actual property owner, attach Letter of Authorization from Property Owner.

Name _____ Tel. (508) 998-0230
Mailing Address Town of New Bedford

The Bonded Contractor/Drain Layer authorized to perform this work is:

Name R.J. Camessa Address _____ Tel. _____
Type of Pipe Required: PVC SDR 35

PERMIT EXPIRES ONE YEAR AFTER DATE OF ISSUE

- Requires separate connections for sewage and storm drain where applicable. Storm water cannot be discharged to a sanitary sewer.
 - All work must be inspected and approved by a D.P.I. inspector before backfilling.
 - If this connection is to be part of a private service shared jointly with other building owners, attach copy of Recorded Joint Maintenance Agreement.
 - Permits can be issued to Industrial and/or Commercial Applicants only upon receipt and approval by the Commissioner of Public Infrastructure of required plans and supplemental information.
 - In addition, a City-issued Industrial User Discharge Permit and/or a Sewer Extension/Connection Permit issued by the Commonwealth of Massachusetts D.E.P. shall be required by the City for Industrial Discharge into the sewer system.
- Industrial User Discharge Permit No. _____ Date _____

Comm. Mass. Sewer Conn./Ext. Permit No. _____ Date _____
A Filing and Inspection Fee of \$ 500, plus an Entrance Fee of \$ _____ where applicable, must accompany this application.Bank# St. Anne's Credit Union Check# 106 Date 7/29/14 Receipt# 21363Other requirements: Please town of New Bedford for any issues in
regards to your sewer & inspections.Sewer sewer extension 24396
Connection made to Part of jointly-shared private line YES NO
Storm Drain

Applicant agrees to abide by the above terms, as well as all pertinent ordinances of the City of New Bedford, and such other special rules as the Commissioner of Public Infrastructure and/or City Engineer may deem necessary

Manuel H. Silva
City Engineer
Supervising Civil EngineerJohn White
Signature of Property Owner or Representative

INSPECTOR'S REPORT

INSPECTED BY: _____
DATE: _____
COMMENTS: _____

APPROVED

DISAPPE

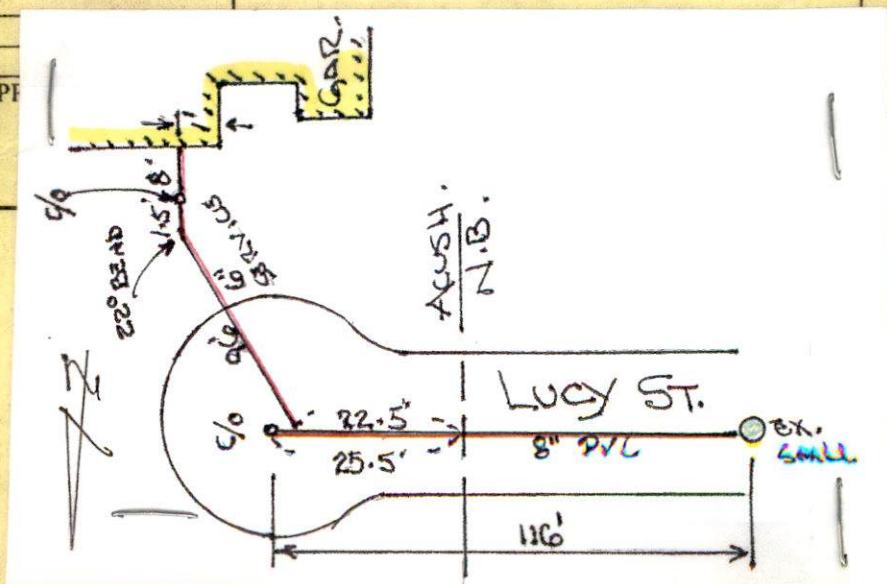
SEE WHITE SHEET
SIGNATURE

service

Inspector

Expiry 7/31/15



PERMIT NO.

CITY OF NEW BEDFORD
SEWER AND/OR STORM DRAIN PERMIT

DATE 7/31/14

24395

This certifies that permission is granted to

Joe Pacheco 130 Winston Street (SOS) 801-1669
Property Owner Address Acushnet, MA 02745 Tel.

To connect a sewer and/or storm drain located at Lucy St. Cut-de-Sac (Acushnet)
Assessor's Plot 18 Lot 46, to the sewer and/or storm drain in tying into 8 inch Street

To be laid in accordance with the conditions in this application and the City of New Bedford ordinances.
TYPE OF USE: RESIDENTIAL COMMERCIAL INDUSTRIAL FLOW G.P.D.

If applicant other than actual property owner, attach Letter of Authorization from Property Owner.
Name Town of Acushnet (SOS 998-0230)
Mailing Address John Westgate
The Bonded Contractor/Drain Layer authorized to perform this work is: Don Menead
Name RJ Carassa Address Tel.
Type of Pipe Required: PVC SDR 35

PERMIT EXPIRES ONE YEAR AFTER DATE OF ISSUE

- Requires separate connections for sewage and storm drain where applicable. Storm water cannot be discharged to a sanitary sewer.
 - All work must be inspected and approved by a D.P.I. inspector before backfilling.
 - If this connection is to be part of a private service shared jointly with other building owners, attach copy of Recorded Joint Maintenance Agreement.
 - Permits can be issued to Industrial and/or Commercial Applicants only upon receipt and approval by the Commissioner of Public Infrastructure of required plans and supplemental information.
 - In addition, a City-issued Industrial User Discharge Permit and/or a Sewer Extension/Connection Permit issued by the Commonwealth of Massachusetts D.E.P. shall be required by the City for Industrial Discharge into the sewer system.
- Industrial User Discharge Permit No. Date

Comm. Mass. Sewer Conn./Ext. Permit No. Date
A Filing and Inspection Fee of \$450.00, plus an Entrance Fee of \$ where applicable, must accompany this application.

Bank# St. Anne's Credit Union Check# 106 Date 7/29/14 Receipt# 21363

Other requirements: Please town of Acushnet for any issues in regards to your service & inspections.
Sewer sewer extension # 24396.
Connection made to Storm Drain Part of jointly-shared private line YES NO

Applicant agrees to abide by the above terms, as well as all pertinent ordinances of the City of New Bedford, and such other special rules as the Commissioner of Public Infrastructure and/or City Engineer may deem necessary

Manuel H. Silva City Engineer
Supervising Civil Engineer
John Westgate Water Sewer Super.
Signature of Property Owner or Representative

INSPECTOR'S REPORT

INSPECTED BY: RB
DATE: 9/15/14
COMMENTS:

APPROVED DISAPPROVED
Signature
SIGNATURE

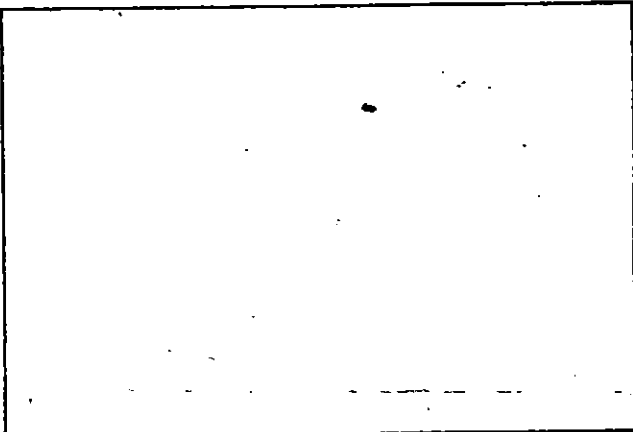

SKETCH PLAN



service

PERMIT NO.

24395

CITY OF NEW BEDFORD
SEWER AND/OR STORM DRAIN PERMIT

DATE 7/31/14

Expiry 7/31/15

This certifies that permission is granted to

Joe Pacheco 130 Winston Street (508) 801-1669
Property Owner Address Acushnet, MA 02745 Tel.To connect a sewer and/or storm drain located at Lucy St. Cut-de-Sac (Acushnet)
Assessor's Plot 18 Lot 46, to the sewer and/or storm drain in. lying into Birch; Street

To be laid in accordance with the conditions in this application and the City of New Bedford ordinances.

TYPE OF USE: RESIDENTIAL COMMERCIAL INDUSTRIAL FLOW G.P.D.

If applicant other than actual property owner, attach Letter of Authorization from Property Owner.

Name: Town of Acushnet Tel. (508) 998-0230
Mailing Address: John Westgate
The Bonded Contractor/Drain Layer authorized to perform this work is: Don MenardName: RJ Carassa Address: 35 Tel.
Type of Pipe Required: PVC SDR 35

PERMIT EXPIRES ONE YEAR AFTER DATE OF ISSUE

- Requires separate connections for sewage and storm drain where applicable. Storm water cannot be discharged to a sanitary sewer.
- All work must be inspected and approved by a D.P.I. inspector before backfilling.
- If this connection is to be part of a private service shared jointly with other building owners, attach copy of Recorded Joint Maintenance Agreement.
- Permits can be issued to Industrial and/or Commercial Applicants only upon receipt and approval by the Commissioner of Public Infrastructure of required plans and supplemental information.
- In addition, a City-issued Industrial User Discharge Permit and/or a Sewer Extension/Connection Permit issued by the Commonwealth of Massachusetts D.E.P. shall be required by the City for Industrial Discharge into the sewer system.

Industrial User Discharge Permit No. Date

Comm. Mass. Sewer Conn./Ext. Permit No. Date

A Filing and Inspection Fee of \$450.00 plus an Entrance Fee of \$ where applicable, must accompany this application.

Bank# St. Anne's Credit Union Check# 106 Date 7/29/14 Receipt# 21363

Other requirements: Please town of Acushnet for any issues in

regards to your service & inspections
Sewer Sewer extension # 24396

Connection made to Storm Drain Part of jointly-shared private line YES NO

Applicant agrees to abide by the above terms, as well as all pertinent ordinances of the City of New Bedford, and such other special rules as the Commissioner of Public Infrastructure and/or City Engineer may deem necessary

Manuel H. Silva
City Engineer
Supervising Civil EngineerJohn Westgate Water Sewer Super
Signature of Property Owner or Representative

INSPECTOR'S REPORT

INSPECTED BY: _____
DATE: _____
COMMENTS: _____

APPROVED

DISAPPROVED

SIGNATURE

SKETCH PLAN

City of New Bedford
Dept of Public Infrastructure
1105 Shawmut Ave
New Bedford, MA 02740
(508) 979-1550

001250-0002 Erin I. 07/31/2014 02:01PM

MISCELLANEOUS

Description: DPI SEWER
PERMITS AND EXTENSIONS
(DPISEW)

DPI SEWER PERMITS AND
EXTENSIONS

1 @ 450.00

DPI SEWER PERMITS AND
EXTENSIONS

Principal 450.00

Interest 0.00

TW05-101009- 450.00D

63906000-422185- 450.00C

Payment Id: 21363

450.00

Subtotal 450.00

Total 450.00

CHECK 450.00

Check Number 106

Change due -----
0.00

Paid by: JOSE PACHECO.

Thank you for your payment

CUSTOMER COPY
DUPLICATE RECEIPT

JOSE L. PACHECO
130 WINSTON STREET
ACUSHNET, MA 02745

106

53-8273/2113
11

7/29/14

Date

Pay to the
Order of

City of New Bedford
four hundred fifty dollars ⁰⁰/₁₀₀ Dollars

\$ 450.00



Security
Features
Details on
Back



For Water Service - Leaf St.

[Signature]

AP

⑆211382737⑆ 011 23010624 0106

GIEMEN T113-111-ACOSHA, RNDP
Bob Canessa

9/13/14

(12)

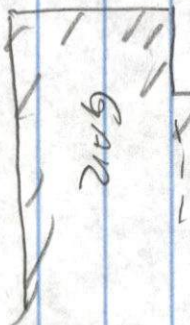
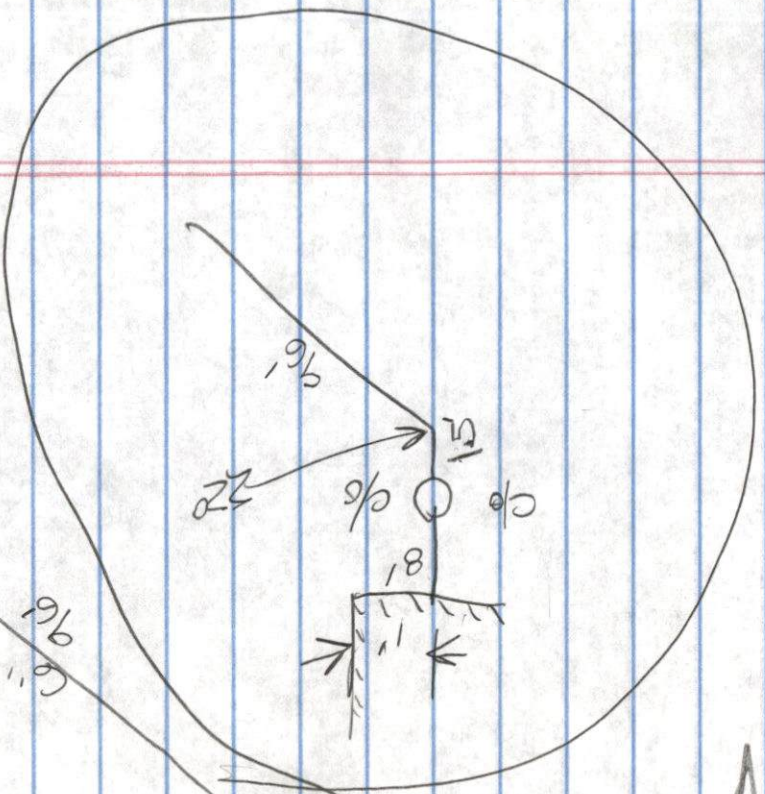
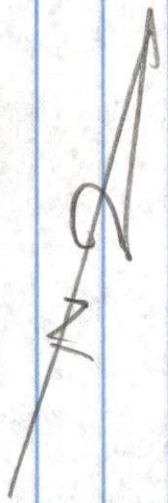

New Hb

ACOSHA N.13

