

Sewer main extension

Expires: 6/20/15



PERMIT NO.
24389

CITY OF NEW BEDFORD
SEWER AND/OR STORM DRAIN PERMIT

DATE 6/20/14

This certifies that permission is granted to - Cumberland Farms:

Property Owner: Cumberland Farms Address: 205 Crossin Blvd, Framingham, MA 01462 Tel: (508) 270-4469

To connect a sewer and/or storm drain located at: Sewer main extension in Shawmut Ave from 335' S x Highway Rd. N 1/4 87'

Assessor's Plot 95 Lot to the sewer and/or storm drain in: sewer main extension Shawmut Avenue Street

To be laid in accordance with the conditions in this application and the City of New Bedford ordinances.

TYPE OF USE: RESIDENTIAL COMMERCIAL INDUSTRIAL FLOW 930 G.P.D.

If applicant other than actual property owner, attach Letter of Authorization from Property Owner.

Name: J.B. Zenggen Tel: (508) 981-1668
Mailing Address: 21 South River Drive, Dedham, MA 02757

The Bonded Contractor/Drain Layer authorized to perform this work is:

Name: J.B. Zenggen Address: 35 - (8 inch) Tel:

Type of Pipe Required: PVC SPM 35 - (8 inch)

PERMIT EXPIRES ONE YEAR AFTER DATE OF ISSUE

- Requires separate connections for sewage and storm drain where applicable. Storm water cannot be discharged to a sanitary sewer.
- All work must be inspected and approved by a D.P.I. inspector before backfilling.
- If this connection is to be part of a private service shared jointly with other building owners, attach copy of Recorded Joint Maintenance Agreement.
- Permits can be issued to Industrial and/or Commercial Applicants only upon receipt and approval by the Commissioner of Public Infrastructure of required plans and supplemental information.
- In addition, a City-issued Industrial User Discharge Permit and/or a Sewer Extension/Connection Permit issued by the Commonwealth of Massachusetts D.E.P. shall be required by the City for Industrial Discharge into the sewer system.

Industrial User Discharge Permit No. Date:

Comm. Mass. Sewer Conn./Ext. Permit No. Date:

A Filing and Inspection Fee of \$450.00, plus an Entrance Fee of \$318.00 where applicable, must accompany this application.

Bank# BayCoast Bank Check# 31982 Date 6/20/14 Receipt# 19354

Other requirements: Please call ahead 24hr notice for any inspectors 2(508) 979-1550

ext 5010 must file COMM/IDE Permit before starting work. Certificate for sewer extension

Connection made to Sewer Part of jointly-shared private line YES NO
Storm Drain

Applicant agrees to abide by the above terms, as well as all pertinent ordinances of the City of New Bedford, and such other special rules as the Commissioner of Public Infrastructure and/or City Engineer may deem necessary

City Engineer

Signature of Property Owner or Representative

INSPECTOR'S REPORT

INSPECTED BY:
DATE:
COMMENTS:

APPROVED

SEE WHITE SHEET
SIGNATURE

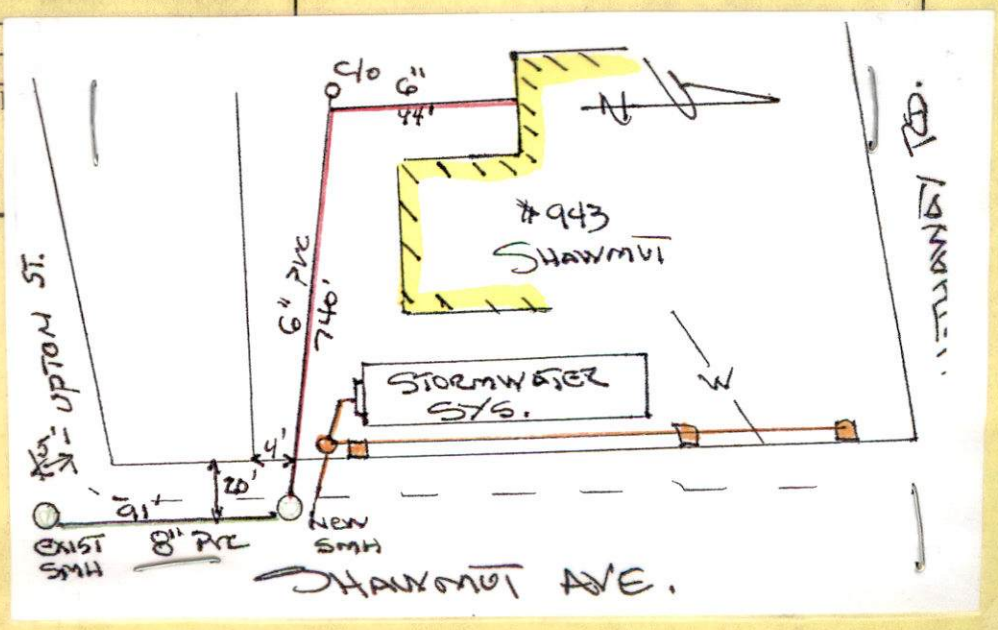

Sewer main extension & storm drain services Expires: 6/20/15



Inspector
Monday June 30 @ 2:00pm

PERMIT NO.

CITY OF NEW BEDFORD
SEWER AND/OR STORM DRAIN PERMIT

DATE 6/20/14

24389

This certifies that permission is granted to - Cumberland Farms:

Cumberland Farms 200 Crossing Blvd. (508) 270-4469
Property Owner Address Framingham, MA 01702 Tel.

To connect a sewer and/or storm drain located at Sewer main extension in Shawsmut Ave from 335' S x
Dartmouth Rd. W 87'

Assessor's Plot 9.5 Lot 233, to the sewer and/or storm drain in sewer mainline Shawsmut Avenue Street
& storm drain to #2

To be laid in accordance with the conditions in this application and the City of New Bedford ordinances.

TYPE OF USE: RESIDENTIAL COMMERCIAL INDUSTRIAL FLOW 930 G.P.D.

If applicant other than actual property owner, attach Letter of Authorization from Property Owner.

Name J.B. Laragan Tel. (508) 981-1668

Mailing Address 21 East River Drive Dartmouth, MA 02747

The Bonded Contractor/Drain Layer authorized to perform this work is:

J.B. Laragan

Name Address Tel.

Type of Pipe Required: PC SDN 35 -(8 inch)

PERMIT EXPIRES ONE YEAR AFTER DATE OF ISSUE

- Requires separate connections for sewage and storm drain where applicable. Storm water cannot be discharged to a sanitary sewer.
- All work must be inspected and approved by a D.P.I. inspector before backfilling.
- If this connection is to be part of a private service shared jointly with other building owners, attach copy of Recorded Joint Maintenance Agreement.
- Permits can be issued to Industrial and/or Commercial Applicants only upon receipt and approval by the Commissioner of Public Infrastructure of required plans and supplemental information.
- In addition, a City-issued Industrial User Discharge Permit and/or a Sewer Extension/Connection Permit issued by the Commonwealth of Massachusetts D.E.P. shall be required by the City for Industrial Discharge into the sewer system.

Industrial User Discharge Permit No. Date

Comm. Mass. Sewer Conn./Ext. Permit No. Date

A Filing and Inspection Fee of \$450.00, plus an Entrance Fee of \$318.00 where applicable, must accompany this application.

Bank# BayCoast Bank Check# 31982 Date 6/20/14 Receipt# 19354

Other requirements Please call ahead 24hr notice for any inspections at (508) 979-1550

ext. 506... Must file with DEP - DEP wp 72 Compliance certificate for sewer extension

Connection made to Sewer <1000' Ccpp. printed with sewer permit. Sewer must be pressure tested before service can be witnessed.
Part of jointly-shared private line YES NO

Applicant agrees to abide by the above terms, as well as all pertinent ordinances of the City of New Bedford, and such other special rules as the Commissioner of Public Infrastructure and/or City Engineer may deem necessary

City Engineer 6/20/2014

Signature of Property Owner or Representative

INSPECTOR'S REPORT

INSPECTED BY: BB
DATE: 7/3/14
COMMENTS:

APPROVED

DISAPPROVED

SIGNATURE

SKETCH PLAN

Sewer main extension & storm drain services.

Expires: 6/20/15



PERMIT NO.
24389

CITY OF NEW BEDFORD
SEWER AND/OR STORM DRAIN PERMIT

DATE 6/20/14

This certifies that permission is granted to - Cumberland Farms:

Cumberland Farms Property Owner 200 Crossing Blvd. Address Framingham, MA 01702 (508) 276-4469 Tel.

To connect a sewer and/or storm drain located at Sewer main extension in Shawmut Ave from 335' S x 11thway Rd. W 87'

Assessor's Plot 95 Lot, to the sewer and/or storm drain in sewer manhole Shawmut Avenue Street

To be laid in accordance with the conditions in this application and the City of New Bedford ordinances.
TYPE OF USE: RESIDENTIAL COMMERCIAL INDUSTRIAL FLOW 930 G.P.D. per day

If applicant other than actual property owner, attach Letter of Authorization from Property Owner.
Name J.B. Laganan Tel. (508) 984-1668
Mailing Address 21 East River Drive Dartmouth, MA 02747

The Bonded Contractor/Drain Layer authorized to perform this work is:

J.B. Laganan
Name Address Tel.
Type of Pipe Required: PR SDN 35 - (8 inch)

PERMIT EXPIRES ONE YEAR AFTER DATE OF ISSUE

- Requires separate connections for sewage and storm drain where applicable. Storm water cannot be discharged to a sanitary sewer.
 - All work must be inspected and approved by a D.P.I. inspector before backfilling.
 - If this connection is to be part of a private service shared jointly with other building owners, attach copy of Recorded Joint Maintenance Agreement.
 - Permits can be issued to Industrial and/or Commercial Applicants only upon receipt and approval by the Commissioner of Public Infrastructure of required plans and supplemental information.
 - In addition, a City-issued Industrial User Discharge Permit and/or a Sewer Extension/Connection Permit issued by the Commonwealth of Massachusetts D.E.P. shall be required by the City for Industrial Discharge into the sewer system.
- Industrial User Discharge Permit No. Date

Comm. Mass. Sewer Conn./Ext. Permit No. Date
A Filing and Inspection Fee of \$450.00, plus an Entrance Fee of \$348.00 where applicable, must accompany this application.

Bank# BayCoast Bank Check# 31982 Date 6/20/14 Receipt# 19354

Other requirements Please call ahead 24hr notice for any inspections (508) 979-1550

Ext. 500' must file with DEP DEP wp 72 Compliance Certificate for sewer extension
Connection made to Sewer Part of jointly-shared private line YES NO tested before service can be witnessed.
Storm Drain

Applicant agrees to abide by the above terms, as well as all pertinent ordinances of the City of New Bedford, and such other special rules as the Commissioner of Public Infrastructure and/or City Engineer may deem necessary

[Signature] 6/20/2014
City Engineer

[Signature]
Signature of Property Owner or Representative

INSPECTOR'S REPORT

INSPECTED BY: _____
DATE: _____
COMMENTS: _____

APPROVED DISAPPROVED

SIGNATURE

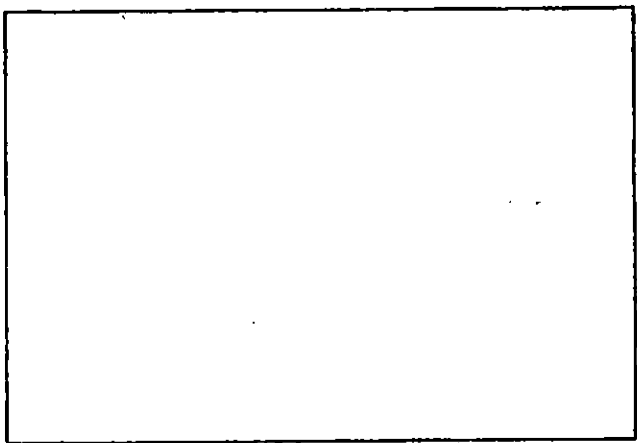

SKETCH PLAN



CITY OF NEW BEDFORD
Jonathan Mitchell, Mayor

Department of Public Infrastructure

Ronald H. Labelle
Commissioner

Water
Wastewater
Highways
Engineering
Cemeteries
Park Maintenance

To Whom It May Concern:

I JAMES Scholes 200 Crossing Blvd., Framingham MA 01702, being
(Name) (Mailing Address)
Senior gas construction Project manager,
Owner of property located at
943 Shawmut Ave.

MAP Plot 95, Lot 233 & 303, hereby agree to allow Jim LAMAGAN (J.B. LAMAGAN & Co.)
(Name)
21 East River Drive, Dartmouth to act on my behalf including affixing my
(Mailing Address) MA 02747
Aron Medeiros

signature in securing permit for:

☒ Sewer/Drain Service Permits
☒ Water Service Permits
☒ Driveway Installation Permits
☒ Sidewalk Installation Permits

I further agree to conform to, and abide by, All City rules and ask regulations applicable to the permit (s) being applied for:

Name James Scholes CF/Cut
Signature
200 Crossing Blvd., Framingham, MA 01702
Address
6/20/14 (508) 270 4469 (direct)
Date Telephone number



CITY OF NEW BEDFORD
Jonathan F. Mitchell, Mayor

Department of Public Infrastructure

Ronald H. Labelle
Commissioner

Water
Wastewater
Highways
Engineering
Cemetery

MEMORANDUM

TO: City of New Bedford Planning Board

FROM: Ronald H. Labelle, Commissioner, D.P.I. 

DATE: November 6, 2013

RE: Site Plan – Cumberland Farms
Shawmut Avenue
Plot 95 Lot 233 + 303

The Department of Public Infrastructure has reviewed the proposed site plan referenced above and recommends approval with the following conditions:

1. Driveway permits are subject to Traffic Commission approval.
2. Permits for sidewalk, driveways, drainage, sewer and water must be obtained from the Department of Public Infrastructure Engineering Division.
3. Driveways to be built in accordance with City of New Bedford regulations and with 4 foot transition curb on both sides.
4. No wheelchair ramp panels at driveways.
5. Drainage design must comply with Phase II, Mass. Department storm water Management Standards.
6. Install wheelchair ramps at the Southwest corner of Upton St and Shawmut Avenue, and the Southeast corner of Hathaway Road and Shawmut Ave.
7. Developer to plant 2 new trees on Shawmut Avenue between the most Southern driveway and Upton St. Trees to be planted in accordance with City of New Bedford regulations.
8. Drainage: Show existing main on Shawmut Avenue with size of pipe. Also, check the condition and capacity of such main.
9. Sewer: Owner must file the compliance certification (form BRP WP 72) with MADEP for the minor sewer main extension being proposed. No sewer service permit will be issued until the compliance Certification has been submitted to MADEP. Also, contractor to check condition of existing sewer manhole where tie-in is proposed.
10. Cut and cap the existing water service at the water main.
11. Tap a new 2 inch water service and reconfigure the domestic service.

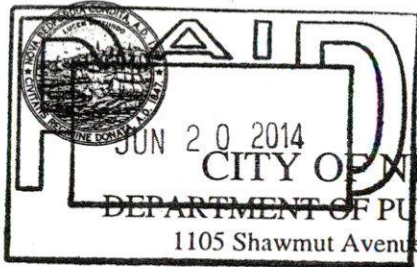

CITY OF NEW BEDFORD

DEPARTMENT OF PUBLIC INFRASTRUCTURE

1105 Shawmut Avenue, New Bedford, MA 02746

Date: June 20 2014

TO: DPI

FROM: J.B. Lanagan Company
sewer permit # 24389 (main extension
Cube
Cumberland Farms)

CHARGE CODE: DPISEW

ACCOUNT: 63906-000-422185

DEPOSIT \$ 450.00 ^{Sewer extension} CHK # 31982
876 + 214.00 = 348.00
\$798.00

Initials UR

White & Yellow/Treasurer's Copy • Pink/Department Copy

City of New Bedford
Dept of Public Infrastructure
1105 Shawmut Ave
New Bedford, MA 02740
(508) 979-1550

001082-0006 Erin I. 06/20/2014 02:54PM

MISCELLANEOUS

Description: DPI SEWER
PERMITS AND EXTENSIONS
(DPISEW)

DPI SEWER PERMITS AND
EXTENSIONS

1 @ 798.00

DPI SEWER PERMITS AND
EXTENSIONS

Principal 798.00

Interest 0.00

0000-101009- 798.00D

63906000-422185- 798.00C

Payment Id: 19354

798.00

Subtotal 798.00

Total 798.00

CHECK 798.00

Check Number 31982

Change due 0.00

Paid by: J.B LANAGAN COMPANY INC

Thank you for your payment

CUSTOMER COPY
DUPLICATE RECEIPT

COMPLEMENTS @
7/21/14 SHAWMUT AVE (B)

SEWER MAIN EXTENSION
FROM OPTION ST. TO PROP.

7/21/14

CIVIL. CONTRACTOR SUBMITTEN
AS-BUILT PLANS ON
SEWER EXTENSION

LANDMAN RECEIVED PERMISSION
FROM ZEB ON SHAWMUT SEWER
EXTENSION PERMITS @ POLICE.

PERMITS ACTION @ KDP TO START
AS-BUILT PERMITS @ POLICE.

