



PERMIT NO.

24375

CITY OF NEW BEDFORD  
SEWER AND/OR STORM DRAIN PERMIT

DATE

1/30/14  
Expires 1/30/15

This certifies that permission is granted to

Property Owner

Address

Tel.

To connect a sewer and/or storm drain located at

Assessor's Plot

Lot

to the sewer and/or storm drain in

To be laid in accordance with the conditions in this application and the City of New Bedford ordinances.

TYPE OF USE: RESIDENTIAL

COMMERCIAL

INDUSTRIAL

FLOW 330 G.P.D.

If applicant other than actual property owner, attach Letter of Authorization from Property Owner.

Name

Mailing Address

The Bonded Contractor/Drain Layer authorized to perform this work is:

Name

Address

Tel.

Type of Pipe Required:

PERMIT EXPIRES ONE YEAR AFTER DATE OF ISSUE

- Requires separate connections for sewage and storm drain where applicable. Storm water cannot be discharged to a sanitary sewer.
- All work must be inspected and approved by a D.P.I. inspector before backfilling.
- If this connection is to be part of a private service shared jointly with other building owners, attach copy of Recorded Joint Maintenance Agreement.
- Permits can be issued to Industrial and/or Commercial Applicants only upon receipt and approval by the Commissioner of Public Infrastructure of required plans and supplemental information.
- In addition, a City-issued Industrial User Discharge Permit and/or a Sewer Extension/Connection Permit issued by the Commonwealth of Massachusetts D.E.P. shall be required by the City for Industrial Discharge into the sewer system.

Industrial User Discharge Permit No.

Date

Comm. Mass. Sewer Conn./Ext. Permit No.

Date

A Filing and Inspection Fee of \$450.00, plus an Entrance Fee of \$ where applicable, must accompany this application.

Bank#

Check#

Date

Receipt#

Other requirements:

Connection made to

Sewer

Storm Drain

Part of jointly-shared private line

YES

NO

Applicant agrees to abide by the above terms, as well as all pertinent ordinances of the City of New Bedford, and such other special rules as the Commissioner of Public Infrastructure and/or City Engineer may deem necessary

City Engineer

Signature of Property Owner or Representative

INSPECTOR'S REPORT

INSPECTED BY: SEE WHITE SHEET

DATE:

COMMENTS:

APPROVED

DISAPPROVED

SIGNATURE

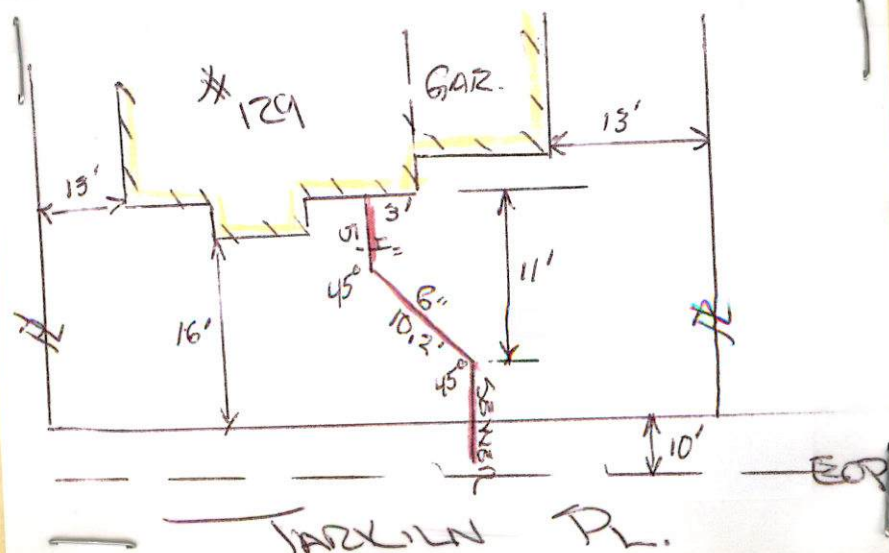



now-14-2.



PERMIT NO.  
24375

CITY OF NEW BEDFORD  
SEWER AND/OR STORM DRAIN PERMIT

DATE 1/30/14  
Expires 1/30/15

This certifies that permission is granted to

Long Built Homes 158 McCombs Blvd (508) 965-3579  
Property Owner Address Tel.

To connect a sewer and/or storm drain located at 129 Taeklin Place

Assessor's Plot 1306 Lot 218, to the sewer and/or storm drain in Taeklin Place 8" main Street

To be laid in accordance with the conditions in this application and the City of New Bedford ordinances.

TYPE OF USE: RESIDENTIAL COMMERCIAL INDUSTRIAL FLOW 330 G.P.D.

If applicant other than actual property owner, attach Letter of Authorization from Property Owner.

Name Lee Catignetti Tel. (508) 965-3579

Mailing Address 158 McCombs Blvd

The Bonded Contractor/Drain Layer authorized to perform this work is:

Name D.W. White Address Development Tel.

Type of Pipe Required: SDM Pvc 35"

PERMIT EXPIRES ONE YEAR AFTER DATE OF ISSUE

- Requires separate connections for sewage and storm drain where applicable. Storm water cannot be discharged to a sanitary sewer.
- All work must be inspected and approved by a D.P.I. inspector before backfilling.
- If this connection is to be part of a private service shared jointly with other building owners, attach copy of Recorded Joint Maintenance Agreement.
- Permits can be issued to Industrial and/or Commercial Applicants only upon receipt and approval by the Commissioner of Public Infrastructure of required plans and supplemental information.
- In addition, a City-issued Industrial User Discharge Permit and/or a Sewer Extension/Connection Permit issued by the Commonwealth of Massachusetts D.E.P. shall be required by the City for Industrial Discharge into the sewer system.

Industrial User Discharge Permit No. .... Date .....

Comm. Mass. Sewer Conn./Ext. Permit No. .... Date .....

A Filing and Inspection Fee of \$ 450.00, plus an Entrance Fee of \$ ..... where applicable, must accompany this application.

Bank# Baymont Bank Check# 09583 Date 1/30/14 Receipt# 10944

Other requirements: Please call ahead 24hr notice for inspection  
@ (508) 979-1550 ext. 500

Connection made to Sewer Part of jointly-shared private line YES NO  
Storm Drain

Applicant agrees to abide by the above terms, as well as all pertinent ordinances of the City of New Bedford, and such other special rules as the Commissioner of Public Infrastructure and/or City Engineer may deem necessary

[Signature] 2/3/2014  
City Engineer

[Signature]  
Signature of Property Owner or Representative  
Long Built Homes, Inc.

INSPECTOR'S REPORT

INSPECTED BY: \_\_\_\_\_

DATE: \_\_\_\_\_

COMMENTS: \_\_\_\_\_

\_\_\_\_\_

\_\_\_\_\_

APPROVED

DISAPPROVED

SIGNATURE

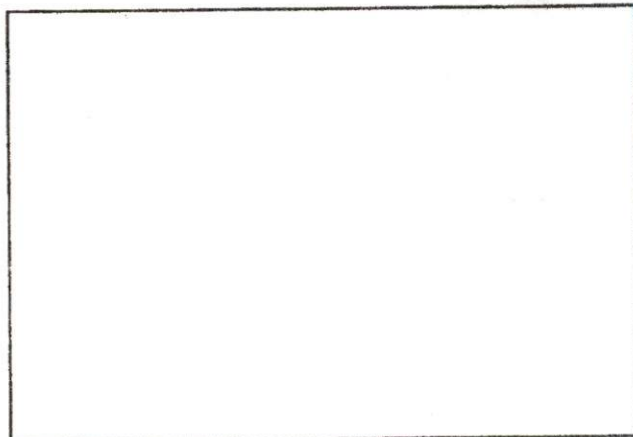

SKETCH PLAN

✓



PERMIT NO.  
24375

CITY OF NEW BEDFORD  
SEWER AND/OR STORM DRAIN PERMIT

DATE 1/30/14  
Expires 1/30/15

This certifies that permission is granted to

Long Built Homes 158 McCombs Blvd (508) 965-3579  
Property Owner Address Tel.

To connect a sewer and/or storm drain located at 129 Taeklin Place

Assessor's Plot 1309 Lot 218, to the sewer and/or storm drain in Taeklin Place 8" main Street

To be laid in accordance with the conditions in this application and the City of New Bedford ordinances.

TYPE OF USE: RESIDENTIAL COMMERCIAL INDUSTRIAL FLOW 330 G.P.D.

If applicant other than actual property owner, attach Letter of Authorization from Property Owner.

Name Lee Catignelli Tel. (508) 965-3579

Mailing Address 158 McCombs Blvd

The Bonded Contractor/Drain Layer authorized to perform this work is:

Name D.W. White Address Development Tel.

Type of Pipe Required: SDM Pvc 35"

PERMIT EXPIRES ONE YEAR AFTER DATE OF ISSUE

- Requires separate connections for sewage and storm drain where applicable. Storm water cannot be discharged to a sanitary sewer.
  - All work must be inspected and approved by a D.P.I. inspector before backfilling.
  - If this connection is to be part of a private service shared jointly with other building owners, attach copy of Recorded Joint Maintenance Agreement.
  - Permits can be issued to Industrial and/or Commercial Applicants only upon receipt and approval by the Commissioner of Public Infrastructure of required plans and supplemental information.
  - In addition, a City-issued Industrial User Discharge Permit and/or a Sewer Extension/Connection Permit issued by the Commonwealth of Massachusetts D.E.P. shall be required by the City for Industrial Discharge into the sewer system.
- Industrial User Discharge Permit No. \_\_\_\_\_ Date \_\_\_\_\_

Comm. Mass. Sewer Conn./Ext. Permit No. \_\_\_\_\_ Date \_\_\_\_\_

A Filing and Inspection Fee of \$ 450.00, plus an Entrance Fee of \$ \_\_\_\_\_ where applicable, must accompany this application.

Bank# Bayport Bank Check# 09583 Date 1/30/14 Receipt# 10944

Other requirements: Please call ahead 24hr notice for inspection

@ (508) 979-1550 ext. 506

Connection made to Sewer Part of jointly-shared private line YES NO  
Storm Drain

Applicant agrees to abide by the above terms, as well as all pertinent ordinances of the City of New Bedford, and such other special rules as the Commissioner of Public Infrastructure and/or City Engineer may deem necessary.

David B. White 2/3/2014  
City Engineer

Long Built Homes, Inc.  
Signature of Property Owner or Representative

INSPECTOR'S REPORT

INSPECTED BY: [Signature]  
DATE: 3/13/14  
COMMENTS: \_\_\_\_\_

APPROVED

DISAPPROVED

[Signature]  
SIGNATURE

SKETCH PLAN





**CITY OF NEW BEDFORD**

Jonathan F. Mitchell, Mayor

**Department of Public Infrastructure**

Ronald H. Labelle  
Commissioner

Water  
Wastewater  
Highways  
Engineering  
Cemetery

**To Whom It May Concern:**

Long Built Homes, Inc., having a mailing address of  
X 158 C. McCombs Blvd., New Bedford, MA 02745, being  
(Name) (Mailing Address)

**Owner of property located at**

129 Tarkila Place

Lee Castignetti and/or

Plot 130G, Lot 218, hereby agree to allow Tony Shardella  
c/o Long Built Homes, Inc.  
(Name)

158 C. McCombs Blvd., to act on my behalf including affixing my  
(Mailing Address)  
New Bedford, MA 02745  
signature in securing permit for:

- ☒ Sewer/Drain Service Permits
- ☒ Water Service Permits
- ☒ Driveway Installation Permits
- ☒ Sidewalk Installation Permits

I further agree to conform to, and abide by, All City rules and ask regulations applicable to the permit (s) being applied for:

Long Built Homes, Inc.  
Name By: Robert F. Long  
Signature  
Robert F. Long, President  
158 C. McCombs Blvd., New Bedford, MA 02745  
Address  
1/30/14 508-245-3161 or  
Date Telephone number  
508-995-8240x13





Commonwealth of Massachusetts

# CITY OF NEW BEDFORD

City Hall, Room 308, 133 William Street New Bedford, MA 02740 (508) 979-1540



lot  
218

## FOUNDATION PERMIT

12/24/2013

No. **B-13-2497**

MSBC Sect. 111.8 - Any permit issued shall be deemed abandoned and invalid unless the work authorized by it shall have been commenced within six (6) months after its issuance.

FEE PAID \$ #Error

This certifies that LONG BUILT HOMES INC

owner/contractor has permission to:

129

TARKILN PL

on: Foundations Only 1-2 Family - 100.00

Providing that the person accepting this permit shall in every respect conform to the terms of application therefore on file in this office; to the provisions of the statute of the Commonwealth and to the by-laws of the City of New Bedford relating to the inspection, erection, enlarging, altering, raising, moving, repairing, or tearing down of a building.

Permit is issued subject to the following special requirements: (Restrictions)



**Wiring Inspector**



**Plumbing Inspector**



**Building Inspector**

---

---

---

---

---

---

---

---

---

---

---

---

YOUR AREA INSPECTOR IS: Thomas Welch

Tel. (508) 979-1540 Between 8:00am - 9:00am

**NOTICE: NOTIFY INSPECTOR 48 HOURS IN  
ADVANCE OF APPLYING SHEATHING OR LATHING**

**OCCUPANCY PERMIT REQUIRED BEFORE OCCUPANCY**

No Building or Structure shall be used or occupied until the Certificate of Use and Occupancy shall have been issued by the Building Commissioner - MSBC, Sect. 120.1

**This Card Must Be Displayed in a Conspicuous Place on the Premises and Not Torn Down or Removed Until Completion of Work**

SUBJECT TO MASSACHUSETTS  
STATE BUILDING CODE

*Danny D. Romanowicz*

Building Inspector





Commonwealth of Massachusetts

# City of New Bedford

133 William Street New Bedford, MA 02740

## SEWER PERMIT



Date: **2/24/2014**

No. **WW-14-2**

Sewer Connection Fee: **\$450.00**

Pipe Size: **0.00**

Trench Length: **0.00**

Service Location: **129 TARKILN PL**

Owner Name: **LONG BUILT HOMES INC**

Type of Occupancy: **Residential**

Type of Work: **Sewer - New Sewer Service**

Work Description: **SEWER PERMIT# 24375**

**P130G L218**

**129 TARKILN PLACE**

**CONNECTING TO 8"MAIN IN TARKILN PLACE**

No. of Units : **3** Required Design Daily Flow : **330.00** Provided Daily Flow : **0.00**

The undersigned petitions you to grant permission to ENTER INTO THE MAIN SEWER and, if such permission is granted, hereby agrees to the following:

1. To abide by the conditions and regulations imposed by the Commissioner of Public Works by statute or by ordinance now in force, or as amended from time to time.
2. That the connection of said sewer with the main sewer shall be inspected by an employee of the department of Public Works or by a designated agent of the Town before burial of said connection.
3. That the work shall at all times be under the direction and control of the Commissioner of Public Works or his authorized agent, and that any expense incurred by the Town shall be charged to the permittee, and said

permittee

agrees to reimburse the Town for said expense.

Installing Company Name: **DW White**

License Type: **CSL-00**  
**Unrestricted**

Address: **867 Middle Road**

City/Town/State: **Acushnet**

**MA**

SNOOPING

3/13/14 (R)

DW WHITES

SEWER TIE @ LOT 218

WHALES WOODS

