



PERMIT NO.

24374 - extension

CITY OF NEW BEDFORD
SEWER AND/OR STORM DRAIN PERMIT

DATE

1/17/14
expires 1/17/15

This certifies that permission is granted to

Four C's Properties

Property Owner

Address

220 McHorsewell Rd.
Rochester, NH 03070

Tel.

(508) 330-6998

To connect a sewer and/or storm drain located at 1 Monmouth Street -

Assessor's Plot 24 Lot 103, to the sewer and/or storm drain in 954 from property to Monmouth Street

To be laid in accordance with the conditions in this application and the City of New Bedford ordinances.

TYPE OF USE: RESIDENTIAL

COMMERCIAL

INDUSTRIAL

FLOW

G.P.D.

If applicant other than actual property owner, attach Letter of Authorization from Property Owner.

Name

Mailing Address

The Bonded Contractor/Drain Layer authorized to perform this work is:

Name

Address

Type of Pipe Required:

8" SDR 35

Tel.

PERMIT EXPIRES ONE YEAR AFTER DATE OF ISSUE

- Requires separate connections for sewage and storm drain where applicable. Storm water cannot be discharged to a sanitary sewer.
- All work must be inspected and approved by a D.P.I. inspector before backfilling.
- If this connection is to be part of a private service shared jointly with other building owners, attach copy of Recorded Joint Maintenance Agreement.
- Permits can be issued to Industrial and/or Commercial Applicants only upon receipt and approval by the Commissioner of Public Infrastructure of required plans and supplemental information.
- In addition, a City-issued Industrial User Discharge Permit and/or a Sewer Extension/Connection Permit issued by the Commonwealth of Massachusetts D.E.P. shall be required by the City for Industrial Discharge into the sewer system.

Comm. Mass. Sewer Conn./Ext. Permit No.

Date

A Filing and Inspection Fee of \$450, plus an Entrance Fee of \$300, where applicable, must accompany this application.

Bank#

Bay Coast Bank

Check#

8205-entrance

Date

1/17/14

Receipt#

000548-0003

Other requirements:

24 hour notice for inspection @ 508.979.1550. Must file with DEP-BRP WP72 compliance certification for sewer extensions <1000' (app printed with sewer permit) Sewer main must be pressure tested before. Serv can be tied into main must be witnessed by DEP Engineering, call to coordinate @ 508.979.1550

Connection made to

Sewer

Part of jointly-shared private line

YES

NO

Storm Drain

Applicant agrees to abide by the above terms, as well as all pertinent ordinances of the City of New Bedford, and such other special rules as the Commissioner of Public Infrastructure and/or City Engineer may deem necessary

City Engineer

Signature of Property Owner or Representative

INSPECTOR'S REPORT

INSPECTED BY:

DATE:

COMMENTS:

APPROVED

DIS

SEE WHITE SHEET

SIGNATURE

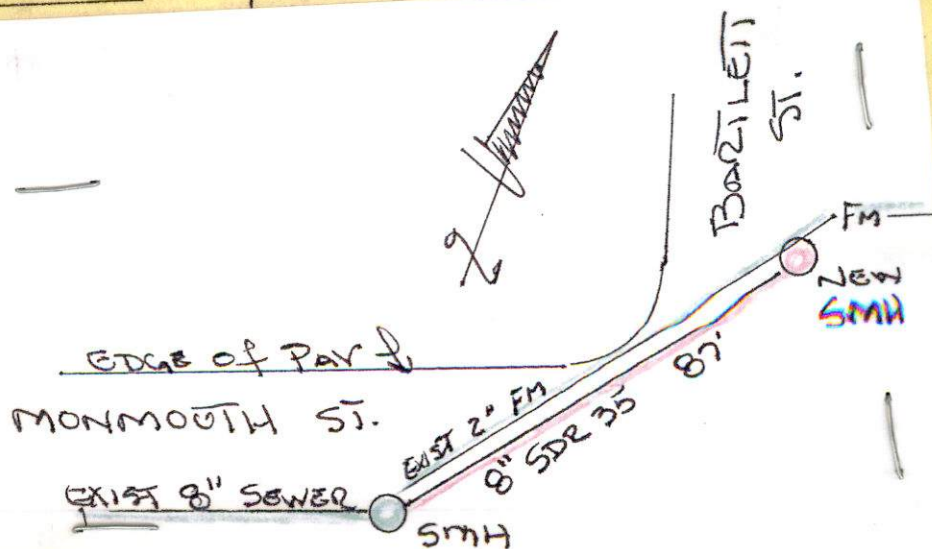



PERMIT NO.

24374 - Extension

CITY OF NEW BEDFORD
SEWER AND/OR STORM DRAIN PERMIT

DATE 1/17/14

expires 1/17/15

This certifies that permission is granted to

Fair C's Properties

Property Owner

Address

220 Mottawisett Rd.
Rochester, MA 01770 - Tel.

(508) 330-6998

To connect a sewer and/or storm drain located at 1 Monmouth Street -

Assessor's Plot 130 Lot 103, to the sewer and/or storm drain in 95' from property to Monmouth Street

To be laid in accordance with the conditions in this application and the City of New Bedford ordinances.

TYPE OF USE: RESIDENTIAL COMMERCIAL INDUSTRIAL FLOW G.P.D.

If applicant other than actual property owner, attach Letter of Authorization from Property Owner.

Name Town of Acushnet Tel.

Mailing Address.

The Bonded Contractor/Drain Layer authorized to perform this work is: RJ Canessa

Name Address Tel.

Type of Pipe Required: 8" SDR 35

PERMIT EXPIRES ONE YEAR AFTER DATE OF ISSUE

- Requires separate connections for sewage and storm drain where applicable. Storm water cannot be discharged to a sanitary sewer.
 - All work must be inspected and approved by a D.P.I. inspector before backfilling.
 - If this connection is to be part of a private service shared jointly with other building owners, attach copy of Recorded Joint Maintenance Agreement.
 - Permits can be issued to Industrial and/or Commercial Applicants only upon receipt and approval by the Commissioner of Public Infrastructure of required plans and supplemental information.
 - In addition, a City-issued Industrial User Discharge Permit and/or a Sewer Extension/Connection Permit issued by the Commonwealth of Massachusetts D.E.P. shall be required by the City for Industrial Discharge into the sewer system.
- Industrial User Discharge Permit No. Date.

Comm. Mass. Sewer Conn./Ext. Permit No. Date.

A Filing and Inspection Fee of \$450 plus an Entrance Fee of \$380, where applicable, must accompany this application.

Bank# Bay Coast Bank Check# 8201 - permit fee 8205 - entrance Date 1/17/14 Receipt# 000548-0003

Other requirements: 24 hour notice for inspection @ 508-979-1550. Must file with DEP-BRP WPT2 compliance certification for sewer extensions <1000' (app printed with sewer permit). Sewer main must be pressure tested before service can be tied into main. Sewer must be witnessed by DEP Engineering, call to coordinate Connection made to Storm Drain Part of jointly-shared private line YES NO @ 508-979-1550

Applicant agrees to abide by the above terms, as well as all pertinent ordinances of the City of New Bedford, and such other special rules as the Commissioner of Public Infrastructure and/or City Engineer may deem necessary.

City Engineer

Signature of Property Owner or Representative

INSPECTOR'S REPORT

INSPECTED BY:

DATE:

COMMENTS:

APPROVED

DISAPPROVED

SIGNATURE

DPI-ENG

SKETCH PLAN



un. Ashnet

PERMIT NO.

24374 - Extension

CITY OF NEW BEDFORD
SEWER AND/OR STORM DRAIN PERMIT

DATE 1/17/14
expires 1/17/15

This certificate permission is granted to

Four C's Properties

220 Mottapoisell Rd.
Rochester, MA - 01770 Tel.

(508) 330-6998

Property Owner

Address

To connect a sewer and/or storm drain located at 1 Monmouth Street -

Assessor's Plot 24 Lot 103, to the sewer and/or storm drain in 95' from property to Monmouth Street

To be laid in accordance with the conditions in this application and the City of New Bedford ordinances.

TYPE OF USE: RESIDENTIAL COMMERCIAL INDUSTRIAL FLOW G.P.D.

If applicant other than actual property owner, attach Letter of Authorization from Property Owner.

Name Town of Acushnet

Tel. 508 998 0230

Mailing Address Dan Monard

The Bonded Contractor/Drain Layer authorized to perform this work is:

RJ Canessa

Name

Address

Tel.

Type of Pipe Required: 8" SDR 35

PERMIT EXPIRES ONE YEAR AFTER DATE OF ISSUE

- Requires separate connections for sewage and storm drain where applicable. Storm water cannot be discharged to a sanitary sewer.
 - All work must be inspected and approved by a D.P.I. inspector before backfilling.
 - If this connection is to be part of a private service shared jointly with other building owners, attach copy of Recorded Joint Maintenance Agreement.
 - Permits can be issued to Industrial and/or Commercial Applicants only upon receipt and approval by the Commissioner of Public Infrastructure of required plans and supplemental information.
 - In addition, a City-issued Industrial User Discharge Permit and/or a Sewer Extension/Connection Permit issued by the Commonwealth of Massachusetts D.E.P. shall be required by the City for Industrial Discharge into the sewer system.
- Industrial User Discharge Permit No. Date.

Comm. Mass. Sewer Conn./Ext. Permit No. Date.

A Filing and Inspection Fee of \$450 plus an Entrance Fee of \$380 where applicable, must accompany this application.

Bank# Bay Coast Bank Check# 8201 - permit fee 8205 - entrance Date 1/17/14 Receipt# 000548-0003

Other requirements: 24 hour notice for inspection @ 508-979-1550. Must file with DEP-BRP WPT2 compliance certification for sewer extensions <1000' (app printed with sewer permit). Sewer main must be pressure tested before sewer can be tied into main. Sewer must be witnessed by DEP Engineering, call to coordinate @ 508-979-1550

Connection made to

Storm Drain

Part of jointly-shared private line

YES

NO

Applicant agrees to abide by the above terms, as well as all pertinent ordinances of the City of New Bedford, and such other special rules as the Commissioner of Public Infrastructure and/or City Engineer may deem necessary

City Engineer

Signature of Property Owner or Representative

INSPECTOR'S REPORT

INSPECTED BY:

DATE:

COMMENTS:

APPROVED

DISAPPROVED

SIGNATURE

SKETCH PLAN



CITY OF NEW BEDFORD
Jonathan Mitchell, Mayor

Department of Public Infrastructure

Ronald H. Labelle
Commissioner

Water
Wastewater
Highways
Engineering
Cemeteries
Park Maintenance

To Whom It May Concern:

I FOUR C'S Properties, LLC 220 Mattapoisett Rd being
(Name) (Mailing Address) Rockester, MA 02770

Owner of property located at

ONE Monmouth Street, Arushnet, MA 02743

Plot _____, Lot _____, hereby agree to allow Sharon Thompson
(Name)

904 Sharon Street NO MA to act on my behalf including affixing my
(Mailing Address)

signature in securing permit for:

☒ Sewer/Drain Service Permits
☐ Water Service Permits
☐ Driveway Installation Permits
☐ Sidewalk Installation Permits

I further agree to conform to, and abide by, All City rules and ask regulations applicable to the permit (s) being applied for:

Name Ruth Correia, Manager
Signature
220 Mattapoisett Rd. Rockester, MA
Address
12/2/13 508-330-6998
Date Telephone number

1YD



1YD