



PERMIT NO.

24368

CITY OF NEW BEDFORD
SEWER AND/OR STORM DRAIN PERMIT

DATE 11/22/13

This certifies that permission is granted to

Property Owner Ronald Oliveira Address 5 Ocean Ave. Apt. 204 Tel. (508) 733-5931

To connect a sewer and/or storm drain located at Lucy St. (S.D.) 322' - Ex. Central Avenue

Assessor's Plot 132 Lot 346, to the sewer and/or storm drain in San Sewer into Lucy Street

To be laid in accordance with the conditions in this application and the City of New Bedford ordinances.

TYPE OF USE: RESIDENTIAL COMMERCIAL INDUSTRIAL FLOW 330 G.P.D.

If applicant other than actual property owner, attach Letter of Authorization from Property Owner.

Name..... Tel.....

Mailing Address.....

The Bonded Contractor/Drain Layer authorized to perform this work is:

Name R.J. Conessa Address (508) 998-3404 Tel. 7

Type of Pipe Required: SD PVC 35

PERMIT EXPIRES ONE YEAR AFTER DATE OF ISSUE

- Requires separate connections for sewage and storm drain where applicable. Storm water cannot be discharged to a sanitary sewer.
- All work must be inspected and approved by a D.P.I. inspector before backfilling.
- If this connection is to be part of a private service shared jointly with other building owners, attach copy of Recorded Joint Maintenance Agreement.
- Permits can be issued to Industrial and/or Commercial Applicants only upon receipt and approval by the Commissioner of Public Infrastructure of required plans and supplemental information.
- In addition, a City-issued Industrial User Discharge Permit and/or a Sewer Extension/Connection Permit issued by the Commonwealth of Massachusetts D.E.P. shall be required by the City for Industrial Discharge into the sewer system.

Industrial User Discharge Permit No..... Date.....

Comm. Mass. Sewer Conn./Ext. Permit No..... Date.....

A Filing and Inspection Fee of \$....., plus an Entrance Fee of \$..... where applicable, must accompany this application.

Bank# Bank of America Check# 5213 Date 11/22/13 Receipt# 09922

Other requirements: Please call ahead 24hr notice for inspection @

(508) 999-1550 ext. 5226

Connection made to Sewer Part of jointly-shared private line YES NO
Storm Drain

Applicant agrees to abide by the above terms, as well as all pertinent ordinances of the City of New Bedford, and such other special rules as the Commissioner of Public Infrastructure and/or City Engineer may deem necessary

Ronald Oliveira
City Engineer

Ronald Oliveira
Signature of Property Owner or Representative

INSPECTOR'S REPORT

INSPECTED BY: _____

DATE: _____

COMMENTS: _____

APPROVED

DISAPPROVED

SIGNATURE

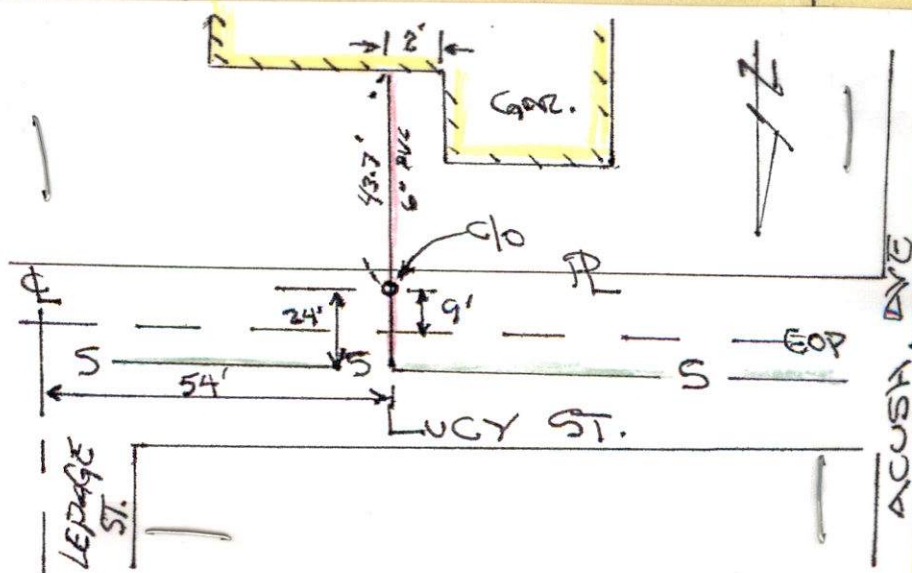



CITY OF NEW BEDFORD
SEWER AND/OR STORM DRAIN PERMIT

PERMIT NO.
24368

DATE 11/22/13

This certifies that permission is granted to

Ronald Oliveira 5 Acers Way (508) 733-5931
Property Owner Address Ocushet mh 02743 Tel.

To connect a sewer and/or storm drain located at Lucy St (S.S.) 32 1/2 Ex Ocushet Avenue

Assessor's Plot 132 Lot 346, to the sewer and/or storm drain in San Sewer into Lucy Street

To be laid in accordance with the conditions in this application and the City of New Bedford ordinances.

TYPE OF USE: RESIDENTIAL COMMERCIAL INDUSTRIAL FLOW 330 G.P.D.

If applicant other than actual property owner, attach Letter of Authorization from Property Owner.

Name N/A Tel.

Mailing Address N/A

The Bonded Contractor/Drain Layer authorized to perform this work is:

Name RJ. Conessa Address (508) 998-3404 Tel.

Type of Pipe Required: SDR PVC 35

PERMIT EXPIRES ONE YEAR AFTER DATE OF ISSUE

- Requires separate connections for sewage and storm drain where applicable. Storm water cannot be discharged to a sanitary sewer.
 - All work must be inspected and approved by a D.P.I. inspector before backfilling.
 - If this connection is to be part of a private service shared jointly with other building owners, attach copy of Recorded Joint Maintenance Agreement.
 - Permits can be issued to Industrial and/or Commercial Applicants only upon receipt and approval by the Commissioner of Public Infrastructure of required plans and supplemental information.
 - In addition, a City-issued Industrial User Discharge Permit and/or a Sewer Extension/Connection Permit issued by the Commonwealth of Massachusetts D.E.P. shall be required by the City for Industrial Discharge into the sewer system.
- Industrial User Discharge Permit No. Date

Comm. Mass. Sewer Conn./Ext. Permit No. Date

A Filing and Inspection Fee of \$, plus an Entrance Fee of \$ where applicable, must accompany this application.

Bank# Bank of America Check# 5213 Date 11/22/13 Receipt# 09922

Other requirements: Please call ahead 24hr notice for inspection @

(508) 979-1550 ext 506

Connection made to Sewer Part of jointly-shared private line YES NO
Storm Drain

Applicant agrees to abide by the above terms, as well as all pertinent ordinances of the City of New Bedford, and such other special rules as the Commissioner of Public Infrastructure and/or City Engineer may deem necessary

Barney M. Andrade [Signature]
City Engineer Signature of Property Owner or Representative

INSPECTOR'S REPORT

INSPECTED BY: [Signature]
DATE: 12/20/13
COMMENTS:

APPROVED DISAPPROVED

[Signature]
SIGNATURE

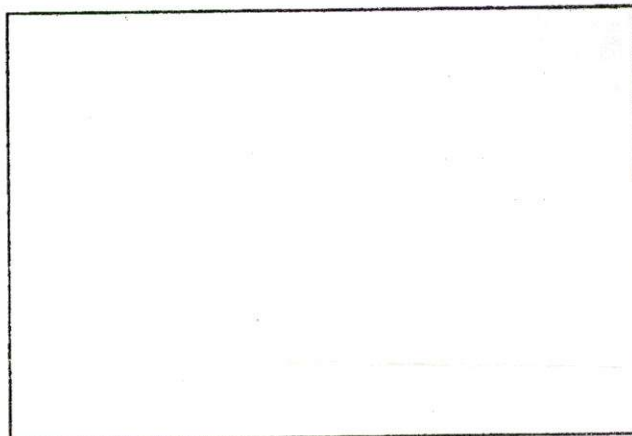

SKETCH PLAN

WOW-13-40

11/22/14



PERMIT NO.
24368

CITY OF NEW BEDFORD
SEWER AND/OR STORM DRAIN PERMIT

DATE 11/22/13

This certifies that permission is granted to

Ronald Oliveira Property Owner 5 Beechers Way Address (508) 733-5931 Tel.

To connect a sewer and/or storm drain located at Lucy St (S.S.) 326 1/2 Ex Acushnet Avenue

Assessor's Plot 132 Lot 346, to the sewer and/or storm drain in 8in Sewer into Lucy Street

To be laid in accordance with the conditions in this application and the City of New Bedford ordinances.

TYPE OF USE: RESIDENTIAL COMMERCIAL INDUSTRIAL FLOW 330 G.P.D.

If applicant other than actual property owner, attach Letter of Authorization from Property Owner.

Name..... Tel.....

Mailing Address.....

The Bonded Contractor/Drain Layer authorized to perform this work is:

Name R.J. Conessa Address (508) 998-3404 → Tel.....

Type of Pipe Required: SDR PVC 35

PERMIT EXPIRES ONE YEAR AFTER DATE OF ISSUE

- Requires separate connections for sewage and storm drain where applicable. Storm water cannot be discharged to a sanitary sewer.
- All work must be inspected and approved by a D.P.I. inspector before backfilling.
- If this connection is to be part of a private service shared jointly with other building owners, attach copy of Recorded Joint Maintenance Agreement.
- Permits can be issued to Industrial and/or Commercial Applicants only upon receipt and approval by the Commissioner of Public Infrastructure of required plans and supplemental information.
- In addition, a City-issued Industrial User Discharge Permit and/or a Sewer Extension/Connection Permit issued by the Commonwealth of Massachusetts D.E.P. shall be required by the City for Industrial Discharge into the sewer system.

Industrial User Discharge Permit No..... Date.....

Comm. Mass. Sewer Conn./Ext. Permit No..... Date.....

A Filing and Inspection Fee of \$....., plus an Entrance Fee of \$..... where applicable, must accompany this application.

Bank# Bank of America Check# 5213 Date 11/22/13 Receipt# 09922

Other requirements: Please call ahead 24hr notice for inspection @

(508) 979-1550 ext 506

Connection made to Sewer Part of jointly-shared private line YES NO
Storm Drain

Applicant agrees to abide by the above terms, as well as all pertinent ordinances of the City of New Bedford, and such other special rules as the Commissioner of Public Infrastructure and/or City Engineer may deem necessary

Dorinda M. Andrade
City Engineer

[Signature]
Signature of Property Owner or Representative

Close of the Works

INSPECTOR'S REPORT

INSPECTED BY: _____
DATE: _____
COMMENTS: _____

APPROVED DISAPPROVED

SIGNATURE

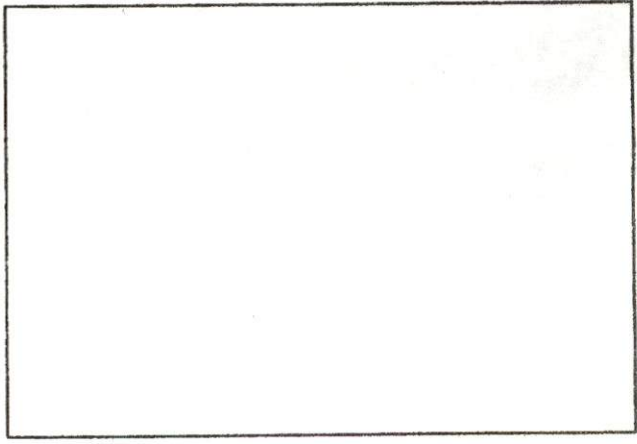

SKETCH PLAN

Return to:

Jordana Roubicek Greenman
185 Devonshire Street
Suite 302
Boston, MA 02110

BK 10908 PG 223
09/26/13 11:20 DOC. 23557
Bristol Co. S.D.

QUITCLAIM DEED

I, Dennis N. Langlois, as Successor Trustee and Sole Trustee of the Langlois Family Nominee Trust u/d/t dated October 3, 2002, recorded with the Bristol County S.D. Registry of Deeds in Book 5792, Page 146 with an address of 709 Dana Farms, Fairhaven, MA 02719 for consideration paid, and in full consideration of SEVENTY THOUSAND AND 00/100 Dollars (U.S. \$70,000.00) grant to Ronald Oliveira, of 5 Archer's Way, Acushnet, Massachusetts *quitclaim covenants*

The land in New Bedford, Bristol County, Massachusetts, together with any buildings thereon, bounded and described as follows:

Being Lot 2 on a plan of land entitled "Approval Not Required Plan in New Bedford, Massachusetts, prepared for Dennis Langlois" dated October 16, 2008 and recorded with the Bristol County S.D. Registry of Deeds in Plan Book 163, Page 73.

Being a portion of the premises conveyed to this Grantor by Deeds recorded in the Bristol County S.D. Registry of Deeds in Book 5792, Page 151 and Book 5792, Page 153.

[Balance of this page is intentionally blank
Signatures follow on the next pages]

REG OF DEEDS
REG #07
BRISTOL S

09/26/13 11:19AM 01
000000 #7809

FEE \$319.20

CASH \$319.20

SS Lucy St (Lot 346) New Bedford, MA
MA 0132-346



Commonwealth of Massachusetts

CITY OF NEW BEDFORD

City Hall, Room 308, 133 William Street New Bedford, MA 02740 (508) 979-1540



FOUNDATION PERMIT

10/24/2013

No. **B-13-1833**

MSBC Sect. 111.8 - Any permit issued shall be deemed abandoned and invalid unless the work authorized by it shall have been commenced within six (6) months after its issuance.

FEE PAID \$ #Error

This certifies that **LANGLOIS JOSEPH A "TRUSTEE" LANGLOIS MARGARET M**

owner/contractor has permission to: **SS LUCY ST**

on: **Foundations Only 1-2 Family - 100.00**

Providing that the person accepting this permit shall in every respect conform to the terms of application therefore on file in this office; to the provisions of the statute of the Commonwealth and to the by-laws of the City of New Bedford relating to the inspection, erection, enlarging, altering, raising, moving, repairing, or tearing down of a building.

Permit is issued subject to the following special requirements: (Restrictions)



Wiring Inspector



Plumbing Inspector



Building Inspector

YOUR AREA INSPECTOR IS: **Thomas Welch**

Tel. (508) 979-1540 Between 8:00am - 9:00am

NOTICE: NOTIFY INSPECTOR 48 HOURS IN ADVANCE OF APPLYING SHEATHING OR LATHING

OCCUPANCY PERMIT REQUIRED BEFORE OCCUPANCY

No Building or Structure shall be used or occupied until the Certificate of Use and Occupancy shall have been issued by the Building Commissioner - MSBC, Sect. 120.1

This Card Must Be Displayed in a Conspicuous Place on the Premises and Not Torn Down or Removed Until Completion of Work

SUBJECT TO MASSACHUSETTS
STATE BUILDING CODE

Danny D. Romanowicz

Building Inspector

Plan Review Comments: :

conservation agent: need proof that the Order of Conditions has been recorded at the registry of deeds. Need to conduct an on site inspection with the contractor prior to any work starting up

Conservation Agent : Project to be completed in compliance with SE49-0673 Order of Conditions

LUCY STREET: NOTE: WILL NEED ELECTRICIAN ALONG WITH ELECTRICAL PERMIT ATTACHED TO THIS JOB

Manny : Plumbing and gas permits required

Civil Eng.: Owner to apply for a water perrrmit

Ana Rosa-DPI Engrg.: RE: TB-13-1833 Lucy St. (S.S.) 326' E. x Acushnet Ave.
(Plot 132/Lot 346)

Requirements to be met by Owner/Developer for this project:

1.) Must provide 4 copies of site plan showing existing conditions and proposed grading/utilities (i.e. proposed water, sewer/storm drain (recharge structure) and driveway), copy of the foundation permit and "stamped" foundation as-built plan.

2.) Must contact D.P.I.-Engineering to measure for building number (address) once front door is framed.

Ana Rosa-DPI Engrg.: TB-13-1833
Lucy St. (S.S.) 326' E. x Acushnet Ave.
P 132/L 346

No site plan submitted showing existing conditions and proposed utility/grading work for this site. Owner/developer must submit grading/utility plan for new house site for review by DPI Engineering.

Said site plan must show the connections, from the street to the entry points at the house foundation, for the proposed sewer, water and recharge structure to service this new dwelling and any related site regrading. Must meet the 10' required separation between water and sewer. Plan must also show proposed driveway location and size (maximum is 18' wide). Details for connections must also be called out on plan.



Commonwealth of Massachusetts

City of New Bedford

133 William Street New Bedford, MA 02740

SEWER PERMIT



Date: **2/4/2014**

No. **WW-13-40**

Sewer Connection Fee: **\$450.00**

Pipe Size: **0.00**

Trench Length: **0.00**

Service Location: **SS LUCY ST**

Owner Name: **LANGLOIS JOSEPH A**

Type of Occupancy: **Residential**

Type of Work: **Sewer - New Sewer Service**

Work Description: **sewer permit# 24368
P.132 L.346**

**Lucy St S.S. 326+/- E x Acushnet Ave
connecxted into 8in sewer into Lucy St**

No. of Units : **3** Required Design Daily Flow : **330.00** Provided Daily Flow : **0.00**

The undersigned petitions you to grant permission to ENTER INTO THE MAIN SEWER and, if such permission is granted, hereby agrees to the following:

1. To abide by the conditions and regulations imposed by the Commissioner of Public Works by statute or by ordinance now in force, or as amended from time to time.
2. That the connection of said sewer with the main sewer shall be inspected by an employee of the department of Public Works or by a designated agent of the Town before burial of said connection.
3. That the work shall at all times be under the direction and control of the Commissioner of Public Works or his authorized agent, and that any expense incurred by the Town shall be charged to the permittee, and said

permittee
agrees to reimburse the Town for said expense.

Installing Company Name: **Robert J. Canessa**

License Type: **CSL-DM
Residential
Demolition Only**

Address: **P. O. Box 51643** City/Town/State: **New Bedford MA**

Call (781) 942-9077 For Inspection

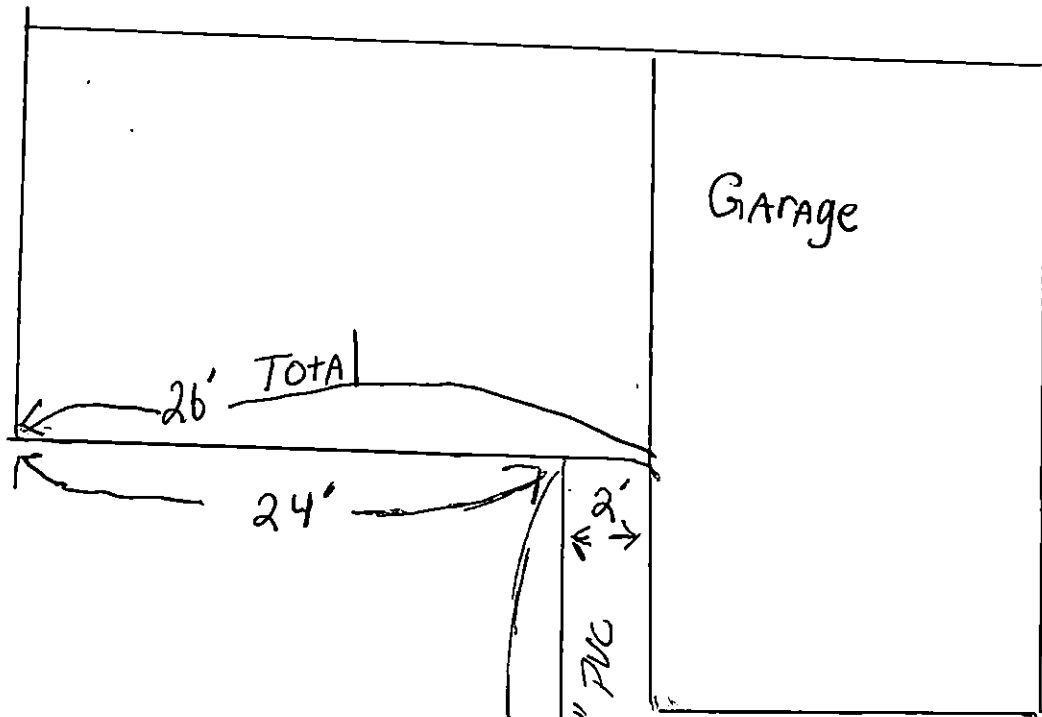

CZ

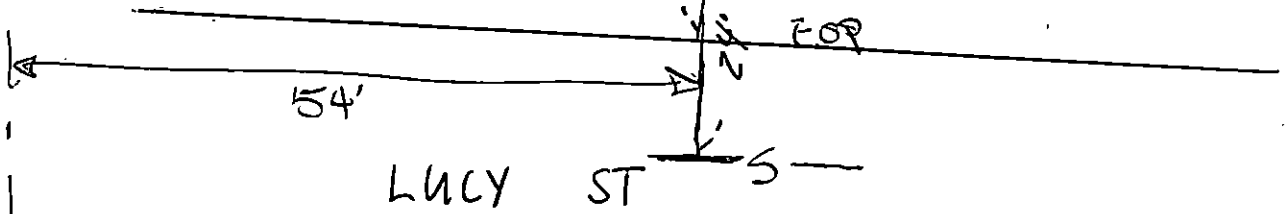

LEPAGE ST