



Expires 11/4/14

PERMIT NO.

24365

CITY OF NEW BEDFORD
SEWER AND/OR STORM DRAIN PERMIT

DATE 11/4/13

This certifies that permission is granted to

New England Marine 5 Hicks Street (508) 993-8883
Property Owner Address Tel.

To connect a sewer and/or storm drain located at 5 Hicks Street

Assessor's Plot 85 Lot 184 to the sewer and/or storm drain in 1122 Property Street

To be laid in accordance with the conditions in this application and the City of New Bedford ordinances.
TYPE OF USE: RESIDENTIAL COMMERCIAL INDUSTRIAL FLOW G.P.D.

If applicant other than actual property owner, attach Letter of Authorization from Property Owner.

Name John Folino Tel.

Mailing Address 13 Industrial Dr. Mattapoisett

The Bonded Contractor/Drain Layer authorized to perform this work is:

Name MIT Excavating Address 1403 Cedar Tel. 774-203-2943

Type of Pipe Required: SD 36" 35'

PERMIT EXPIRES ONE YEAR AFTER DATE OF ISSUE

- Requires separate connections for sewage and storm drain where applicable. Storm water cannot be discharged to a sanitary sewer.
- All work must be inspected and approved by a D.P.I. inspector before backfilling.
- If this connection is to be part of a private service shared jointly with other building owners, attach copy of Recorded Joint Maintenance Agreement.
- Permits can be issued to Industrial and/or Commercial Applicants only upon receipt and approval by the Commissioner of Public Infrastructure of required plans and supplemental information.
- In addition, a City-issued Industrial User Discharge Permit and/or a Sewer Extension/Connection Permit issued by the Commonwealth of Massachusetts D.E.P. shall be required by the City for Industrial Discharge into the sewer system.

Industrial User Discharge Permit No. Date

Comm. Mass. Sewer Conn./Ext. Permit No. Date

A Filing and Inspection Fee of \$4500 plus an Entrance Fee of \$ where applicable, must accompany this application.

Bank# Citizens Bank Check# 12175 Date 11/1/13 Receipt# 09897

Other requirements: Please call ahead 24hr notice for inspection @ (508) 999-1550 ext 820

Connection made to Sewer Part of jointly-shared private line YES NO
Storm Drain

Applicant agrees to abide by the above terms, as well as all pertinent ordinances of the City of New Bedford, and such other special rules as the Commissioner of Public Infrastructure and/or City Engineer may deem necessary

City Engineer

Signature of Property Owner or Representative

INSPECTOR'S REPORT

INSPECTED BY:

DATE:

COMMENTS:

APPROVED

DISA

SEE WHITE SHEET
SIGNATURE

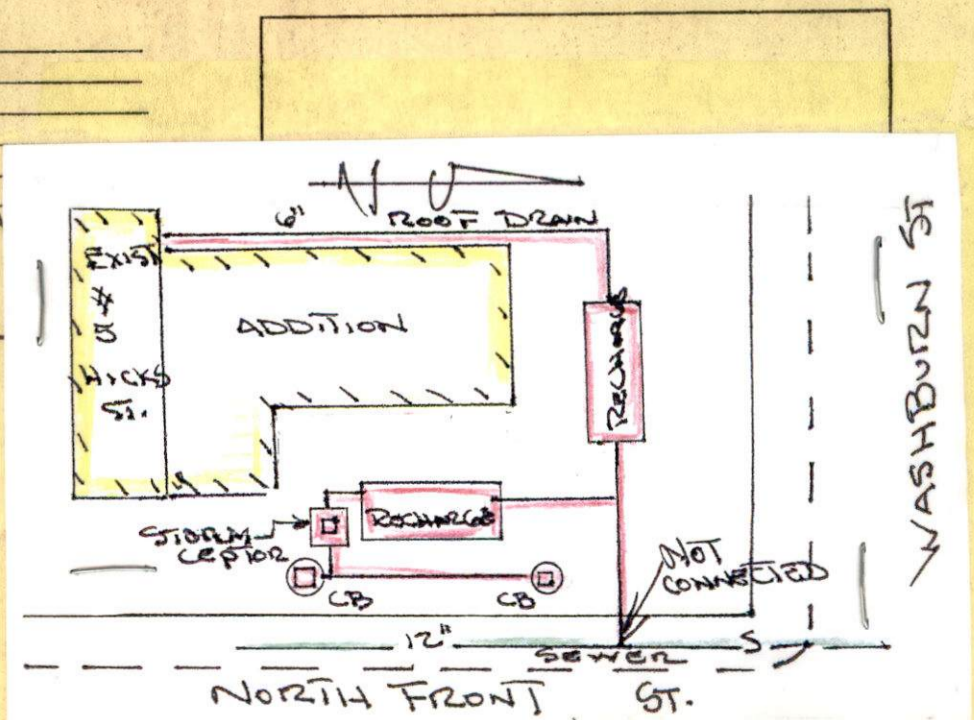



Today ~~11/11~~ 11/15
whenever you can!

Inspection Expires 11/4/14.

PERMIT NO.

24365

CITY OF NEW BEDFORD
SEWER AND/OR STORM DRAIN PERMIT

DATE 11/4/13

This certifies that permission is granted to

New England Marine 5 Hicks Street (508) 993-8883
Property Owner Engineering Address NB, MA Tel.

To connect a sewer and/or storm drain located at 5 Hicks Street

Assessor's Plot 85 Lot 184 + 182, to the sewer and/or storm drain intersecting into sewer system in sidewalk area (WEC Property) Intersection of Washburn + N Front

To be laid in accordance with the conditions in this application and the City of New Bedford ordinances.

TYPE OF USE: RESIDENTIAL COMMERCIAL INDUSTRIAL FLOW _____ G.P.D.

If applicant other than actual property owner, attach Letter of Authorization from Property Owner.

Name John Folino Tel.

Mailing Address 13 Industrial Dr Mattapoisett

The Bonded Contractor/Drain Layer authorized to perform this work is:

Name MHT Excavating Address 1213 Way Tel. 774-268-2943

Type of Pipe Required: SDR 35

PERMIT EXPIRES ONE YEAR AFTER DATE OF ISSUE

- Requires separate connections for sewage and storm drain where applicable. Storm water cannot be discharged to a sanitary sewer.
- All work must be inspected and approved by a D.P.I. inspector before backfilling.
- If this connection is to be part of a private service shared jointly with other building owners, attach copy of Recorded Joint Maintenance Agreement.
- Permits can be issued to Industrial and/or Commercial Applicants only upon receipt and approval by the Commissioner of Public Infrastructure of required plans and supplemental information.
- In addition, a City-issued Industrial User Discharge Permit and/or a Sewer Extension/Connection Permit issued by the Commonwealth of Massachusetts D.E.P. shall be required by the City for Industrial Discharge into the sewer system.

Industrial User Discharge Permit No. _____ Date _____

Comm. Mass. Sewer Conn./Ext. Permit No. _____ Date _____

A Filing and Inspection Fee of \$4500, plus an Entrance Fee of \$ _____ where applicable, must accompany this application.

Bank# Citizens Bank Check# 12175 Date 11/1/13 Receipt# 09897

Other requirements: Please call ahead 24 hr notice for

inspection @ (508) 999-1550 ext 526

Connection made to Sewer Part of jointly-shared private line YES NO

Storm Drain

Applicant agrees to abide by the above terms, as well as all pertinent ordinances of the City of New Bedford, and such other special rules as the Commissioner of Public Infrastructure and/or City Engineer may deem necessary

City Engineer

Signature of Property Owner or Representative

INSPECTOR'S REPORT

INSPECTED BY: _____

DATE: _____

COMMENTS: _____

APPROVED

DISAPPROVED

SIGNATURE

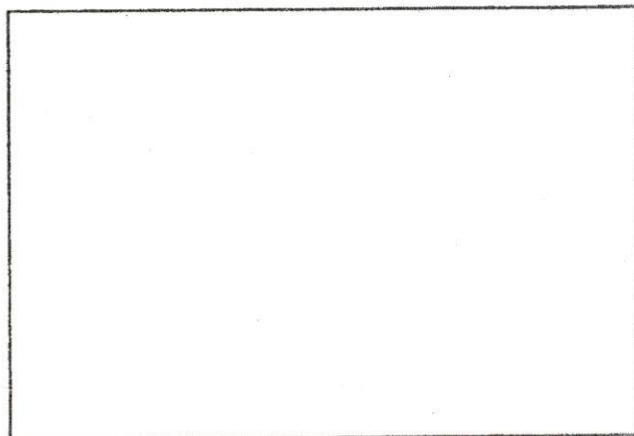

SKETCH PLAN

EXP 11/4/14



PERMIT NO.
24365

CITY OF NEW BEDFORD
SEWER AND/OR STORM DRAIN PERMIT

DATE 11/4/13

This certifies that permission is granted to

Property Owner New England Marine Engineering Address 5 Hicks Street NB, MA Tel. (508) 993-8883

To connect a sewer and/or storm drain located at 5 Hicks Street

Assessor's Plot 85 Lot 184 + 182, to the sewer and/or storm drain in fitting into sewer system in sidewalk (NEC Property) Intersection of Washington St in front

To be laid in accordance with the conditions in this application and the City of New Bedford ordinances.
TYPE OF USE: RESIDENTIAL COMMERCIAL INDUSTRIAL FLOW _____ G.P.D.

If applicant other than actual property owner, attach Letter of Authorization from Property Owner.

Name John Faling Tel. _____

Mailing Address 13 Industrial Dr Mattapoisett

The Bonded Contractor/Drain Layer authorized to perform this work is:

Name MHT Excavating Address 1215 Way Tel. 774-263-2943

Type of Pipe Required: SDR 48" 35'

PERMIT EXPIRES ONE YEAR AFTER DATE OF ISSUE

- Requires separate connections for sewage and storm drain where applicable. Storm water cannot be discharged to a sanitary sewer.
- All work must be inspected and approved by a D.P.I. inspector before backfilling.
- If this connection is to be part of a private service shared jointly with other building owners, attach copy of Recorded Joint Maintenance Agreement.
- Permits can be issued to Industrial and/or Commercial Applicants only upon receipt and approval by the Commissioner of Public Infrastructure of required plans and supplemental information.
- In addition, a City-issued Industrial User Discharge Permit and/or a Sewer Extension/Connection Permit issued by the Commonwealth of Massachusetts D.E.P. shall be required by the City for Industrial Discharge into the sewer system.

Industrial User Discharge Permit No. _____ Date _____

Comm. Mass. Sewer Conn./Ext. Permit No. _____ Date _____

A Filing and Inspection Fee of \$ 4500, plus an Entrance Fee of \$ _____ where applicable, must accompany this application.

Bank# Citizens Bank Check# 12175 Date 11/1/13 Receipt# 09897

Other requirements: Please call ahead 24hr notice for

inspection @ (508) 999-1550 ext 526

Connection made to Sewer Part of jointly-shared private line YES NO
Storm Drain

Applicant agrees to abide by the above terms, as well as all pertinent ordinances of the City of New Bedford, and such other special rules as the Commissioner of Public Infrastructure and/or City Engineer may deem necessary

[Signature]
City Engineer

[Signature]
Signature of Property Owner or Representative

INSPECTOR'S REPORT

INSPECTED BY: _____
DATE: _____
COMMENTS: _____

APPROVED _____ DISAPPROVED _____

SIGNATURE

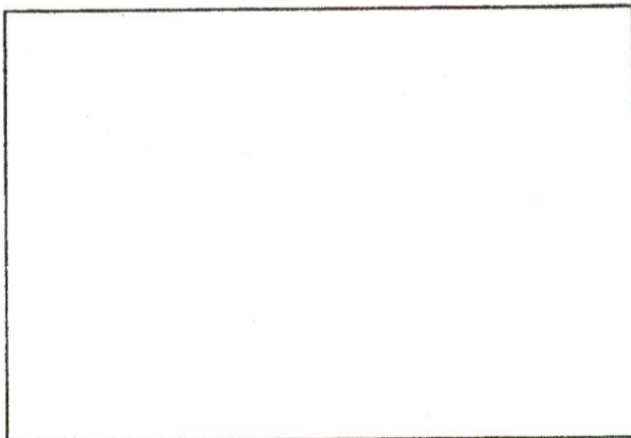

SKETCH PLAN



Department of Public Infrastructure

Ronald H. Labelle
Commissioner

CITY OF NEW BEDFORD
Jonathan Mitchell, Mayor

Water
Wastewater
Highways
Engineering
Cemeteries
Park Maintenance

To Whom It May Concern:

I Zuleika C. Vidal 5 Hicks St, New Bedford, MA, being
(Name) (Mailing Address) */ president of company.*

Owner of property located at

5 Hicks St New Bedford

Plot 85, Lot 182, 184, hereby agree to allow John W. Folino
(Name)

13 Industrial Dr, Mattapoisett, to act on my behalf including affixing my
(Mailing Address)

signature in securing permit for:

☒ Sewer/Drain Service Permits
☐ Water Service Permits
☒ Driveway Installation Permits
☒ Sidewalk Installation Permits

I further agree to conform to, and abide by, All City rules and ask regulations applicable to the permit (s) being applied for:

Name Zuleika C Vidal
Signature
5 Hicks Street New Bedford, MA
Address 02740
10/31/2013 508-993-8883
Date Telephone number



Commonwealth of Massachusetts

City of New Bedford

133 William Street New Bedford, MA 02740

SEWER PERMIT



Date: **2/4/2014**

No. **WW-13-39**

Sewer Connection Fee: **\$450.00**

Pipe Size: **0.00**

Trench Length: **0.00**

Service Location: **5 HICKS ST**

Owner Name: **NEW ENGLAND MARINE**

Type of Occupancy: **Commercial**

Type of Work: **Sewer - New Sewer Service**

Work Description: **sewer permit# 243
P.85 L.184+182**

5 Hicks Street

**tying into sewer system in sidewalk area
NEC property intersection of Washburn + N.Front St**

No. of Units : **0** Required Design Daily Flow : **0.00** Provided Daily Flow : **0.00**

The undersigned petitions you to grant permission to ENTER INTO THE MAIN SEWER and, if such permission is granted, hereby agrees to the following:

1. To abide by the conditions and regulations imposed by the Commissioner of Public Works by statute or by ordinance now in force, or as amended from time to time.
2. That the connection of said sewer with the main sewer shall be inspected by an employee of the department of Public Works or by a designated agent of the Town before burial of said connection.
3. That the work shall at all times be under the direction and control of the Commissioner of Public Works or his authorized agent, and that any expense incurred by the Town shall be charged to the permittee, and said

permittee
agrees to reimburse the Town for said expense.

Installing Company Name: **MHT EXCAVATING**

License Type: **DPI - Other**

Address: **1 LIL'S WAY**

City/Town/State: **MATTAPOISETT**

MA

Call (781) 942-9077 For Inspection