



PERMIT NO.
24364

CITY OF NEW BEDFORD
SEWER AND/OR STORM DRAIN PERMIT

DATE 10/25/13
expires: 10/25/14

This certifies that permission is granted to

Long Built Homes 158 McConkey Blvd (508) 965-3579
Property Owner Address Tel.

To connect a sewer and/or storm drain located at 52 Tarklin Place

Assessor's Plot 1306 Lot 244, to the sewer and/or storm drain in Tarklin Place 8" man Street

To be laid in accordance with the conditions in this application and the City of New Bedford ordinances.

TYPE OF USE: RESIDENTIAL COMMERCIAL INDUSTRIAL FLOW 330 G.P.D.

If applicant other than actual property owner, attach Letter of Authorization from Property Owner.

Name..... Tel.....

Mailing Address.....

The Bonded Contractor/Drain Layer authorized to perform this work is:

Name DW White Address Department Tel.

Type of Pipe Required: SDM PVC 35"

PERMIT EXPIRES ONE YEAR AFTER DATE OF ISSUE

- Requires separate connections for sewage and storm drain where applicable. Storm water cannot be discharged to a sanitary sewer.
- All work must be inspected and approved by a D.P.I. inspector before backfilling.
- If this connection is to be part of a private service shared jointly with other building owners, attach copy of Recorded Joint Maintenance Agreement.
- Permits can be issued to Industrial and/or Commercial Applicants only upon receipt and approval by the Commissioner of Public Infrastructure of required plans and supplemental information.
- In addition, a City-issued Industrial User Discharge Permit and/or a Sewer Extension/Connection Permit issued by the Commonwealth of Massachusetts D.E.P. shall be required by the City for Industrial Discharge into the sewer system.

Industrial User Discharge Permit No..... Date.....

Comm. Mass. Sewer Conn./Ext. Permit No..... Date.....

A Filing and Inspection Fee of \$....., plus an Entrance Fee of \$..... where applicable, must accompany this application.

Bank# Bay Coast Bank Check# 8739 Date 10/25/13 Receipt# 09885

Other requirements: Please call ahead 24 hr notice for impda

@ (508) 979-1500 ext 5720

Connection made to Sewer Part of jointly-shared private line YES NO
Storm Drain

Applicant agrees to abide by the above terms, as well as all pertinent ordinances of the City of New Bedford, and such other special rules as the Commissioner of Public Infrastructure and/or City Engineer may deem necessary

[Signature]
City Engineer

[Signature]
Signature of Property Owner or Representative

INSPECTOR'S REPORT

INSPECTED BY: SEE WHITE SHEET

DATE: _____

COMMENTS: _____

APPROVED

DISAP

SIGNATURE

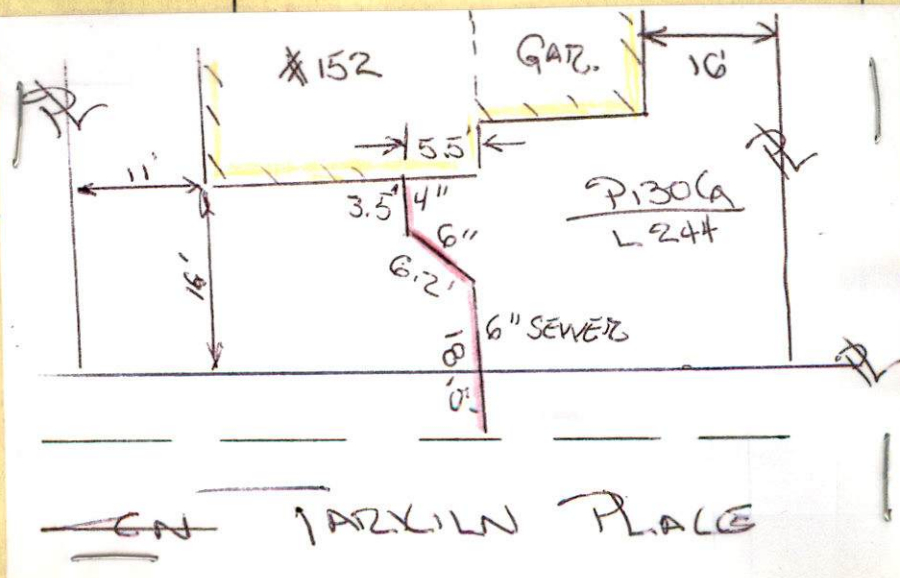

www-13-33.

Pending



PERMIT NO.
24364

CITY OF NEW BEDFORD
SEWER AND/OR STORM DRAIN PERMIT

DATE 10/25/13
expires 10/25/14

This certifies that permission is granted to

Property Owner Long Built Homes Address 158 McCombs Blvd Tel. (508) 968-3579
NB MA 02745

To connect a sewer and/or storm drain located at 52 Tarklin Place

Assessor's Plot 1306 Lot 244 to the sewer and/or storm drain in Tarklin Place 8" main - Street

To be laid in accordance with the conditions in this application and the City of New Bedford ordinances.

TYPE OF USE: RESIDENTIAL COMMERCIAL INDUSTRIAL FLOW 330 G.P.D.

If applicant other than actual property owner, attach Letter of Authorization from Property Owner.

Name N/A Tel. _____

Mailing Address _____

The Bonded Contractor/Drain Layer authorized to perform this work is:

Name DW White Address Development Tel. _____

Type of Pipe Required: SDM PVC 35"

PERMIT EXPIRES ONE YEAR AFTER DATE OF ISSUE

- Requires separate connections for sewage and storm drain where applicable. Storm water cannot be discharged to a sanitary sewer.
- All work must be inspected and approved by a D.P.I. inspector before backfilling.
- If this connection is to be part of a private service shared jointly with other building owners, attach copy of Recorded Joint Maintenance Agreement.
- Permits can be issued to Industrial and/or Commercial Applicants only upon receipt and approval by the Commissioner of Public Infrastructure of required plans and supplemental information.
- In addition, a City-issued Industrial User Discharge Permit and/or a Sewer Extension/Connection Permit issued by the Commonwealth of Massachusetts D.E.P. shall be required by the City for Industrial Discharge into the sewer system.

Industrial User Discharge Permit No. _____ Date _____

Comm. Mass. Sewer Conn./Ext. Permit No. _____ Date _____

A Filing and Inspection Fee of \$ 450.00, plus an Entrance Fee of \$ _____ where applicable, must accompany this application.

Bank# BayCoast Bank Check# 8739 Date 10/25/13 Receipt# 09885

Other requirements: Please call ahead 24 hr notice for unpe dta

@ (508) 979-1550 ext 506

Connection made to Sewer Part of jointly-shared private line YES NO
Storm Drain

Applicant agrees to abide by the above terms, as well as all pertinent ordinances of the City of New Bedford, and such other special rules as the Commissioner of Public Infrastructure and/or City Engineer may deem necessary

[Signature]
City Engineer

[Signature] for
Signature of Property Owner or Representative
Long Built Homes Inc.

INSPECTOR'S REPORT

INSPECTED BY: _____
DATE: _____
COMMENTS: _____

APPROVED _____ DISAPPROVED _____

SIGNATURE

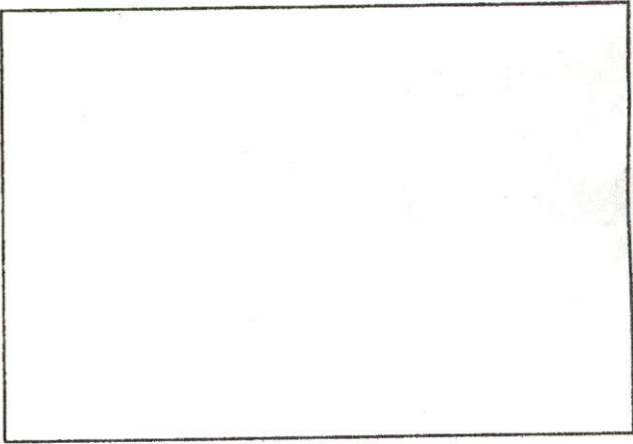

SKETCH PLAN

Inspection: Tuesday
NOV 12 @ 9:00am

Inspector



PERMIT NO.
24364

CITY OF NEW BEDFORD
SEWER AND/OR STORM DRAIN PERMIT

DATE 10/25/13
expires: 10/25/14

This certifies that permission is granted to

long Built Homes 158 McCombs Blvd (SOS) 965-3579
Property Owner Address NB MA 02745 Tel.

To connect a sewer and/or storm drain located at 52 Tarklin Place

Assessor's Plot 1306 Lot 244, to the sewer and/or storm drain in Tarklin Place 8" main Street

To be laid in accordance with the conditions in this application and the City of New Bedford ordinances.

TYPE OF USE: RESIDENTIAL COMMERCIAL INDUSTRIAL FLOW 330 G.P.D.

If applicant other than actual property owner, attach Letter of Authorization from Property Owner.

Name Tel.

Mailing Address N/A

The Bonded Contractor/Drain Layer authorized to perform this work is:

Name DW White Address Development Tel.

Type of Pipe Required: SDm PVC 35"

PERMIT EXPIRES ONE YEAR AFTER DATE OF ISSUE

- Requires separate connections for sewage and storm drain where applicable. Storm water cannot be discharged to a sanitary sewer.
 - All work must be inspected and approved by a D.P.I. inspector before backfilling.
 - If this connection is to be part of a private service shared jointly with other building owners, attach copy of Recorded Joint Maintenance Agreement.
 - Permits can be issued to Industrial and/or Commercial Applicants only upon receipt and approval by the Commissioner of Public Infrastructure of required plans and supplemental information.
 - In addition, a City-issued Industrial User Discharge Permit and/or a Sewer Extension/Connection Permit issued by the Commonwealth of Massachusetts D.E.P. shall be required by the City for Industrial Discharge into the sewer system.
- Industrial User Discharge Permit No. Date

Comm. Mass. Sewer Conn./Ext. Permit No. Date

A Filing and Inspection Fee of \$450.00 plus an Entrance Fee of \$ where applicable, must accompany this application.

Bank# Bay Coast Bank Check# 8739 Date 10/25/13 Receipt# 09885

Other requirements: Please call ahead 24 hr notice for inspection

@ (SOS) 979-1550 ext 506

Connection made to Sewer Part of jointly-shared private line YES NO
Storm Drain

Applicant agrees to abide by the above terms, as well as all pertinent ordinances of the City of New Bedford, and such other special rules as the Commissioner of Public Infrastructure and/or City Engineer may deem necessary

City Engineer

Signature of Property Owner or Representative
Long Built Homes Inc.

INSPECTOR'S REPORT

INSPECTED BY: DATE: 11/12/13
COMMENTS:

APPROVED

DISAPPROVED

SIGNATURE

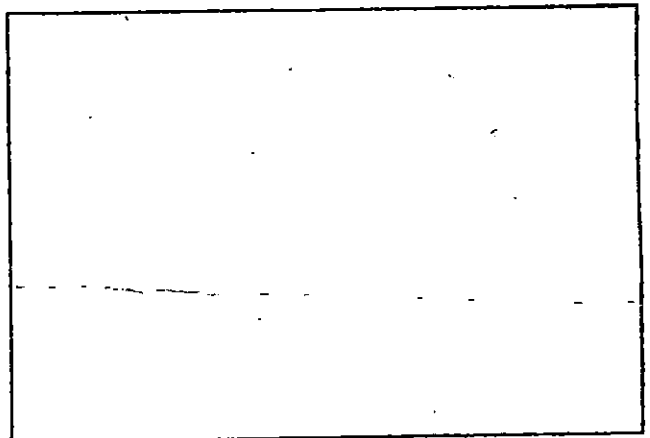

SKETCH PLAN



Department of Public Infrastructure

Ronald H. Labelle
Commissioner

CITY OF NEW BEDFORD

Jonathan F. Mitchell, Mayor

Water
Wastewater
Highways
Engineering
Cemetery

To Whom It May Concern:

Long Built Homes, Inc., having a mailing address
X of 158 C. McCombs Blvd., New Bedford, MA 02745, being
(Name) (Mailing Address)

Owner of property located at

152 Tarkiln Place

Plot 130G, Lot 244, hereby agree to allow Lee Castignetti and/or
a/o Long Built Homes, Inc. Tony Sbardella
158 C. McCombs Blvd. to act on my behalf including affixing my
(Mailing Address) New Bedford, MA 02745
signature in securing permit for:

☒ Sewer/Drain Service Permits
☒ Water Service Permits
☒ Driveway Installation Permits
☒ Sidewalk Installation Permits

I further agree to conform to, and abide by, All City rules and ask regulations applicable to the permit (s) being applied for:

Long Built Homes, Inc.
Name By: Robert F. Long
Signature Robert F. Long, President
158 C. McCombs Blvd., New Bedford, MA 02745
Address
10/14/13 Date 508-245-3161 Telephone number



Commonwealth of Massachusetts

CITY OF NEW BEDFORD

City Hall, Room 308, 133 William Street New Bedford, MA 02740 (508) 979-1540



FOUNDATION PERMIT

No. **B-13-1989**

10/11/2013

MSBC Sect. 111.8 - Any permit issued shall be deemed abandoned and invalid unless the work authorized by it shall have been commenced within six (6) months after its issuance.

FEE PAID \$**Error**

This certifies that **LONG BUILT HOMES INC**

owner/contractor has permission to:

152

TARKILN PL

on: **Foundations Only 1-2 Family - 100.00**

Providing that the person accepting this permit shall in every respect conform to the terms of application therefore on file in this office; to the provisions of the statute of the Commonwealth and to the by-laws of the City of New Bedford relating to the inspection, erection, enlarging, altering, raising, moving, repairing, or tearing down of a building.

Permit is issued subject to the following special requirements: (Restrictions)



Wiring Inspector



Plumbing Inspector



Building Inspector

YOUR AREA INSPECTOR IS: **Thomas Welch**

Tel. (508) 979-1540 Between 8:00am - 9:00am

**NOTICE: NOTIFY INSPECTOR 48 HOURS IN
ADVANCE OF APPLYING SHEATHING OR LATHING**

OCCUPANCY PERMIT REQUIRED BEFORE OCCUPANCY

No Building or Structure shall be used or occupied until the Certificate of Use and Occupancy shall have been issued by the Building Commissioner - MSBC, Sect. 120.1

This Card Must Be Displayed in a Conspicuous Place on the Premises and Not Torn Down or Removed Until Completion of Work

SUBJECT TO MASSACHUSETTS
STATE BUILDING CODE

Building Inspector

Plan Review Comments: :

NEW HOME: NOTE: NEED ELECTRICIAN ALONG WITH ELECTRICAL PERMIT ATTACHED HERE.

DPI: Owner to apply for a water permit

Ana Rosa-D.P.I. Engrg.: TB-13-1989

Tarkiln Place (ES) 405' S. x Mate Drive (N.)

- 1.) The correct address for the new home will be 152 Tarkiln Place (Plot 130G Lot 244).
- 2.) To be built in accordance with approved Subdivision Plans.
- 3.) Must provide 3 copies of site plan showing proposed water, sewer/storm drain (recharge structure) and driveway, copy of the foundation permit and stamped as-built plan.

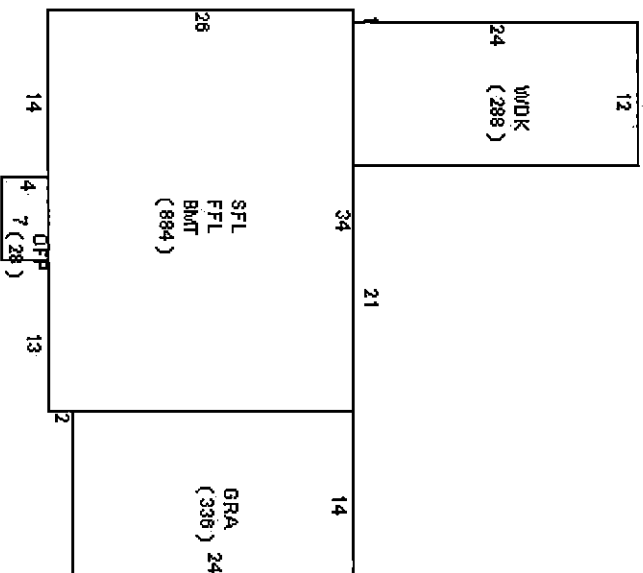

DISPLAY PERMIT IN A CONSPICUOUS PLACE ON THE PREMISES



Commonwealth of Massachusetts

City of New Bedford

133 William Street New Bedford, MA 02740

SEWER PERMIT



Date: **11/22/2013**

No. **WW-13-33**

Sewer Connection Fee: **\$450.00**

Pipe Size: **0.00**

Trench Length: **0.00**

Service Location: **152 TARKILN PL**

Owner Name: **LONG BUILT HOMES INC**

Type of Occupancy: **Residential**

Type of Work: **Sewer - New Sewer Service**

Work Description: **sewer-24364**

**152 Tarkiln Place
P.130G L.244**

tying into sewer on Tarkilkn Place 8" main

No. of Units : **3** Required Design Daily Flow : **330.00** Provided Daily Flow : **0.00**

The undersigned petitions you to grant permission to ENTER INTO THE MAIN SEWER and, if such permission is granted, hereby agrees to the following:

1. To abide by the conditions and regulations imposed by the Commissioner of Public Works by statute or by ordinance now in force, or as amended from time to time.
2. That the connection of said sewer with the main sewer shall be inspected by an employee of the department of Public Works or by a designated agent of the Town before burial of said connection.
3. That the work shall at all times be under the direction and control of the Commissioner of Public Works or his authorized agent, and that any expense incurred by the Town shall be charged to the permittee, and said

permittee

agrees to reimburse the Town for said expense.

Installing Company Name: **DW White**

License Type: **CSL-00
Unrestricted**

Address: **867 Middle Road** City/Town/State: **Acushnet MA**

Call (781) 942-9077 For Inspection

24

11/11/13
11/12/13

100055

(14)

151 # 244

