



PERMIT NO.

24356

CITY OF NEW BEDFORD
SEWER AND/OR STORM DRAIN PERMIT

DATE

9/13/13

This certifies that permission is granted to

Property Owner

Address

Tel.

To connect a sewer and/or storm drain located at

Assessor's Plot 125B Lot 147, to the sewer and/or storm drain in

To be laid in accordance with the conditions in this application and the City of New Bedford ordinances.

TYPE OF USE: RESIDENTIAL COMMERCIAL INDUSTRIAL FLOW G.P.D.

If applicant other than actual property owner, attach Letter of Authorization from Property Owner.

Name

Mailing Address

The Bonded Contractor/Drain Layer authorized to perform this work is:

Name

Address

Tel.

Type of Pipe Required:

PERMIT EXPIRES ONE YEAR AFTER DATE OF ISSUE

- Requires separate connections for sewage and storm drain where applicable. Storm water cannot be discharged to a sanitary sewer.
- All work must be inspected and approved by a D.P.I. inspector before backfilling.
- If this connection is to be part of a private service shared jointly with other building owners, attach copy of Recorded Joint Maintenance Agreement.
- Permits can be issued to Industrial and/or Commercial Applicants only upon receipt and approval by the Commissioner of Public Infrastructure of required plans and supplemental information.
- In addition, a City-issued Industrial User Discharge Permit and/or a Sewer Extension/Connection Permit issued by the Commonwealth of Massachusetts D.E.P. shall be required by the City for Industrial Discharge into the sewer system.

Industrial User Discharge Permit No. Date

Comm. Mass. Sewer Conn./Ext. Permit No. Date

A Filing and Inspection Fee of \$980, plus an Entrance Fee of \$980, where applicable, must accompany this application.

Bank# North Shore Bank Check# 21359 - permit Date 9/13/13 Receipt# 09805

Other requirements: 24hr notice for inspection @ 9:00 AM - 1:00 PM, must be with DEP permit. Also, a copy of the DEP permit must be submitted to the City Engineer. The connection must be witnessed by the City Engineer. The connection must be made to the main line sewer. The connection must be made to the main line sewer. The connection must be made to the main line sewer.

Connection made to Sewer Part of jointly-shared private line YES NO
Storm Drain

Applicant agrees to abide by the above terms, as well as all pertinent ordinances of the City of New Bedford, and such other special rules as the Commissioner of Public Infrastructure and/or City Engineer may deem necessary

City Engineer

Signature of Property Owner or Representative

INSPECTOR'S REPORT

INSPECTED BY: _____
DATE: _____
COMMENTS: _____

APPROVED

DIS

SIGNATURE

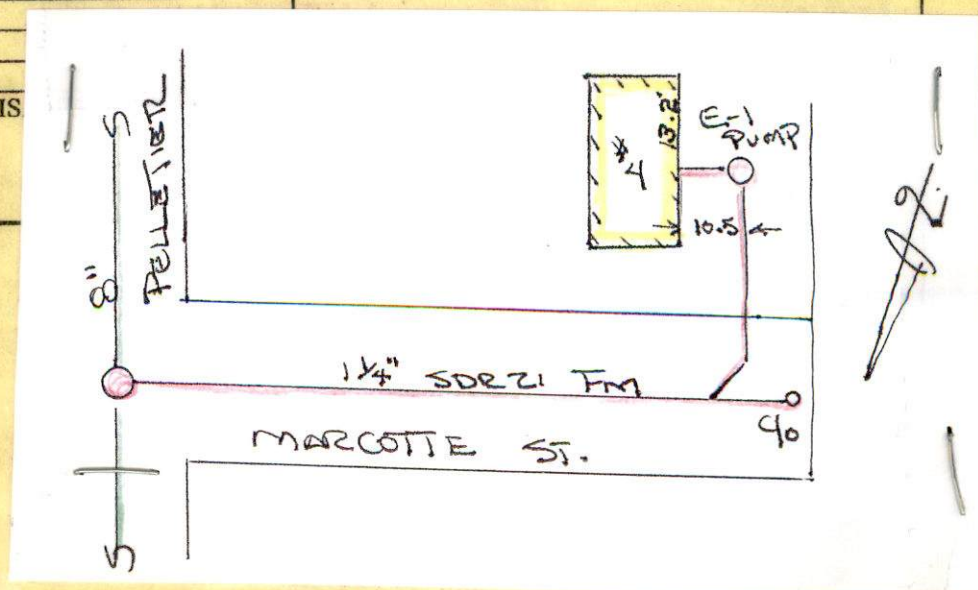

Extension



Inspection: Thur Jan 16 @ 10:00am

Inspector Expires 9/13/14

PERMIT NO.
24356

CITY OF NEW BEDFORD
SEWER AND/OR STORM DRAIN PERMIT

DATE 9/13/13

This certifies that permission is granted to

Plot 10
Property Owner DI School Invest BS Address Limerick Wall Easton, MA 01922 Tel. (508) 237-2797

To connect a sewer and/or storm drain located at 8 inch sewer on Pelletier St

Assessor's Plot 125B Lot 147, to the sewer and/or storm drain in main - (4) Marcotte St Street

To be laid in accordance with the conditions in this application and the City of New Bedford ordinances.

TYPE OF USE: RESIDENTIAL COMMERCIAL INDUSTRIAL FLOW _____ G.P.D.

If applicant other than actual property owner, attach Letter of Authorization from Property Owner.

Name DI School Investment Removal Tel. 781-596-9594

Mailing Address _____

The Bonded Contractor/Drain Layer authorized to perform this work is:

Name Unlimited + Demo Address 41 Munroe Street Tel. 781-596-0594

Type of Pipe Required: 1 1/4 SDR 21 (Force Main)

PERMIT EXPIRES ONE YEAR AFTER DATE OF ISSUE

- Requires separate connections for sewage and storm drain where applicable. Storm water cannot be discharged to a sanitary sewer.
 - All work must be inspected and approved by a D.P.I. inspector before backfilling.
 - If this connection is to be part of a private service shared jointly with other building owners, attach copy of Recorded Joint Maintenance Agreement.
 - Permits can be issued to Industrial and/or Commercial Applicants only upon receipt and approval by the Commissioner of Public Infrastructure of required plans and supplemental information.
 - In addition, a City-issued Industrial User Discharge Permit and/or a Sewer Extension/Connection Permit issued by the Commonwealth of Massachusetts D.E.P. shall be required by the City for Industrial Discharge into the sewer system.
- Industrial User Discharge Permit No. _____ Date _____

Comm. Mass. Sewer Conn./Ext. Permit No. _____ Date _____

A Filing and Inspection Fee of \$ 450, plus an Entrance Fee of \$ 980 where applicable, must accompany this application.

Bank# North Shore Bank Check# 21464 - entrance fee Date 9/13/13 Receipt# 09805

Other requirements: 24hr notice for inspection @ SOS 979-1550 must be filed with DEP Rep WP 72
complete certification for sewer extensions 210001 cap printed with sewer permit
must be pressure tested before service can be tied into main - must
be witnessed by DPL Engineering call to coordinate @ SOS 979-1550 ext 526

Connection made to _____ Part of jointly-shared private line YES NO
Storm Drain

Applicant agrees to abide by the above terms, as well as all pertinent ordinances of the City of New Bedford, and such other special rules as the Commissioner of Public Infrastructure and/or City Engineer may deem necessary

Vernon M. Amadio
City Engineer
Clerk of the Works

[Signature]
Signature of Property Owner or Representative

INSPECTOR'S REPORT

INSPECTED BY: [Signature]
DATE: 3/18/14
COMMENTS: _____

APPROVED DISAPPROVED

[Signature]
SIGNATURE

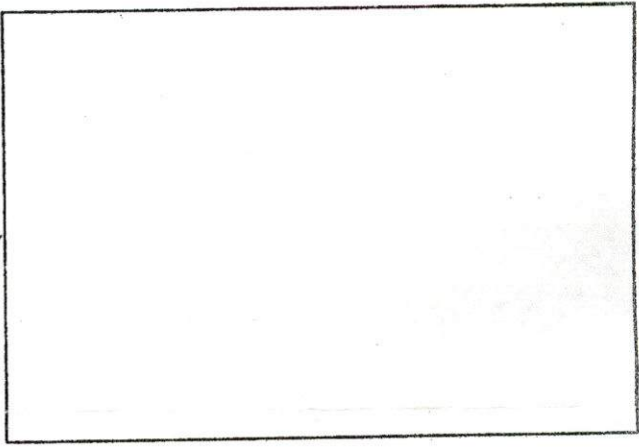

SKETCH PLAN

Extension



#24356

Expires 9/13/14

PERMIT NO.
24356

CITY OF NEW BEDFORD
SEWER AND/OR STORM DRAIN PERMIT

DATE 9/13/13

This certifies that permission is granted to

Property Owner DT School Invest. BS Address Limerick Wall Eastham, MA 02542 Tel. (508) 237-2797

To connect a sewer and/or storm drain located at 8 inch sewer on Pelletier St
Assessor's Plot 125B Lot 147 to the sewer and/or storm drain in Main - (4) Marcotte St Street

To be laid in accordance with the conditions in this application and the City of New Bedford ordinances.
TYPE OF USE: RESIDENTIAL COMMERCIAL INDUSTRIAL FLOW _____ G.P.D.

If applicant other than actual property owner, attach Letter of Authorization from Property Owner.
Name DT School Invest. BS Address Eastham, MA Tel. 781-596-9594

Mailing Address _____
The Bonded Contractor/Drain Layer authorized to perform this work is:

Name Unregistered + Demo Address 41 Monroe Street Tel. 781-596-9594
Type of Pipe Required: 1 1/4 SDR 21 (Force Main)

Sewer main
$$\begin{array}{r} 245' \\ 4 \\ \hline \$980 \end{array}$$

\$450.00
\$980.00

\$1430.00

Water main
~~225' x 4 = \$900.00~~

in where applicable. Storm water cannot be discharged to a
spectator before backfilling.
If jointly with other building owners, attach copy of Recorded
applicants only upon receipt and approval by the Commissioner of
information.
mit and/or a Sewer Extension/Connection Permit issued by the
ed by the City for Industrial Discharge into the sewer system.
Date _____

Date _____
e of \$980 where applicable, must accompany this application.
Date 9/13/13 Receipt# 09805

@ SOS 979-1550 must take with DEP PPP WP 7
can be tied into main - must
cell to coordinate @ SOS 979-1550 ext 326
ed private line YES NO

all pertinent ordinances of the City of New Bedford, and such
tructure and/or City Engineer may deem necessary

X
Signature of Property Owner or Representative

FOR'S REPORT

+450.

DATE: _____
COMMENTS: _____

APPROVED _____ DISAPPROVED _____

SIGNATURE

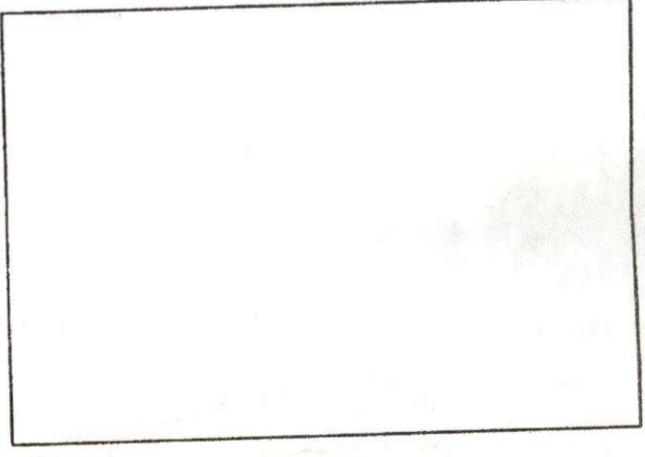

SKETCH PLAN



CITY OF NEW BEDFORD
Jonathan Mitchell, Mayor

Department of Public Infrastructure

Ronald H. Labelle
Commissioner

Water
Wastewater
Highways
Engineering
Cemeteries
Park Maintenance

To Whom It May Concern:

I DJ SCHOLL, INVESTMENT CAPITAL, being
(Name) (Mailing Address)

Owner of property located at

4 MARCOTTE ST

Plot _____, Lot _____, hereby agree to allow UNLIMITED REMOVAL
(Name) Demolition
49 Monroe St Lynn 01901, to act on my behalf including affixing my
(Mailing Address)

signature in securing permit for:

☒ Sewer/Drain Service Permits
☒ Water Service Permits
☒ Driveway Installation Permits
☒ Sidewalk Installation Permits

I further agree to conform to, and abide by, All City rules and ask regulations applicable to the permit (s) being applied for:

Name DJ Scholl, INVESTMENT CAPITAL COMMERCIAL MORTGAGE, LLC MANAGER
Signature
Address 35 LIMERICK WAY
EASTHAM, MA 02642
Date 8/20/13 Telephone number CELL 508-237-2797

MARCOVICS ST.

3/18/14

(12)

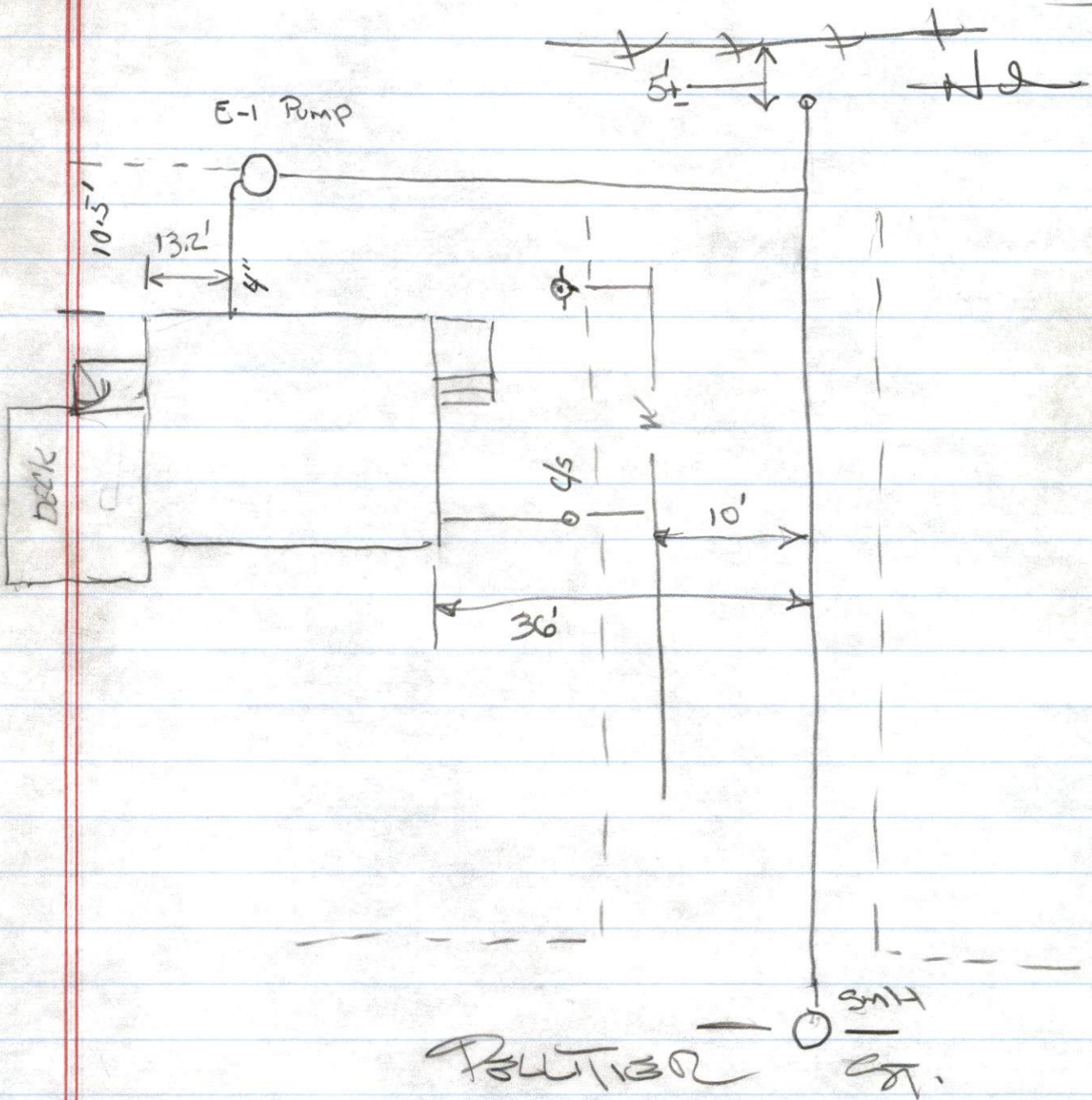

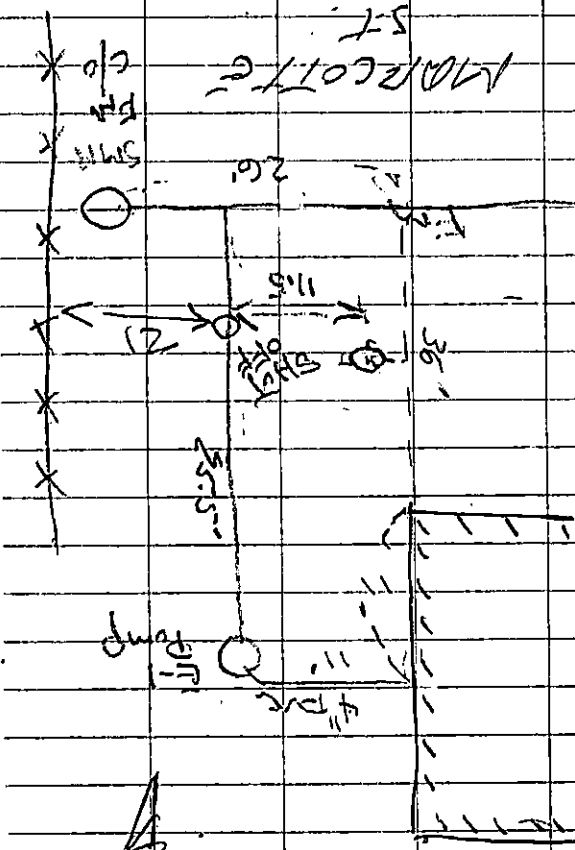

12/18/14 MARCOIT ST. (23)
 1/5/14 CLEAN/OIL MY - OILY (23)
 1/2/14 BACKHOE OIL - (23)
 Note: 5M COVER + FLAME CHANGED
 TO 26" IN ST. + 500 CUB. YD. FILLING!

12/18/14 Potomac St. (23)
 POLICE TRAFFIC
 BOB BOHAR
 K. D. BOWNE - STAMP WORK
 FORMS
 7:10 AM. LUNCH.
 CLOTHES, AND
 SPREADING ROOM AROUND
 SIDEWALK AREA
 1 - CRASH
 1 - TRUCK
 1 - TRUCK
 1 - TRUCK