



Expires 7/30/14

PERMIT NO.  
**24349**

CITY OF NEW BEDFORD  
SEWER AND/OR STORM DRAIN PERMIT

DATE 7/30/13

This certifies that permission is granted to

Property Owner Paul Bennett Address 304 Highland St New Bedford MA Tel. (508) 995-9674

To connect a sewer and/or storm drain located at Sharon St (N.S.) 122 1/2 E. Acushnet Avenue

Assessor's Plot 137A Lot 425, to the sewer and/or storm drain in 8" Sewer on Sharon Street

To be laid in accordance with the conditions in this application and the City of New Bedford ordinances.

TYPE OF USE: RESIDENTIAL COMMERCIAL INDUSTRIAL FLOW 330 G.P.D.

If applicant other than actual property owner, attach Letter of Authorization from Property Owner.

Name Suzanne Tel. (508) 995-9674

Mailing Address 32 Nye Avenue Acushnet MA 02743

The Bonded Contractor/Drain Layer authorized to perform this work is:

H.P. Conessa P.O. Box 21643 Tel. (508) 998-3404

Name Address Tel.

Type of Pipe Required: SPM 35 PVC

PERMIT EXPIRES ONE YEAR AFTER DATE OF ISSUE

- Requires separate connections for sewage and storm drain where applicable. Storm water cannot be discharged to a sanitary sewer.
  - All work must be inspected and approved by a D.P.I. inspector before backfilling.
  - If this connection is to be part of a private service shared jointly with other building owners, attach copy of Recorded Joint Maintenance Agreement.
  - Permits can be issued to Industrial and/or Commercial Applicants only upon receipt and approval by the Commissioner of Public Infrastructure of required plans and supplemental information.
  - In addition, a City-issued Industrial User Discharge Permit and/or a Sewer Extension/Connection Permit issued by the Commonwealth of Massachusetts D.E.P. shall be required by the City for Industrial Discharge into the sewer system.
- Industrial User Discharge Permit No. \_\_\_\_\_ Date \_\_\_\_\_

Comm. Mass. Sewer Conn./Ext. Permit No. \_\_\_\_\_ Date \_\_\_\_\_

A Filing and Inspection Fee of \$ 450.00, plus an Entrance Fee of \$ \_\_\_\_\_ where applicable, must accompany this application.

Bank# Bank of America Check# 1033 Date 7/30/13 Receipt# 10144

Other requirements: Please call ahead 24 hr notice for inspection @

(508) 999-1150 ext 500

Connection made to Sewer Part of jointly-shared private line YES NO  
Storm Drain

Applicant agrees to abide by the above terms, as well as all pertinent ordinances of the City of New Bedford, and such other special rules as the Commissioner of Public Infrastructure and/or City Engineer may deem necessary

Norman Amado  
City Engineer

Rep. Suzanne Bennett  
Signature of Property Owner or Representative

INSPECTOR'S REPORT

INSPECTED BY: \_\_\_\_\_  
DATE: \_\_\_\_\_  
COMMENTS: \_\_\_\_\_

INSPECTOR'S REPORT

APPROVED \_\_\_\_\_ DISAP \_\_\_\_\_

SIGNATURE \_\_\_\_\_

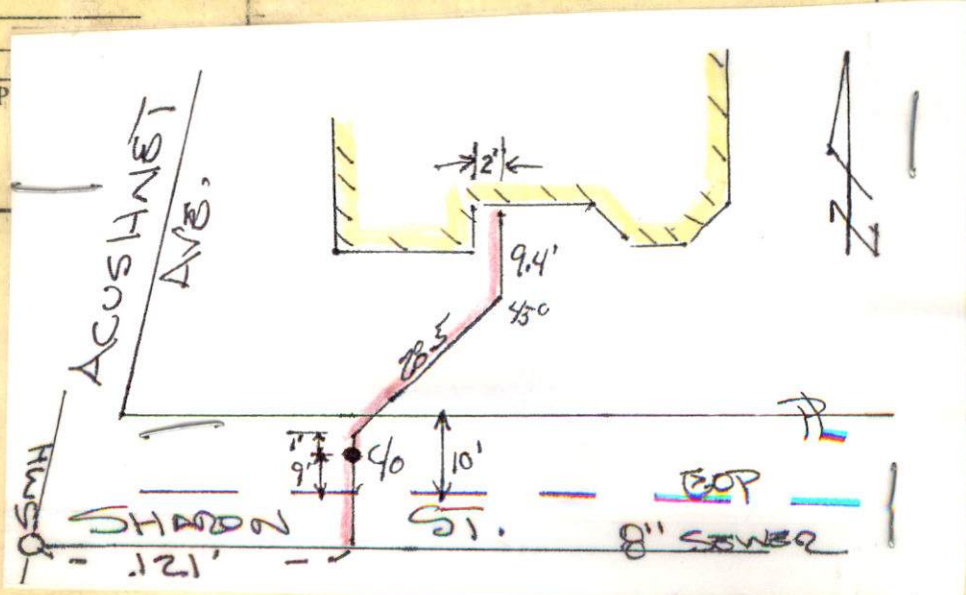





Inspection Tuesday  
8/27/13 @ 11:00

Expires 7/30/14.  
Inspector

PERMIT NO.  
24349

CITY OF NEW BEDFORD  
SEWER AND/OR STORM DRAIN PERMIT

DATE 7/30/13

This certifies that permission is granted to

Paul Bennett 304 Upland St (508) 995-9674  
Property Owner Address New Bedford MA Tel.

To connect a sewer and/or storm drain located at Sharon St (U.S.) 120' E. Cicushet Avenue.

Assessor's Plot 137A Lot 425, to the sewer and/or storm drain in Siphon Sewer on Sharon Street

To be laid in accordance with the conditions in this application and the City of New Bedford ordinances.

TYPE OF USE: RESIDENTIAL COMMERCIAL INDUSTRIAL FLOW 330 G.P.D.

If applicant other than actual property owner, attach Letter of Authorization from Property Owner.

Name Suzanne Ellis Tel. (508) 995-9674

Mailing Address 32 Nye Avenue, Cicushet MA 02743

The Bonded Contractor/Drain Layer authorized to perform this work is:

Dr. Conessa P.O. Box 61643 (508) 998-3404

Name Address Tel.

Type of Pipe Required: SPM 35 PV a

PERMIT EXPIRES ONE YEAR AFTER DATE OF ISSUE

- Requires separate connections for sewage and storm drain where applicable. Storm water cannot be discharged to a sanitary sewer.
  - All work must be inspected and approved by a D.P.I. inspector before backfilling.
  - If this connection is to be part of a private service shared jointly with other building owners, attach copy of Recorded Joint Maintenance Agreement.
  - Permits can be issued to Industrial and/or Commercial Applicants only upon receipt and approval by the Commissioner of Public Infrastructure of required plans and supplemental information.
  - In addition, a City-issued Industrial User Discharge Permit and/or a Sewer Extension/Connection Permit issued by the Commonwealth of Massachusetts D.E.P. shall be required by the City for Industrial Discharge into the sewer system.
- Industrial User Discharge Permit No. .... Date .....

Comm. Mass. Sewer Conn./Ext. Permit No. .... Date .....

A Filing and Inspection Fee of \$450.00, plus an Entrance Fee of \$..... where applicable, must accompany this application.

Bank# Bank of America Check# 1033 Date 7/30/13 Receipt# 10144

Other requirements: Please call ahead 24 hr notice for inspection @

(508) 929-1550 ext 506

Connection made to Sewer Part of jointly-shared private line YES NO  
Storm Drain

Applicant agrees to abide by the above terms, as well as all pertinent ordinances of the City of New Bedford, and such other special rules as the Commissioner of Public Infrastructure and/or City Engineer may deem necessary

Armando Amado  
City Engineer  
Clock of the Works

Rep: Dyane R. Ellis  
Signature of Property Owner or Representative

INSPECTOR'S REPORT

INSPECTED BY: [Signature]  
DATE: 8/27/13  
COMMENTS:

APPROVED DISAPPROVED

SIGNATURE

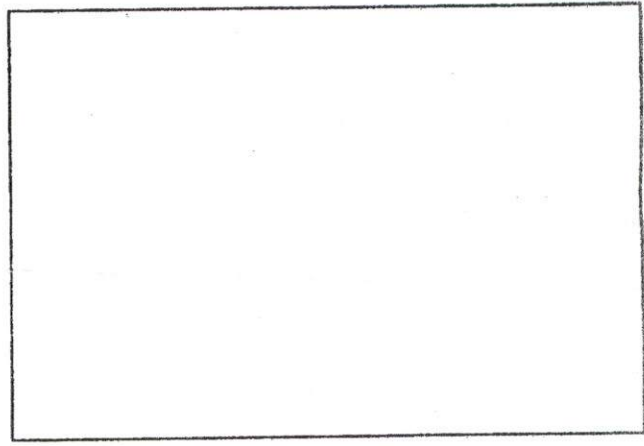

SKETCH PLAN





TWW-15.2

EXP-125 7/30/14.

PERMIT NO.  
24349

CITY OF NEW BEDFORD  
SEWER AND/OR STORM DRAIN PERMIT

DATE 7/30/13

This certifies that permission is granted to

Paul Bennett 304 Upland St (508) 995-9674  
Property Owner Address Tel.

To connect a sewer and/or storm drain located at Sharon St (U.S.) 120' E x Acadnet Avenue

Assessor's Plot 137A Lot 425 to the sewer and/or storm drain in 137-B-66 8 inch Sewer on Sharon Street

To be laid in accordance with the conditions in this application and the City of New Bedford ordinances.

TYPE OF USE: RESIDENTIAL COMMERCIAL INDUSTRIAL FLOW 330 G.P.D.

If applicant other than actual property owner, attach Letter of Authorization from Property Owner.

Name Suzanne Ellis Tel. (508) 995-9674

Mailing Address 32 Nye Avenue, Acadnet MA 02743

The Bonded Contractor/Drain Layer authorized to perform this work is:  
P.J. Conessa P.O. Box 61643 (508) 998-3404

Name Address Tel.

Type of Pipe Required: SDM 35 PVC

PERMIT EXPIRES ONE YEAR AFTER DATE OF ISSUE

- Requires separate connections for sewage and storm drain where applicable. Storm water cannot be discharged to a sanitary sewer.
- All work must be inspected and approved by a D.P.I. inspector before backfilling.
- If this connection is to be part of a private service shared jointly with other building owners, attach copy of Recorded Joint Maintenance Agreement.
- Permits can be issued to Industrial and/or Commercial Applicants only upon receipt and approval by the Commissioner of Public Infrastructure of required plans and supplemental information.
- In addition, a City-issued Industrial User Discharge Permit and/or a Sewer Extension/Connection Permit issued by the Commonwealth of Massachusetts D.E.P. shall be required by the City for Industrial Discharge into the sewer system.

Industrial User Discharge Permit No. Date

Comm. Mass. Sewer Conn./Ext. Permit No. Date

A Filing and Inspection Fee of \$ 450.00, plus an Entrance Fee of \$ where applicable, must accompany this application.

Bank# Bank of America Check# 1033 Date 7/30/13 Receipt# 10144

Other requirements: Please call ahead 24 hr notice for inspection @

(508) 929-1550 ext 500

Connection made to Sewer Part of jointly-shared private line YES NO  
Storm Drain

Applicant agrees to abide by the above terms, as well as all pertinent ordinances of the City of New Bedford, and such other special rules as the Commissioner of Public Infrastructure and/or City Engineer may deem necessary

Gernard M. Amadio  
City Engineer  
Chief of the Works

Rep: Diane Bellis  
Signature of Property Owner or Representative

INSPECTOR'S REPORT

INSPECTED BY: \_\_\_\_\_  
DATE: \_\_\_\_\_  
COMMENTS: \_\_\_\_\_

APPROVED DISAPPROVED

SIGNATURE

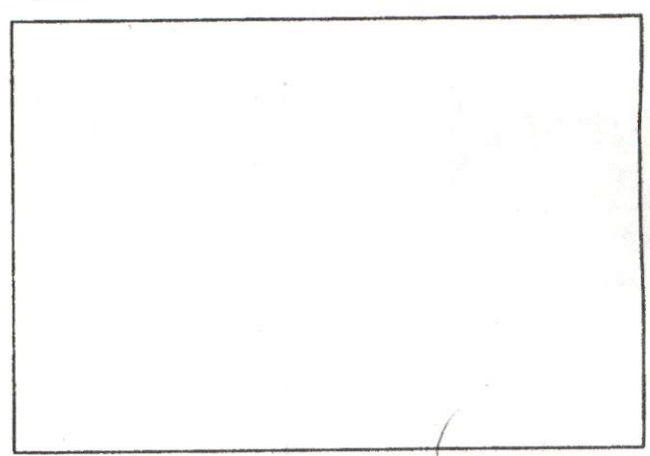

SKETCH PLAN





Department of Public Infrastructure

Ronald H. Labelle  
Commissioner

CITY OF NEW BEDFORD  
Jonathan F. Mitchell, Mayor

Water  
Wastewater  
Highways  
Engineering  
Cemetery

To Whom It May Concern:

I Paul Bennett 304 Upland Street, being  
(Name) (Mailing Address)

Owner of property located at

Lot 2, Sharon Street, MA 02740

Plot 137A, Lot ~~(3) 412~~ 425, hereby agree to allow Shayne Ellis  
(Name)

32 Leg Avenue, Ashmet MA 02743, to act on my behalf including affixing my  
(Mailing Address)

signature in securing permit for:

☒ Sewer/Drain Service Permits  
☒ Water Service Permits  
☒ Driveway Installation Permits  
☐ Sidewalk Installation Permits

I further agree to conform to, and abide by, All City rules and ask regulations applicable to the permit (s) being applied for:

Name Paul D. Bennett  
Signature

304 Upland St N. B.  
Address

7/29/13  
Date

508-995-9674  
Telephone number



Commonwealth of Massachusetts

# CITY OF NEW BEDFORD

City Hall, Room 308, 133 William Street New Bedford, MA 02740 (508) 979-1540



## FOUNDATION PERMIT

7/15/2013

No. **B-13-1227**

MSBC Sect. 111.8 - Any permit issued shall be deemed abandoned and invalid unless the work authorized by it shall have been commenced within six (6) months after its issuance.

FEE PAID \$ #Error

This certifies that **DEREE DENNIS JBENNETT PAUL D**

owner/contractor has permission to: **NS SHARON ST**

on: **Foundations Only 1-2 Family - 100.00**

Providing that the person accepting this permit shall in every respect conform to the terms of application therefore on file in this office; to the provisions of the statute of the Commonwealth and to the by-laws of the City of New Bedford relating to the inspection, erection, enlarging, altering, raising, moving, repairing, or tearing down of a building.

Permit is issued subject to the following special requirements: (Restrictions)



Wiring Inspector



Plumbing Inspector



Building Inspector

YOUR AREA INSPECTOR IS: **Thomas Welch**

Tel: (508) 979-1540 Between 8:00am - 9:00am

**NOTICE: NOTIFY INSPECTOR 48 HOURS IN ADVANCE OF APPLYING SHEATHING OR LATHING**

**OCCUPANCY PERMIT REQUIRED BEFORE OCCUPANCY**

No Building or Structure shall be used or occupied until the Certificate of Use and Occupancy shall have been issued by the Building Commissioner MSBC Sect. 120.1

**This Card Must Be Displayed in a Conspicuous Place on the Premises and Not Torn Down or Removed Until Completion of Work**

SUBJECT TO MASSACHUSETTS  
STATE BUILDING CODE

*Donny O'Rourke*

Building Inspector



