



PERMIT NO.
24346-EXT.

CITY OF NEW BEDFORD
SEWER AND/OR STORM DRAIN PERMIT

DATE 6/19/13

This certifies that permission is granted to

David + Melissa Wojnar 35 Ludlow St Acushnet, MA
Property Owner Address Tel.

To connect a sewer and/or storm drain located at 35 Ludlow St.
Acushnet
Assessor's Plot 24 Lot 15-R, to the sewer and/or storm drain in Ludlow St. Street

To be laid in accordance with the conditions in this application and the City of New Bedford ordinances.

TYPE OF USE: RESIDENTIAL COMMERCIAL INDUSTRIAL FLOW G.P.D.

If applicant other than actual property owner, attach Letter of Authorization from Property Owner.

Name Town of Acushnet Tel. 508-986-0230

Mailing Address

The Bonded Contractor/Drain Layer authorized to perform this work is: Greco Const.

Name Address Tel.

Type of Pipe Required: 8" SDR 35

PERMIT EXPIRES ONE YEAR AFTER DATE OF ISSUE

- Requires separate connections for sewage and storm drain where applicable. Storm water cannot be discharged to a sanitary sewer.
 - All work must be inspected and approved by a D.P.I. inspector before backfilling.
 - If this connection is to be part of a private service shared jointly with other building owners, attach copy of Recorded Joint Maintenance Agreement.
 - Permits can be issued to Industrial and/or Commercial Applicants only upon receipt and approval by the Commissioner of Public Infrastructure of required plans and supplemental information.
 - In addition, a City-issued Industrial User Discharge Permit and/or a Sewer Extension/Connection Permit issued by the Commonwealth of Massachusetts D.E.P. shall be required by the City for Industrial Discharge into the sewer system.
- Industrial User Discharge Permit No. Date

Comm. Mass. Sewer Conn./Ext. Permit No. Date

A Filing and Inspection Fee of \$450, plus an Entrance Fee of \$ where applicable, must accompany this application.

Bank# Bank of America Check# 16368 Date 6/11/13 Receipt# 10091

Other requirements: extend sewer main in Ludlow St 45'

Connection made to Sewer Part of jointly-shared private line YES NO
Storm Drain

Applicant agrees to abide by the above terms, as well as all pertinent ordinances of the City of New Bedford, and such other special rules as the Commissioner of Public Infrastructure and/or City Engineer may deem necessary

Don M. Amadeo
City Engineer

Signature of Property Owner or Representative

INSPECTOR'S REPORT

INSPECTED BY:

DATE:

COMMENTS:

APPROVED

DISA

SIGNATURE

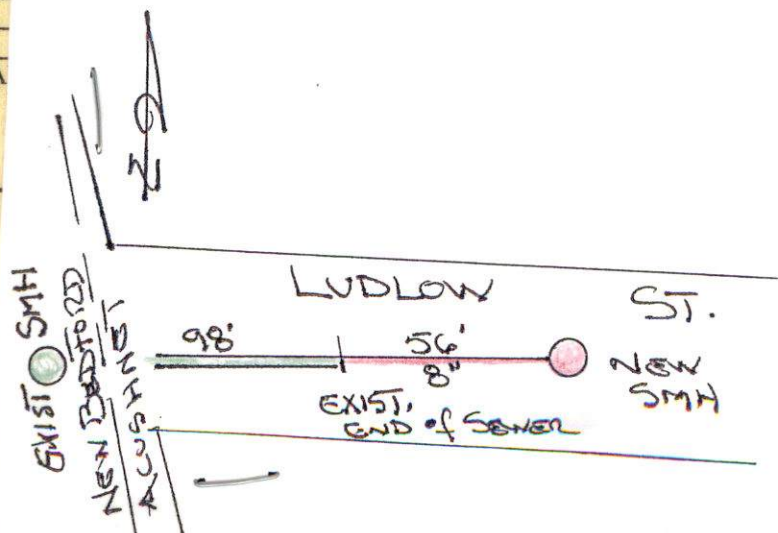



PERMIT NO.
24346-EXT.

CITY OF NEW BEDFORD
SEWER AND/OR STORM DRAIN PERMIT

DATE 6/19/13

This certifies that permission is granted to

David + Melissa Wojnar 35 Ludlow St Acushnet, MA
Property Owner Address Tel.

To connect a sewer and/or storm drain located at 35 Ludlow St
Acushnet Assessor's Plot 24 Lot 15-R, to the sewer and/or storm drain in Ludlow St Street

To be laid in accordance with the conditions in this application and the City of New Bedford ordinances.

TYPE OF USE: RESIDENTIAL COMMERCIAL INDUSTRIAL FLOW G.P.D.

If applicant other than actual property owner, attach Letter of Authorization from Property Owner.

Name: T. O. H. Acushnet Tel: 508-988-0230

Mailing Address:

The Bonded Contractor/Drain Layer authorized to perform this work is: Geo. Deo Const.

Name Address Tel.

Type of Pipe Required: 8" S.D.R. 35

PERMIT EXPIRES ONE YEAR AFTER DATE OF ISSUE

- Requires separate connections for sewage and storm drain where applicable. Storm water cannot be discharged to a sanitary sewer.
 - All work must be inspected and approved by a D.P.I. inspector before backfilling.
 - If this connection is to be part of a private service shared jointly with other building owners, attach copy of Recorded Joint Maintenance Agreement.
 - Permits can be issued to Industrial and/or Commercial Applicants only upon receipt and approval by the Commissioner of Public Infrastructure of required plans and supplemental information.
 - In addition, a City-issued Industrial User Discharge Permit and/or a Sewer Extension/Connection Permit issued by the Commonwealth of Massachusetts D.E.P. shall be required by the City for Industrial Discharge into the sewer system.
- Industrial User Discharge Permit No. Date.

Comm. Mass. Sewer Conn./Ext. Permit No. Date.

A Filing and Inspection Fee of \$150, plus an Entrance Fee of \$16368, where applicable, must accompany this application.

Bank# Bank of America Check# 45888 Date 6/11/13 Receipt# 10091

Other requirements: extend sewer main in Ludlow St 45'

Connection made to Sewer Part of jointly-shared private line YES NO
Storm Drain

Applicant agrees to abide by the above terms, as well as all pertinent ordinances of the City of New Bedford, and such other special rules as the Commissioner of Public Infrastructure and/or City Engineer may deem necessary

City Engineer

Signature of Property Owner or Representative

INSPECTOR'S REPORT

INSPECTED BY: DATE: 6/19/13 COMMENTS:

APPROVED DISAPPROVED

SIGNATURE

SKETCH PLAN



Expires: 6/19/14

PERMIT NO.
24346-EXT.

CITY OF NEW BEDFORD
SEWER AND/OR STORM DRAIN PERMIT

DATE 6/19/13

This certifies that permission is granted to

David + Melissa Wojnar 35 Ludlow St. Acushnet, MA
Property Owner Address Tel.

Town of Acushnet

To connect a sewer and/or storm drain located at 35 Ludlow St. Acushnet
Assessor's Plot 24 Lot 15-R, to the sewer and/or storm drain in Ludlow St. Street

To be laid in accordance with the conditions in this application and the City of New Bedford ordinances.

TYPE OF USE: RESIDENTIAL COMMERCIAL INDUSTRIAL FLOW G.P.D.

If applicant other than actual property owner, attach Letter of Authorization from Property Owner.

Name: John of Acushnet Tel: 508-988-0230
Mailing Address:

The Bonded Contractor/Drain Layer authorized to perform this work is: Greco Const.

Name: 8" Address: S.D.R. 35 Tel:

Type of Pipe Required:

PERMIT EXPIRES ONE YEAR AFTER DATE OF ISSUE

- Requires separate connections for sewage and storm drain where applicable. Storm water cannot be discharged to a sanitary sewer.
 - All work must be inspected and approved by a D.P.I. inspector before backfilling.
 - If this connection is to be part of a private service shared jointly with other building owners, attach copy of Recorded Joint Maintenance Agreement.
 - Permits can be issued to Industrial and/or Commercial Applicants only upon receipt and approval by the Commissioner of Public Infrastructure of required plans and supplemental information.
 - In addition, a City-issued Industrial User Discharge Permit and/or a Sewer Extension/Connection Permit issued by the Commonwealth of Massachusetts D.E.P. shall be required by the City for Industrial Discharge into the sewer system.
- Industrial User Discharge Permit No. Date:

Comm. Mass. Sewer Conn./Ext. Permit No. Date:

A Filing and Inspection Fee of \$450., plus an Entrance Fee of \$..... where applicable, must accompany this application.

Bank# Bank of America Check# 16368 Date 6/11/13 Receipt# 10091

Other requirements: extend sewer main in Ludlow St. 45'

Connection made to Sewer Part of jointly-shared private line YES NO
Storm Drain

Applicant agrees to abide by the above terms, as well as all pertinent ordinances of the City of New Bedford, and such other special rules as the Commissioner of Public Infrastructure and/or City Engineer may deem necessary

Don M. Amador
City Engineer

Signature of Property Owner or Representative

INSPECTOR'S REPORT

INSPECTED BY: _____
DATE: _____
COMMENTS: _____

APPROVED DISAPPROVED

SIGNATURE

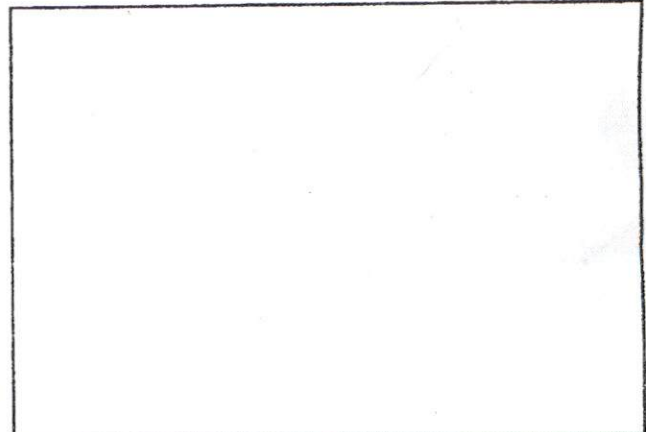

SKETCH PLAN

