



PERMIT NO.

CITY OF NEW BEDFORD  
SEWER AND/OR STORM DRAIN PERMIT

DATE 3/27/13

24324

This certifies that permission is granted to

Property Owner Joseph Valente Address 152 W. Bedford St. Tel. 781-363-1393

To connect a sewer and/or storm drain located at Bedford St.

Assessor's Plot 40 Lot 180, to the sewer and/or storm drain in Bedford Street Street

To be laid in accordance with the conditions in this application and the City of New Bedford ordinances.

TYPE OF USE: RESIDENTIAL COMMERCIAL INDUSTRIAL FLOW \_\_\_\_\_ G.P.D.

If applicant other than actual property owner, attach Letter of Authorization from Property Owner.

Name N/A Tel. \_\_\_\_\_

Mailing Address N/A

The Bonded Contractor/Drain Layer authorized to perform this work is:

Name M.J. Corassa Address P.O. Box 51043 Tel. (508) 998-3404

Type of Pipe Required: SDH 33 PVC

PERMIT EXPIRES ONE YEAR AFTER DATE OF ISSUE

- Requires separate connections for sewage and storm drain where applicable. Storm water cannot be discharged to a sanitary sewer.
  - All work must be inspected and approved by a D.P.I. inspector before backfilling.
  - If this connection is to be part of a private service shared jointly with other building owners, attach copy of Recorded Joint Maintenance Agreement.
  - Permits can be issued to Industrial and/or Commercial Applicants only upon receipt and approval by the Commissioner of Public Infrastructure of required plans and supplemental information.
  - In addition, a City-issued Industrial User Discharge Permit and/or a Sewer Extension/Connection Permit issued by the Commonwealth of Massachusetts D.E.P. shall be required by the City for Industrial Discharge into the sewer system.
- Industrial User Discharge Permit No. \_\_\_\_\_ Date \_\_\_\_\_

Comm. Mass. Sewer Conn./Ext. Permit No. \_\_\_\_\_ Date \_\_\_\_\_  
A Filing and Inspection Fee of \$ 450.00, plus an Entrance Fee of \$ \_\_\_\_\_ where applicable, must accompany this application.

Bank# Citizen Bank Check# 734 Date 3/25/13 Receipt# 09966

Other requirements: Please call street 24 hr. notice for inspection - @ (508) 998-1550. Follow only if 12:00 PM - 1:00 PM

Connection made to Sewer Part of jointly-shared private line YES NO  
Storm Drain

Applicant agrees to abide by the above terms, as well as all pertinent ordinances of the City of New Bedford, and such other special rules as the Commissioner of Public Infrastructure and/or City Engineer may deem necessary

Manuel P. Silva  
Supervising City Engineer

Joseph Valente  
Signature of Property Owner or Representative

INSPECTOR'S REPORT

INSPECTED BY: \_\_\_\_\_  
DATE: \_\_\_\_\_  
COMMENTS: \_\_\_\_\_

APPROVED DIS

SEE WHITE SHEET  
SIGNATURE

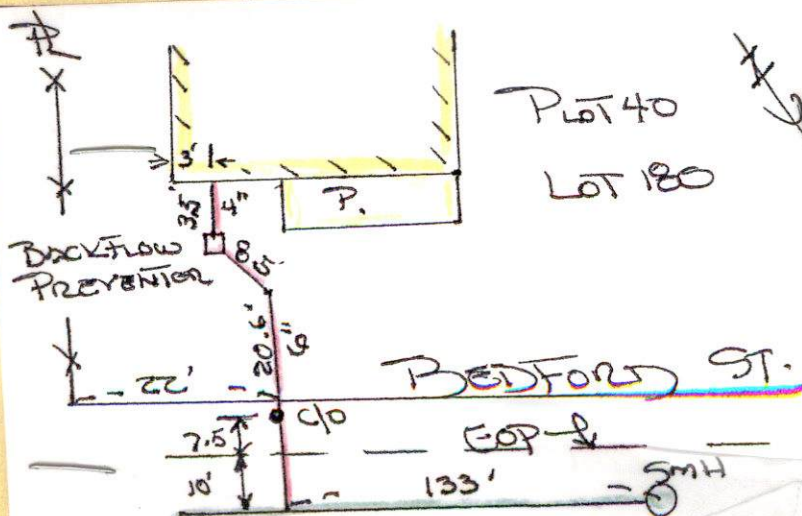





Inspector

PERMIT NO.

24324

CITY OF NEW BEDFORD  
SEWER AND/OR STORM DRAIN PERMIT

DATE

3/25/13

This certifies that permission is granted to

Jorge Verissimo Property Owner Address 1 Cookie Way S. Dartmouth MA 02748 Tel. 741-263-1292

To connect a sewer and/or storm drain located at Bedford St & Oak St 1107

Assessor's Plot 40 Lot 180, to the sewer and/or storm drain in Bedford Street

To be laid in accordance with the conditions in this application and the City of New Bedford ordinances.

TYPE OF USE RESIDENTIAL COMMERCIAL INDUSTRIAL FLOW G.P.D.

If applicant other than actual property owner, attach Letter of Authorization from Property Owner.

Name Mailing Address Tel.

The Bonded Contractor/Drain Layer authorized to perform this work is:

Name M.J. Conessa Address P.O. Box 51643 Tel. (508) 948-3404

Type of Pipe Required: SD 35 PVC

PERMIT EXPIRES ONE YEAR AFTER DATE OF ISSUE

- Requires separate connections for sewage and storm drain where applicable. Storm water cannot be discharged to a sanitary sewer.
  - All work must be inspected and approved by a D.P.I. inspector before backfilling.
  - If this connection is to be part of a private service shared jointly with other building owners, attach copy of Recorded Joint Maintenance Agreement.
  - Permits can be issued to Industrial and/or Commercial Applicants only upon receipt and approval by the Commissioner of Public Infrastructure of required plans and supplemental information.
  - In addition, a City-issued Industrial User Discharge Permit and/or a Sewer Extension/Connection Permit issued by the Commonwealth of Massachusetts D.E.P. shall be required by the City for Industrial Discharge into the sewer system.
- Industrial User Discharge Permit No. Date

Comm. Mass. Sewer Conn./Ext. Permit No. Date

A Filing and Inspection Fee of \$450.00 plus an Entrance Fee of \$ where applicable, must accompany this application.

Bank# Citizens Bank Check# 734 Date 3/25/13 Receipt# 09966

Other requirements: Please call ahead 24 hr. notice for inspection @ (508) 979-1550 Follow city of New Bedford Regulations for patches

Connection made to Sewer Storm Drain Part of jointly-shared private line YES NO

Applicant agrees to abide by the above terms, as well as all pertinent ordinances of the City of New Bedford, and such other special rules as the Commissioner of Public Infrastructure and/or City Engineer may deem necessary

Manuel A. Silva Supervising City Engineer

Signature of Property Owner or Representative

INSPECTOR'S REPORT

INSPECTED BY: DATE: 5/21/13 COMMENTS:

APPROVED

DISAPPROVED

SIGNATURE

SKETCH PLAN

WN-150



PERMIT NO.

24324

CITY OF NEW BEDFORD  
SEWER AND/OR STORM DRAIN PERMIT

DATE

3/25/13

This certifies that permission is granted to

Jorge Verissimo  
Property Owner

1 Cookie Way  
Address S. Dartmouth MA 02745

74-263-1292

Tel. Borden St

To connect a sewer and/or storm drain located at Bedford St Ex Ash St HO/-

Assessor's Plot 40 Lot 180, to the sewer and/or storm drain in Bedford Street Street

To be laid in accordance with the conditions in this application and the City of New Bedford ordinances.

TYPE OF USE RESIDENTIAL COMMERCIAL INDUSTRIAL FLOW G.P.D.

If applicant other than actual property owner, attach Letter of Authorization from Property Owner.

Name N/A Tel.

Mailing Address

The Bonded Contractor/Drain Layer authorized to perform this work is:

Joe Carre

Name M.J. Conessa Address P.O. Box 51643

Tel. (508) 998-3404

Type of Pipe Required: SDH 35 PVC

PERMIT EXPIRES ONE YEAR AFTER DATE OF ISSUE

- Requires separate connections for sewage and storm drain where applicable. Storm water cannot be discharged to a sanitary sewer.
  - All work must be inspected and approved by a D.P.I. inspector before backfilling.
  - If this connection is to be part of a private service shared jointly with other building owners, attach copy of Recorded Joint Maintenance Agreement.
  - Permits can be issued to Industrial and/or Commercial Applicants only upon receipt and approval by the Commissioner of Public Infrastructure of required plans and supplemental information.
  - In addition, a City-issued Industrial User Discharge Permit and/or a Sewer Extension/Connection Permit issued by the Commonwealth of Massachusetts D.E.P. shall be required by the City for Industrial Discharge into the sewer system.
- Industrial User Discharge Permit No. Date.

Comm. Mass. Sewer Conn./Ext. Permit No. Date.

A Filing and Inspection Fee of \$450 plus an Entrance Fee of \$ where applicable, must accompany this application.

Bank# Citizens Bank Check# 734 Date 3/25/13 Receipt# 09966

Other requirements: Please call ahead 24 hr. notice for

inspection @ (508) 971-1550 Follow city of New Bedford

Connection made to Sewer Part of jointly-shared private line YES NO  
Storm Drain

Applicant agrees to abide by the above terms, as well as all pertinent ordinances of the City of New Bedford, and such other special rules as the Commissioner of Public Infrastructure and/or City Engineer may deem necessary

Manuel P. Silva  
Supervising City Engineer

Jorge Verissimo  
Signature of Property Owner or Representative

INSPECTOR'S REPORT

INSPECTED BY:

DATE:

COMMENTS:

APPROVED

DISAPPROVED

SIGNATURE

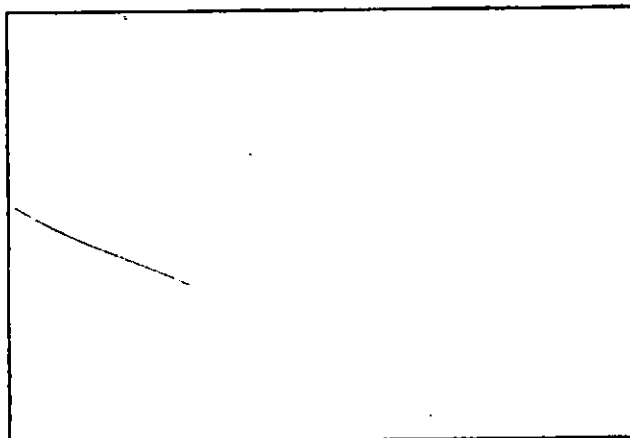

SKETCH PLAN

40

[illegible]



Commonwealth of Massachusetts  
**City of New Bedford**

133 William Street New Bedford, MA 02740

**SEWER PERMIT**



Date: **3/26/2013**

No. **WW-13-5**

Sewer Connection Fee: **\$450.00**

Pipe Size: **0.00**

Trench Length: **0.00**

Service Location: **SS BEDFORD ST**

Owner Name: **INVESTMENT CAPITAL**

Type of Occupancy: **Residential**

Type of Work: **Sewer - New Sewer Service**

Work Description: **Installing New Service Service into Bedford Street**

**Bedford St (SS) 152' W x Borden St  
P40  
L180**

**\*\* Jorge Verissimo - Owner**

No. of Units : **0** Required Design Daily Flow : **0.00** Provided Daily Flow : **0.00**

The undersigned petitions you to grant permission to ENTER INTO THE MAIN SEWER and, if such permission is granted, hereby agrees to the following:

1. To abide by the conditions and regulations imposed by the Commissioner of Public Works by statute or by ordinance now in force, or as amended from time to time.
2. That the connection of said sewer with the main sewer shall be inspected by an employee of the department of Public Works or by a designated agent of the Town before burial of said connection.
3. That the work shall at all times be under the direction and control of the Commissioner of Public Works or his authorized agent, and that any expense incurred by the Town shall be charged to the permittee, and said

permittee  
agrees to reimburse the Town for said expense.

Installing Company Name: **Robert J. Canessa**

License Type: **DPI - Other**

Address: **P. O. Box 51643**

City/Town/State: **New Bedford**

**MA**

**GRANTED WITH THE USUAL CONDITIONS**

**Call (781) 942-9077 For Inspection**



Commonwealth of Massachusetts

# CITY OF NEW BEDFORD

City Hall, Room 308, 133 William Street New Bedford, MA 02740 (508) 979-1540



## FOUNDATION PERMIT

3/1/2013

No. **B-13-140**

MSBC Sect. 111.8 - Any permit issued shall be deemed abandoned and invalid unless the work authorized by it shall have been commenced within six (6) months after its issuance.

FEE PAID \$**#Error**

This certifies that **Jorge Verissimo**

owner/contractor has permission to:

**SS BEDFORD ST**

on: **Foundations Only 1-2 Family - 100.00**

Providing that the person accepting this permit shall in every respect conform to the terms of application therefore on file in this office; to the provisions of the statute of the Commonwealth and to the by-laws of the City of New Bedford relating to the inspection, erection, enlarging, altering, raising, moving, repairing, or tearing down of a building.

Permit is issued subject to the following special requirements: (Restrictions)



**Wiring Inspector**



**Plumbing Inspector**



**Building Inspector**

YOUR AREA INSPECTOR IS **James E. Berube**

Tel (508) 979-1540 Between 8:00am - 9:00am

**NOTICE: NOTIFY INSPECTOR 48 HOURS IN ADVANCE OF APPLYING SHEATHING OR LATHING**

**OCCUPANCY PERMIT REQUIRED BEFORE OCCUPANCY**

No Building or Structure shall be used or occupied until the Certificate of Use and Occupancy shall have been issued by the Building Commissioner - MSBC, Sect. 120.1

**This Card Must Be Displayed in a Conspicuous Place on the Premises and Not Torn Down or Removed Until Completion of Work**

SUBJECT TO MASSACHUSETTS  
STATE BUILDING CODE

*Donny O. Penney*

Building Inspector