



PERMIT NO.

CITY OF NEW BEDFORD
SEWER AND/OR STORM DRAIN PERMIT

DATE 1/14/13

24320

This certifies that permission is granted to

Property Owner

Address

Tel.

To connect a sewer and/or storm drain located at

Assessor's Plot 122 Lot 3, to the sewer and/or storm drain in Shawmut Avenue Street

To be laid in accordance with the conditions in this application and the City of New Bedford ordinances.

TYPE OF USE: RESIDENTIAL COMMERCIAL INDUSTRIAL FLOW G.P.D.

If applicant other than actual property owner, attach Letter of Authorization from Property Owner.

Name

Tel.

Mailing Address

The Bonded Contractor/Drain Layer authorized to perform this work is:

Name

Address

Tel.

Type of Pipe Required:

PERMIT EXPIRES ONE YEAR AFTER DATE OF ISSUE

- Requires separate connections for sewage and storm drain where applicable. Storm water cannot be discharged to a sanitary sewer.
 - All work must be inspected and approved by a D.P.I. inspector before backfilling.
 - If this connection is to be part of a private service shared jointly with other building owners, attach copy of Recorded Joint Maintenance Agreement.
 - Permits can be issued to Industrial and/or Commercial Applicants only upon receipt and approval by the Commissioner of Public Infrastructure of required plans and supplemental information.
 - In addition, a City-issued Industrial User Discharge Permit and/or a Sewer Extension/Connection Permit issued by the Commonwealth of Massachusetts D.E.P. shall be required by the City for Industrial Discharge into the sewer system.
- Industrial User Discharge Permit No. Date

Comm. Mass. Sewer Conn./Ext. Permit No. Date

A Filing and Inspection Fee of \$, plus an Entrance Fee of \$ where applicable, must accompany this application.

Bank# Check# Date Receipt#

Other requirements: Please call phone 24 hour notice for inspection @ (508) 729-1560

Connection made to Sewer Part of jointly-shared private line YES NO
Storm Drain

Applicant agrees to abide by the above terms, as well as all pertinent ordinances of the City of New Bedford, and such other special rules as the Commissioner of Public Infrastructure and/or City Engineer may deem necessary

City Engineer Sup. Engr

Signature of Property Owner or Representative Doris Cunningham

INSPECTOR'S REPORT

INSPECTED BY:
DATE:
COMMENTS:

APPROVED

DISAP

SIGNATURE

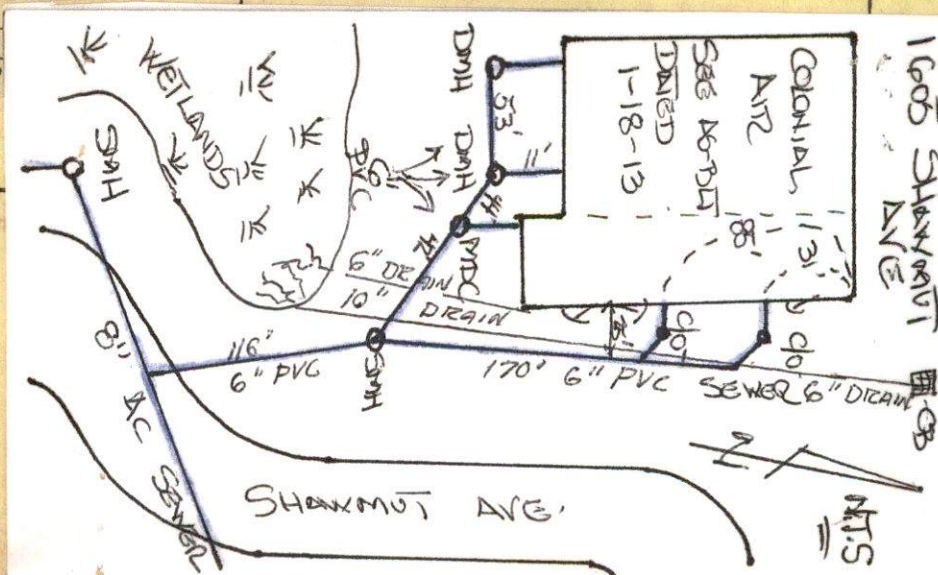



PERMIT NO.

CITY OF NEW BEDFORD
SEWER AND/OR STORM DRAIN PERMIT

DATE 1/16/13

24320

This certifies that permission is granted to

(DOT) Cunningham 13 Quanaoog Rd (SOS) 997-0620
Doris Property Owner Address E. Freetown, MA 02717 Tel.To connect a sewer and/or storm drain located at 1105 Shawmut Avenue (Hanger drain
the ins)Assessor's Plot 122 Lot 3, to the sewer and/or storm drain in Shawmut Avenue Street
8 inch Sewer

To be laid in accordance with the conditions in this application and the City of New Bedford ordinances.

TYPE OF USE: RESIDENTIAL COMMERCIAL INDUSTRIAL FLOW G.P.D.

Adminal AIRPORT

If applicant other than actual property owner, attach Letter of Authorization from Property Owner.

Name N/A Tel.

Mailing Address N/A

The Bonded Contractor/Drain Layer authorized to perform this work is:

City of New Bedford

Name DPI Address 1105 Shawmut Ave Tel.

Type of Pipe Required: SDR 36 PVC

PERMIT EXPIRES ONE YEAR AFTER DATE OF ISSUE

- Requires separate connections for sewage and storm drain where applicable. Storm water cannot be discharged to a sanitary sewer.
 - All work must be inspected and approved by a D.P.I. inspector before backfilling.
 - If this connection is to be part of a private service shared jointly with other building owners, attach copy of Recorded Joint Maintenance Agreement.
 - Permits can be issued to Industrial and/or Commercial Applicants only upon receipt and approval by the Commissioner of Public Infrastructure of required plans and supplemental information.
 - In addition, a City-issued Industrial User Discharge Permit and/or a Sewer Extension/Connection Permit issued by the Commonwealth of Massachusetts D.E.P. shall be required by the City for Industrial Discharge into the sewer system.
- Industrial User Discharge Permit No. Date

Comm. Mass. Sewer Conn./Ext. Permit No. Date

A Filing and Inspection Fee of \$, plus an Entrance Fee of \$, where applicable, must accompany this application.

Bank# Fee Waived Per ZEB Date Receipt#

Other requirements: Please call ahead 24 hour notice for
inspection @ (SOS) 979-1560Connection made to Sewer Part of jointly-shared private line YES NO
Storm Drain

Applicant agrees to abide by the above terms, as well as all pertinent ordinances of the City of New Bedford, and such other special rules as the Commissioner of Public Infrastructure and/or City Engineer may deem necessary

City Engineer S.P. ENG Signature of Property Owner or Representative

INSPECTOR'S REPORT

INSPECTED BY:

DATE:

COMMENTS:

APPROVED

DISAPPROVED

SIGNATURE

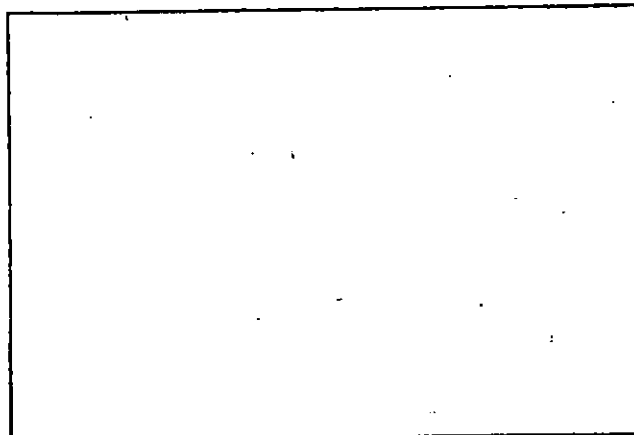

SKETCH PLAN

www-12-36



Yellow Copy Missing

PERMIT NO.

CITY OF NEW BEDFORD
SEWER AND/OR STORM DRAIN PERMIT

DATE 1/16/13

24320

This certifies that permission is granted to

(DOT) Cunningham 13 Quanaoag Rd (508) 997-0620
Doris Property Owner Address E. Freeborn, MA 02717 Tel.

To connect a sewer and/or storm drain located at 1105 Shawmut Avenue (Hanger drain tie in)

Assessor's Plot 122 Lot 3, to the sewer and/or storm drain in Shawmut Avenue Street
8' inch Sewer

To be laid in accordance with the conditions in this application and the City of New Bedford ordinances.

TYPE OF USE: RESIDENTIAL COMMERCIAL INDUSTRIAL FLOW G.P.D.

Colonial Airport

If applicant other than actual property owner, attach Letter of Authorization from Property Owner.

Name Tel.

Mailing Address

The Bonded Contractor/Drain Layer authorized to perform this work is:

City of New Bedford

Name D.P.I. Address 1105 Shawmut Ave Tel.

Type of Pipe Required: SDR 35 PVC

PERMIT EXPIRES ONE YEAR AFTER DATE OF ISSUE

- Requires separate connections for sewage and storm drain where applicable. Storm water cannot be discharged to a sanitary sewer.
 - All work must be inspected and approved by a D.P.I. inspector before backfilling.
 - If this connection is to be part of a private service shared jointly with other building owners, attach copy of Recorded Joint Maintenance Agreement.
 - Permits can be issued to Industrial and/or Commercial Applicants only upon receipt and approval by the Commissioner of Public Infrastructure of required plans and supplemental information.
 - In addition, a City-issued Industrial User Discharge Permit and/or a Sewer Extension/Connection Permit issued by the Commonwealth of Massachusetts D.E.P. shall be required by the City for Industrial Discharge into the sewer system.
- Industrial User Discharge Permit No. Date

Comm. Mass. Sewer Conn./Ext. Permit No. Date

A Filing and Inspection Fee of \$, plus an Entrance Fee of \$, where applicable, must accompany this application.

Bank# Fee waived Per ZEB. Check# Date Receipt#

Other requirements: Please call ahead 24 hour notice for inspection @ (508) 979-1560

Connection made to Sewer Part of jointly-shared private line YES NO
Storm Drain

Applicant agrees to abide by the above terms, as well as all pertinent ordinances of the City of New Bedford, and such other special rules as the Commissioner of Public Infrastructure and/or City Engineer may deem necessary

City Engineer Signature of Property Owner or Representative

INSPECTOR'S REPORT

INSPECTED BY: DATE: 1-18-13 COMMENTS:

APPROVED DISAPPROVED

SIGNATURE

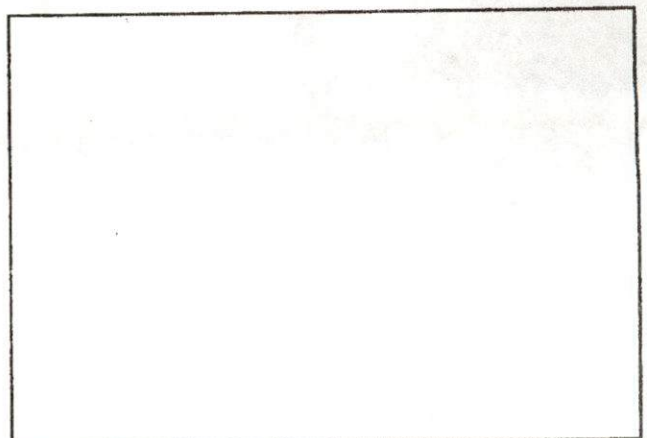

SKETCH PLAN