



expire 11/6/13

PERMIT NO.

CITY OF NEW BEDFORD
SEWER AND/OR STORM DRAIN PERMIT

DATE 11/6/12

24313

This certifies that permission is granted to

John Maffey P.O. Box 79416 Dartmouth MA 01917 Tel. 774-836-6800

To connect a sewer and/or storm drain located at (W.S.) Rockdale Ave - 125' x 80' x 10' Terrace

Assessor's Plot 108 Lot 155, to the sewer and/or storm drain in Rockdale Ave Street

To be laid in accordance with the conditions in this application and the City of New Bedford ordinances.

TYPE OF USE: RESIDENTIAL COMMERCIAL INDUSTRIAL FLOW 330 G.P.D.

If applicant other than actual property owner, attach Letter of Authorization from Property Owner.

Name: J.A. Tel.:

Mailing Address:

The Bonded Contractor/Drain Layer authorized to perform this work is:

W.C. Smith 148 W. 11th St. D.R. 140 508 995-1449

Name: W.C. Smith Address: 148 W. 11th St. Tel.:

Type of Pipe Required: 30" PVC

PERMIT EXPIRES ONE YEAR AFTER DATE OF ISSUE

- Requires separate connections for sewage and storm drain where applicable. Storm water cannot be discharged to a sanitary sewer.
 - All work must be inspected and approved by a D.P.I. inspector before backfilling.
 - If this connection is to be part of a private service shared jointly with other building owners, attach copy of Recorded Joint Maintenance Agreement.
 - Permits can be issued to Industrial and/or Commercial Applicants only upon receipt and approval by the Commissioner of Public Infrastructure of required plans and supplemental information.
 - In addition, a City-issued Industrial User Discharge Permit and/or a Sewer Extension/Connection Permit issued by the Commonwealth of Massachusetts D.E.P. shall be required by the City for Industrial Discharge into the sewer system.
- Industrial User Discharge Permit No. Date:

Comm. Mass. Sewer Conn./Ext. Permit No. Date:

A Filing and Inspection Fee of \$450, plus an Entrance Fee of \$ where applicable, must accompany this application.

Bank# Sovereign Bank Check# 3524 Date 11-6-12 Receipt# 96511/6/13

Other requirements: 24 Hour notice for inspection @ (500) 991-4550

All manholes to be connected into drainage structure

Connection made to Sewer Part of jointly-shared private line YES NO
Storm Drain

Applicant agrees to abide by the above terms, as well as all pertinent ordinances of the City of New Bedford, and such other special rules as the Commissioner of Public Infrastructure and/or City Engineer may deem necessary

Michael E. Silva
City Engineer
Clerk of the Works

John Maffey
Signature of Property Owner or Representative

INSPECTOR'S REPORT

INSPECTED BY: _____
DATE: _____
COMMENTS: _____

APPROVED

SIGNATURE

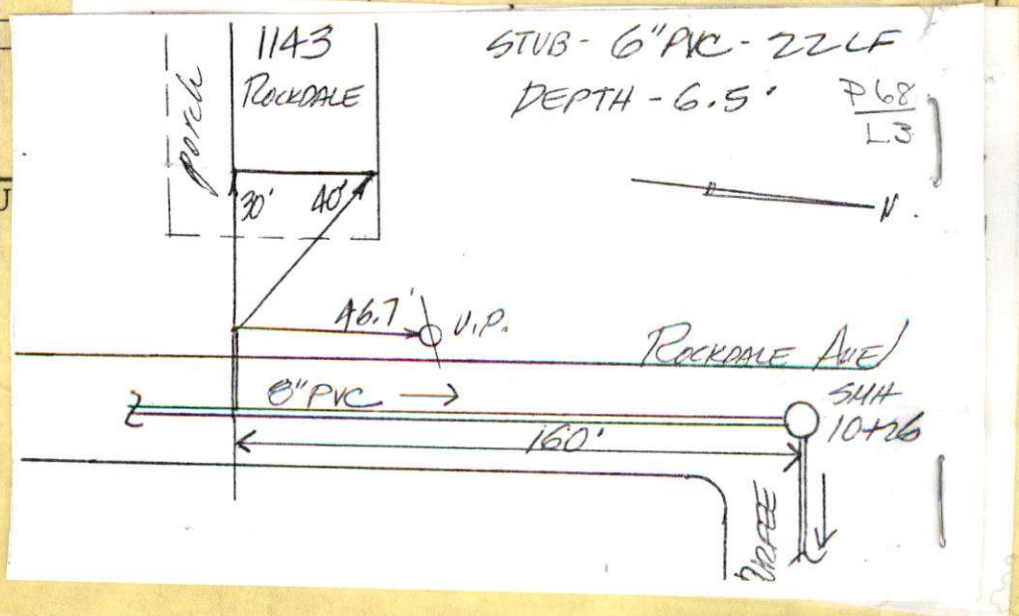



PERMIT NO.

CITY OF NEW BEDFORD
SEWER AND/OR STORM DRAIN PERMIT

Inspector:
expires 11/6/13
DATE 11/6/12

24313

This certifies that permission is granted to

John Maffei P.O. Box 79416 Dorchester MA 724-836-6800
Property Owner Address Tel.

To connect a sewer and/or storm drain located at (N.S.) Rockdale Ave - 125' 4" S x Eastland Terrace
connecting to a stub at property line formerly known as 1143 Rockdale
Assessor's Plot 68 Lot 155, to the sewer and/or storm drain in Rockdale Ave Street Ave
Old permit # 23143-C1 10/26/01

To be laid in accordance with the conditions in this application and the City of New Bedford ordinances.
TYPE OF USE: RESIDENTIAL COMMERCIAL INDUSTRIAL FLOW 330 G.P.D.

If applicant other than actual property owner, attach Letter of Authorization from Property Owner.
Name John Maffei Tel.
Mailing Address
The Bonded Contractor/Drain Layer authorized to perform this work is:
W.C. Smith + Sons 148 Western St D.B. MA SOP 995-1449
Name Address Tel.
Type of Pipe Required: SOP 35 PVC

PERMIT EXPIRES ONE YEAR AFTER DATE OF ISSUE

- Requires separate connections for sewage and storm drain where applicable. Storm water cannot be discharged to a sanitary sewer.
 - All work must be inspected and approved by a D.P.I. inspector before backfilling.
 - If this connection is to be part of a private service shared jointly with other building owners, attach copy of Recorded Joint Maintenance Agreement.
 - Permits can be issued to Industrial and/or Commercial Applicants only upon receipt and approval by the Commissioner of Public Infrastructure of required plans and supplemental information.
 - In addition, a City-issued Industrial User Discharge Permit and/or a Sewer Extension/Connection Permit issued by the Commonwealth of Massachusetts D.E.P. shall be required by the City for Industrial Discharge into the sewer system.
- Industrial User Discharge Permit No. Date

Comm. Mass. Sewer Conn./Ext. Permit No. Date
A Filing and Inspection Fee of \$ 450, plus an Entrance Fee of \$ where applicable, must accompany this application.

Bank# Sovereign Bank Check# 3524 Date 11-6-12 Receipt# 9651

Other requirements: 24 Hour notice for inspection @ (SOP) 991-6156

All manhole leaders to be connect into discharge structure

Connection made to Sewer Part of jointly-shared private line YES ☒ NO ☐
Storm Drain

Applicant agrees to abide by the above terms, as well as all pertinent ordinances of the City of New Bedford, and such other special rules as the Commissioner of Public Infrastructure and/or City Engineer may deem necessary.

Michael E. Silver John Maffei
City Engineer Signature of Property Owner or Representative
Clerk of the Works

INSPECTOR'S REPORT

INSPECTED BY: FB
DATE: 2/20/17
COMMENTS:

☒ APPROVED ☐ DISAPPROVED

SIGNATURE

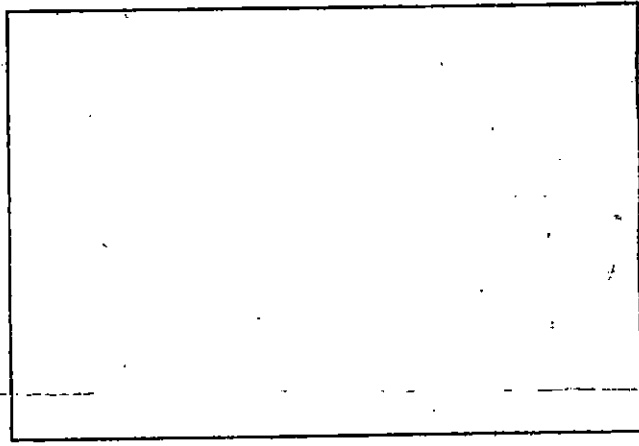

SKETCH PLAN



PERMIT NO.

CITY OF NEW BEDFORD
SEWER AND/OR STORM DRAIN PERMIT

expiries 11/6/12
DATE 11/6/12

24313

This certifies that permission is granted to PHB Development, LLC

John Maffei PO Box 79416 Dartmouth MA 02747 774-836-6800
Property Owner Address Tel.

To connect a sewer and/or storm drain located at (W.S.) Rockdale Ave - 125' x 3' x Eastland Terrace
Assessor's Plot 68 Lot 155, to the sewer and/or storm drain in Rockdale Ave old permit # 23143-01 for 10126/01 Street Outlet

To be laid in accordance with the conditions in this application and the City of New Bedford ordinances.
TYPE OF USE: RESIDENTIAL COMMERCIAL INDUSTRIAL FLOW 330 G.P.D.

If applicant other than actual property owner, attach Letter of Authorization from Property Owner.
Name JOHN M. Maffei Tel 774-836-6800
Mailing Address P.O. Box 79416 Dartmouth, MA 02747
The Bonded Contractor/Drain Layer authorized to perform this work is:
W.C. Smith + Sons 148 Wastwater St D.B. MA 02740 SAR 995-1449
Name Address Tel.
Type of Pipe Required: SDR 35 PVC

PERMIT EXPIRES ONE YEAR AFTER DATE OF ISSUE

- Requires separate connections for sewage and storm drain where applicable. Storm water cannot be discharged to a sanitary sewer.
- All work must be inspected and approved by a D.P.I. inspector before backfilling.
- If this connection is to be part of a private service shared jointly with other building owners, attach copy of Recorded Joint Maintenance Agreement.
- Permits can be issued to Industrial and/or Commercial Applicants only upon receipt and approval by the Commissioner of Public Infrastructure of required plans and supplemental information.
- In addition, a City-issued Industrial User Discharge Permit and/or a Sewer Extension/Connection Permit issued by the Commonwealth of Massachusetts D.E.P. shall be required by the City for Industrial Discharge into the sewer system.

Industrial User Discharge Permit No. Date

Comm. Mass. Sewer Conn./Ext. Permit No. Date

A Filing and Inspection Fee of \$ 450, plus an Entrance Fee of \$ where applicable, must accompany this application.

Bank# Sovereign Bank Check# 3524 Date 11-6-12 Receipt# 9651

Other requirements: 24 Hour notice for inspection @ (SAR) 991-6650

All most leaders to be connect into discharge structure

Connection made to Sewer Part of jointly-shared private line YES NO
Storm Drain

Applicant agrees to abide by the above terms, as well as all pertinent ordinances of the City of New Bedford, and such other special rules as the Commissioner of Public Infrastructure and/or City Engineer may deem necessary

Michael E. Selix John Maffei
City Engineer Signature of Property Owner or Representative
Clerk of the Works

INSPECTOR'S REPORT

INSPECTED BY: _____
DATE: _____
COMMENTS: _____

APPROVED _____ DISAPPROVED _____

SIGNATURE

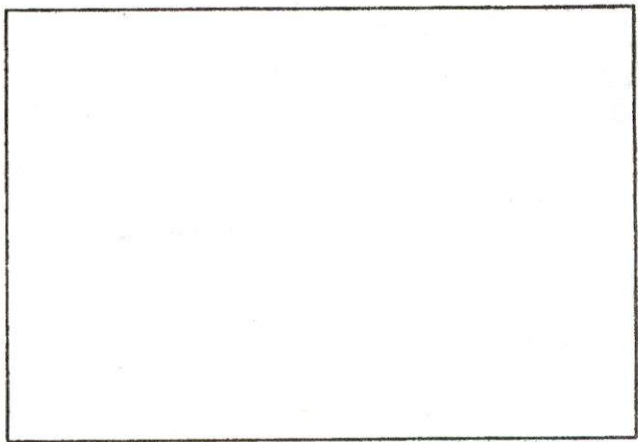

SKETCH PLAN



CITY OF NEW BEDFORD
Jonathan F. Mitchell, Mayor

Department of Public Infrastructure

Ronald H. Labelle
Commissioner

Water
Wastewater
Highways
Engineering
Cemetery

To Whom It May Concern:

Ray Bourque 346 Cushman Rd.
1803 Wavermont LLC 10. Middleboro, MA. 02746 being
(Name) (Mailing Address)

Owner of property located at

(W-3) Brockdale Ave - 125 +/- Sx Eastford Terrace

Plot 68, Lot 155, hereby agree to allow John H. H. H.
(Name)

192 Mystic Dr. Weymouth, MA to act on my behalf including affixing my
(Mailing Address)

signature in securing permit for:

☒ Sewer/Drain Service Permits
☐ Water Service Permits
☒ Driveway Installation Permits
☐ Sidewalk Installation Permits

I further agree to conform to, and abide by, All City rules and ask regulations applicable to the permit (s) being applied for:

Name Ray Bourque
Signature
346 Cushman Rd 10. Middleboro, MA
Address
11-13-12 508-991-3571
Date Telephone number

HP Officejet Pro 8500 A910 All-In-One series

Fax Log for
PUBLIC INFRASTRUCTURE
5089916152
Nov 13 2011 8:36AM

Last Transaction

Date	Time	Type	Station ID	Duration	Pages	Result
				Digital Fax		
Nov 13	8:35AM	Fax Sent	915087780770	0:58 N/A	2	OK



Commonwealth of Massachusetts

CITY OF NEW BEDFORD

City Hall, Room 308, 133 William Street New Bedford, MA 02740 (508) 979-1540



FOUNDATION PERMIT

10/4/2012

No. B-12-1287

MSBC Sect. 111.8 - Any permit issued shall be deemed abandoned and invalid unless the work authorized by it shall have been commenced within six (6) months after its issuance.

FEE PAID \$ #Error

This certifies that RBB DEVELOPMENT
owner/contractor has permission to:
on: Foundations Only 1-2 Family - 100.00

WS ROCKDALE AVE

Providing that the person accepting this permit shall in every respect conform to the terms of application, therefore on file in this office; to the provisions of the statute of the Commonwealth and to the by-laws of the City of New Bedford relating to the inspection, erection, enlarging, altering, raising, moving, repairing, or tearing down of a building.

Permit is issued subject to the following special requirements: (Restrictions)



Wiring Inspector



Plumbing Inspector



Building Inspector

YOUR AREA INSPECTOR IS: Mussie Gizaw

Tel: (508) 979-1540 Between 8:00am - 9:00am

NOTICE: NOTIFY INSPECTOR 48 HOURS IN
ADVANCE OF APPLYING SHEATHING OR LATHING

OCCUPANCY PERMIT REQUIRED BEFORE OCCUPANCY

No Building or Structure shall be used or occupied until the Certificate of Use and Occupancy shall have been issued by the Building Commissioner - MSBC, Sect. 120.1

This Card Must Be Displayed in a Conspicuous Place on the Premises and Not Torn Down or Removed Until Completion of Work

SUBJECT TO MASSACHUSETTS
STATE BUILDING CODE

Danny O. Brown

Building Inspector



City of New Bedford, MA

Building Division

City Hall, Room 308, 133 William Street
New Bedford, MA 02740

RECEIPT

APPLICATION TO CONSTRUCTION, REPAIR, RENOVATE, CHANGE THE USE OR OCCUPANCY OF, OR DEMOLISH A DWELLING

Permit No #: TB-12-1287	Date Received: 7/18/2012
Signature: JOHN J. MAFFEI	Date
Building Commissioner/Inspector of Buildings:	

SECTION 1 : SITE INFORMATION

1.1 Property Address WS ROCKDALE AVE	1.2 Assessors Map & Parcel Number 68-155
1.3 Zoning Information RA Zoning District	1.4 Property Dimensions 17135 Lot Area Frontage (ft)

1.5 Building Setbacks (ft)					
Front Yard		Side Yard		Rear Yard	
Required	Provided	Required	Provided	Required	Provided
20.00	45.00	8.00	12.00	30.00	148.00
1.6 Water Supply	False	1.7 Flood Zone Information		1.8 Sewage Disposal	False

SECTION 2: PROPERTY AUTHORIZED AGENT

Agent of Record					
JOHN J. MAFFEI		110 BREEDS HILL RD. #10		HYANNIS	MA 02601
Name		Address			

SECTION 3: Description of Proposed Work

Permit For: Foundations Only 1-2 Family - 100.00
Brief Description of Proposed Work: Foundation only

SECTION 4: Estimated Construction Costs / Permit Fees

Total Project Cost : \$9,780.00	Payment Date 10/4/2012	Amount Paid \$100.00	Check No 3484
Total Permit Fee Paid: \$100.00	Account Number : 0001 240 44300 000		

THIS IS NOT A PERMIT



Commonwealth of Massachusetts

City of New Bedford

133 William Street New Bedford, MA 02740

SEWER PERMIT



Date: 11/13/2012

No. WW-12-40

Sewer Connection Fee: \$450.00

Pipe Size: 0.00

Trench Length: 0.00

Service Location: WS ROCKDALE AVE

Owner Name: RBB DEVELOPMENT

Type of Occupancy: Residential

Type of Work: Sewer - New Sewer Service

Work Description: Connecting to stub at Property Line formerly known as 1143 Rockdale Avenue. Now (W.S.) Rockdale Ave - 125+/- x Eastland Terrace SEWER PERMIT# 24313

No. of Units : 0 Required Design Daily Flow : 0.00 Provided Daily Flow : 0.00

The undersigned petitions you to grant permission to ENTER INTO THE MAIN SEWER and, if such permission is granted, hereby agrees to the following:

1. To abide by the conditions and regulations imposed by the Commissioner of Public Works by statute or by ordinance now in force, or as amended from time to time.
2. That the connection of said sewer with the main sewer shall be inspected by an employee of the department of Public Works or by a designated agent of the Town before burial of said connection.
3. That the work shall at all times be under the direction and control of the Commissioner of Public Works or his authorized agent, and that any expense incurred by the Town shall be charged to the permittee, and said permittee agrees to reimburse the Town for said expense.

Installing Company Name: License Type:

Address: City/Town/State:

GRANTED WITH THE USUAL CONDITIONS

COMMISSIONER

103

68

7-17-2011	OUT OF LOT 3	FB 168-72	930-170
	FRB DEVELOPMENT, LLC		
4-5-2012	PAGE INTO LOT 158	FB 169-3	934-195

THIS LOT TO
INCLUDE P141/L184,
WHICH IS TO BE
TRANSFERRED TO P168/
LIST. ONCE DEEDS
RECEIVED PUTTING INTO
COMMON OWNERSHIP.
(PO 169-7)

WCSmith

ROCKDALE AVE.

11/20/12 RJ

DOMIGUEL 19

© Gmail

