



PERMIT NO.

CITY OF NEW BEDFORD  
SEWER AND/OR STORM DRAIN PERMIT

DATE 11-2-12

Exp. 11-2-13

24311

This certifies that permission is granted to

Property Owner

Address

Tel.

To connect a sewer and/or storm drain located at

Assessor's Plot 93 Lot 201, to the sewer and/or storm drain in Veterans Memorial Way Street

To be laid in accordance with the conditions in this application and the City of New Bedford ordinances.

TYPE OF USE: RESIDENTIAL COMMERCIAL INDUSTRIAL FLOW 220 G.P.D.

If applicant other than actual property owner, attach Letter of Authorization from Property Owner.

Name..... Tel.....

Mailing Address.....

The Bonded Contractor/Drain Layer authorized to perform this work is:

Name..... Address..... Tel. 308-763-8865

Type of Pipe Required: 35 PVC

PERMIT EXPIRES ONE YEAR AFTER DATE OF ISSUE

- Requires separate connections for sewage and storm drain where applicable. Storm water cannot be discharged to a sanitary sewer.
- All work must be inspected and approved by a D.P.I. inspector before backfilling.
- If this connection is to be part of a private service shared jointly with other building owners, attach copy of Recorded Joint Maintenance Agreement.
- Permits can be issued to Industrial and/or Commercial Applicants only upon receipt and approval by the Commissioner of Public Infrastructure of required plans and supplemental information.
- In addition, a City-issued Industrial User Discharge Permit and/or a Sewer Extension/Connection Permit issued by the Commonwealth of Massachusetts D.E.P. shall be required by the City for Industrial Discharge into the sewer system.

Industrial User Discharge Permit No..... Date.....

Comm. Mass. Sewer Conn./Ext. Permit No..... Date.....

A Filing and Inspection Fee of \$ 400, plus an Entrance Fee of \$..... where applicable, must accompany this application.

Bank# Bristol County Savings Bank Check# 16768 Date 11/2/12 Receipt# 09647

Other requirements: Please call ahead 24 hr notice for inspection

Connection made to Sewer Part of jointly-shared private line YES NO no permit slip  
Storm Drain

Applicant agrees to abide by the above terms, as well as all pertinent ordinances of the City of New Bedford, and such other special rules as the Commissioner of Public Infrastructure and/or City Engineer may deem necessary

Manuel H. Silva City Engineer  
Supervising Civil Engineer  
[Signature] Signature of Property Owner or Representative

INSPECTOR'S REPORT

INSPECTED BY: \_\_\_\_\_  
DATE: \_\_\_\_\_  
COMMENTS: \_\_\_\_\_

APPROVED

DIS

SIGNATURE

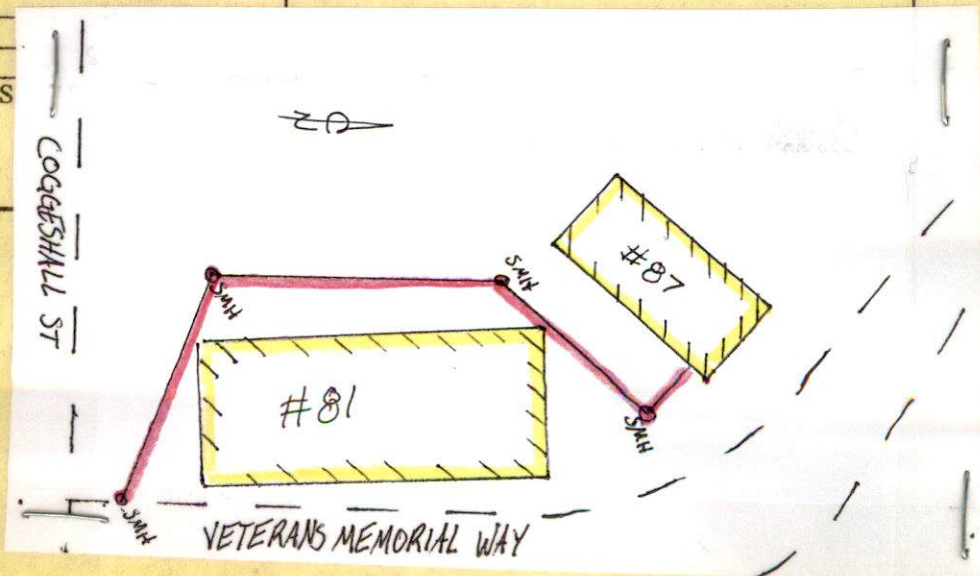

WW-12-39



PERMIT NO.

CITY OF NEW BEDFORD  
SEWER AND/OR STORM DRAIN PERMIT

DATE 11-2-12  
Exp. 11-2-13

24311

This certifies that permission is granted to

Property Owner Highway View LLC Address 1266 former Brook Parkway Quincy, MA 02169 Tel. (508) 947-6050  
Furnace  
Contact person: Rich Phoaum

To connect a sewer and/or storm drain located at (TACO BELL) - Riverside Landing #85  
N.W.C. x Coggeshall St / Veterans Memorial Way

Assessor's Plot 93 Lot 201, to the sewer and/or storm drain in Veterans Memorial Way (6" inch sewer)  
N.W.C. Intersection x Coggeshall Street

To be laid in accordance with the conditions in this application and the City of New Bedford ordinances.

TYPE OF USE: RESIDENTIAL COMMERCIAL INDUSTRIAL FLOW 220 G.P.D.

If applicant other than actual property owner, attach Letter of Authorization from Property Owner.

Name..... Tel.....

Mailing Address.....

The Bonded Contractor/Drain Layer authorized to perform this work is:

D.W. White 867 Middle Rd. Acushnet, MA

Name Address Tel. 508-763-8868

Type of Pipe Required: SD 35 PVC

PERMIT EXPIRES ONE YEAR AFTER DATE OF ISSUE

- Requires separate connections for sewage and storm drain where applicable. Storm water cannot be discharged to a sanitary sewer.
- All work must be inspected and approved by a D.P.I. inspector before backfilling.
- If this connection is to be part of a private service shared jointly with other building owners, attach copy of Recorded Joint Maintenance Agreement.
- Permits can be issued to Industrial and/or Commercial Applicants only upon receipt and approval by the Commissioner of Public Infrastructure of required plans and supplemental information.
- In addition, a City-issued Industrial User Discharge Permit and/or a Sewer Extension/Connection Permit issued by the Commonwealth of Massachusetts D.E.P. shall be required by the City for Industrial Discharge into the sewer system.

Industrial User Discharge Permit No..... Date.....

Comm. Mass. Sewer Conn./Ext. Permit No..... Date.....

A Filing and Inspection Fee of \$40.00, plus an Entrance Fee of \$..... where applicable, must accompany this application.

Bank# Bristol County Savings Bank Check# 16768 Date 11/2/12 Receipt# 09647

Other requirements: Please call ahead 24 hr notice for inspection. (508) 941-6050. Per Ron LaBelle - issue permits even if necessary paperwork missing. No foundation as built. no permit slip.

Connection made to Sewer Part of jointly-shared private line YES NO  
Storm Drain

Applicant agrees to abide by the above terms, as well as all pertinent ordinances of the City of New Bedford, and such other special rules as the Commissioner of Public Infrastructure and/or City Engineer may deem necessary

Marcus H. Silva, Esq. City Engineer  
Supervising Civil Engineer  
Signature of Property Owner or Representative

INSPECTOR'S REPORT

INSPECTED BY: \_\_\_\_\_  
DATE: \_\_\_\_\_  
COMMENTS: \_\_\_\_\_

APPROVED \_\_\_\_\_ DISAPPROVED \_\_\_\_\_

SIGNATURE

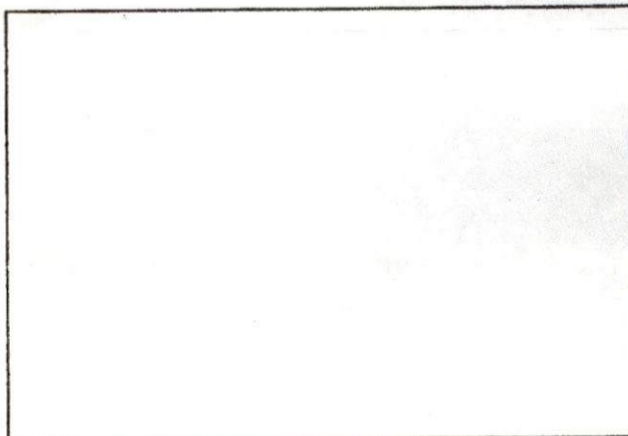

SKETCH PLAN



Commonwealth of Massachusetts

# City of New Bedford

133 William Street New Bedford, MA 02740

## SEWER PERMIT



Date: **11/7/2012**

No. **WW-12-39**

Sewer Connection Fee: **\$450.00**

Pipe Size: **0.00**

Trench Length: **0.00**

Service Location: **NS COGGESHALL ST**

Owner Name: **HIGHWAYVIEW LLC C/O**

Type of Occupancy: **Commercial**

Type of Work: **Sewer - New Sewer Service**

Work Description: **DPI SEWER PERMIT # 24311 - TACO BELL RIVERSIDE LANDING - INSTALL SEWER SERVICE TO 6" SEWER MAIN IN VETERANS MEMORIAL WAY - NWC OF INTERSECTION WITH COGGESHALL ST**

No. of Units : **0** Required Design Daily Flow : **0.00** Provided Daily Flow : **0.00**

The undersigned petitions you to grant permission to ENTER INTO THE MAIN SEWER and, if such permission is granted, hereby agrees to the following:

1. To abide by the conditions and regulations imposed by the Commissioner of Public Works by statute or by ordinance now in force, or as amended from time to time.
2. That the connection of said sewer with the main sewer shall be inspected by an employee of the department of Public Works or by a designated agent of the Town before burial of said connection.
3. That the work shall at all times be under the direction and control of the Commissioner of Public Works or his authorized agent, and that any expense incurred by the Town shall be charged to the permittee, and said

permittee

agrees to reimburse the Town for said expense.

Installing Company Name: **DW White**

License Type: **DPI - Other**

Address: **867 Middle Road**

City/Town/State: **Acushnet**

**MA**

**GRANTED WITH THE USUAL CONDITIONS**

COMMISSIONER

Attach to Taco Bell Permit

JOINT SEWER MAINTENANCE AGREEMENT

In consideration of the City of New Bedford permitting

Highwayview LLC MARK C DICKINSON, MGR  
(Names and Addresses of Owners)

Highwayview LLC is owner of said parcels  
to make connection to a public sewer, the said parties hereto, their  
heirs and/or assigns, being owners of property located at

25 Coggeshall St. Plot 93/Lot 269  
(Addresses and Plot & Lot Nos.)

do hereby agree to bear jointly the cost of maintaining the private  
sewer serving the above described properties, from the point where  
the individual house sewers combine into a single pipe to the point  
where said single pipe enters into the public sewer.

However, in cases in which the location requiring maintenance is  
found to be behind or above the point of connection of one or more  
of the above described individual house sewers, the cost shall be  
borne jointly by those remaining property owners which have joint use  
of the private sewer at such location.

WITNESS TO ALL:

Tanya Warner

OWNERS INVOLVED:

Mark C. Dickinson  
Mark C. Dickinson

COMMONWEALTH OF MASSACHUSETTS

Bristol, ss

New Bedford

3-14-13  
(Date)

Then personally appeared the above named

Mark C. Dickinson

and made oath that the above is their free act and deed,  
before me

Marilyn M. Skypeck  
Notary Public



NOTARY PUBLIC  
Marilyn M. Skypeck  
Commonwealth of Massachusetts  
My Commission Expires Jan. 3, 2014

CITY CLERKS OFFICE  
NEW BEDFORD, MA

2012 MAY 22 P 2:27

CITY CLERK

I, *Donna Banu*, Administrative Assistant to the Board of  
Assessors of the City of New Bedford, do hereby certify that the names and addresses as  
identified on the attached "Abutters List" are duly recorded and appear on the most recent  
tax.

Date: 2/22/12

SUBJECT PROPERTY:

MAP 93-2 LOT 264

LOCATION NS Coggeshall STREET A/K AS 85 Coggeshall

OWNER'S NAME Highwayview LLC FURNACE BROOK PARK

MAILING ADDRESS C/O Dickinson Dev. Corp. 1266 Courtney Rd 02110

CONTACT PERSON RICK RHEAUME "PRIME ENGINEERING"

TELEPHONE NUMBER 508-947-0050

REASON FOR REQUEST

- SITE PLAN / PLANNING BOARD  
SPECIAL PERMIT

Lot 120

Project Area

SAWYER ST

MITCHELL ST

Lot 284

Lot 263

Plot 93  
Lot 265

Plot 93  
Lot 264

COGGESHALL ST

Commonweath of Mass

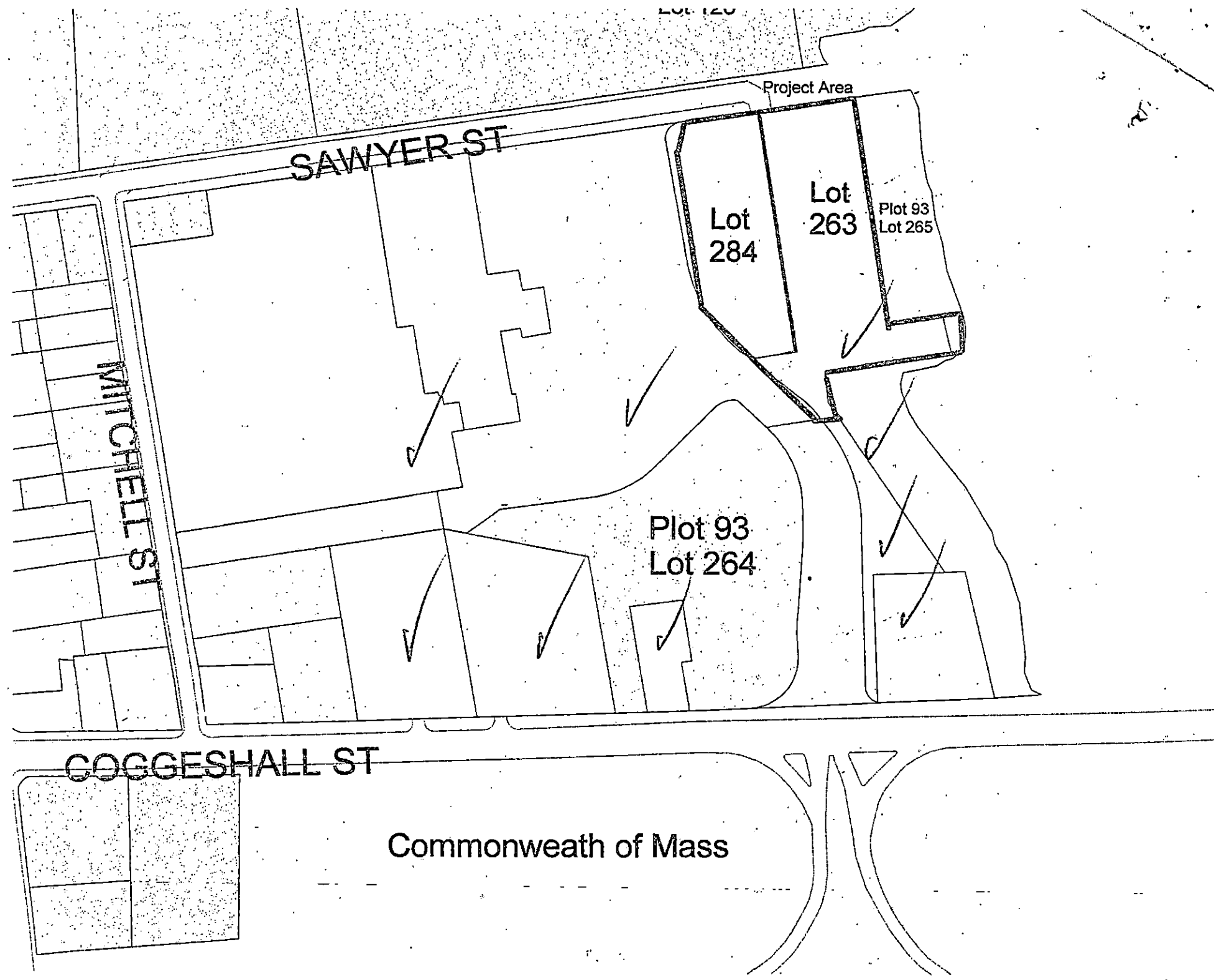

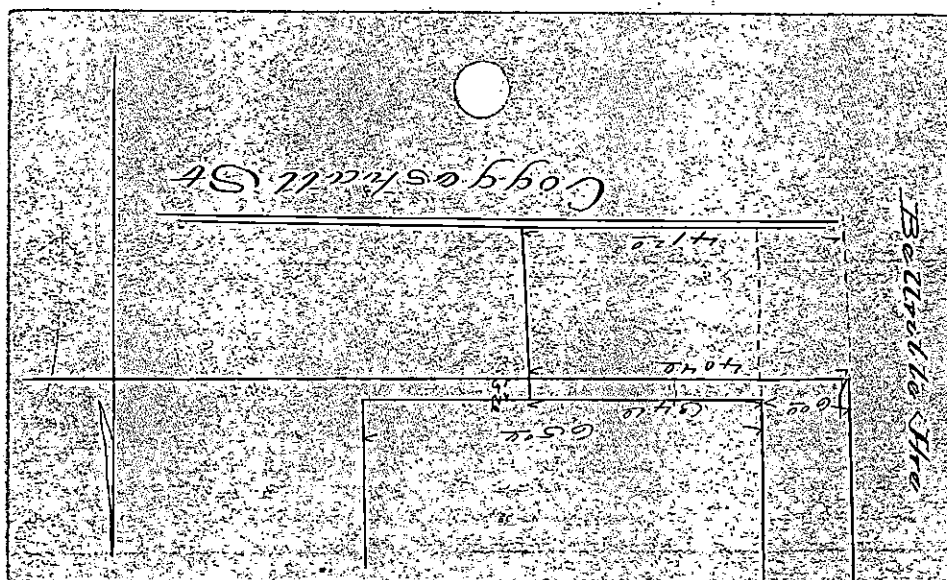

DRAIN

Permit

No. 1296-1892

Coggeshall St

Mitchell to Bellville Ave

Entered Coggeshall St. New

412<sup>nd</sup> of Bellville Ave. 6<sup>th</sup> P, October 27, 1892

at 2 P. M. by John Holland

From property of

Daniel Fanten

Located

Coggeshall n.e. 40<sup>th</sup> of Bellville Ave

Account

Miss. Ledger 316