



PERMIT NO.

24303

CITY OF NEW BEDFORD
SEWER AND/OR STORM DRAIN PERMITDATE 10/11/12
Exp. 10/11/13This certifies that permission is granted to 218 Willard St
Stephen Ricciardi P.O. Box 690307 Quincy, MA 02269
Property Owner Address ES Tel. 617-479-3434To connect a sewer and/or storm drain located at Riverside Ave & Belleville AveAssessor's Plot 105 Lot 170, to the sewer and/or storm drain in Riverside Ave - into sewer Street
storm drain on private property max hole

To be laid in accordance with the conditions in this application and the City of New Bedford ordinances.

TYPE OF USE: RESIDENTIAL COMMERCIAL INDUSTRIAL FLOW G.P.D.

If applicant other than actual property owner, attach Letter of Authorization from Property Owner.

Name Alan Caldwell Tel. 617-479-3434
Mailing Address P.O. Box 690307 Quincy, MA 02269

The Bonded Contractor/Drain Layer authorized to perform this work is:

Vicira & Sons, Inc. 1145 Bank St. Swansea, MA 02777
Name Address Tel. 508-674-8976
Type of Pipe Required: 11" SDR 35

PERMIT EXPIRES ONE YEAR AFTER DATE OF ISSUE

- Requires separate connections for sewage and storm drain where applicable. Storm water cannot be discharged to a sanitary sewer.
 - All work must be inspected and approved by a D.P.I. inspector before backfilling.
 - If this connection is to be part of a private service shared jointly with other building owners, attach copy of Recorded Joint Maintenance Agreement.
 - Permits can be issued to Industrial and/or Commercial Applicants only upon receipt and approval by the Commissioner of Public Infrastructure of required plans and supplemental information.
 - In addition, a City-issued Industrial User Discharge Permit and/or a Sewer Extension/Connection Permit issued by the Commonwealth of Massachusetts D.E.P. shall be required by the City for Industrial Discharge into the sewer system.
- Industrial User Discharge Permit No. _____ Date _____

Comm. Mass. Sewer Conn./Ext. Permit No. _____ Date _____
A Filing and Inspection Fee of \$ 450, plus an Entrance Fee of \$ _____ where applicable, must accompany this application.Bank# Eastern Bank Check# 1644 Date 10/5/12 Receipt# 9620Other requirements: Must meet all conditions as per site plan review for drainage system & sewer. Will have to submit revised plan showing relocation of stormceptor for D.P.I. approval - Must provide City with m.a.s.s. of recorded easements if any part of sewer or drainage system crosses into adjacent lots not owned by applicant
Connection made to Sewer Part of jointly-shared private line YES ☒ NO ☐
Storm Drain

Applicant agrees to abide by the above terms, as well as all pertinent ordinances of the City of New Bedford, and such other special rules as the Commissioner of Public Infrastructure and/or City Engineer may deem necessary

Manuel H. Silva
City EngineerStephen Ricciardi
Signature of Property Owner or Representative

INSPECTOR'S REPORT

INSPECTED BY: _____

DATE: _____

COMMENTS: _____

APPROVED _____

DISAP _____

SEE WHITE COPY

SIGNATURE

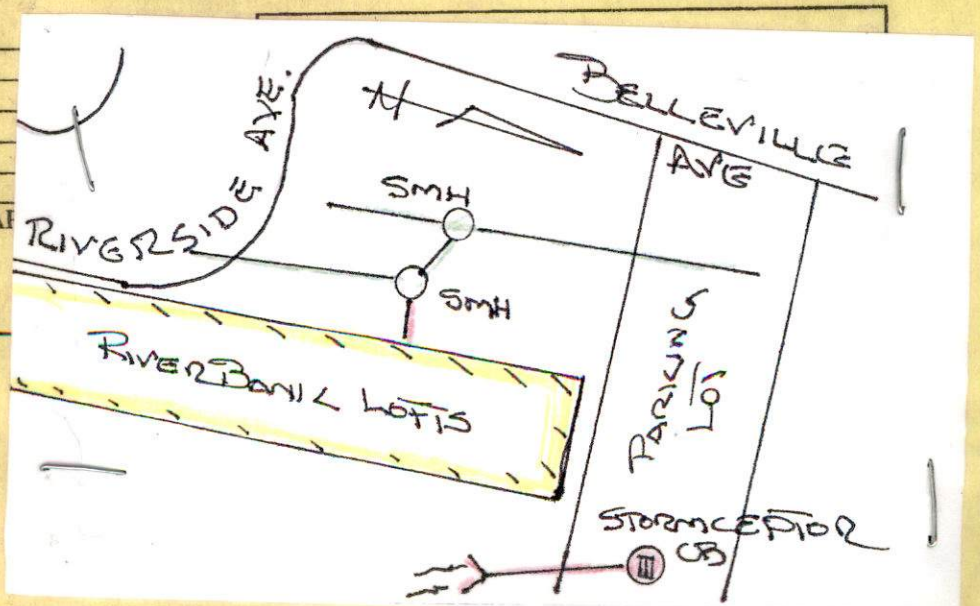

Inspector



PERMIT NO.

24303 *WW-12-33*

CITY OF NEW BEDFORD
SEWER AND/OR STORM DRAIN PERMIT

DATE *10/11/12*
Exp. *10/11/13*

This certifies that permission is granted to *218 Willard St.*

Property Owner *Stephen Ricciardi* Address *P.O. Box 690307 Quincy, MA 02269* Tel. *617-479-2434*

To connect a sewer and/or storm drain located at *Riverside Ave + ES Belleville Ave*

Assessor's Plot *105* Lot *170*, to the sewer and/or storm drain in *Riverside Ave - into sewer Street*
Storm drain on private property *market*

To be laid in accordance with the conditions in this application and the City of New Bedford ordinances.

TYPE OF USE: RESIDENTIAL COMMERCIAL INDUSTRIAL FLOW G.P.D.

If applicant other than actual property owner, attach Letter of Authorization from Property Owner.

Name *Alan Caldwell* Tel.
Mailing Address *P.O. Box 690307 Quincy, MA 02269*

The Bonded Contractor/Drain Layer authorized to perform this work is:

Vieira & Sons, Inc. Address *1145 Bank St. Swansea, MA 02777* Tel. *508-674-8976*
Name Address Tel.
Type of Pipe Required: *10" SDR 35*

PERMIT EXPIRES ONE YEAR AFTER DATE OF ISSUE

- Requires separate connections for sewage and storm drain where applicable. Storm water cannot be discharged to a sanitary sewer.
 - All work must be inspected and approved by a D.P.I. inspector before backfilling.
 - If this connection is to be part of a private service shared jointly with other building owners, attach copy of Recorded Joint Maintenance Agreement.
 - Permits can be issued to Industrial and/or Commercial Applicants only upon receipt and approval by the Commissioner of Public Infrastructure of required plans and supplemental information.
 - In addition, a City-issued Industrial User Discharge Permit and/or a Sewer Extension/Connection Permit issued by the Commonwealth of Massachusetts D.E.P. shall be required by the City for Industrial Discharge into the sewer system.
- Industrial User Discharge Permit No. Date

Comm. Mass. Sewer Conn./Ext. Permit No. Date
A Filing and Inspection Fee of \$ *450*, plus an Entrance Fee of \$ where applicable, must accompany this application.

Bank# *Eastern Bank* Check# *1644* Date *10/5/12* Receipt# *9620*

Other requirements: *Must meet all conditions as per site plan review for drainage system + sewer. Will have to submit revised plan showing relocation of stormceptor for D.P.I. approval - Must provide City with copies of recorded sewer easements if any part of sewer or drainage system crosses into adjacent lots not owned by applicant*

Connection made to Storm Drain Part of jointly-shared private line YES ☒ NO ☐

Applicant agrees to abide by the above terms, as well as all pertinent ordinances of the City of New Bedford, and such other special rules as the Commissioner of Public Infrastructure and/or City Engineer may deem necessary

Manuel H. Silva *cs*
City Engineer
Superising Civil Engineer

Alan Caldwell
Signature of Property Owner or Representative

INSPECTOR'S REPORT

INSPECTED BY: *JP*
DATE: *9/6/13*
COMMENTS:

APPROVED

DISAPPROVED

SIGNATURE

SKETCH PLAN



PERMIT NO.

24303

1 WW-12-33

CITY OF NEW BEDFORD
SEWER AND/OR STORM DRAIN PERMIT

DATE 10/11/12
Exp. 10/11/13

This certifies that permission is granted to

Stephen Ricciardi, P.O. Box 690307, Quincy, MA 02269
Property Owner Address Tel. 617-479-2434

To connect a sewer and/or storm drain located at Riverside Ave & ES Belleville Ave

Assessor's Plot 105 Lot 170, to the sewer and/or storm drain in Riverside Ave - into sewer
storm drain on private property manhole

To be laid in accordance with the conditions in this application and the City of New Bedford ordinances.

TYPE OF USE: RESIDENTIAL COMMERCIAL INDUSTRIAL FLOW G.P.D.

If applicant other than actual property owner, attach Letter of Authorization from Property Owner.

Name Alan Caldwell, 218 Willard St, Tel. 617-479-2424

Mailing Address P.O. Box 690307, Quincy, MA 02269

The Bonded Contractor/Drain Layer authorized to perform this work is:

Vieira & Sons, Inc., 1145 Bank St, Swansea, MA 02777
Name Address Tel. 508-674-8976

Type of Pipe Required: 10" SDR 35

PERMIT EXPIRES ONE YEAR AFTER DATE OF ISSUE

- Requires separate connections for sewage and storm drain where applicable. Storm water cannot be discharged to a sanitary sewer.
- All work must be inspected and approved by a D.P.I. inspector before backfilling.
- If this connection is to be part of a private service shared jointly with other building owners, attach copy of Recorded Joint Maintenance Agreement.
- Permits can be issued to Industrial and/or Commercial Applicants only upon receipt and approval by the Commissioner of Public Infrastructure of required plans and supplemental information.
- In addition, a City-issued Industrial User Discharge Permit and/or a Sewer Extension/Connection Permit issued by the Commonwealth of Massachusetts D.E.P. shall be required by the City for Industrial Discharge into the sewer system.

Industrial User Discharge Permit No. Date

Comm. Mass. Sewer Conn./Ext. Permit No. Date

A Filing and Inspection Fee of \$450, plus an Entrance Fee of \$, where applicable, must accompany this application.

Bank# Eastern Bank Check# 1644 Date 10/5/12 Receipt# 9620

Other requirements: Must meet all conditions as per site plan review for drainage system & sewer. Will have to submit revised plan showing relocation of stormceptor for D.P.I. approval. Must provide City with copies of recorded easements if any part of sewer or drainage system crosses into adjacent lots not owned by applicant

Connection made to Sewer Storm Drain Part of jointly-shared private line YES NO

Applicant agrees to abide by the above terms, as well as all pertinent ordinances of the City of New Bedford, and such other special rules as the Commissioner of Public Infrastructure and/or City Engineer may deem necessary

Manuel H. Silva, es
City Engineer

Signature of Property Owner or Representative

Supervising Civil Engineer

INSPECTOR'S REPORT

INSPECTED BY: _____
DATE: _____
COMMENTS: _____

APPROVED DISAPPROVED

SIGNATURE

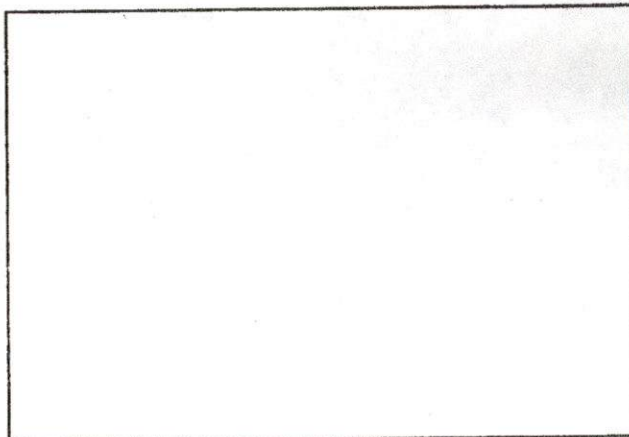

SKETCH PLAN

ACORN MANAGEMENT
ALAN CALDWELL

218 Willard Street
Quincy, MA 02169
Tel: 617-479-2424
Fax: 617-773-3840
Cell: 781-589-2000

ac7754@comcast.net



Department of Public Infrastructure

Ronald H. Labelle
Commissioner

CITY OF NEW BEDFORD

Jonathan F. Mitchell, Mayor

Water
Wastewater
Highways
Engineering
Cemetery

To Whom It May Concern:

River bank lifts, LLC
I STEPHEN RICCIARDI, P.O. BOX 690307, QUINCY, MASS, 02269, being
(Name) (Mailing Address)

Owner of property located at

~~200~~ RIVERSIDE AVENUE

Plot 105, Lot 170, hereby agree to allow ALAN CALDWELL
(Name)

of P.O. BOX 690307, QUINCY, MASS, 02269, to act on my behalf including affixing my
(Mailing Address)

signature in securing permit for:

☒ Sewer/Drain Service Permits
☒ Water Service Permits
☒ Driveway Installation Permits
☒ Sidewalk Installation Permits

I further agree to conform to, and abide by, All City rules and ask regulations applicable to the permit (s) being applied for:

Name Stephen Ricciardi
Signature
218 WILLARD ST, QUINCY MASS 02169
Address
9/26/12 617-479-2424
Date Telephone number