



PERMIT NO.

CITY OF NEW BEDFORD
SEWER AND/OR STORM DRAIN PERMITDATE 9/14/12
exp. 9/14/13

24296 EXTENSION

This certifies that permission is granted to

Property Owner Carlos DaCosta Address 510 Hawthorn St Dartmouth, MA 02747 Tel. 774-263-8134To connect a sewer and/or storm drain located at Sparrow St W x Robin StAssessor's Plot 138 Lot 244-249 to the sewer and/or storm drain in Sparrow St EXTENSION Streetinstall clean out 7' from curb install 100'-8" DI + small MH + connect to existing SMH in

To be laid in accordance with the conditions in this application and the City of New Bedford ordinances.

TYPE OF USE: RESIDENTIAL COMMERCIAL INDUSTRIAL FLOW G.P.D. Robin St

If applicant other than actual property owner, attach Letter of Authorization from Property Owner.

Name..... Tel.....

Mailing Address.....

The Bonded Contractor/Drain Layer authorized to perform this work is:

MKT EXCAVATING 1211'S WAY MAHARJOSEH MA 02739

Name..... Address..... Tel.....

Type of Pipe Required: SDR 35 PVC

PERMIT EXPIRES ONE YEAR AFTER DATE OF ISSUE

- Requires separate connections for sewage and storm drain where applicable. Storm water cannot be discharged to a sanitary sewer.
 - All work must be inspected and approved by a D.P.I. inspector before backfilling.
 - If this connection is to be part of a private service shared jointly with other building owners, attach copy of Recorded Joint Maintenance Agreement.
 - Permits can be issued to Industrial and/or Commercial Applicants only upon receipt and approval by the Commissioner of Public Infrastructure of required plans and supplemental information.
 - In addition, a City-issued Industrial User Discharge Permit and/or a Sewer Extension/Connection Permit issued by the Commonwealth of Massachusetts D.E.P. shall be required by the City for Industrial Discharge into the sewer system.
- Industrial User Discharge Permit No..... Date.....

Comm. Mass. Sewer Conn./Ext. Permit No..... Date.....
A Filing and Inspection Fee of \$ 450 plus an Entrance Fee of \$ 400 where applicable, must accompany this application.
Total \$850.00 EXT. FEEBank# St. Anne's C.U. Check# 775000 Date 9/14/12 Receipt# 9582Other requirements: 24 hour notice for inspection @ 508-991-6150. MUST file with DEP - BAPCompliance certification for sewer EXTENSIONS < 1000' (AD. printed w/ sewer permit)
Sewer main must be pressure tested before services can be tied into main - MUSTConnection made to Sewer Part of jointly-shared private line YES ☒ NO ☐ Be witnessed by DPI
ENGINEERING. Call to
Coordinate @ 508-991-6150

Applicant agrees to abide by the above terms, as well as all pertinent ordinances of the City of New Bedford, and such other special rules as the Commissioner of Public Infrastructure and/or City Engineer may deem necessary

M. E. Alia
City EngineerCarlos P. DaCosta
Signature of Property Owner or Representative

INSPECTOR'S REPORT

INSPECTED BY: [Signature]
DATE: 9/19/12
COMMENTS:

APPROVED

DISA

SIGNATURE

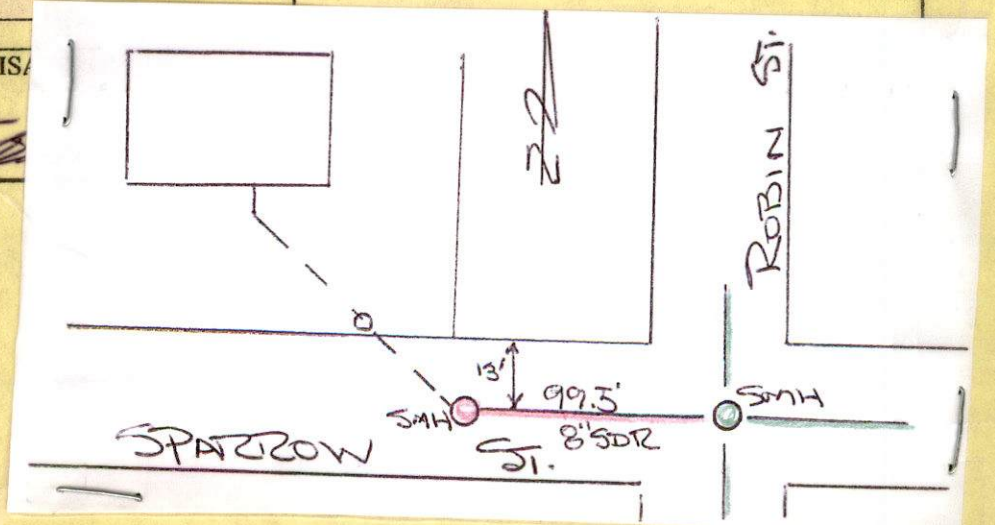

Engineer's

WW-12-24



PERMIT NO.

CITY OF NEW BEDFORD
SEWER AND/OR STORM DRAIN PERMIT

DATE 9/14/12

exp. 9/14/13

24296 EXTENSION

This certifies that permission is granted to

Property Owner Carlos DaCosta Address 510 Hawthorn St Dartmouth, MA 02747
Tel. 774-263-8134

To connect a sewer and/or storm drain located at Sparrow St w x Robin St 100 FT

Assessor's Plot 138 Lot 239, to the sewer and/or storm drain in Sparrow St EXTENSION
install clean out 4' from curb install 100' - 8" DI & 5' MH + connect to existing 5 MH EX
To be laid in accordance with the conditions in this application and the City of New Bedford ordinances.
TYPE OF USE: RESIDENTIAL COMMERCIAL INDUSTRIAL FLOW G.P.D. Robi

If applicant other than actual property owner, attach Letter of Authorization from Property Owner.

Name Mailing Address
The Bonded Contractor/Drain Layer authorized to perform this work is:
M.H.T. EXCAVATING, LLC 1411'S WAY MAHAPOSETT, MA 02739
Name Address Tel.
Type of Pipe Required: SDR 35 PVC

PERMIT EXPIRES ONE YEAR AFTER DATE OF ISSUE

- Requires separate connections for sewage and storm drain where applicable. Storm water cannot be discharged to a sanitary sewer.
 - All work must be inspected and approved by a D.P.I. inspector before backfilling.
 - If this connection is to be part of a private service shared jointly with other building owners, attach copy of Recorded Joint Maintenance Agreement.
 - Permits can be issued to Industrial and/or Commercial Applicants only upon receipt and approval by the Commissioner of Public Infrastructure of required plans and supplemental information.
 - In addition, a City-issued Industrial User Discharge Permit and/or a Sewer Extension/Connection Permit issued by the Commonwealth of Massachusetts D.E.P. shall be required by the City for Industrial Discharge into the sewer system.
- Industrial User Discharge Permit No. Date

Comm. Mass. Sewer Conn./Ext. Permit No. Date
A Filing and Inspection Fee of \$450, plus an Entrance Fee of \$400 where applicable, must accompany this application.
TOTAL \$850.00 EXT. FEE

Bank# St. Anne's C.U. Check# 775000 Date 9/14/12 Receipt# 9582

Other requirements: 24 hour notice for inspection @ 508-991-6150. MUST File with D.E.P. - BRP

Compliance certification for sewer EXTENSIONS < 1000' (App. printed w/ sewer permit.....
Sewer main must be pressure tested before services can be tied into main - MUST
Connection made to Sewer Part of jointly-shared private line YES (NO) Be witnessed by DPZ
Storm Drain ENGINEERING. Call to
Coordinate @ 508-991-6150

Applicant agrees to abide by the above terms, as well as all pertinent ordinances of the City of New Bedford, and such other special rules as the Commissioner of Public Infrastructure and/or City Engineer may deem necessary

Michel E. Silva
City Engineer
Chief of the Works

Carlos P. Da Costa
Signature of Property Owner or Representative

INSPECTOR'S REPORT

INSPECTED BY: [Signature]
DATE: 9/19/12
COMMENTS:

APPROVED

DISAPPROVED

SIGNATURE [Signature]

871/ENG

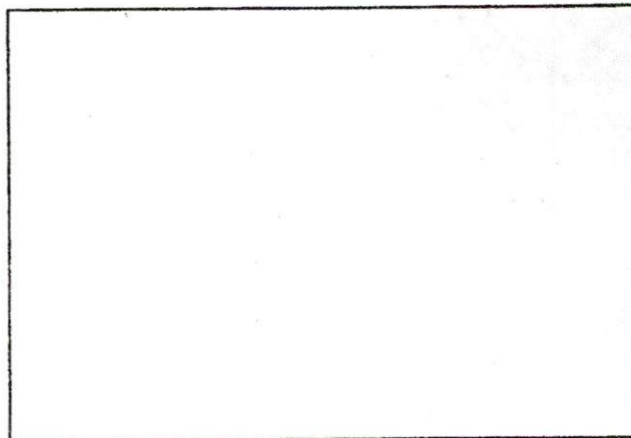

SKETCH PLAN

DISPLAY PERMIT IN A CONSPICUOUS PLACE ON THE PREMISES



Commonwealth of Massachusetts
City of New Bedford

133 William Street New Bedford, MA 02740

SEWER PERMIT



Date: **10/2/2012**

No. **WW-12-24**

Sewer Connection Fee: **\$850.00**

Pipe Size: **0.00**

Trench Length: **0.00**

Service Location: **NS SPARROW ST**

Owner Name: **DACOSTA CARLOSPINHANCOS**

Type of Occupancy: **Residential**

Type of Work: **Sewer - New Sewer Main**

Work Description: **SEWER EXTENSION PERMIT # 24296 - 100 FT - 8" DI SEWER EXTENSION IN SPARROW ST
- INSTALL SEWER MANHOLE & CONNECT TO SEWER MANHOLE IN ROBIN ST & INSTALL
CLEAN OUT 7' FROM CURB**

No. of Units : **3** Required Design Daily Flow : **330.00** Provided Daily Flow : **330.00**

The undersigned petitions you to grant permission to ENTER INTO THE MAIN SEWER and, if such permission is granted, hereby agrees to the following:

1. To abide by the conditions and regulations imposed by the Commissioner of Public Works by statute or by ordinance now in force, or as amended from time to time.
2. That the connection of said sewer with the main sewer shall be inspected by an employee of the department of Public Works or by a designated agent of the Town before burial of said connection.
3. That the work shall at all times be under the direction and control of the Commissioner of Public Works or his authorized agent, and that any expense incurred by the Town shall be charged to the permittee, and said permittee agrees to reimburse the Town for said expense.

Installing Company Name: _____ License Type: _____

Address: _____ City/Town/State: _____

GRANTED WITH THE USUAL CONDITIONS

COMMISSIONER

Call (781) 942-9077 For Inspection

SPARROW St

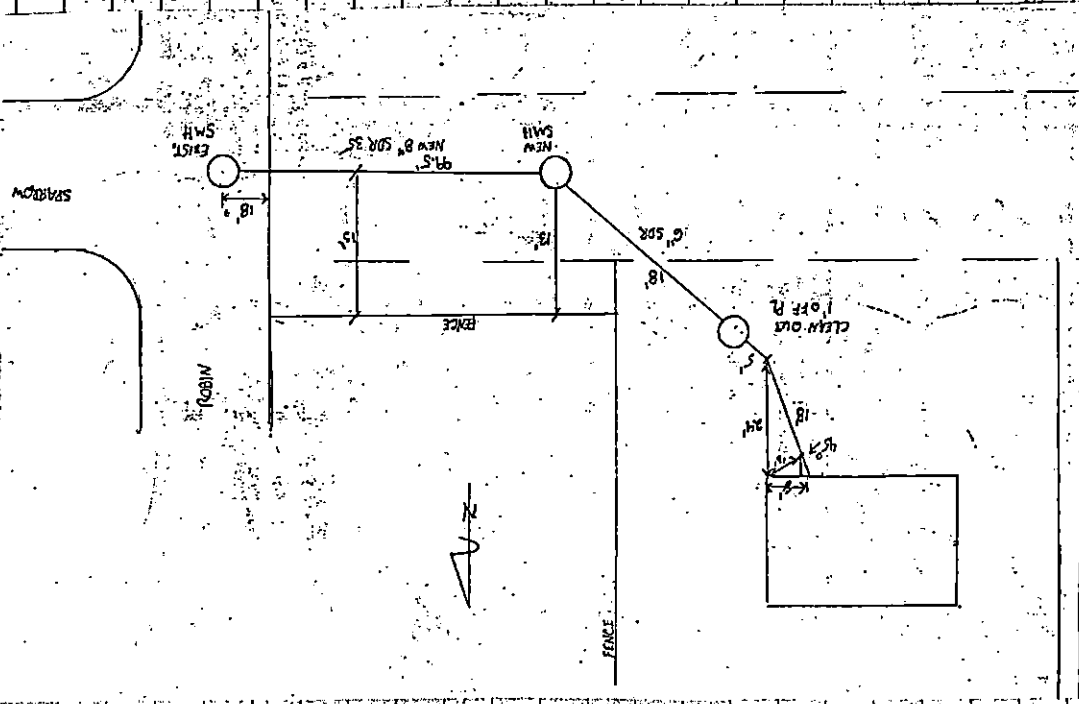

SEWER INSPECTION/TIE IN	
DATE: 9/19/2012	
CONTRACTOR: MHT EXCAVATING	
INSP: R BICHEL	
PERMIT #: 24296	
PLOT 138 LOT 239	
2" SEWER MAIN PRESSED HEAD TESTING ON 10/24/12	
SUBT. DON REYNOLDS	
L. REYNOLDS	