



PERMIT NO.

CITY OF NEW BEDFORD
SEWER AND/OR STORM DRAIN PERMITDATE 5/30/12
exp. 5/30/13

24281

This certifies that permission is granted to

Property Owner Robert Gomes Address 973 Pembroke St. New Bedford, MA Tel. 508-243-5919To connect a sewer and/or storm drain located at Pembroke St. #973Assessor's Plot 134 Lot 168, to the sewer and/or storm drain in Pembroke St. Street

To be laid in accordance with the conditions in this application and the City of New Bedford ordinances.

TYPE OF USE: RESIDENTIAL COMMERCIAL INDUSTRIAL FLOW 330 G.P.D.

If applicant other than actual property owner, attach Letter of Authorization from Property Owner.

Name..... Tel.....

Mailing Address.....

The Bonded Contractor/Drain Layer authorized to perform this work is:

RJ Canessa PO Box 51643 New Bedford, MA 508-998-3404

Name..... Address..... Tel.....

Type of Pipe Required: 2" PVC SDR-35

PERMIT EXPIRES ONE YEAR AFTER DATE OF ISSUE

- Requires separate connections for sewage and storm drain where applicable. Storm water cannot be discharged to a sanitary sewer.
 - All work must be inspected and approved by a D.P.I. inspector before backfilling.
 - If this connection is to be part of a private service shared jointly with other building owners, attach copy of Recorded Joint Maintenance Agreement.
 - Permits can be issued to Industrial and/or Commercial Applicants only upon receipt and approval by the Commissioner of Public Infrastructure of required plans and supplemental information.
 - In addition, a City-issued Industrial User Discharge Permit and/or a Sewer Extension/Connection Permit issued by the Commonwealth of Massachusetts D.E.P. shall be required by the City for Industrial Discharge into the sewer system.
- Industrial User Discharge Permit No. Date

Comm. Mass. Sewer Conn./Ext. Permit No. Date

A Filing and Inspection Fee of \$....., plus an Entrance Fee of \$..... where applicable, must accompany this application.

Bank#..... Check#..... Date..... Receipt#.....

Other requirements: Insp. Only: Contractor to connect to end of stub
in Pembroke St. main, Abandon Septic SystemConnection made to Sewer Part of jointly-shared private line YES NO
Storm Drain

Applicant agrees to abide by the above terms, as well as all pertinent ordinances of the City of New Bedford, and such other special rules as the Commissioner of Public Infrastructure and/or City Engineer may deem necessary

Michelle E. Silva
City Engineer
Clerk of the Works[Signature]
Signature of Property Owner or Representative

INSPECTOR'S REPORT

INSPECTED BY: [Signature]
DATE: 6/7/12
COMMENTS:

APPROVED

DISAPPROVED

SIGNATURE

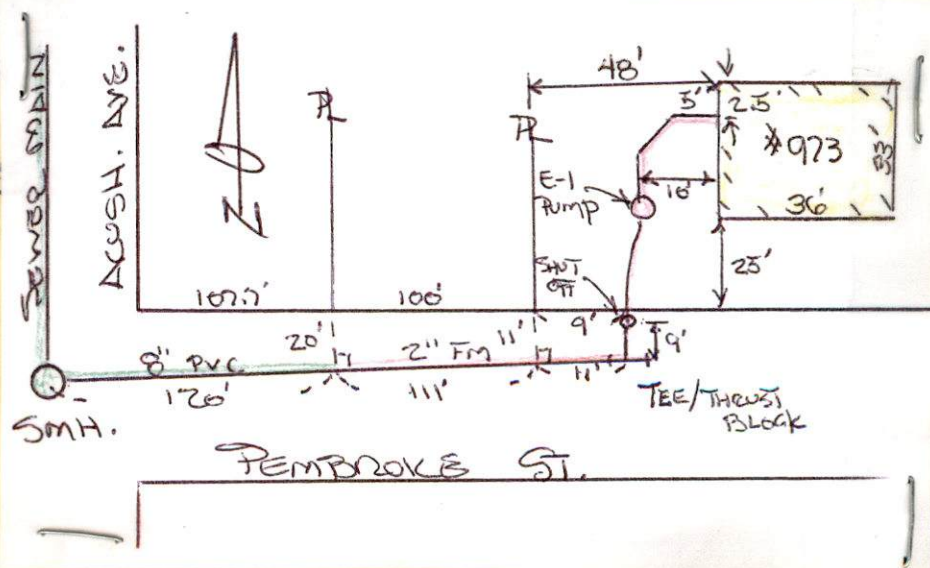

ww-12-8



PERMIT NO.

CITY OF NEW BEDFORD
SEWER AND/OR STORM DRAIN PERMIT

DATE 5/30/12
exp. 5/30/13

24281

This certifies that permission is granted to

Robert Gomes 973 Pembroke St. New Bedford, MA 508-243-5919
Property Owner Address Tel.

To connect a sewer and/or storm drain located at Pembroke St. #973

Assessor's Plot 134 Lot 168, to the sewer and/or storm drain in Pembroke St. Street

To be laid in accordance with the conditions in this application and the City of New Bedford ordinances.

TYPE OF USE: RESIDENTIAL COMMERCIAL INDUSTRIAL FLOW 330 G.P.D.

If applicant other than actual property owner, attach Letter of Authorization from Property Owner.

Name..... Tel.....

Mailing Address.....

The Bonded Contractor/Drain Layer authorized to perform this work is:

R.J. Canessa PO Box 51643 New Bedford, MA 508-998-3404
Name Address Tel.

Type of Pipe Required: 2" PVC SDR-35

PERMIT EXPIRES ONE YEAR AFTER DATE OF ISSUE

- Requires separate connections for sewage and storm drain where applicable. Storm water cannot be discharged to a sanitary sewer.
- All work must be inspected and approved by a D.P.I. inspector before backfilling.
- If this connection is to be part of a private service shared jointly with other building owners, attach copy of Recorded Joint Maintenance Agreement.
- Permits can be issued to Industrial and/or Commercial Applicants only upon receipt and approval by the Commissioner of Public Infrastructure of required plans and supplemental information.
- In addition, a City-issued Industrial User Discharge Permit and/or a Sewer Extension/Connection Permit issued by the Commonwealth of Massachusetts D.E.P. shall be required by the City for Industrial Discharge into the sewer system.

Industrial User Discharge Permit No..... Date.....

Comm. Mass. Sewer Conn./Ext. Permit No..... Date.....

A Filing and Inspection Fee of \$....., plus an Entrance Fee of \$..... where applicable, must accompany this application.

Bank#..... Check#..... Date..... Receipt#.....
N/C per Zeb

Other requirements: Insp. Only - Contractor to connect to end of stub

in Pembroke St. main, Abandon Septic System

Connection made to Sewer Part of jointly-shared private line YES NO
Storm Drain

Applicant agrees to abide by the above terms, as well as all pertinent ordinances of the City of New Bedford, and such other special rules as the Commissioner of Public Infrastructure and/or City Engineer may deem necessary

Michelle E. Silva
City Engineer
Clerk of the Works

[Signature]
Signature of Property Owner or Representative

INSPECTOR'S REPORT

INSPECTED BY: [Signature]
DATE: 6/1/12
COMMENTS:

APPROVED

DISAPPROVED

[Signature]
SIGNATURE

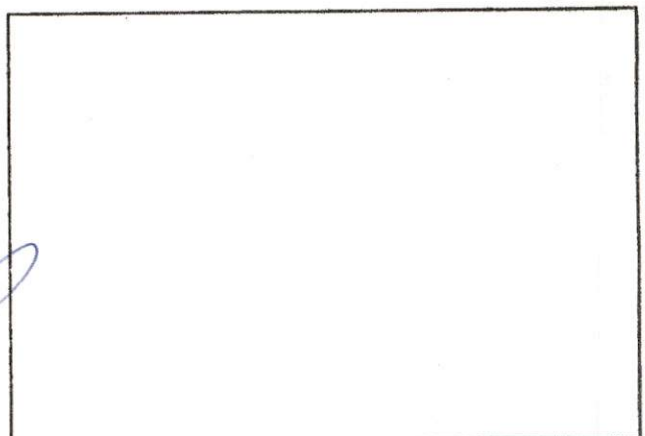

SKETCH PLAN

DISPLAY PERMIT IN A CONSPICUOUS PLACE ON THE PREMISES



Commonwealth of Massachusetts

City of New Bedford

133 William Street New Bedford, MA 02740

SEWER PERMIT



Date: 8/17/2012

No. WW-12-8

Sewer Connection Fee: \$0.00

Pipe Size: 2.00

Trench Length: 0.00

Service Location: 973 PEMBROKE ST

Owner Name: GOMES ROBERT GOMES DEBRA

Type of Occupancy: Residential

Type of Work: Sewer - New Sewer Service

Work Description:

No. of Units : 3 Required Design Daily Flow : 330.00 Provided Daily Flow : 330.00

The undersigned petitions you to grant permission to ENTER INTO THE MAIN SEWER and, if such permission is granted, hereby agrees to the following:

1. To abide by the conditions and regulations imposed by the Commissioner of Public Works by statute or by ordinance now in force, or as amended from time to time.
2. That the connection of said sewer with the main sewer shall be inspected by an employee of the department of Public Works or by a designated agent of the Town before burial of said connection.
3. That the work shall at all times be under the direction and control of the Commissioner of Public Works or his authorized agent, and that any expense incurred by the Town shall be charged to the permittee, and said permittee agrees to reimburse the Town for said expense.

Installing Company Name: Able Asphalt

License Type: HIC

Address: 128 Woodcock Road City/Town/State: South Dartmouth MA

GRANTED WITH THE USUAL CONDITIONS

COMMISSIONER

Call (781) 942-9077 For Inspection



Pembroke St

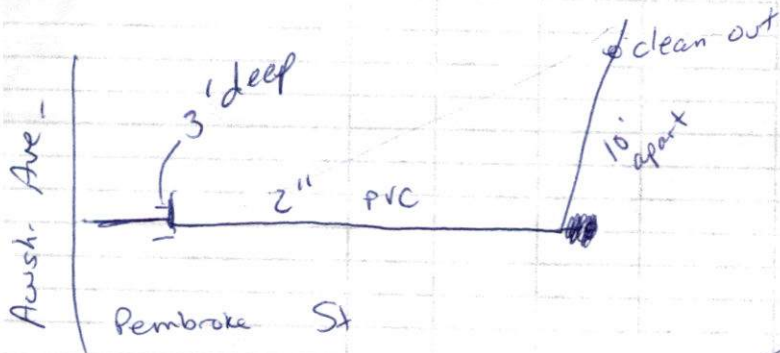

P. 134

L. 168

Robert Gomes
973 Pembroke St

To: Sarah

Fax: 961-3045

R.J. Canessa Excavation

P.O. Box 51643

New Bedford Mass 02745

Telephone (508) 998-3404

Fax (508) 998-3404

E-mail rcanessa964@comcast.net

sewer CONNECTION

At 973 Pembroke St.

