



PERMIT NO.

24278

CITY OF NEW BEDFORD  
SEWER AND/OR STORM DRAIN PERMIT

DATE 3/30/12  
Exp. 3/30/13

This certifies that permission is granted to

Property Owner TYMIL REALTY TRUST Address 129 Allen St New Bedford, MA 02740 Tel. \_\_\_\_\_

To connect a sewer and/or storm drain located at 129 Allen St

Assessor's Plot 41 Lot 148, to the sewer and/or storm drain in Allen St Street connect to existing manhole

To be laid in accordance with the conditions in this application and the City of New Bedford ordinances.

TYPE OF USE: RESIDENTIAL COMMERCIAL INDUSTRIAL FLOW \_\_\_\_\_ G.P.D.

If applicant other than actual property owner, attach Letter of Authorization from Property Owner.

Name J.B. Laganan & Co. Inc. Tel. 508-984-1668

Mailing Address 21 East River Dr. No. Dartmouth, MA 02747

The Bonded Contractor/Drain Layer authorized to perform this work is:

Name J.B. Laganan Address 21 East River Dr. No. Dartmouth, MA 02747 Tel. 508-984-1668

Type of Pipe Required: S.D.R. 35 PVC

PERMIT EXPIRES ONE YEAR AFTER DATE OF ISSUE

- Requires separate connections for sewage and storm drain where applicable. Storm water cannot be discharged to a sanitary sewer.
  - All work must be inspected and approved by a D.P.I. inspector before backfilling.
  - If this connection is to be part of a private service shared jointly with other building owners, attach copy of Recorded Joint Maintenance Agreement.
  - Permits can be issued to Industrial and/or Commercial Applicants only upon receipt and approval by the Commissioner of Public Infrastructure of required plans and supplemental information.
  - In addition, a City-issued Industrial User Discharge Permit and/or a Sewer Extension/Connection Permit issued by the Commonwealth of Massachusetts D.E.P. shall be required by the City for Industrial Discharge into the sewer system.
- Industrial User Discharge Permit No. \_\_\_\_\_ Date \_\_\_\_\_

Comm. Mass. Sewer Conn./Ext. Permit No. \_\_\_\_\_ Date \_\_\_\_\_

A Filing and Inspection Fee of \$ 450, plus an Entrance Fee of \$ \_\_\_\_\_ where applicable, must accompany this application.

Bank# Sovereign Bank Check# 26853 Date 3/30/12 Receipt# 9416

Other requirements: 24 hour inspection @ 508-991-6150

Connection made to Sewer Part of jointly-shared private line YES ☒ NO ☐  
Storm Drain

Applicant agrees to abide by the above terms, as well as all pertinent ordinances of the City of New Bedford, and such other special rules as the Commissioner of Public Infrastructure and/or City Engineer may deem necessary

Manuel H. Silva co.  
Supervising City Engineer

Signature of Property Owner or Representative

INSPECTOR'S REPORT

INSPECTED BY: \_\_\_\_\_  
DATE: \_\_\_\_\_  
COMMENTS: \_\_\_\_\_

APPROVED

DISA

SEE WHITE SHEET

SIGNATURE

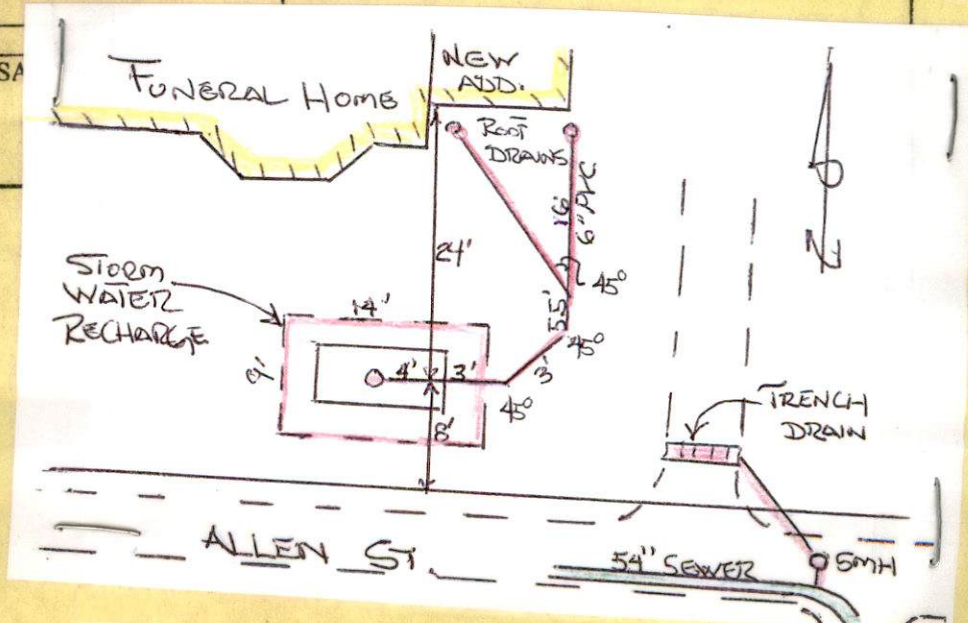





Inspector

PERMIT NO. 1

CITY OF NEW BEDFORD  
SEWER AND/OR STORM DRAIN PERMIT

DATE 3/30/12

Exp. 3/30/13

24278

This certifies that permission is granted to

TYMIL REALTY TRUST 129 Allen St New Bedford, MA 02740  
Property Owner Address Tel.

To connect a sewer and/or storm drain located at 129 Allen St.

Assessor's Plot 41 Lot 148, to the sewer and/or storm drain in Allen St. Street

To be laid in accordance with the conditions in this application and the City of New Bedford ordinances.

TYPE OF USE: RESIDENTIAL COMMERCIAL INDUSTRIAL FLOW G.P.D.

If applicant other than actual property owner, attach Letter of Authorization from Property Owner.

\* Name J.B. Langan & Co. Inc. Tel. 508-984-1668  
Mailing Address 21 East River Dr. No. Dartmouth, MA 02747

The Bonded Contractor/Drain Layer authorized to perform this work is:

J.B. Langan 21 East River Dr. No. Dartmouth, MA 02747  
Name Address Tel. 508-984-1668

Type of Pipe Required: S.D.R. 3.5 PVC

PERMIT EXPIRES ONE YEAR AFTER DATE OF ISSUE

- Requires separate connections for sewage and storm drain where applicable. Storm water cannot be discharged to a sanitary sewer.
  - All work must be inspected and approved by a D.P.I. inspector before backfilling.
  - If this connection is to be part of a private service shared jointly with other building owners, attach copy of Recorded Joint Maintenance Agreement.
  - Permits can be issued to Industrial and/or Commercial Applicants only upon receipt and approval by the Commissioner of Public Infrastructure of required plans and supplemental information.
  - In addition, a City-issued Industrial User Discharge Permit and/or a Sewer Extension/Connection Permit issued by the Commonwealth of Massachusetts D.E.P. shall be required by the City for Industrial Discharge into the sewer system.
- Industrial User Discharge Permit No. Date.

Comm. Mass. Sewer Conn./Ext. Permit No. Date.

A Filing and Inspection Fee of \$450, plus an Entrance Fee of \$ where applicable, must accompany this application.

Bank# Sovereign Bank Check# 26853 Date 3/30/12 Receipt# 9416

Other requirements: 24 hour inspection @ 508-991-6150

Connection made to Sewer Part of jointly-shared private line YES NO  
Storm Drain

Applicant agrees to abide by the above terms, as well as all pertinent ordinances of the City of New Bedford, and such other special rules as the Commissioner of Public Infrastructure and/or City Engineer may deem necessary

Supersizing City Engineer  
Civ:1

Signature of Property Owner or Representative

INSPECTOR'S REPORT

INSPECTED BY: [Signature]  
DATE: 4/9/12  
COMMENTS:

APPROVED

DISAPPROVED

SIGNATURE

SKETCH PLAN





Department of Public Infrastructure

Ronald H. Labelle  
Commissioner

CITY OF NEW BEDFORD  
Jonathan F. Mitchell, Mayor

Water  
Wastewater  
Highways  
Engineering  
Cemetery

To Whom It May Concern:

I TYMIL REALTY TRUST 129 Allen St. NB 02740, being  
(Name) (Mailing Address)

Owner of property located at

129 Allen St.

Plot 41, Lot 148, hereby agree to allow J.B. Longen & Co, Inc.  
(Name)

21 E. River Dr. N. Dork, to act on my behalf including affixing my  
(Mailing Address)

signature in securing permit for:

☒ Sewer/Drain Service Permits  
☒ Water Service Permits  
☒ Driveway Installation Permits  
☒ Sidewalk Installation Permits

I further agree to conform to, and abide by, All City rules and ask regulations applicable to the permit (s) being applied for:

Name Amelia Lopez  
Signature  
129 Allen Street, New Bedford MA  
Address  
3/30/12 508 992-2957  
Date Telephone number



# WORK ORDER

CHECK LEAK  
MARK OFF  
INSPECTION  
POOR PRESSURE

HYDRANT  
INVESTIGATE  
SHUT-OFF  
TURN-ON

DATE: 8/18/11 TIME: \_\_\_\_\_ FROM: Chevel

TO: Perry,

LOCATION: 129 Allen St. / Allen St side  
- Aubertin Funeral Home.

COMMENTS: Adding edition; roof-deck  
tie in. Legal Date 8/24.

Steve 508 984-1668.  
J.B. Lamagna

RESPONSE: \_\_\_\_\_

DATE: 8 22 '11 FROM: PR

129 ALLEN ST

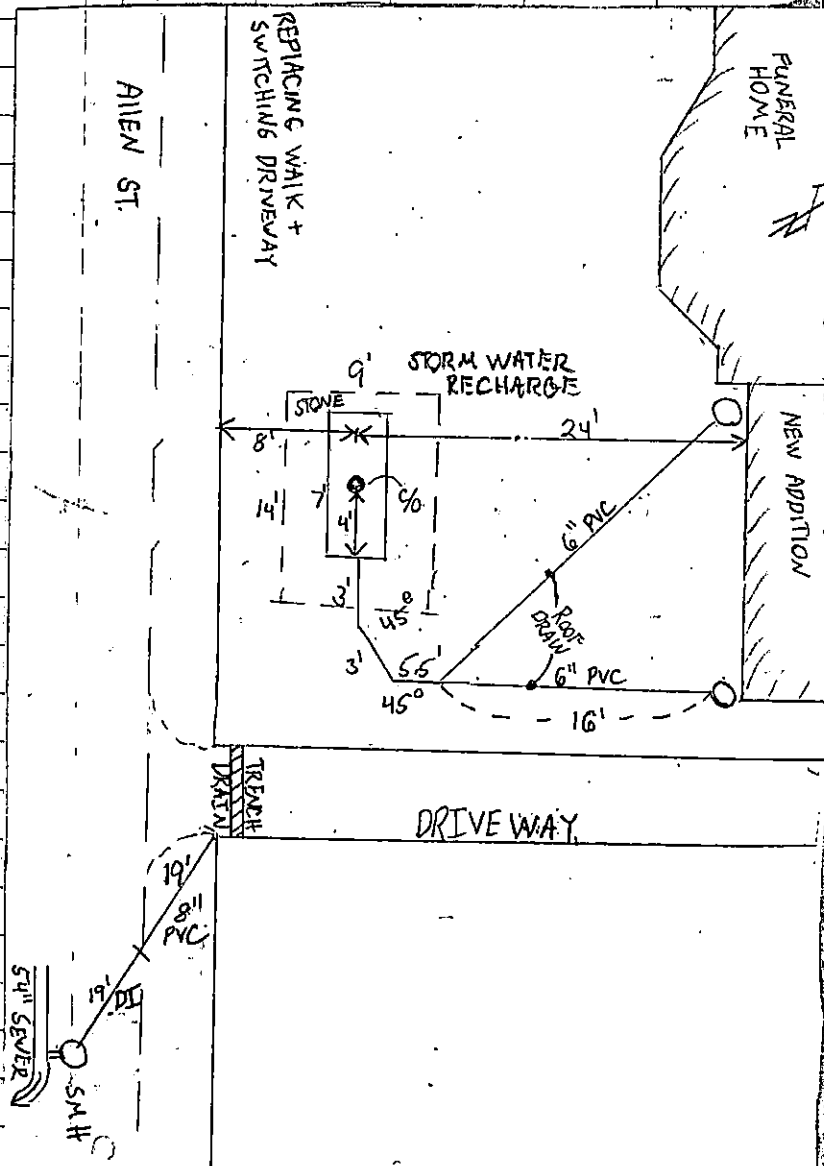

# SEWER INSPECTION

DATE: 4/4/2012

CONTRACTOR: J. B. LANASAN

INSP: R. BICHEL

PERMIT # 24278

PLOT 41 LOT 148