



PERMIT NO.

24253

CITY OF NEW BEDFORD  
SEWER AND/OR STORM DRAIN PERMIT

DATE 8/2/11

This certifies that permission is granted to

J+T LAND DEVELOPMENT LLC

Property Owner

Address

Tel.

To connect a sewer and/or storm drain located at

Assessor's Plot 121 Lot 151, to the sewer and/or storm drain in 8' sewer Jay Rd Street

To be laid in accordance with the conditions in this application and the City of New Bedford ordinances.

TYPE OF USE: RESIDENTIAL COMMERCIAL INDUSTRIAL FLOW 330 G.P.D.

If applicant other than actual property owner, attach Letter of Authorization from Property Owner.

Name.....Tel.....

Mailing Address.....

The Bonded Contractor/Drain Layer authorized to perform this work is:

Plow Collecting.....

Name.....Address.....Tel. 774-930-KD4.

Type of Pipe Required: PVC SDR 35

PERMIT EXPIRES ONE YEAR AFTER DATE OF ISSUE

- Requires separate connections for sewage and storm drain where applicable. Storm water cannot be discharged to a sanitary sewer.
- All work must be inspected and approved by a D.P.I. inspector before backfilling.
- If this connection is to be part of a private service shared jointly with other building owners, attach copy of Recorded Joint Maintenance Agreement.
- Permits can be issued to Industrial and/or Commercial Applicants only upon receipt and approval by the Commissioner of Public Infrastructure of required plans and supplemental information.
- In addition, a City-issued Industrial User Discharge Permit and/or a Sewer Extension/Connection Permit issued by the Commonwealth of Massachusetts D.E.P. shall be required by the City for Industrial Discharge into the sewer system.

Industrial User Discharge Permit No.....Date.....

Comm. Mass. Sewer Conn./Ext. Permit No.....Date.....

A Filing and Inspection Fee of \$450.00, plus an Entrance Fee of \$..... where applicable, must accompany this application.

Bank# Bank Five Check# 2796 Date 8/2/11 Receipt# 8975

Other requirements: Please call ahead 24 hours for inspection.

at (508) 991-6150

Connection made to Sewer Part of jointly-shared private line YES NO  
Storm Drain

Applicant agrees to abide by the above terms, as well as all pertinent ordinances of the City of New Bedford, and such other special rules as the Commissioner of Public Infrastructure and/or City Engineer may deem necessary

Diante M. Andrade City Engineer Signature of Property Owner or Representative

See attached, for INSPECTOR'S REPORT

INSPECTED BY: Signature & Sketch.

DATE:

COMMENTS:

APPROVED

DISAPPROVED

SEE WHITE SHEET

SIGNATURE

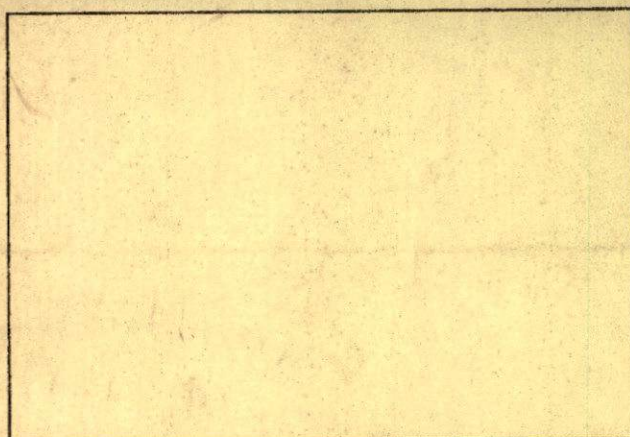

SKETCH PLAN





PERMIT NO.

24253

CITY OF NEW BEDFORD  
SEWER AND/OR STORM DRAIN PERMIT

DATE 8/2/11

This certifies that permission is granted to

J&T Home Builders P.O. Box 80038 Dartmouth MA (774) 202 4737  
Property Owner Address 02748 Tel.

To connect a sewer and/or storm drain located at 57 Joy Rd

Assessor's Plot 121 Lot 151, to the sewer and/or storm drain in 8" sewer Joy Rd Street

To be laid in accordance with the conditions in this application and the City of New Bedford ordinances.

TYPE OF USE: RESIDENTIAL COMMERCIAL INDUSTRIAL FLOW 330 G.P.D.

If applicant other than actual property owner, attach Letter of Authorization from Property Owner.

Name Mailing Address

The Bonded Contractor/Drain Layer authorized to perform this work is:

Pico Contracting

Name Address Tel. 774-930-1024

Type of Pipe Required: PVC SDR 35"

PERMIT EXPIRES ONE YEAR AFTER DATE OF ISSUE

- Requires separate connections for sewage and storm drain where applicable. Storm water cannot be discharged to a sanitary sewer.
- All work must be inspected and approved by a D.P.I. inspector before backfilling.
- If this connection is to be part of a private service shared jointly with other building owners, attach copy of Recorded Joint Maintenance Agreement.
- Permits can be issued to Industrial and/or Commercial Applicants only upon receipt and approval by the Commissioner of Public Infrastructure of required plans and supplemental information.
- In addition, a City-issued Industrial User Discharge Permit and/or a Sewer Extension/Connection Permit issued by the Commonwealth of Massachusetts D.E.P. shall be required by the City for Industrial Discharge into the sewer system.

Industrial User Discharge Permit No. Date

Comm. Mass. Sewer Conn./Ext. Permit No. Date

A Filing and Inspection Fee of \$450.00, plus an Entrance Fee of \$ where applicable, must accompany this application.

Bank# Bank Five Check# 2796 Date 8/2/11 Receipt# 8975

Other requirements: please call ahead 24 hours for inspection  
at (508) 991-6150

Connection made to Sewer Part of jointly-shared private line YES (NO)  
Storm Drain

Applicant agrees to abide by the above terms, as well as all pertinent ordinances of the City of New Bedford, and such other special rules as the Commissioner of Public Infrastructure and/or City Engineer may deem necessary

Duarte M. Andrade  
City Engineer

Signature of Property Owner or Representative

INSPECTOR'S REPORT

INSPECTED BY:  
DATE:  
COMMENTS:

APPROVED DISAPPROVED

SIGNATURE

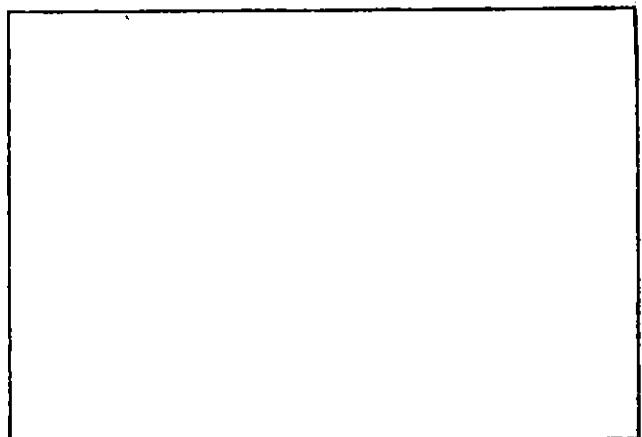

SKETCH PLAN

Inspector's  
copy.



PERMIT NO.

24253

CITY OF NEW BEDFORD  
SEWER AND/OR STORM DRAIN PERMIT

DATE 8/2/11

This certifies that permission is granted to

J&T Home Builders P.O. Box 80038 Dartmouth MA (774) 202 4737  
Property Owner Address Tel.

To connect a sewer and/or storm drain located at 57 Joy Rd

Assessor's Plot 121 Lot 151, to the sewer and/or storm drain in 8" Sewer Joy Rd Street

To be laid in accordance with the conditions in this application and the City of New Bedford ordinances.

TYPE OF USE: RESIDENTIAL COMMERCIAL INDUSTRIAL FLOW 330 G.P.D.

If applicant other than actual property owner, attach Letter of Authorization from Property Owner.

Name..... Tel.....

Mailing Address.....

The Bonded Contractor/Drain Layer authorized to perform this work is:

PWC Contracting

Name..... Address..... Tel. 774-930-1024

Type of Pipe Required: PVC SDR 35"

PERMIT EXPIRES ONE YEAR AFTER DATE OF ISSUE

- Requires separate connections for sewage and storm drain where applicable. Storm water cannot be discharged to a sanitary sewer.
  - All work must be inspected and approved by a D.P.I. inspector before backfilling.
  - If this connection is to be part of a private service shared jointly with other building owners, attach copy of Recorded Joint Maintenance Agreement.
  - Permits can be issued to Industrial and/or Commercial Applicants only upon receipt and approval by the Commissioner of Public Infrastructure of required plans and supplemental information.
  - In addition, a City-issued Industrial User Discharge Permit and/or a Sewer Extension/Connection Permit issued by the Commonwealth of Massachusetts D.E.P. shall be required by the City for Industrial Discharge into the sewer system.
- Industrial User Discharge Permit No. .... Date .....

Comm. Mass. Sewer Conn./Ext. Permit No. .... Date .....

A Filing and Inspection Fee of \$ 450.00, plus an Entrance Fee of \$ ..... where applicable, must accompany this application.

Bank# Bank Five Check# 2796 Date 8/2/11 Receipt# 8975

Other requirements: please call ahead 24 hours for inspection  
at (508) 991-6150

Connection made to Sewer Part of jointly-shared private line YES (NO)  
Storm Drain

Applicant agrees to abide by the above terms, as well as all pertinent ordinances of the City of New Bedford, and such other special rules as the Commissioner of Public Infrastructure and/or City Engineer may deem necessary

Duarte M. Andrade  
City Engineer

[Signature]  
Signature of Property Owner or Representative

INSPECTOR'S REPORT

INSPECTED BY: [Signature]  
DATE: 8/3/11  
COMMENTS: \_\_\_\_\_

APPROVED

DISAPPROVED

[Signature]  
SIGNATURE

See attached inspector's sketch.

SKETCH PLAN



## CITY OF NEW BEDFORD

NO. 100611 LICENSE NO. \_\_\_\_\_DATE 7/25 2011

## FOUNDATION PERMIT

MSBC Sect. 111.8 – Any permit issued shall be deemed abandoned and invalid unless the work authorized by it shall have been commenced within six (6) months after its issuance.

This certifies that St Home Builders, owner/contractor  
has permission to install foundation  
on 57 Joy Rd Plot 121, Lot 151

providing that the person accepting this permit shall in every respect conform to the terms of the application therefor on file in this office; to the provisions of the Statute of the Commonwealth and to the By-Laws of the City of New Bedford relating to the Inspection, Erection, Enlarging, Altering, Raising, Moving, Repairing or Tearing Down of a Building.

WIRING INSPECTOR

PLUMBING INSPECTOR

BUILDING INSPECTOR

YOUR AREA INSPECTOR IS: Home Builders

ROUGH FINISH

– Tel. 979-1540 Between 8:00 AM – 9:00 AM

NOTICE: NOTIFY INSPECTOR 48 HOURS  
IN ADVANCE OF APPLYING  
SHEATING OR LATHING

## OCCUPANCY PERMIT REQUIRED BEFORE OCCUPANCY

No Building or Structure shall be used or occupied until the Certificate of Use and Occupancy shall have been issued by the Building Commissioner – MSBC. Sect. 120.1 – N.B. Zoning Ord. Sect. 9-269

THIS CARD MUST BE DISPLAYED IN A CONSPICUOUS PLACE ON THE PREMISES  
AND NOT TORN DOWN OR REMOVED UNTIL COMPLETION OF WORK

SUBJECT TO MASSACHUSETTS STATE  
BUILDING CODE REQUIREMENTS

[Signature]  
BUILDING INSPECTOR



Zucerman Farms  
Sewer Insp.

8/3/11  
RJ

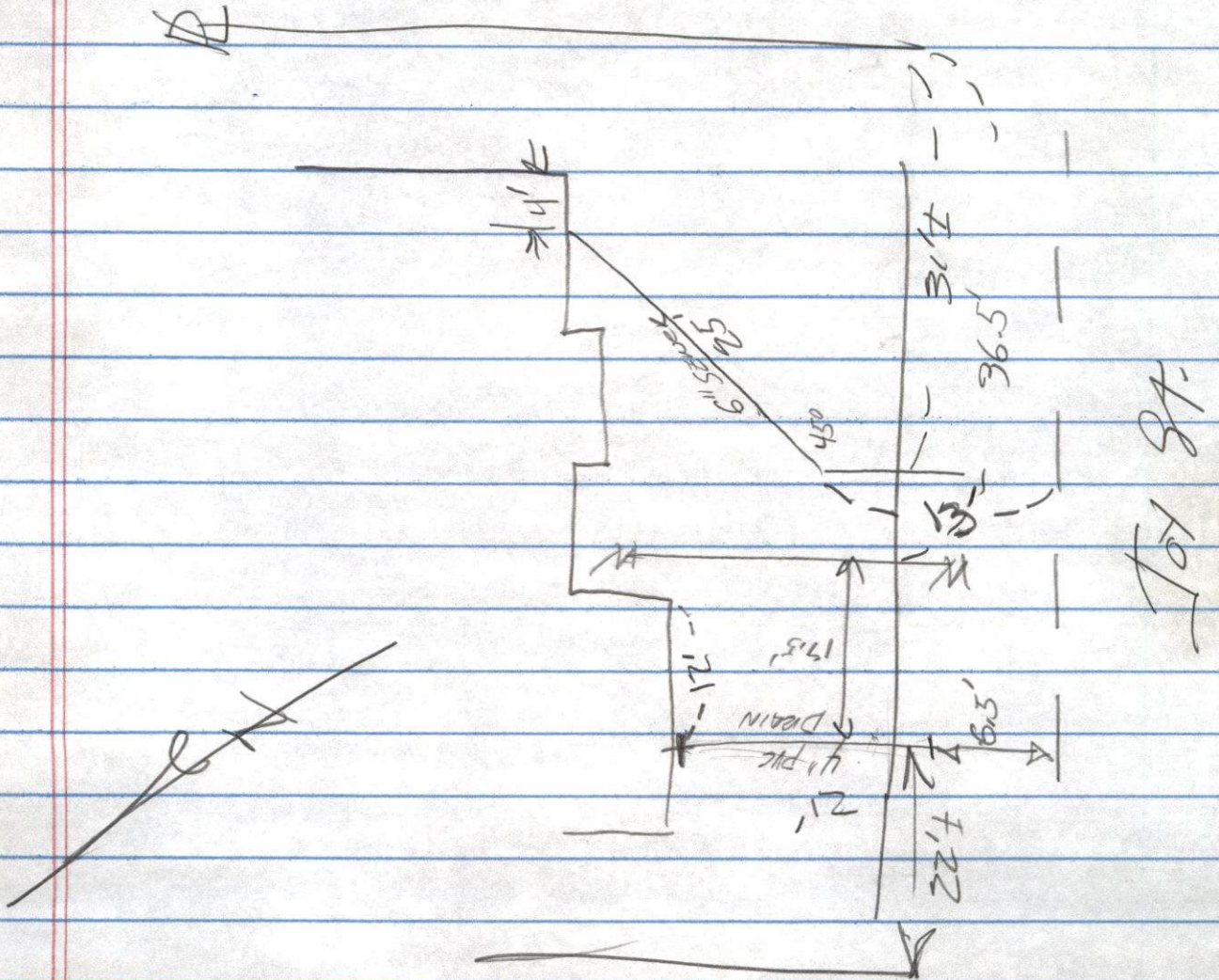



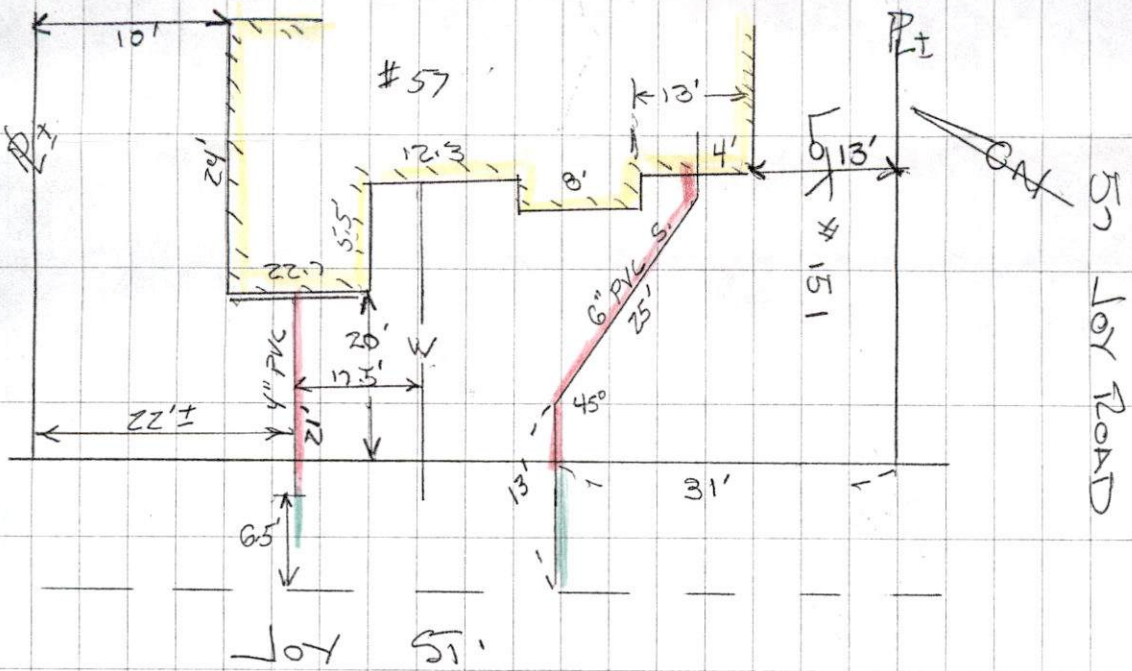

SEWER SERVICE  
TIE-IN

DATE: 8/3/11

CONTR: MANNY / PICO CONTR-

INSPECTION: R. B. BAKER

PERMIT # 24253

Sub'd for Rec  
8/26/11