



PERMIT NO.

CITY OF NEW BEDFORD  
SEWER AND/OR STORM DRAIN PERMIT

DATE 4/26/2011  
EXP. 4/26/2012

24243

This certifies that permission is granted to

Property Owner MAUNYFAVA, FLA DEFT MGR, CUMBERLAND FARMS, INC 100 CROSSING BLVD FRAMINGHAM MA  
Address RE 1540 EARTHMOUTH ST. (INCORP.) Tel. (808) 270-1400 01702

To connect a sewer and/or storm drain located at ROCKDALE AVE (S.S.) 90' (41-) E X DARTMOUTH ST.

Assessor's Plot 17 Lot 3, 4, 5, to the sewer and/or storm drain in 30" J.D. & 18" S. ROCKDALE Street AVE.

To be laid in accordance with the conditions in this application and the City of New Bedford ordinances.

TYPE OF USE: RESIDENTIAL COMMERCIAL INDUSTRIAL FLOW G.P.D. W.C.B.

If applicant other than actual property owner, attach Letter of Authorization from Property Owner.

Name PAUL MARTE IGARAFOLLO & ASSOCIATES, INC. Tel. (401) 273-6000

Mailing Address 85 CORPUS ST. 1905 EX 6148, FARMVILLE, VT 05940

The Bonded Contractor/Drain Layer authorized to perform this work is:

Name W.C.B. Address ROC 35 Tel.   
Type of Pipe Required: PVC

PERMIT EXPIRES ONE YEAR AFTER DATE OF ISSUE

- Requires separate connections for sewage and storm drain where applicable. Storm water cannot be discharged to a sanitary sewer.
- All work must be inspected and approved by a D.P.I. inspector before backfilling.
- If this connection is to be part of a private service shared jointly with other building owners, attach copy of Recorded Joint Maintenance Agreement.
- Permits can be issued to Industrial and/or Commercial Applicants only upon receipt and approval by the Commissioner of Public Infrastructure of required plans and supplemental information.
- In addition, a City-issued Industrial User Discharge Permit and/or a Sewer Extension/Connection Permit issued by the Commonwealth of Massachusetts D.E.P. shall be required by the City for Industrial Discharge into the sewer system.

Industrial User Discharge Permit No. NIA Date

Comm. Mass. Sewer Conn./Ext. Permit No. NIA Date

A Filing and Inspection Fee of \$ 480., plus an Entrance Fee of \$  where applicable, must accompany this application.

Bank# BANK OF AMERICA Check# 236660 Date 4/4/11 Receipt# 09272

Other requirements: MUST CALL 24 HRS. IN ADVANCE FOR INSPECTION; MUST USE

FLOWABLE FILL IN TRENCHES; MUST COORDINATE WORK W/ STATE'S SCHEDULE

Connection made to Sewer Part of jointly-shared private line YES NO  
Storm Drain

Applicant agrees to abide by the above terms, as well as all pertinent ordinances of the City of New Bedford, and such other special rules as the Commissioner of Public Infrastructure and/or City Engineer may deem necessary

[Signature]  
Acting City Engineer

[Signature]  
Signature of Property Owner or Representative

INSPECTED BY:   
DATE:   
COMMENTS:

APPROVED  DIS

SIGNATURE

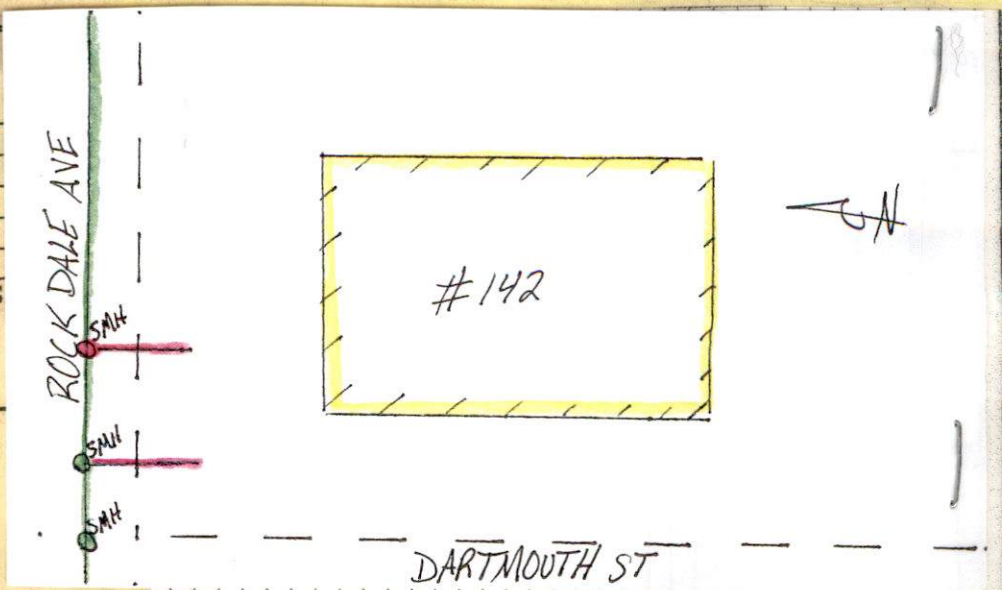

\* AND MUST BE INSTALLED PRIOR TO SITE COMPLETING WORK; THIS PERMIT BEING ISSUED TO INSTALL STORM MAINS TO PDS - ANY CHANGES MUST BE REVIEWED BY DPI; MUST BE INSTALLED IN ACCORDANCE TO ATTACHED PLAN; CITY OF N.B. MUST APPROVE FINAL SITE PLANS SHOWING UTILITIES ON PRIVATE PROPERTY (I.E. STORM SYSTEM, SEWER CONNECTION, MISC TRENCHES, ETC...).





INSPECTOR'S COPY

PERMIT NO.

24243

CITY OF NEW BEDFORD  
SEWER AND/OR STORM DRAIN PERMIT

DATE 4/26/2011  
EXP. 4/26/2012

This certifies that permission is granted to

MANNYFAIVA, PLG. DEPT. MGR. / CUMBERLAND FARMS, INC., 1000 CROSSING BLVD. FRAMINGHAM  
Property Owner Address

To connect a sewer and/or storm drain located at: #142 RE: 540 DARTMOUTH ST. (INDV. TEL. (508) 270-1400 01702  
ROCKDALE AVE. (S.S.) 90' (41-) E X DARTMOUTH ST.

Assessor's Plot ... 17 ... Lot 3, 4, 5, to the sewer and/or storm drain to 30" J.D. & 18" S. ROCKDALE Street Av

To be laid in accordance with the conditions in this application and the City of New Bedford ordinances.

TYPE OF USE: RESIDENTIAL COMMERCIAL INDUSTRIAL FLOW \_\_\_\_\_ G.P.D. W.C.F.

If applicant other than actual property owner, attach Letter of Authorization from Property Owner.

Name PAUL MARTE IGARAFALO & ASSOCIATES, INC. Tel. (401) 273-6000

Mailing Address 85 CORLISS ST. BOX 643, PROVIDENCE, RI 02940

The Bonded Contractor/Drain Layer authorized to perform this work is:

WCB

Name Address Tel.

Type of Pipe Required: PVC SDR 35

PERMIT EXPIRES ONE YEAR AFTER DATE OF ISSUE

- Requires separate connections for sewage and storm drain where applicable. Storm water cannot be discharged to a sanitary sewer.
  - All work must be inspected and approved by a D.P.I. inspector before backfilling.
  - If this connection is to be part of a private service shared jointly with other building owners, attach copy of Recorded Joint Maintenance Agreement.
  - Permits can be issued to Industrial and/or Commercial Applicants only upon receipt and approval by the Commissioner of Public Infrastructure of required plans and supplemental information.
  - In addition, a City-issued Industrial User Discharge Permit and/or a Sewer Extension/Connection Permit issued by the Commonwealth of Massachusetts D.E.P. shall be required by the City for Industrial Discharge into the sewer system.
- Industrial User Discharge Permit No. N/A Date \_\_\_\_\_

Comm. Mass. Sewer Conn./Ext. Permit No. N/A Date \_\_\_\_\_

A Filing and Inspection Fee of \$450, plus an Entrance Fee of \$\_\_\_\_\_ where applicable, must accompany this application.

Bank# BANK OF AMERICA Check# 236660 Date 4/4/11 Receipt# 09272

Other requirements: MUST CALL 24HR IN ADVANCE FOR INSPECTION; MUST USE

FLOWABLE FILL IN TRENCHES; MUST COORDINATE WORK W/ STATE'S SCHEDULE \*

Connection made to Sewer Part of jointly-shared private line YES NO  
Storm Drain

Applicant agrees to abide by the above terms, as well as all pertinent ordinances of the City of New Bedford, and such other special rules as the Commissioner of Public Infrastructure and/or City Engineer may deem necessary

\_\_\_\_\_  
ACTING City Engineer

\_\_\_\_\_  
Signature of Property Owner or Representative

INSPECTOR'S REPORT

INSPECTED BY: ROLAND FARLAND  
DATE: 6/3/2011  
COMMENTS:

APPROVED

APPROVED

DISAPPROVED

\_\_\_\_\_  
SIGNATURE

Rev'd 6/6/11

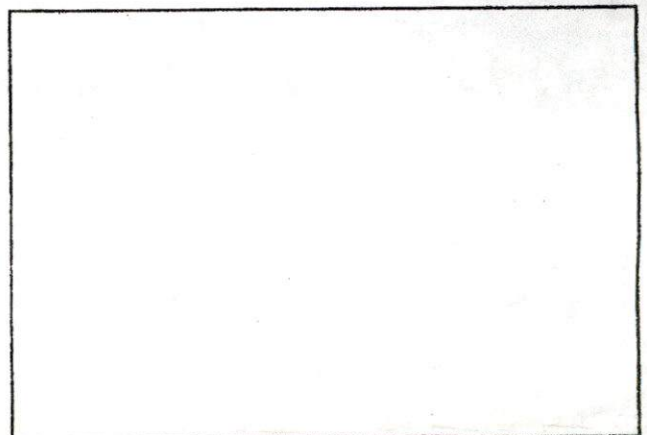

SKETCH PLAN

\* AND MUST BE INSTALLED PRIOR TO STATE COMPLETING WORK; THIS PERMIT BEING ISSUED TO INSTALL STUBS FROM MAINS TO PLS - ANY CHANGES MUST BE REVIEWED BY DPI; MUST BE INSTALLED IN ACCORDANCE TO ATTACHED PLAN; CITY OF N.B. MUST APPROVE FINAL SITE PLANS SHOWING UTILITIES ON PRIVATE PROPERTY (I.E. STORM SYSTEM, SEWER CONNECTION, MDC TRAPS, ETC...).





PERMIT NO.

24243

This certifies that permission is granted to

CITY OF NEW BEDFORD  
SEWER AND/OR STORM DRAIN PERMIT

DATE 4/26/2011  
EXP. 4/26/2012

Property Owner: MANNYFAVA, FLS DEPT. MGR. / Address: CUMBERLAND FARMS, INC., 1000 CROSSING BLVD. FRAMINGHAM MA  
RE: 50 DARTMOUTH ST. (INDV. TEL. (808) 270-1400 01702

To connect a sewer and/or storm drain located at: ROCKDALE AVE. (S.S.) 90' (+/-) E x DARTMOUTH ST.

Assessor's Plot: 17 Lot: 3, 4, 5, to the sewer and/or storm drain in: 30" J.D. & 15" S. ROCKDALE STREET AVE.

To be laid in accordance with the conditions in this application and the City of New Bedford ordinances.

TYPE OF USE: RESIDENTIAL COMMERCIAL INDUSTRIAL FLOW: GAS STATION 300 GPD  
RETAIL STORE 200 GPD  
G.P.D. W.C.B. (SEE ATTACHED)

If applicant other than actual property owner, attach Letter of Authorization from Property Owner.

Name: PAUL MARTE IGARAFALO & ASSOCIATES, INC. Tel: (401) 273-6000

Mailing Address: 85 CORLISS ST. 19080X 6.48, PROVIDENCE, RI 02940

The Bonded Contractor/Drain Layer authorized to perform this work is:

W.C.B.

Name: Address: Tel:

Type of Pipe Required: P.V.C. 30" S.D.C. 35"

PERMIT EXPIRES ONE YEAR AFTER DATE OF ISSUE

- Requires separate connections for sewage and storm drain where applicable. Storm water cannot be discharged to a sanitary sewer.
  - All work must be inspected and approved by a D.P.I. inspector before backfilling.
  - If this connection is to be part of a private service shared jointly with other building owners, attach copy of Recorded Joint Maintenance Agreement.
  - Permits can be issued to Industrial and/or Commercial Applicants only upon receipt and approval by the Commissioner of Public Infrastructure of required plans and supplemental information.
  - In addition, a City-issued Industrial User Discharge Permit and/or a Sewer Extension/Connection Permit issued by the Commonwealth of Massachusetts D.E.P. shall be required by the City for Industrial Discharge into the sewer system.
- Industrial User Discharge Permit No. N/A Date:

Comm. Mass. Sewer Conn./Ext. Permit No. N/A Date:

A Filing and Inspection Fee of \$450.00, plus an Entrance Fee of \$ where applicable, must accompany this application.

Bank# BANK OF AMERICA Check# 236660 Date 4/4/11 Receipt# 09272

Other requirements: MUST CALL 24 HRS IN ADVANCE FOR INSPECTION; MUST USE

FLOWABLE FILL IN TRENCHES; MUST COORDINATE WORK W/ STATE'S SCHEDULE \*

Connection made to Sewer Part of jointly-shared private line YES NO  
Storm Drain

Applicant agrees to abide by the above terms, as well as all pertinent ordinances of the City of New Bedford, and such other special rules as the Commissioner of Public Infrastructure and/or City Engineer may deem necessary

Signature of City Engineer  
ACTING City Engineer

Signature of Property Owner or Representative

INSPECTOR'S REPORT

INSPECTED BY: \_\_\_\_\_  
DATE: \_\_\_\_\_  
COMMENTS: \_\_\_\_\_

APPROVED \_\_\_\_\_ DISAPPROVED \_\_\_\_\_

SIGNATURE

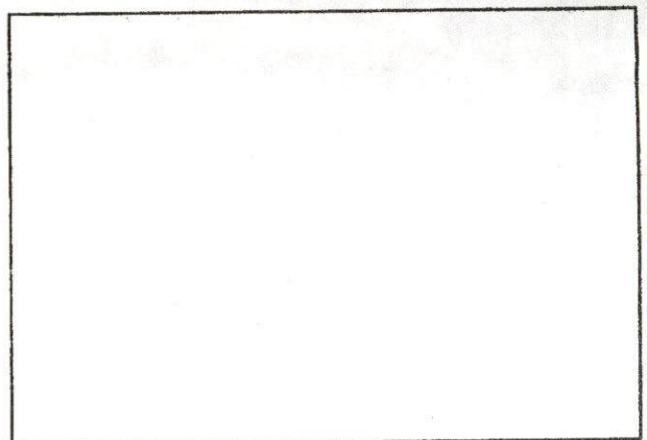

SKETCH PLAN

BE INSTALLED PRIOR TO STATE COMPLETING WORK; THIS PERMIT TO INSTALL JUBS FROM MAINS TO PLS - ANY CHANGES MUST BY DPI; MUST BE INSTALLED IN ACCORDANCE TO ATTACHED PLAN; MUST APPROVE FINAL SITE PLANS SHOWING UTILITIES ON PRIVATE E. STOCK SYSTEM, SEWER CONNECTION, MDC TRAPS, ETC...).



April 7, 2011

To Whom It May Concern:

Cumberland Farms, Inc., with a usual place of business in Framingham, Massachusetts, does hereby authorize **Garofalo & Associates, Inc.** to apply for and represent Cumberland Farms, Inc. in filing of any applications for required permits and/or approvals for the construction, operation and maintenance at our convenience store/self-service gas station located at **540 Dartmouth Street and Rockdale Ave (V# 0968 / Store 2324 / Station 2137)**, including, but not limited to, appearing before any governmental agency at general meetings or public hearing addressing such construction/improvement of Cumberland Farms retail facilities.

Cumberland Farms, Inc.

Manny Paiva  
Planning Department Manager

COMMONWEALTH OF MASSACHUSETTS  
MIDDLESEX COUNTY

Subscribed and sworn to before me this 7th day of April 2011 by Manny Paiva who is personally known to me.

Notary Public: Maureen Dickson  
My Commission Expires: March 15, 2013

Cumberland Gulf Group of Companies  
100 Crossing Boulevard, Framingham, MA 01702  
508-270-1400

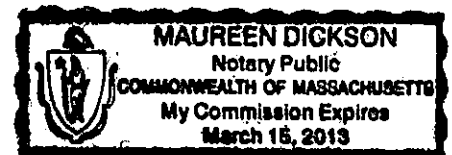

**Ana S. Rosa**

---

**From:** Paul Duarte [pduarte@garofaloassociates.com]  
**Sent:** Tuesday, April 26, 2011 11:07 AM  
**To:** Ana S. Rosa; Manuel Silva  
**Cc:** 'Steven Garofalo'  
**Subject:** Cumberland Farms Dartmouth St/Rockdale Ave. estimated sanitary sewer flow per Title V

Ana

As requested ,below is the estimated design sanitary sewer flow using 310 CMR 15.00 Title V design flows for the above referenced project.

DESIGN FLOW CALCULATIONS:

GAS STATION = 75 G.P.D./ISLAND x 4 PUMP ISLANDS  
= 300 G.P.D.

RETAIL STORE = 50 G.P.D./1,000 S.F. x 3,634 S.F.  
= 182 G.P.D. (MIN. 200 G.P.D. PER CODE)

TOTAL DESIGN FLOW = 300 + 200 = 500 G.P.D.

Sincerely,

**Paul J. Duarte**

Project Engineer

**Garofalo & Associates, Inc.**

85 Corliss Street

P.O. Box 6145

Providence, R.I. 02940

Tel. (401)-273-6000 xt. 227

Fax (401)-273-1000

[pduarte@garofaloassociates.com](mailto:pduarte@garofaloassociates.com)



