



PERMIT NO.

24211

CITY OF NEW BEDFORD
SEWER AND/OR STORM DRAIN PERMIT

DATE 8/25/10

Exp. 8/25/11

This certifies that permission is granted to

Property Owner Pope's Island Harbor Dev. Corp. Address 867 Middle Rd. Acushnet, MA Tel. 508-763-8868

To connect a sewer and/or storm drain located at Pope's Island (NS) North Side of Bldg.

Assessor's Plot 60 Lot 12, to the sewer and/or storm drain in Pope's Island Street

To be laid in accordance with the conditions in this application and the City of New Bedford ordinances.

TYPE OF USE: RESIDENTIAL COMMERCIAL INDUSTRIAL FLOW G.P.D.

If applicant other than actual property owner, attach Letter of Authorization from Property Owner.

Name Tel.

Mailing Address

The Bonded Contractor/Drain Layer authorized to perform this work is:

D.W. Public Construction, Inc. Address 867 Middle Rd. Acushnet, MA Tel. 508-763-8868

Name Address Tel.

Type of Pipe Required: Schedule 20 PVC 2" x 2"

PERMIT EXPIRES ONE YEAR AFTER DATE OF ISSUE

- Requires separate connections for sewage and storm drain where applicable. Storm water cannot be discharged to a sanitary sewer.
- All work must be inspected and approved by a D.P.I. inspector before backfilling.
- If this connection is to be part of a private service shared jointly with other building owners, attach copy of Recorded Joint Maintenance Agreement.
- Permits can be issued to Industrial and/or Commercial Applicants only upon receipt and approval by the Commissioner of Public Infrastructure of required plans and supplemental information.
- In addition, a City-issued Industrial User Discharge Permit and/or a Sewer Extension/Connection Permit issued by the Commonwealth of Massachusetts D.E.P. shall be required by the City for Industrial Discharge into the sewer system.

Industrial User Discharge Permit No. Date

Comm. Mass. Sewer Conn./Ext. Permit No. Date

A Filing and Inspection Fee of \$ 4.95, plus an Entrance Fee of \$ where applicable, must accompany this application.

Bank# BPP Bank Check# 2720 Date 8/27/10 Receipt# 8872

Other requirements: 24 hr. notice for all Pre-Inspections

Connection made to Sewer Part of jointly-shared private line YES NO
Storm Drain

Applicant agrees to abide by the above terms, as well as all pertinent ordinances of the City of New Bedford, and such other special rules as the Commissioner of Public Infrastructure and/or City Engineer may deem necessary

Dwight M. Andrade (NS)
Acting City Engineer

Signature of Property Owner or Representative

INSPECTOR'S REPORT

INSPECTED BY:

DATE:

COMMENTS:

APPROVED DISAP

SIGNATURE

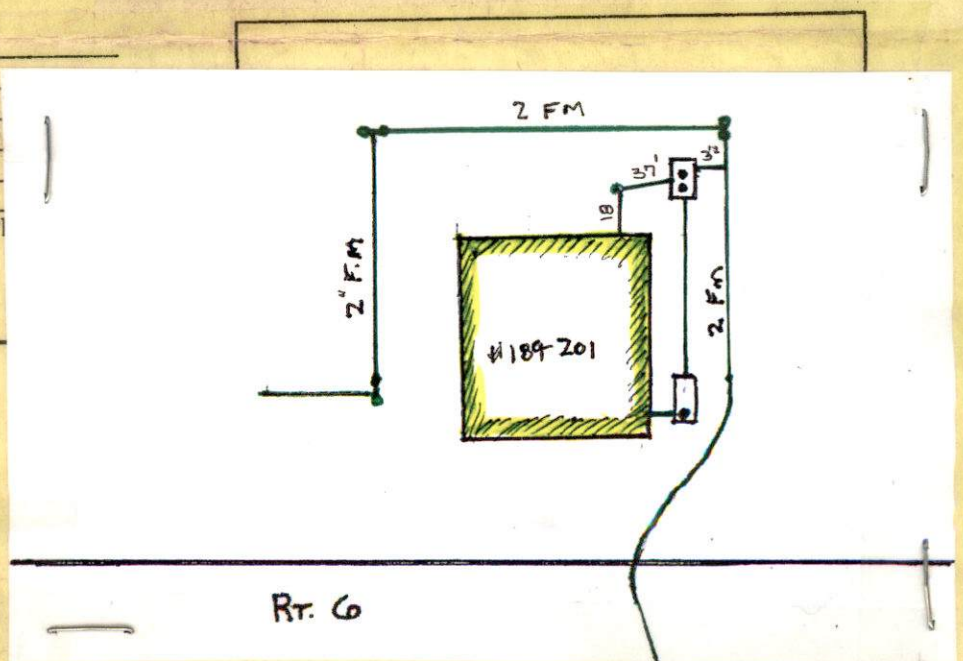



PERMIT NO.
24211

CITY OF NEW BEDFORD
SEWER AND/OR STORM DRAIN PERMIT

DATE 8/25/10
Exp. 8/25/11

This certifies that permission is granted to

Pope's Island Harbor Dev. Corp. 867 Middle Rd. Acushnet, MA 508-763-8868
Property Owner Address Tel.

To connect a sewer and/or storm drain located at Pope's Island (ns) ~~East~~ North Side of Bldg.

Assessor's Plot 60 Lot 12, to the sewer and/or storm drain in Pope's Island Street

To be laid in accordance with the conditions in this application and the City of New Bedford ordinances.

TYPE OF USE: RESIDENTIAL COMMERCIAL INDUSTRIAL FLOW _____ G.P.D.

If applicant other than actual property owner, attach Letter of Authorization from Property Owner.

Name _____ Tel. _____

Mailing Address _____

The Bonded Contractor/Drain Layer authorized to perform this work is:

DW White Construction Inc. 867 Middle Rd. Acushnet, MA 508-763-8868

Name _____ Address _____ Tel. _____

Type of Pipe Required: Schedule 21 PVC 2"

PERMIT EXPIRES ONE YEAR AFTER DATE OF ISSUE

- Requires separate connections for sewage and storm drain where applicable. Storm water cannot be discharged to a sanitary sewer.
- All work must be inspected and approved by a D.P.I. inspector before backfilling.
- If this connection is to be part of a private service shared jointly with other building owners, attach copy of Recorded Joint Maintenance Agreement.
- Permits can be issued to Industrial and/or Commercial Applicants only upon receipt and approval by the Commissioner of Public Infrastructure of required plans and supplemental information.
- In addition, a City-issued Industrial User Discharge Permit and/or a Sewer Extension/Connection Permit issued by the Commonwealth of Massachusetts D.E.P. shall be required by the City for Industrial Discharge into the sewer system.

Industrial User Discharge Permit No. _____ Date _____

Comm. Mass. Sewer Conn./Ext. Permit No. _____ Date _____

A Filing and Inspection Fee of \$400, plus an Entrance Fee of \$ _____ where applicable, must accompany this application.

Bank# BEP Bank Check# 2720 Date 8/27/10 Receipt# _____

Other requirements: 24 hr. notice for all Pre-Inspections

Connection made to Sewer Part of jointly-shared private line YES NO
Storm Drain

Applicant agrees to abide by the above terms, as well as all pertinent ordinances of the City of New Bedford, and such other special rules as the Commissioner of Public Infrastructure and/or City Engineer may deem necessary

Durk M. Andrade ns
Acting City Engineer

Signature of Property Owner or Representative

INSPECTOR'S REPORT

INSPECTED BY: _____

DATE: _____

COMMENTS: _____

APPROVED

DISAPPROVED

SIGNATURE

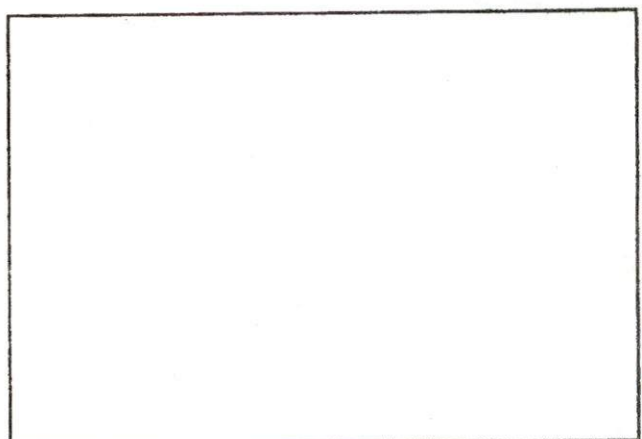

SKETCH PLAN

