



PERMIT NO.

CITY OF NEW BEDFORD  
SEWER AND/OR STORM DRAIN PERMIT

DATE 4-28-10  
EXP. 4-28-11

24192

This certifies that permission is granted to

New Bedford Housing Authority 134 S. Second St. New Bedford, MA 02740  
Property Owner Address Tel. 508-997-4800 WS

To connect a sewer and/or storm drain located at E.S. Summer St between Coggeshall St & Reckham St  
Assessor's Plot 90 Lot 27 to the sewer and/or storm drain in comes from back from proposed Tabitha Lane Street 16 unit S

To be laid in accordance with the conditions in this application and the City of New Bedford ordinances.

TYPE OF USE: RESIDENTIAL COMMERCIAL INDUSTRIAL FLOW \_\_\_\_\_ G.P.D.

If applicant other than actual property owner, attach Letter of Authorization from Property Owner.

Name \_\_\_\_\_ Tel. \_\_\_\_\_

Mailing Address \_\_\_\_\_

The Bonded Contractor/Drain Layer authorized to perform this work is:

Podgurski Corporation 8 Springdale Ave Canton, MA 02021  
Name Address Tel. 781-828-0821

Type of Pipe Required: 6" SDR 35 PVC

PERMIT EXPIRES ONE YEAR AFTER DATE OF ISSUE

- Requires separate connections for sewage and storm drain where applicable. Storm water cannot be discharged to a sanitary sewer.
- All work must be inspected and approved by a D.P.I. inspector before backfilling.
- If this connection is to be part of a private service shared jointly with other building owners, attach copy of Recorded Joint Maintenance Agreement.
- Permits can be issued to Industrial and/or Commercial Applicants only upon receipt and approval by the Commissioner of Public Infrastructure of required plans and supplemental information.
- In addition, a City-issued Industrial User Discharge Permit and/or a Sewer Extension/Connection Permit issued by the Commonwealth of Massachusetts D.E.P. shall be required by the City for Industrial Discharge into the sewer system.

Industrial User Discharge Permit No. \_\_\_\_\_ Date \_\_\_\_\_

Comm. Mass. Sewer Conn./Ext. Permit No. \_\_\_\_\_ Date \_\_\_\_\_

A Filing and Inspection Fee of \$ 450, plus an Entrance Fee of \$ \_\_\_\_\_ where applicable, must accompany this application.

Bank# The Community Bank Check# 8572 Date 4/27/10 Receipt# 8741

Other requirements: 24 hour notice for inspection at 508-997-1527

Connection made to Sewer Part of jointly-shared private line YES NO  
Storm Drain

Applicant agrees to abide by the above terms, as well as all pertinent ordinances of the City of New Bedford, and such other special rules as the Commissioner of Public Infrastructure and/or City Engineer may deem necessary

Duarte M. Andrade  
Acting City Engineer

Cynthia F. Spina  
Signature of Property Owner or Representative

INSPECTOR'S REPORT

INSPECTED BY: \_\_\_\_\_

DATE: \_\_\_\_\_

COMMENTS: \_\_\_\_\_

APPROVED

DISAP

SEE WHITE SHEET

SIGNATURE

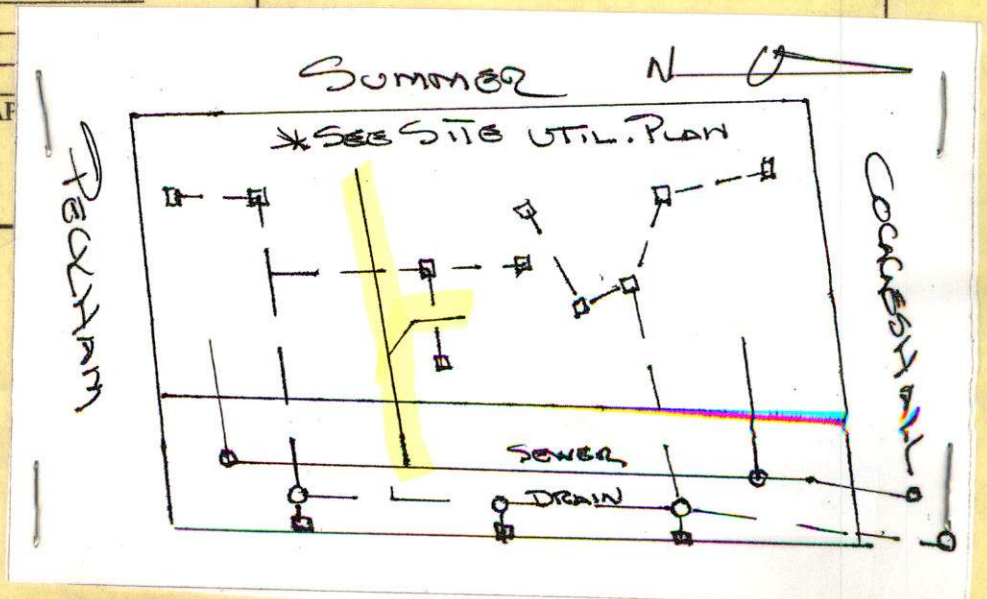





PERMIT NO.

CITY OF NEW BEDFORD  
SEWER AND/OR STORM DRAIN PERMIT

DATE 4-28-10  
EXP. 4-28-11

24192

This certifies that permission is granted to

New Bedford Housing Authority 134 S. Second St. New Bedford MA 02740  
Property Owner Address Tel. 508-997-0800 WS  
4 Community Bldg on Tabitha

To connect a sewer and/or storm drain located at E.S. Summer St between Coggeshall St & Reckham St  
Assessor's Plot 90 Lot 27, to the sewer and/or storm drain in from proposed Tabitha lane Street 16 unit S

To be laid in accordance with the conditions in this application and the City of New Bedford ordinances.  
TYPE OF USE: RESIDENTIAL COMMERCIAL INDUSTRIAL FLOW G.P.D.

If applicant other than actual property owner, attach Letter of Authorization from Property Owner.

Name.....Tel.....  
Mailing Address.....

The Bonded Contractor/Drain Layer authorized to perform this work is:  
Podgurski Corporation 8 Springdale Ave Canton, MA 02021  
Name Address Tel. 781-828-0821

Type of Pipe Required: 6" SDR 35 PVC

PERMIT EXPIRES ONE YEAR AFTER DATE OF ISSUE

- Requires separate connections for sewage and storm drain where applicable. Storm water cannot be discharged to a sanitary sewer.
  - All work must be inspected and approved by a D.P.I. inspector before backfilling.
  - If this connection is to be part of a private service shared jointly with other building owners, attach copy of Recorded Joint Maintenance Agreement.
  - Permits can be issued to Industrial and/or Commercial Applicants only upon receipt and approval by the Commissioner of Public Infrastructure of required plans and supplemental information.
  - In addition, a City-issued Industrial User Discharge Permit and/or a Sewer Extension/Connection Permit issued by the Commonwealth of Massachusetts D.E.P. shall be required by the City for Industrial Discharge into the sewer system.
- Industrial User Discharge Permit No.....Date.....

Comm. Mass. Sewer Conn./Ext. Permit No.....Date.....  
A Filing and Inspection Fee of \$450, plus an Entrance Fee of \$..... where applicable, must accompany this application.

Bank# Community Bank Check# 8572 Date 4/27/10 Receipt# 8741

Other requirements: 24 hour notice for inspection at 508-979-1527

Connection made to Sewer Part of jointly-shared private line YES NO  
Storm Drain

Applicant agrees to abide by the above terms, as well as all pertinent ordinances of the City of New Bedford, and such other special rules as the Commissioner of Public Infrastructure and/or City Engineer may deem necessary

Duarte M. Andrade cs  
Acting City Engineer

Cynthia F. Spina  
Signature of Property Owner or Representative

INSPECTOR'S REPORT

INSPECTED BY: [Signature]  
DATE: 5/19/10  
COMMENTS:

APPROVED

DISAPPROVED

SIGNATURE

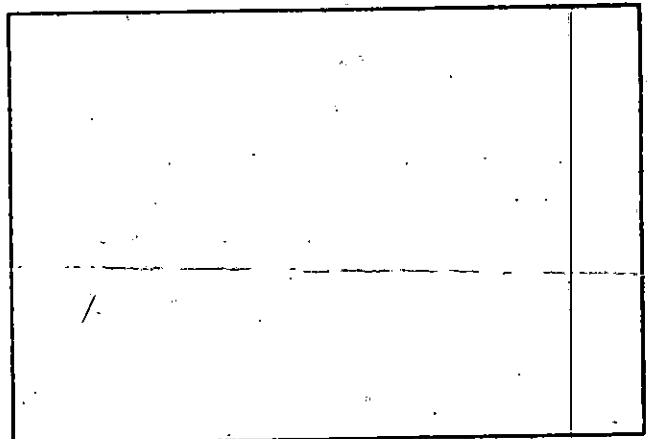

SKETCH PLAN

1073

1988



# CITY OF NEW BEDFORD

 NO. **107309**

LICENSE NO. \_\_\_\_\_

 DATE **2/28** 20 **09**

# FOUNDATION PERMIT

MSBC Sect. 111.8 – Any permit issued shall be deemed abandoned and invalid unless the work authorized by it shall have been commenced within six (6) months after its issuance.

This certifies that **N.B.H.A.**, owner/contractor  
 has permission to **INSTALL FOUNDATION 208' x 32'**  
 on **SUMNER STREET**

providing that the person accepting this permit shall in every respect conform to the terms of the application therefor on file in this office; to the provisions of the Statute of the Commonwealth and to the By-Laws of the City of New Bedford relating to the Inspection, Erection, Enlarging, Altering, Raising, Moving, Repairing or Tearing Down of a Building.

WIRING INSPECTOR

PLUMBING INSPECTOR

BUILDING INSPECTOR

 \_\_\_\_\_  
 \_\_\_\_\_

 \_\_\_\_\_  
 \_\_\_\_\_

 \_\_\_\_\_  
 \_\_\_\_\_

ROUGH FINISH

 YOUR AREA INSPECTOR IS: **Jim BERWDE**

- Tel. 979-1540 Between 8:00 AM - 9:00 AM

NOTICE: NOTIFY INSPECTOR 48 HOURS  
 IN ADVANCE OF APPLYING  
 SHEETING OR LATHING

## OCCUPANCY PERMIT REQUIRED BEFORE OCCUPANCY

No Building or Structure shall be used or occupied until the Certificate of Use and Occupancy shall have been issued by the Building Commissioner – MSBC. Sect. 120.1 – N.B. Zoning Ord. Sect. 9-269

THIS CARD MUST BE DISPLAYED IN A CONSPICUOUS PLACE ON THE PREMISES  
 AND NOT TORN DOWN OR REMOVED UNTIL COMPLETION OF WORK

SUBJECT TO MASSACHUSETTS STATE  
 BUILDING CODE REQUIREMENTS

*[Signature]*  
 BUILDING INSPECTOR



PERMIT NO.

CITY OF NEW BEDFORD  
SEWER AND/OR STORM DRAIN PERMIT

DATE 4-28-10  
EXP. 4-28-11

24192

This certifies that permission is granted to

New Bedford Housing Authority 134 S. Second St. New Bedford MA 02740  
Property Owner Address Tel. 508-997-4800 WS  
+ Community Bldg on Tabitha

To connect a sewer and/or storm drain located at E.S. Summer St between Coggeshall St & Peckham St  
comes from back

Assessor's Plot 90 Lot 27, to the sewer and/or storm drain in from proposed Tabitha Lane Street  
16 units

To be laid in accordance with the conditions in this application and the City of New Bedford ordinances.

TYPE OF USE: RESIDENTIAL COMMERCIAL INDUSTRIAL FLOW G.P.D.

If applicant other than actual property owner, attach Letter of Authorization from Property Owner.

Name.....Tel.....

Mailing Address.....

The Bonded Contractor/Drain Layer authorized to perform this work is:

Podgurski Corporation 8 Springdale Ave. Canton, MA 02021

Name Address Tel. 781-828-0821

Type of Pipe Required: 6" SDR 35 PVC

PERMIT EXPIRES ONE YEAR AFTER DATE OF ISSUE

- Requires separate connections for sewage and storm drain where applicable. Storm water cannot be discharged to a sanitary sewer.
- All work must be inspected and approved by a D.P.I. inspector before backfilling.
- If this connection is to be part of a private service shared jointly with other building owners, attach copy of Recorded Joint Maintenance Agreement.
- Permits can be issued to Industrial and/or Commercial Applicants only upon receipt and approval by the Commissioner of Public Infrastructure of required plans and supplemental information.
- In addition, a City-issued Industrial User Discharge Permit and/or a Sewer Extension/Connection Permit issued by the Commonwealth of Massachusetts D.E.P. shall be required by the City for Industrial Discharge into the sewer system.

Industrial User Discharge Permit No.....Date.....

Comm. Mass. Sewer Conn./Ext. Permit No.....Date.....

A Filing and Inspection Fee of \$450, plus an Entrance Fee of \$..... where applicable, must accompany this application.

Bank# Community Bank Check# 8572 Date 4/27/10 Receipt# 8741

Other requirements: 24 hour notice for inspection at 508-979-1527

Connection made to Sewer Part of jointly-shared private line YES NO  
Storm Drain

Applicant agrees to abide by the above terms, as well as all pertinent ordinances of the City of New Bedford, and such other special rules as the Commissioner of Public Infrastructure and/or City Engineer may deem necessary

Quarte M. Andrade  
Acting City Engineer

Cynthia F. Spina  
Signature of Property Owner or Representative

INSPECTOR'S REPORT

INSPECTED BY: \_\_\_\_\_  
DATE: \_\_\_\_\_  
COMMENTS: \_\_\_\_\_

APPROVED DISAPPROVED

SIGNATURE

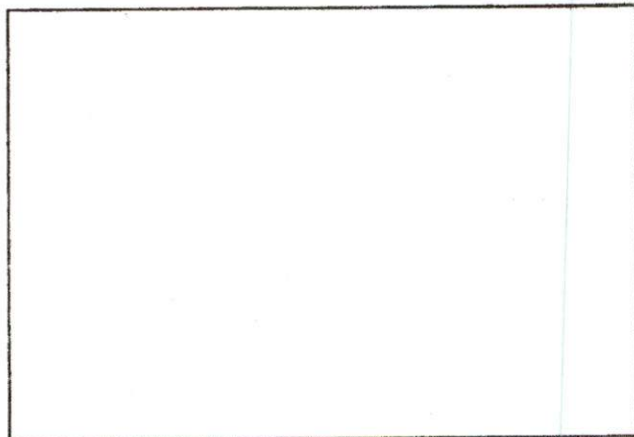

SKETCH PLAN



1077



# CITY OF NEW BEDFORD

NO. **107309**

LICENSE NO. \_\_\_\_\_

DATE **2/28** 20 **09**

# FOUNDATION PERMIT

MSBC Sect. 111.8 – Any permit issued shall be deemed abandoned and invalid unless the work authorized by it shall have been commenced within six (6) months after its issuance.

This certifies that **N.B.H.A.**, owner/contractor  
has permission to **INSTALL FOUNDATION 208' x 32'**  
on **SUMMER STREET**

providing that the person accepting this permit shall in every respect conform to the terms of the application therefor on file in this office; to the provisions of the Statute of the Commonwealth and to the By-Laws of the City of New Bedford relating to the Inspection, Erection, Enlarging, Altering, Raising, Moving, Repairing or Tearing Down of a Building.

WIRING INSPECTOR

PLUMBING INSPECTOR

BUILDING INSPECTOR

\_\_\_\_\_  
\_\_\_\_\_  
\_\_\_\_\_

\_\_\_\_\_  
\_\_\_\_\_  
\_\_\_\_\_

\_\_\_\_\_  
\_\_\_\_\_  
\_\_\_\_\_

ROUGH FINISH

YOUR AREA INSPECTOR IS: **Jim BERWBE**

- Tel. 979-1540 Between 8:00 AM - 9:00 AM

NOTICE: NOTIFY INSPECTOR 48 HOURS  
IN ADVANCE OF APPLYING  
SHEATING OR LATHING

## OCCUPANCY PERMIT REQUIRED BEFORE OCCUPANCY

No Building or Structure shall be used or occupied until the Certificate of Use and Occupancy shall have been issued by the Building Commissioner – MSBC. Sect. 120.1 – N.B. Zoning Ord. Sect. 9-269

THIS CARD MUST BE DISPLAYED IN A CONSPICUOUS PLACE ON THE PREMISES  
AND NOT TORN DOWN OR REMOVED UNTIL COMPLETION OF WORK.

SUBJECT TO MASSACHUSETTS STATE  
BUILDING CODE REQUIREMENTS

**[Signature]**  
BUILDING INSPECTOR