



PERMIT NO.

24190

This certifies that permission is granted to

CITY OF NEW BEDFORD
SEWER AND/OR STORM DRAIN PERMIT

DATE 4-28-10

Exp 4-28-11

New Bedford Housing Authority 134 S. Second St. New Bedford MA 02740
Property Owner Address Tel. 508-997-4800

To connect a sewer and/or storm drain located at Sewer & Storm drain (Extension) in Proposed Tabitha Lane

Assessor's Plot 90 Lot 27, to the sewer and/or storm drain in Proposed Tabitha Lane From Street Coggeshall St to Peckham St

To be laid in accordance with the conditions in this application and the City of New Bedford ordinances.

TYPE OF USE: RESIDENTIAL COMMERCIAL INDUSTRIAL FLOW G.P.D.

If applicant other than actual property owner, attach Letter of Authorization from Property Owner.

Name Mailing Address Tel.

The Bonded Contractor/Drain Layer authorized to perform this work is:

Podgurski Corporation 8 Springdale Ave. Canton MA 02021
Name Address Tel. 781-828-0821

Type of Pipe Required: 8" SDR 35 PVC

PERMIT EXPIRES ONE YEAR AFTER DATE OF ISSUE

- Requires separate connections for sewage and storm drain where applicable. Storm water cannot be discharged to a sanitary sewer.
- All work must be inspected and approved by a D.P.I. inspector before backfilling.
- If this connection is to be part of a private service shared jointly with other building owners, attach copy of Recorded Joint Maintenance Agreement.
- Permits can be issued to Industrial and/or Commercial Applicants only upon receipt and approval by the Commissioner of Public Infrastructure of required plans and supplemental information.
- In addition, a City-issued Industrial User Discharge Permit and/or a Sewer Extension/Connection Permit issued by the Commonwealth of Massachusetts D.E.P. shall be required by the City for Industrial Discharge into the sewer system.

Industrial User Discharge Permit No. Date

Comm. Mass. Sewer Conn./Ext. Permit No. Date

A Filing and Inspection Fee of \$450.00, plus an Entrance Fee of \$1996, where applicable, must accompany this application.

Sewer Extension Fee - \$1136.00 Storm Drain Extension
Bank# THE Community Bank Check# 8572 Date 4-27-10 Receipt# 8741

Other requirements: 24 hour inspection notice @ 508-979-1537

Connection made to Sewer Part of jointly-shared private line YES NO
Storm Drain

Applicant agrees to abide by the above terms, as well as all pertinent ordinances of the City of New Bedford, and such other special rules as the Commissioner of Public Infrastructure and/or City Engineer may deem necessary

Duarte M. ANDRADE Acting City Engineer
Signature of Property Owner or Representative

INSPECTOR'S REPORT

INSPECTED BY:

DATE:

COMMENTS:

APPROVED

DIS

SEE WHITE SHEET

SIGNATURE

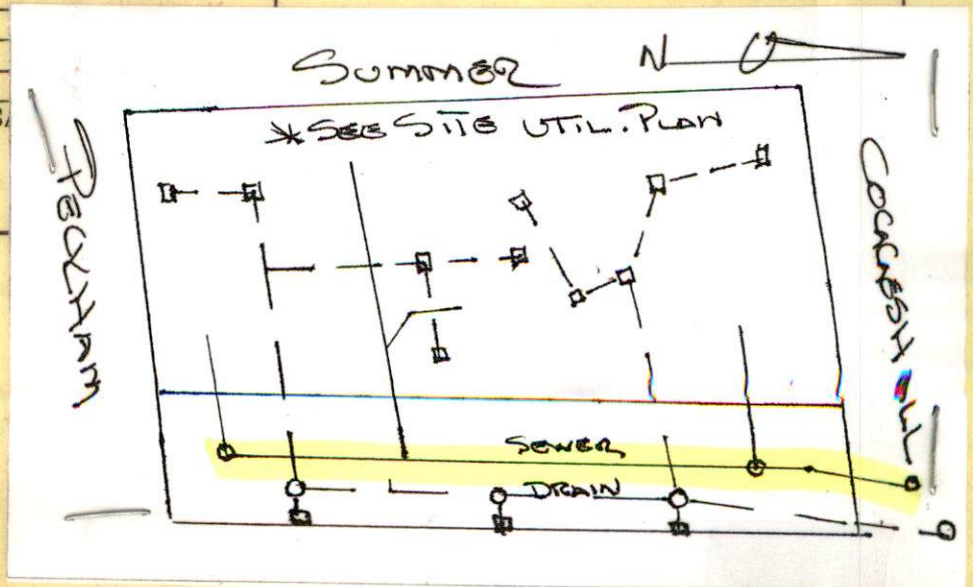



WORK ORDER

CHECK LEAK

MARK OFF

INSPECTION

POOR PRESSURE

HYDRANT

INVESTIGATE

SHUT-OFF

TURN-ON

DATE: 5/17 TIME: 3:35 FROM: Carol

TO: Bob Bichel

LOCATION: Coggeshall St.

Crestview Senior Housing.

COMMENTS: _____

Sewer inspection

Wednesday 5/19/10 - after

lunch

Kurt Podgurski Construction

RESPONSE: 781-828-0821

DATE: _____ FROM: _____



Inspector

PERMIT NO.

24190 - 03

CITY OF NEW BEDFORD
SEWER AND/OR STORM DRAIN PERMIT

DATE 4-28-10

Exp 4-28-11

This certifies that permission is granted to

New Bedford Housing Authority 134 S. Second St. New Bedford MA 02740
Property Owner Address Tel. 508-997-4800

To connect a sewer and/or storm drain located at Sewer & Storm drain (Extension) in Proposed
Tabitha Lane

Assessor's Plot 90 Lot 27, to the sewer and/or storm drain in Proposed Tabitha Lane From
Coggeshall St to Peckham St

To be laid in accordance with the conditions in this application and the City of New Bedford ordinances.

TYPE OF USE: RESIDENTIAL COMMERCIAL INDUSTRIAL FLOW G.P.D.

If applicant other than actual property owner, attach Letter of Authorization from Property Owner.

Name Tel.

Mailing Address

The Bonded Contractor/Drain Layer authorized to perform this work is:

Podgurski Corporation 8 Springdale Ave. Canton MA 02021
Name Address Tel. 781-828-0831

Type of Pipe Required: 8" SDR 35 PVC

PERMIT EXPIRES ONE YEAR AFTER DATE OF ISSUE

- Requires separate connections for sewage and storm drain where applicable. Storm water cannot be discharged to a sanitary sewer.
 - All work must be inspected and approved by a D.P.I. inspector before backfilling.
 - If this connection is to be part of a private service shared jointly with other building owners, attach copy of Recorded Joint Maintenance Agreement.
 - Permits can be issued to Industrial and/or Commercial Applicants only upon receipt and approval by the Commissioner of Public Infrastructure of required plans and supplemental information.
 - In addition, a City-issued Industrial User Discharge Permit and/or a Sewer Extension/Connection Permit issued by the Commonwealth of Massachusetts D.E.P. shall be required by the City for Industrial Discharge into the sewer system.
- Industrial User Discharge Permit No. Date

Comm. Mass. Sewer Conn./Ext. Permit No. Date

A Filing and Inspection Fee of \$450.00 plus an Entrance Fee of \$1996 where applicable, must accompany this application.

Sewer Extension Fee - \$136.00 Storm Drain EXTENSION
Bank# THE Community Bank Check# 8572 Date 4-27-10 Receipt# 8741

Other requirements: 24 hour inspection Notice @ 508-979-1537

Connection made to Sewer Part of jointly-shared private line YES NO
Storm Drain

Applicant agrees to abide by the above terms, as well as all pertinent ordinances of the City of New Bedford, and such other special rules as the Commissioner of Public Infrastructure and/or City Engineer may deem necessary

Duarte M. ANDRADE
Acting City Engineer

Signature of Property Owner or Representative

INSPECTOR'S REPORT

INSPECTED BY: [Signature]
DATE: 5/19/10
COMMENTS:

APPROVED DISAPPROVED

SIGNATURE

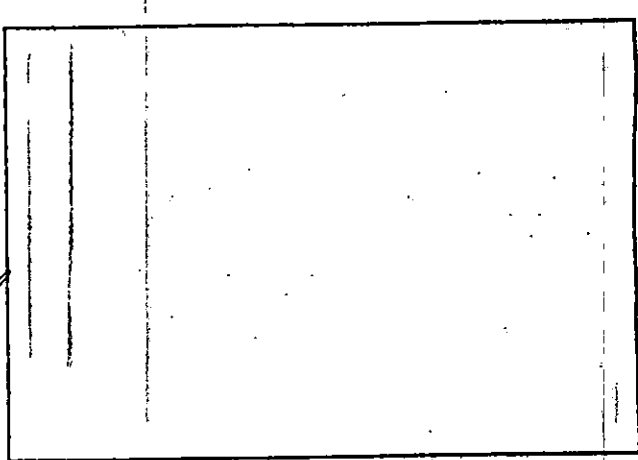

SKETCH PLAN



PERMIT NO.

24190

This certifies that permission is granted to

CITY OF NEW BEDFORD
SEWER AND/OR STORM DRAIN PERMIT

DATE 4-28-10
Exp 4-28-11

New Bedford Housing Authority 134 S. Second St. New Bedford MA 02740
Property Owner Address Tel. 508-997-4800

To connect a sewer and/or storm drain located at Sewer & Storm drain Extension in Proposed
Tabitha Lane
Assessor's Plot 90 Lot 27 to the sewer and/or storm drain in Proposed Tabitha Lane From
Coggeshall St to Peckham St

To be laid in accordance with the conditions in this application and the City of New Bedford ordinances.

TYPE OF USE: RESIDENTIAL COMMERCIAL INDUSTRIAL FLOW G.P.D.

If applicant other than actual property owner, attach Letter of Authorization from Property Owner.

Name Tel.
Mailing Address

The Bonded Contractor/Drain Layer authorized to perform this work is:

Podgurski Corporation 8 Springdale Ave. Canton, MA 02021
Name Address Tel. 781-828-0821
Type of Pipe Required: 8" SDR 35 PVC

PERMIT EXPIRES ONE YEAR AFTER DATE OF ISSUE

- Requires separate connections for sewage and storm drain where applicable. Storm water cannot be discharged to a sanitary sewer.
 - All work must be inspected and approved by a D.P.I. inspector before backfilling.
 - If this connection is to be part of a private service shared jointly with other building owners, attach copy of Recorded Joint Maintenance Agreement.
 - Permits can be issued to Industrial and/or Commercial Applicants only upon receipt and approval by the Commissioner of Public Infrastructure of required plans and supplemental information.
 - In addition, a City-issued Industrial User Discharge Permit and/or a Sewer Extension/Connection Permit issued by the Commonwealth of Massachusetts D.E.P. shall be required by the City for Industrial Discharge into the sewer system.
- Industrial User Discharge Permit No. Date

Comm. Mass. Sewer Conn./Ext. Permit No. Date

A Filing and Inspection Fee of \$450.00 plus an Entrance Fee of \$199.00 where applicable, must accompany this application.

Sewer Extension fee - \$1136.00 Storm Drain Extension
Bank# THE Community Bank Check# 8572 Date 4-27-10 Receipt# 8741

Other requirements: 24 hour inspection Notice @ 508-979-1527

Connection made to Sewer Part of jointly-shared private line YES NO
Storm Drain

Applicant agrees to abide by the above terms, as well as all pertinent ordinances of the City of New Bedford, and such other special rules as the Commissioner of Public Infrastructure and/or City Engineer may deem necessary

Duarte M. ANDRADE
Acting City Engineer

Cynthia F. Spina NBHA
Signature of Property Owner or Representative

INSPECTOR'S REPORT

INSPECTED BY:
DATE:
COMMENTS:

APPROVED DISAPPROVED

SIGNATURE

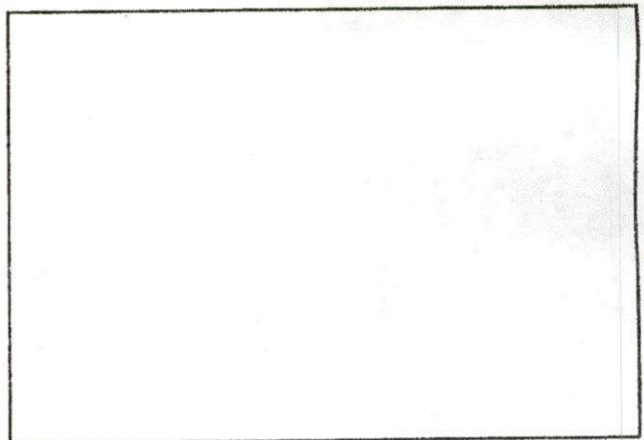

SKETCH PLAN

1071

1086



CITY OF NEW BEDFORD

NO. 107109

LICENSE NO. _____

DATE 7/28 2009

FOUNDATION PERMIT

MSBC Sect. 111.8 – Any permit issued shall be deemed abandoned and invalid unless the work authorized by it shall have been commenced within six (6) months after its issuance.

This certifies that N.B.H.A., owner/contractor
has permission to INSTALL FOUNDATION 53' 3" x 25'
on Peckham Street

providing that the person accepting this permit shall in every respect conform to the terms of the application therefor on file in this office; to the provisions of the Statute of the Commonwealth and to the By-Laws of the City of New Bedford relating to the Inspection, Erection, Enlarging, Altering, Raising, Moving, Repairing or Tearing Down of a Building.

WIRING INSPECTOR

PLUMBING INSPECTOR

BUILDING INSPECTOR

ROUGH FINISH

YOUR AREA INSPECTOR IS: Jim BERUBE

- Tel. 979-1540 Between 8:00 AM – 9:00 AM

NOTICE: NOTIFY INSPECTOR 48 HOURS
IN ADVANCE OF APPLYING
SHEATING OR LATHING

OCCUPANCY PERMIT REQUIRED BEFORE OCCUPANCY
No Building or Structure shall be used or occupied until the Certificate of Use and Occupancy shall have been issued by the Building Commissioner – MSBC. Sect. 120.1 – N.B. Zoning Ord. Sect. 9-269

THIS CARD MUST BE DISPLAYED IN A CONSPICUOUS PLACE ON THE PREMISES
AND NOT TORN DOWN OR REMOVED UNTIL COMPLETION OF WORK

SUBJECT TO MASSACHUSETTS STATE
BUILDING CODE REQUIREMENTS

[Signature]
BUILDING INSPECTOR