

This certifies that permission is granted to

To connect a sewer and/or storm drain located at..... 1 stub at prop. line 5.5 deep.....

Assessor's Plot81.....Lot.....42....., to the sewer and/or storm drain in.....Rockdale Avenue Street

To be laid in accordance with the conditions in this application and the City of New Bedford ordinances.

TYPE OF USE: ☒ RESIDENTIAL

If applicant other than actual property owner, attach Letter of Authorization from Property Owner.

Name Demetrio Costa Tel. 224 263 2197

Mailing Address 415 Lake Rd. Twinton, R.I.

The Bonded Contractor/Drain Layer authorized to perform this work is:

C. Construction 415 Lake Rd. Twinston K.S.

| Name | Address | Tel. |
|------|---------|------|
|------|---------|------|

PERMIT EXPIRES ONE YEAR AFTER DATE OF ISSUE

- Requires separate connections for sewage and storm drain where applicable. Storm water cannot be discharged to a sanitary sewer.
- All work must be inspected and approved by a D.P.I. inspector before backfilling.
- If this connection is to be part of a private service shared jointly with other building owners, attach copy of Recorded Joint Maintenance Agreement.
- Permits can be issued to Industrial and/or Commercial Applicants only upon receipt and approval by the Commissioner of Public Infrastructure of required plans and supplemental information.
- In addition, a City-issued Industrial User Discharge Permit and/or a Sewer Extension/Connection Permit issued by the Commonwealth of Massachusetts D.E.P. shall be required by the City for Industrial Discharge into the sewer system.

Industrial User Discharge Permit No. Date

Comm. Mass. Sewer Conn./Ext. Permit No. Date.....

A Filing and Inspection Fee of \$450.00, plus an Entrance Fee of \$323.40 where applicable, must accompany this application.

Bank# Evergreen Bank Check# 0507655 Date 9/21/09 Receipt# 8477

Other requirements: 24 hr. inspection notice at 508-979-1527

| Connection made to | <u>Sewer</u> | Part of jointly-shared private line | YES | <u>NO</u> |
|--------------------|--------------|-------------------------------------|-----|-----------|
| | Storm Drain | | | |

Applicant agrees to abide by the above terms, as well as all pertinent ordinances of the City of New Bedford, and such other special rules as the Commissioner of Public Infrastructure and/or City Engineer may deem necessary

.....
 Acting City Engineer

Wayne Greenwood
Signature of Property Owner or Representative

INSPECTOR'S REPORT

INSPECTED BY: _____
DATE: 9/23/09
COMMENTS: _____

APPROVED

DISAP

SIGNATURE

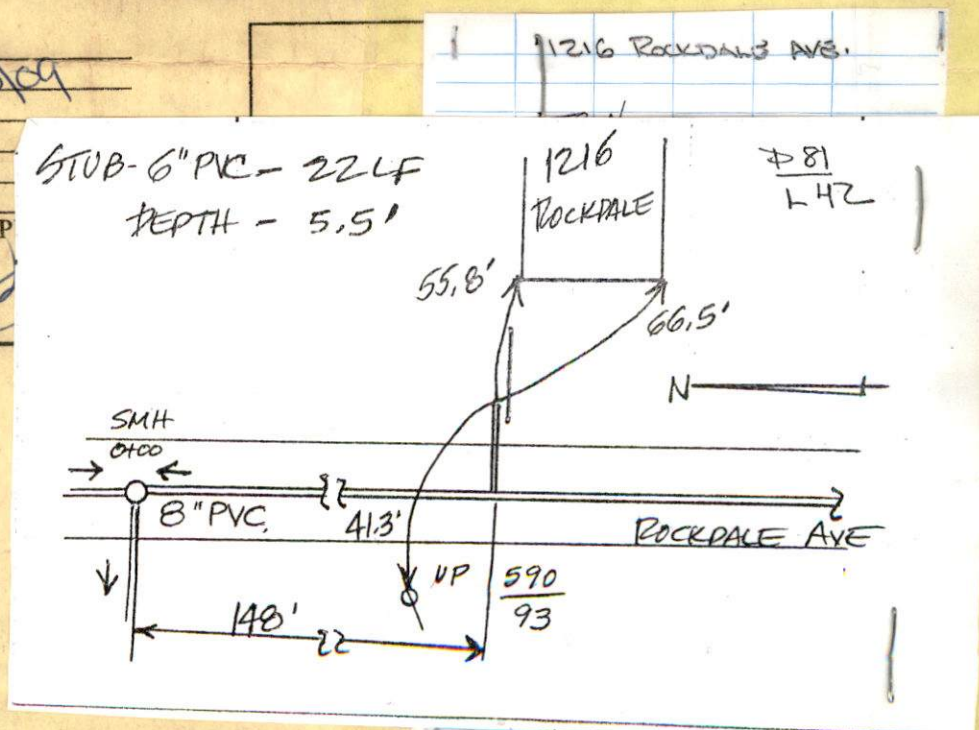



PERMIT NO.
24146

CITY OF NEW BEDFORD
SEWER AND/OR STORM DRAIN PERMIT

DATE 9/15/09

This certifies that permission is granted to

Norman Mendoza 66 Willard St. (owner)
Property Owner Address 1216 Rockdale Ave. N.B. Tel. 617.803.9592

To connect a sewer and/or storm drain located at ↑ stub at prop. line 5.5' deep

Assessor's Plot 81 Lot 42, to the sewer and/or storm drain in Rockdale Avenue Street

To be laid in accordance with the conditions in this application and the City of New Bedford ordinances.

TYPE OF USE: ☒ RESIDENTIAL ☐ COMMERCIAL ☐ INDUSTRIAL FLOW 440 G.P.D.

If applicant other than actual property owner, attach Letter of Authorization from Property Owner.

Name Demetrio Costa / Wayne Greenwood Tel. 774.263.2197

Mailing Address 415 Lake Rd. Swanton Rd.

The Bonded Contractor/Drain Layer authorized to perform this work is:

J.L.C. Construction 415 Lake Rd. Swanton Rd.
Name Address Tel.

Type of Pipe Required: sdr 3.5 pvc 774.263.2197

PERMIT EXPIRES ONE YEAR AFTER DATE OF ISSUE

- Requires separate connections for sewage and storm drain where applicable. Storm water cannot be discharged to a sanitary sewer.
- All work must be inspected and approved by a D.P.I. inspector before backfilling.
- If this connection is to be part of a private service shared jointly with other building owners, attach copy of Recorded Joint Maintenance Agreement.
- Permits can be issued to Industrial and/or Commercial Applicants only upon receipt and approval by the Commissioner of Public Infrastructure of required plans and supplemental information.
- In addition, a City-issued Industrial User Discharge Permit and/or a Sewer Extension/Connection Permit issued by the Commonwealth of Massachusetts D.E.P. shall be required by the City for Industrial Discharge into the sewer system.

Industrial User Discharge Permit No. _____ Date _____

Comm. Mass. Sewer Conn./Ext. Permit No. _____ Date _____

A Filing and Inspection Fee of \$450.00 plus an Entrance Fee of \$323.40 where applicable, must accompany this application.

Bank# Sovereign Bank Check# 0507655 Date 9/21/09 Receipt# 8477

Other requirements: 24 hr. inspection notice at 508-979-1527

Connection made to Sewer Part of jointly-shared private line YES NO
Storm Drain

Applicant agrees to abide by the above terms, as well as all pertinent ordinances of the City of New Bedford, and such other special rules as the Commissioner of Public Infrastructure and/or City Engineer may deem necessary

Duarte M. Andrade
Acting City Engineer

Wayne Greenwood
Signature of Property Owner or Representative

INSPECTOR'S REPORT

INSPECTED BY: _____

DATE: _____

COMMENTS: _____

APPROVED

DISAPPROVED

SIGNATURE

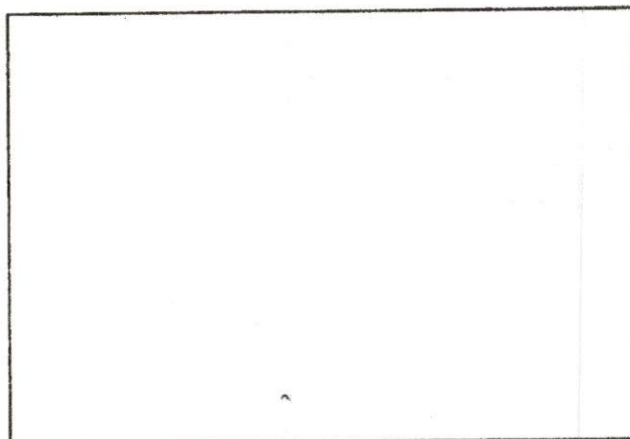

SKETCH PLAN



Ronald Labelle
Commissioner

Duarte M. Andrade
Acting City Engineer

CITY OF NEW BEDFORD MASSACHUSETTS

D.P.I. -Engineering Division

1105 Shawmut Ave.

New Bedford, Ma. 02746

Tel: 508-991-6150

Fax: 508-991-6152

To Whom It May Concern:

I NORMAN MENDOZA, being
(Name) (Mailing Address)

Owner of property located at 1216 Rockdale Ave

Plot _____, Lot _____, hereby agree to allow J.L.C. Construction
(Name)

415 Lake Rd Tiverton RI to act on my behalf including affixing my
(Mailing Address) 02878

signature in securing permit for:

☒ Sewer/Drain Service Permits
☐ Water Service Permits
☐ Driveway Installation Permits
☐ Sidewalk Installation Permits

I further agree to conform to, and abide by, All City rules and ask regulations applicable to the permit (s) being applied for:

Name NORMAN MENDOZA
Signature

66 WILLARD ST New Bedford
Address

9-9-09
Date

617-803-2592
Telephone Number

Dig SAFE # 2009 370 3116

1216 Rockdale Ave

Sewer Line

From Prop - Line to House

Mary T. Neves

From: Sarah Porter
Sent: Wednesday, September 16, 2009 1:13 PM
To: Mary T. Neves
Cc: Ana S. Rosa; Carol Sherman; Kerry Muldoon
Subject: RE: SEWER PERMIT

Hi Mary, yes you can issue that permit
Thank you

From: Mary T. Neves
Sent: Tuesday, September 15, 2009 9:18 AM
To: Sarah Porter
Cc: Ana S. Rosa; Carol Sherman
Subject: SEWER PERMIT

Hi Sarah,

The owner of 1216 Rockdale Avenue would like to tie into the sewer stub at their property line. The plot is 81 and the lot is 42.

May we issue the permit?

Thanks for your assistance.

Mary

trench permit dig-safe
2009-370 3116

No. 05-15

FEE \$56.00
Rec # 5589

COMMONWEALTH OF MASSACHUSETTS
Board of Health, New Bedford, MA.
DISPOSAL SYSTEM CONSTRUCTION PERMIT

Permission is hereby granted to; Construct() Repair() Upgrade() Abandon(☒) an individual sewage disposal system
at 1216 Rockdale Ave as described in the application for

Disposal System Construction Permit No. 05-15, dated 9/15/09

Provided: Construction shall be completed within three years of the date of this permit. All local conditions must be met.

Form 1255 Rev. 5/96 A.M. Sulkin Co. Boston, MA

Date 9/15/09 Board of Health [Signature]

No. 5589

CITY OF NEW BEDFORD
BILL FOR ENVIRONMENTAL HEALTH

Date: 9/15/09 Issued By: Mary

Name: Domenico Costa

Address: 415 Rockdale Rd
Township of 02878

Permit #:

Description/Calculations:

Septic Tank
Septic Abatement

Fee: \$560 Check #: 1603

Make Check Payable to City of New Bedford

0001-241-44255-000

RECORD OF PAYMENT

CITY CLERK'S OFFICE
NEW BEDFORD, MASS.

NO REFUNDS OR RETU

Date 9-15-9

To

For THE CONSTRUCTION

1216 Rockdale Ave
1 permit - labor

Amount Paid \$55.00 CHAS

Clerk RL CAV
481628
WINING PRESS INC FAIRHAVEN MA 02719 3305438
CUSTOMER

1216 ROCKDALE AVE.

C.V.

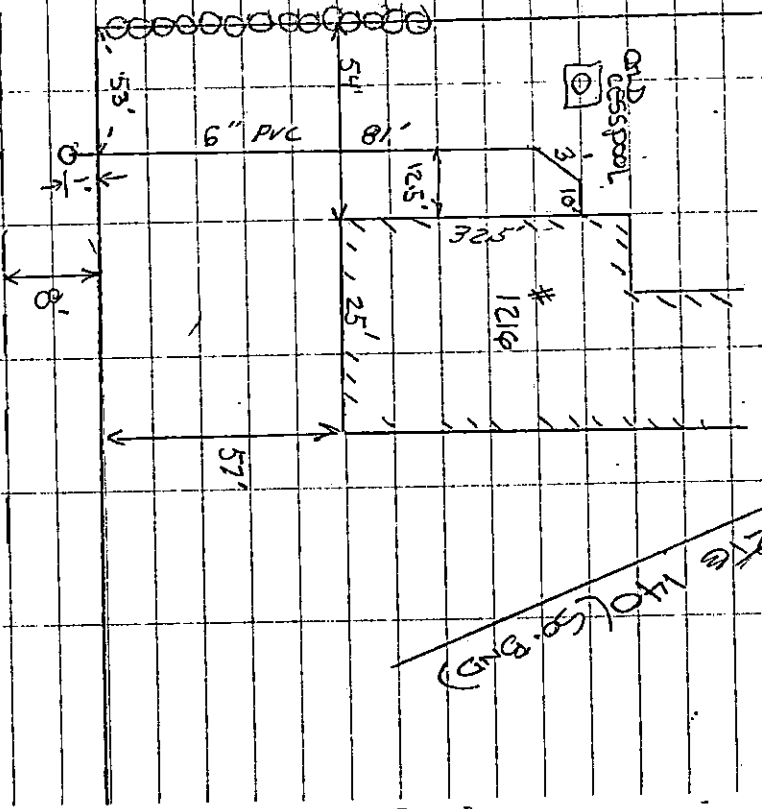

ROCKDALE AVE.

12" 140 (S.B.W.)

COVER TIE-IN

DATE: 9/23/04

CONTR: JLC CONST. / DIMENSION

INSPIRE 12.3.04

SEWER PERMIT 24146

PER 81 101 42

5050 800 RER
10/21/04