



PERMIT NO.
24126

CITY OF NEW BEDFORD
SEWER AND/OR STORM DRAIN PERMIT

DATE 6/15/09
EXP. 6/15/10

This certifies that permission is granted to

Isabel Alves 772 New Plainville Rd N. Dartmouth, MA
Property Owner Address Tel. 508-995-8109

To connect a sewer and/or storm drain located at England St (NS) 150' W x Mt. Pleasant St

Assessor's Plot 123A Lot 360, to the sewer and/or storm drain in England St Street

To be laid in accordance with the conditions in this application and the City of New Bedford ordinances.

TYPE OF USE: RESIDENTIAL COMMERCIAL INDUSTRIAL FLOW 330 G.P.D.

If applicant other than actual property owner, attach Letter of Authorization from Property Owner.

Name Jose Fontes Tel. 508-991-5047

Mailing Address 178 Grinnell St NB MA

The Bonded Contractor/Drain Layer authorized to perform this work is:

JLC Construction 415 Lake Rd Tiverton RI 508-326-9228

Name Address Tel.

Type of Pipe Required: PRC SDR-35

PERMIT EXPIRES ONE YEAR AFTER DATE OF ISSUE

- Requires separate connections for sewage and storm drain where applicable. Storm water cannot be discharged to a sanitary sewer.
- All work must be inspected and approved by a D.P.I. inspector before backfilling.
- If this connection is to be part of a private service shared jointly with other building owners, attach copy of Recorded Joint Maintenance Agreement.
- Permits can be issued to Industrial and/or Commercial Applicants only upon receipt and approval by the Commissioner of Public Infrastructure of required plans and supplemental information.
- In addition, a City-issued Industrial User Discharge Permit and/or a Sewer Extension/Connection Permit issued by the Commonwealth of Massachusetts D.E.P. shall be required by the City for Industrial Discharge into the sewer system.

Industrial User Discharge Permit No. Date

Comm. Mass. Sewer Conn./Ext. Permit No. Date

A Filing and Inspection Fee of \$450, plus an Entrance Fee of \$194.40 where applicable, must accompany this application.

Bank# Citizens Bank Check# 1706 Date 6/15/09 Receipt# 8370

St. Anne's Credit Union 1031 7/16/09 8404
Other requirements: Insp Only - 24 hrs. notice for Pre-Inspection - Connect to

8" Sewer main

Connection made to Sewer Part of jointly-shared private line YES NO updated 7/16/09 with sewer stub fee being paid
Storm Drain

Applicant agrees to abide by the above terms, as well as all pertinent ordinances of the City of New Bedford, and such other special rules as the Commissioner of Public Infrastructure and/or City Engineer may deem necessary

Duarte M. Andrade MA
Acting City Engineer

Jose A. Fontes
Signature of Property Owner or Representative
Jose Fontes

INSPECTOR'S REPORT

INSPECTED BY: _____

DATE: _____

COMMENTS: _____

APPROVED

DISAPPROVED

SIGNATURE

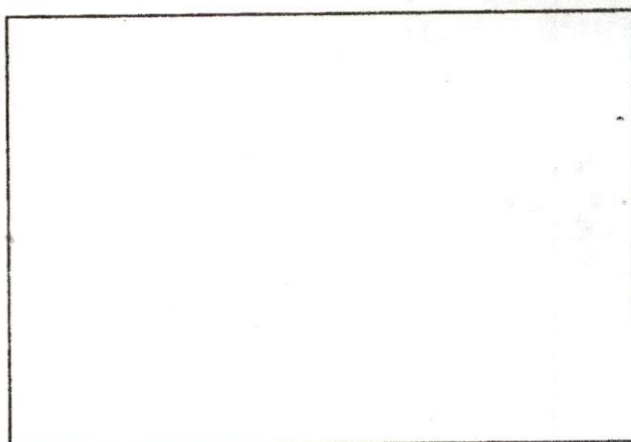

SKETCH PLAN



CITY OF NEW BEDFORD MASSACHUSETTS

D.P.I. -Engineering Division

1105 Shawmut Ave.

New Bedford, Ma. 02746

Tel: 508-991-6150

Fax: 508-991-6152

Ronald Labelle
Commissioner

Duarte M. Andrade
Acting City Engineer

To Whom It May Concern:

I Isabel Alves 772 New Blainville Rd. N.D. MA-02747, being
(Name) (Mailing Address)

Owner of property located at #1 England St.

Plot 123 A, Lot 360, hereby agree to allow JOSE FONTES
(Name)

178 Guinnell St. N.B. MA., to act on my behalf including affixing my
(Mailing Address)

signature in securing permit for:

☒ Sewer/Drain Service Permits
☒ Water Service Permits
☐ Driveway Installation Permits
☐ Sidewalk Installation Permits

I further agree to conform to, and abide by, All City rules and ask regulations applicable to the permit (s) being applied for:

Name Isabel M. Alves
Signature

772 New Blainville Rd. N.D. MA-02747
Address

6-15-09 508-9958109
Date Telephone number



CITY OF NEW BEDFORD

1043

NO. 180408 LICENSE NO. _____DATE 10/16 2008

FOUNDATION PERMIT

MSBC Sect. 111.8 – Any permit issued shall be deemed abandoned and invalid unless the work authorized by it shall have been commenced within six (6) months after its issuance.

This certifies that Joe Fouter, owner contractor
has permission to Install foundation 50.5 x 59
on England St Plot 123A, Lot 360

providing that the person accepting this permit shall in every respect conform to the terms of the application therefor on file in this office; to the provisions of the Statute of the Commonwealth and to the By-Laws of the City of New Bedford relating to the Inspection, Erection, Enlarging, Altering, Raising, Moving, Repairing or Tearing Down of a Building.

WIRING INSPECTOR

PLUMBING INSPECTOR

BUILDING INSPECTOR

ROUGH FINISH

YOUR AREA INSPECTOR IS: _____

– Tel. 979-1540 Between 8:00 AM – 9:00 AM

NOTICE: NOTIFY INSPECTOR 48 HOURS
IN ADVANCE OF APPLYING
SHEATING OR LATHING

OCCUPANCY PERMIT REQUIRED BEFORE OCCUPANCY

No Building or Structure shall be used or occupied until the Certificate of Use and Occupancy shall have been issued by the Building Commissioner – MSBC. Sect. 120.1 – N.B. Zoning Ord. Sect. 9-269

THIS CARD MUST BE DISPLAYED IN A CONSPICUOUS PLACE ON THE PREMISES
AND NOT TORN DOWN OR REMOVED UNTIL COMPLETION OF WORK

SUBJECT TO MASSACHUSETTS STATE
BUILDING CODE REQUIREMENTS

BUILDING INSPECTOR

213 ENGLAND ST.

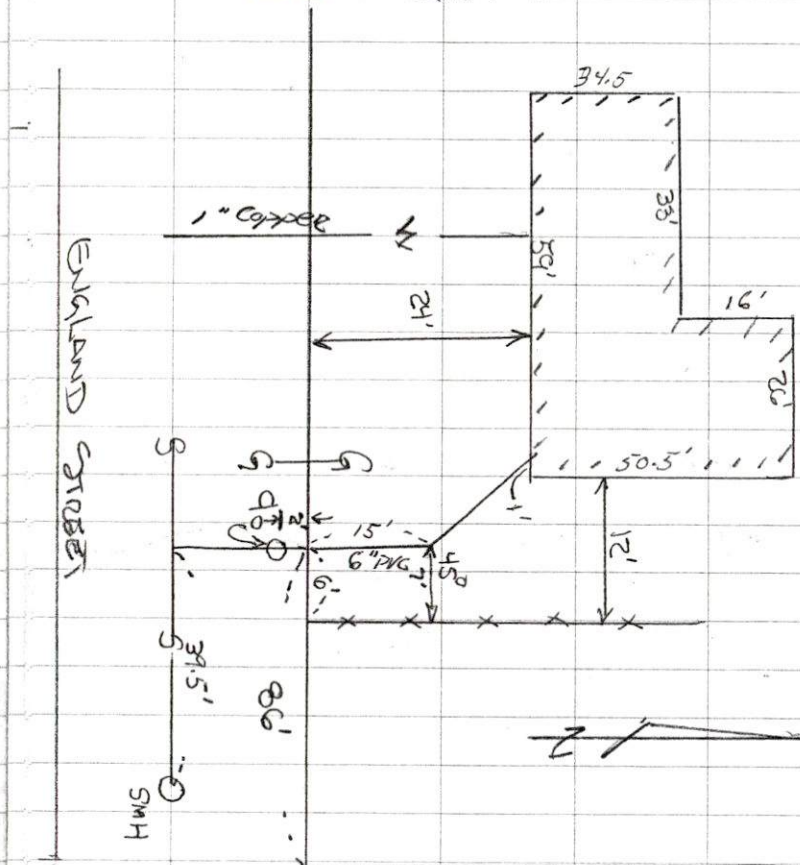

MT. PLEASANT

16

SEWER TIE-IN

DATE: 7/17/09

CONTRACTOR: JLC / DEMETRI

INSPECTOR: R. Bichel

Permit # 24126

PLOT 123A LOT 360

NEW CONSTRUCTION

Sub for REC 10/27/09