



PERMIT NO.

24101

CITY OF NEW BEDFORD
SEWER AND/OR STORM DRAIN PERMIT

DATE 1/6/09

This certifies that permission is granted to

Am. Res. Bismark Ralty Trust 3 Ridgewood Blvd. Dactmouth MA
Property Owner Address Tel. (#46) 2748

To connect a sewer and/or storm drain located at 440' E of Bismark St. ss in Bismark Meadows Rd

Assessor's Plot 136 Lot 514, to the sewer and/or storm drain in 3" force main in Bismark Meadows Street Rd.

To be laid in accordance with the conditions in this application and the City of New Bedford ordinances.

TYPE OF USE: ☒ RESIDENTIAL ☐ COMMERCIAL ☐ INDUSTRIAL FLOW 330 G.P.D.

If applicant other than actual property owner, attach Letter of Authorization from Property Owner.

Name..... Tel.....

Mailing Address.....

The Bonded Contractor/Drain Layer authorized to perform this work is:

W.C. Smith 58 Ridgewood Rd. N.B. 508.9951447
Name Address Tel.

Type of Pipe Required: PVC SDR 40

PERMIT EXPIRES ONE YEAR AFTER DATE OF ISSUE

- Requires separate connections for sewage and storm drain where applicable. Storm water cannot be discharged to a sanitary sewer.
 - All work must be inspected and approved by a D.P.I. inspector before backfilling.
 - If this connection is to be part of a private service shared jointly with other building owners, attach copy of Recorded Joint Maintenance Agreement.
 - Permits can be issued to Industrial and/or Commercial Applicants only upon receipt and approval by the Commissioner of Public Infrastructure of required plans and supplemental information.
 - In addition, a City-issued Industrial User Discharge Permit and/or a Sewer Extension/Connection Permit issued by the Commonwealth of Massachusetts D.E.P. shall be required by the City for Industrial Discharge into the sewer system.
- Industrial User Discharge Permit No..... Date.....

Comm. Mass. Sewer Conn./Ext. Permit No..... Date.....

A Filing and Inspection Fee of \$450.00 plus an Entrance Fee of \$..... where applicable, must accompany this application.

Bank# Bank 5 Check# 1035 Date 1/5/09 Receipt# 8178

Other requirements: 24 hr inspection notice at

508.9951527

Connection made to Sewer Part of jointly-shared private line YES NO
Storm Drain

Applicant agrees to abide by the above terms, as well as all pertinent ordinances of the City of New Bedford, and such other special rules as the Commissioner of Public Infrastructure and/or City Engineer may deem necessary

Quanta M. Asquith
Acting City Engineer mn

Signature of Property Owner or Representative

INSPECTOR'S REPORT

INSPECTED BY: SEE WHITE SHEET

DATE:

COMMENTS:

APPROVED

DIS.

SIGNATURE

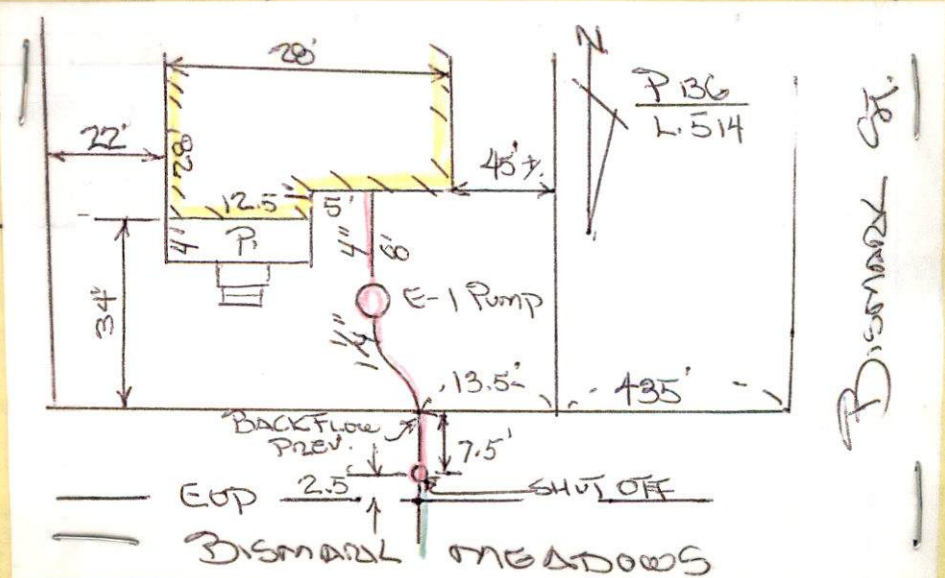



PERMIT NO.

24101

CITY OF NEW BEDFORD
SEWER AND/OR STORM DRAIN PERMIT

DATE 1/6/09

This certifies that permission is granted to

Ara Reis Bismark Realty Trust 3 Lodgewood Blvd. Dartmouth MA
Property Owner Address Tel. 508 958 199
02148

To connect a sewer and/or storm drain located at 440' e. of Bismark St. ss. in Bismark Meadows Rd
Assessor's Plot 136 Lot 514, to the sewer and/or storm drain in 3" force main in Bismark Meadows Street Rd.

To be laid in accordance with the conditions in this application and the City of New Bedford ordinances.

TYPE OF USE: ☒ RESIDENTIAL ☐ COMMERCIAL ☐ INDUSTRIAL FLOW 330 G.P.D.

If applicant other than actual property owner, attach Letter of Authorization from Property Owner.

Name..... Tel.....

Mailing Address.....

The Bonded Contractor/Drain Layer authorized to perform this work is:

W.C. Smith 58 Ridgewood Rd. N.B. 508 995 1449
Name Address Tel.

Type of Pipe Required: PVC SDR 40

PERMIT EXPIRES ONE YEAR AFTER DATE OF ISSUE

- Requires separate connections for sewage and storm drain where applicable. Storm water cannot be discharged to a sanitary sewer.
- All work must be inspected and approved by a D.P.I. inspector before backfilling.
- If this connection is to be part of a private service shared jointly with other building owners, attach copy of Recorded Joint Maintenance Agreement.
- Permits can be issued to Industrial and/or Commercial Applicants only upon receipt and approval by the Commissioner of Public Infrastructure of required plans and supplemental information.
- In addition, a City-issued Industrial User Discharge Permit and/or a Sewer Extension/Connection Permit issued by the Commonwealth of Massachusetts D.E.P. shall be required by the City for Industrial Discharge into the sewer system.

Industrial User Discharge Permit No. Date

Comm. Mass. Sewer Conn./Ext. Permit No. Date

A Filing and Inspection Fee of \$ 450.00 plus an Entrance Fee of \$ where applicable, must accompany this application.

Bank# Bank 5 Check# 1035 Date 1/5/09 Receipt# 8178

Other requirements: 24 hr. inspection notice at

508 995 1527

Connection made to Sewer Part of jointly-shared private line YES NO
Storm Drain

Applicant agrees to abide by the above terms, as well as all pertinent ordinances of the City of New Bedford, and such other special rules as the Commissioner of Public Infrastructure and/or City Engineer may deem necessary

Quanta M. Andrade
Acting City Engineer mn

Signature of Property Owner or Representative

INSPECTOR'S REPORT

INSPECTED BY:

DATE:

COMMENTS:

.....

.....

APPROVED

DISAPPROVED

SIGNATURE

SKETCH PLAN



Inspector's Copy

PERMIT NO.

24101

CITY OF NEW BEDFORD
SEWER AND/OR STORM DRAIN PERMIT

DATE 1/6/09

This certifies that permission is granted to

Ara Reis Bismark Realty Trust 3 Ledge Wood Blvd Dartmouth MA
Property Owner Address Tel. (#46) 02148

To connect a sewer and/or storm drain located at 442' e. of Bismark St. ss. in Bismark Meadows
Assessor's Plot 134 Lot 514, to the sewer and/or storm drain in 3" force main in Bismark Meadows Street R

To be laid in accordance with the conditions in this application and the City of New Bedford ordinances.

TYPE OF USE: RESIDENTIAL COMMERCIAL INDUSTRIAL FLOW 330 G.P.D.

If applicant other than actual property owner, attach Letter of Authorization from Property Owner.

Name..... Tel.....

Mailing Address.....

The Bonded Contractor/Drain Layer authorized to perform this work is:

W.C. Smith S.B. Ridgewood Rd. N.B. 508.995/449

Name Address Tel.

Type of Pipe Required: P.V.C. S.D.R. 40

PERMIT EXPIRES ONE YEAR AFTER DATE OF ISSUE

- Requires separate connections for sewage and storm drain where applicable. Storm water cannot be discharged to a sanitary sewer.
 - All work must be inspected and approved by a D.P.I. inspector before backfilling.
 - If this connection is to be part of a private service shared jointly with other building owners, attach copy of Recorded Joint Maintenance Agreement.
 - Permits can be issued to Industrial and/or Commercial Applicants only upon receipt and approval by the Commissioner of Public Infrastructure of required plans and supplemental information.
 - In addition, a City-issued Industrial User Discharge Permit and/or a Sewer Extension/Connection Permit issued by the Commonwealth of Massachusetts D.E.P. shall be required by the City for Industrial Discharge into the sewer system.
- Industrial User Discharge Permit No..... Date.....

Comm. Mass. Sewer Conn./Ext. Permit No..... Date.....

A Filing and Inspection Fee of \$450.00 plus an Entrance Fee of \$..... where applicable, must accompany this application.

Bank# Bank 5 Check# 1035 Date 1/5/09 Receipt# 8178

Other requirements: 24 hr. inspection notice at

508.995/527

Connection made to Sewer Part of jointly-shared private line YES NO
Storm Drain

Applicant agrees to abide by the above terms, as well as all pertinent ordinances of the City of New Bedford, and such other special rules as the Commissioner of Public Infrastructure and/or City Engineer may deem necessary

Quarta M. Andrade Acting City Engineer mn

Signature of Property Owner or Representative

INSPECTOR'S REPORT

INSPECTED BY: [Signature]
DATE: 2/10/09
COMMENTS:

APPROVED

DISAPPROVED

SIGNATURE

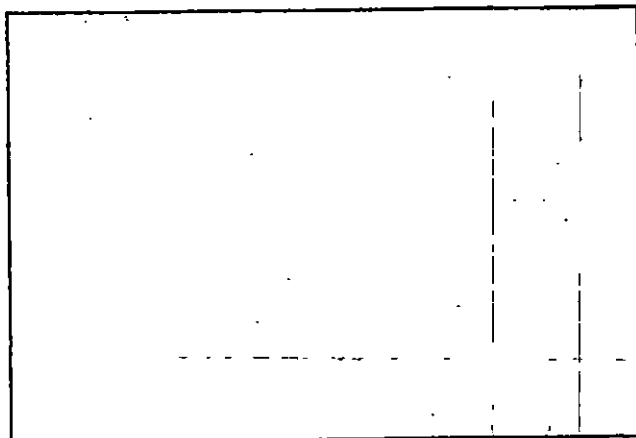

SKETCH PLAN



1048

NO. 191508 CITY OF NEW BEDFORD

LICENSE NO. _____

DATE 10/23 2008

FOUNDATION PERMIT

MSBC Sect. 111.8 – Any permit issued shall be deemed abandoned and invalid unless the work authorized by it shall have been commenced within six (6) months after its issuance.

This certifies that Ken Steen, owner/contractor
has permission to install foundation 28x28
on Barnard Meadows Rd. P. 136, Lot 514

providing that the person accepting this permit shall in every respect conform to the terms of the application therefor on file in this office; to the provisions of the Statute of the Commonwealth and to the By-Laws of the City of New Bedford relating to the Inspection, Erection, Enlarging, Altering, Raising, Moving, Repairing or Tearing Down of a Building.

WIRING INSPECTOR

PLUMBING INSPECTOR

BUILDING INSPECTOR

ROUGH FINISH

– Tel. 979-1540 Between 8:00 AM – 9:00 AM

YOUR AREA INSPECTOR IS: _____

OCCUPANCY PERMIT REQUIRED BEFORE OCCUPANCY

No Building or Structure shall be used or occupied until the Certificate of Use and Occupancy shall have been issued by the Building Commissioner – MSBC. Sect. 120.1 – N.B. Zoning Ord. Sect. 9-269

NOTICE: NOTIFY INSPECTOR 48 HOURS
IN ADVANCE OF APPLYING
SHEATING OR LATHING

THIS CARD MUST BE DISPLAYED IN A CONSPICUOUS PLACE ON THE PREMISES
AND NOT TORN DOWN OR REMOVED UNTIL COMPLETION OF WORK

SUBJECT TO MASSACHUSETTS STATE
BUILDING CODE REQUIREMENTS

[Signature]
BUILDING INSPECTOR

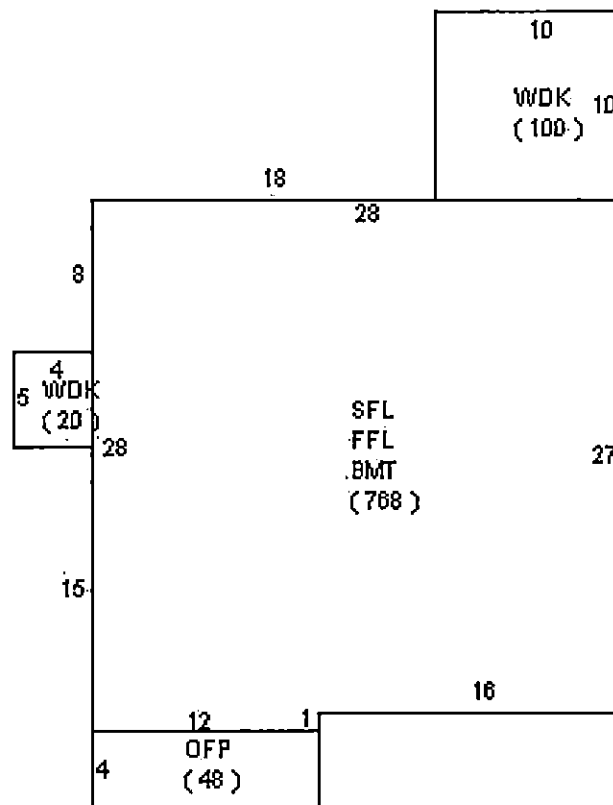

6/10/09

