



PERMIT NO.

24092

CITY OF NEW BEDFORD
SEWER AND/OR STORM DRAIN PERMIT

DATE 11/20/08

This certifies that permission is granted to

Brian Duoras 28 Dakhale Ave Marion MA 508 889 5713
Property Owner Address Tel.To connect a sewer and/or storm drain located at stub at property line
Assessor's Plot 123 B Lot 577, to the sewer and/or storm drain in White Lock Mt Pleasant Street

To be laid in accordance with the conditions in this application and the City of New Bedford ordinances.

TYPE OF USE: ☒ RESIDENTIAL ☐ COMMERCIAL ☐ INDUSTRIAL FLOW 330 G.P.D.

If applicant other than actual property owner, attach Letter of Authorization from Property Owner.

Name..... Tel.....

Mailing Address.....

The Bonded Contractor/Drain Layer authorized to perform this work is:

Dennis Trucking 301 County St NB 508 996 9213
Name Address Tel.

Type of Pipe Required: SDR 35 PVC

PERMIT EXPIRES ONE YEAR AFTER DATE OF ISSUE

- Requires separate connections for sewage and storm drain where applicable. Storm water cannot be discharged to a sanitary sewer.
- All work must be inspected and approved by a D.P.I. inspector before backfilling.
- If this connection is to be part of a private service shared jointly with other building owners, attach copy of Recorded Joint Maintenance Agreement.
- Permits can be issued to Industrial and/or Commercial Applicants only upon receipt and approval by the Commissioner of Public Infrastructure of required plans and supplemental information.
- In addition, a City-issued Industrial User Discharge Permit and/or a Sewer Extension/Connection Permit issued by the Commonwealth of Massachusetts D.E.P. shall be required by the City for Industrial Discharge into the sewer system.

Industrial User Discharge Permit No..... Date.....

Comm. Mass. Sewer Conn./Ext. Permit No..... Date.....

A Filing and Inspection Fee of \$150, plus an Entrance Fee of \$28.20 where applicable, must accompany this application.

Bank# St. Anne's Church Check# 146 Date 11/20/08 Receipt# 8140

Other requirements: inspection notice at 508-979-1527

Connection made to Sewer Part of jointly-shared private line YES NO
Storm Drain dry wells

Applicant agrees to abide by the above terms, as well as all pertinent ordinances of the City of New Bedford, and such other special rules as the Commissioner of Public Infrastructure and/or City Engineer may deem necessary

Robert M. Androski
Acting City Engineer

Signature of Property Owner or Representative

INSPECTOR'S REPORT

INSPECTED BY: [Signature]
DATE: 11/13/09
COMMENTS:

APPROVED

DISAPPROVED

SIGNATURE

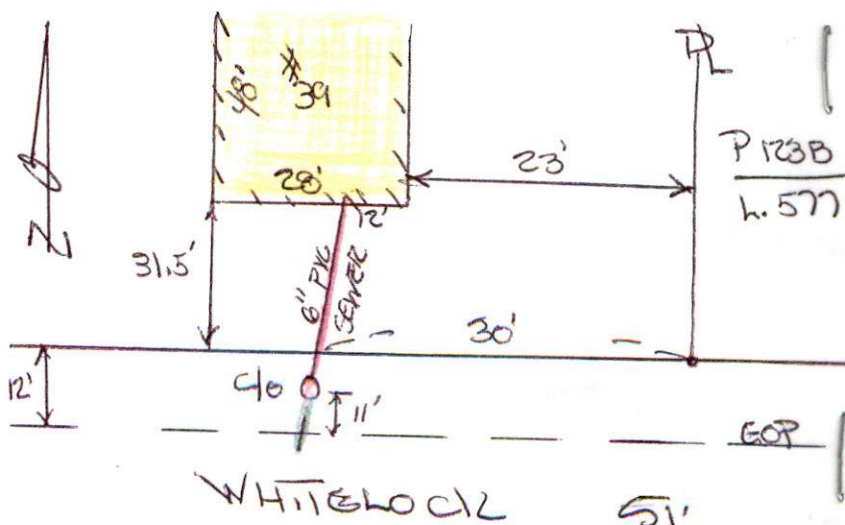



Inspector's Copy

PERMIT NO.
24092

CITY OF NEW BEDFORD
SEWER AND/OR STORM DRAIN PERMIT

DATE 11/20/08

This certifies that permission is granted to

Brian Dupras 28 Oakdale Ave Marion MA 508.889.5713
Property Owner Address Tel.

To connect a sewer and/or storm drain located at st.b. at property line
Assessor's Plot 123.B Lot 5.7.7., to the sewer and/or storm drain in #39 Whitelock 410' w x Mt. Pleasant Street

To be laid in accordance with the conditions in this application and the City of New Bedford ordinances.

TYPE OF USE: ☒ RESIDENTIAL ☐ COMMERCIAL ☐ INDUSTRIAL FLOW 330 G.P.D.

If applicant other than actual property owner, attach Letter of Authorization from Property Owner.

Name..... Tel.....

Mailing Address.....

The Bonded Contractor/Drain Layer authorized to perform this work is:

Dennis Trucking 301 County St. N.B. 508.996.9213
Name Address Tel.

Type of Pipe Required: S.D.R. 35 P.V.C.

PERMIT EXPIRES ONE YEAR AFTER DATE OF ISSUE

- Requires separate connections for sewage and storm drain where applicable. Storm water cannot be discharged to a sanitary sewer.
- All work must be inspected and approved by a D.P.I. inspector before backfilling.
- If this connection is to be part of a private service shared jointly with other building owners, attach copy of Recorded Joint Maintenance Agreement.
- Permits can be issued to Industrial and/or Commercial Applicants only upon receipt and approval by the Commissioner of Public Infrastructure of required plans and supplemental information.
- In addition, a City-issued Industrial User Discharge Permit and/or a Sewer Extension/Connection Permit issued by the Commonwealth of Massachusetts D.E.P. shall be required by the City for Industrial Discharge into the sewer system.

Industrial User Discharge Permit No..... Date.....

Comm. Mass. Sewer Conn./Ext. Permit No..... Date.....

A Filing and Inspection Fee of \$450.00, plus an Entrance Fee of \$28.20 where applicable, must accompany this application.

Bank# St. Anne's Credit Union Check# 146 Date 11/20/08 Receipt# 8140

Other requirements: 24 hr. inspection notice at 508.997.91527

Connection made to Sewer Part of jointly-shared private line YES NO
Storm Drain dry wells

Applicant agrees to abide by the above terms, as well as all pertinent ordinances of the City of New Bedford, and such other special rules as the Commissioner of Public Infrastructure and/or City Engineer may deem necessary

Duarte M. Andrade
Acting City Engineer

Signature of Property Owner or Representative

INSPECTOR'S REPORT

INSPECTED BY: [Signature]
DATE: 11/13/09
COMMENTS:

APPROVED [Signature] DISAPPROVED

SIGNATURE

Rec'd 3116/09.

Tues. 11/13/09 1p.m.
Sewer inspection.

SKETCH PLAN



CITY OF NEW BEDFORD

NO. 189808

LICENSE NO. _____

DATE 10/23 2008

FOUNDATION PERMIT

MSBC Sect. 111.8 – Any permit issued shall be deemed abandoned and invalid unless the work authorized by it shall have been commenced within six (6) months after its issuance.

This certifies that Brian Dupras, owner/contractor
has permission to install foundation
on Whitcomb St Plot 123 B, Lot 577

providing that the person accepting this permit shall in every respect conform to the terms of the application therefor on file in this office; to the provisions of the Statute of the Commonwealth and to the By-Laws of the City of New Bedford relating to the Inspection, Erection, Enlarging, Altering, Raising, Moving, Repairing or Tearing Down of a Building.

WIRING INSPECTOR

PLUMBING INSPECTOR

BUILDING INSPECTOR

ROUGH FINISH

YOUR AREA INSPECTOR IS: _____

- Tel. 979-1540 Between 8:00 AM – 9:00 AM

NOTICE: NOTIFY INSPECTOR 48 HOURS
IN ADVANCE OF APPLYING
SHEATING OR LATHING

OCCUPANCY PERMIT REQUIRED BEFORE OCCUPANCY
No Building or Structure shall be used or occupied until the Certificate of Use and Occupancy shall have been issued by the Building Commissioner – MSBC. Sect. 120.1 – N.B. Zoning Ord. Sect. 9-269

THIS CARD MUST BE DISPLAYED IN A CONSPICUOUS PLACE ON THE PREMISES
AND NOT TORN DOWN OR REMOVED UNTIL COMPLETION OF WORK

SUBJECT TO MASSACHUSETTS STATE
BUILDING CODE REQUIREMENTS

[Signature]
BUILDING INSPECTOR

103107

MASSACHUSETTS QUITCLAIM DEED

I, **Cynthia Marie Goulart** of 118 South Street, New Bedford, Massachusetts

for consideration paid and in full consideration of Seventy-Five Thousand and 00/100 (\$75,000.00) Dollars

grant to **Brian Dupras and Jennifer Dupras**, as Joint Tenants of 28 Oakdale Avenue, Marion, Massachusetts

with *quitclaim covenants*

the land in said New Bedford, Bristol County, Massachusetts, with the buildings thereon, bounded and described as follows:

See Attached Exhibit A – Property Description

Witness my hand and seal this 2nd day of September, 2008.

Cynthia Marie Goulart
Cynthia Marie Goulart

REG OF DEEDS
REG #07
BRISTOL S

09/02/08 1:35PM 01
000000 #4326

FEE \$342.00

CASH \$342.00

VACANT LAND

Lor 6 Whirelock Street
New Bedford, MA 02740

103107

Exhibit A - Property Description

Property Address: **Land on Whitelock/Garcia Street, New Bedford, Massachusetts**

the land situated in New Bedford, in the County of Bristol and Commonwealth of Massachusetts, bounded and described as follows:

SOUTHEASTERLY by **the northwesterly line of Whitelock Street, eighty (80) feet;**

SOUTHWESTERLY by **land now or formerly of Manuel A. Sardinha, et al., one hundred sixty (160) feet;**

NORTHWESTERLY by **the southeasterly line of Garcia Street, eighty (80) feet; and**

NORTHEASTERLY by **land now or formerly of Wiktorja Hrytzay and by Lot 5 on plan hereinafter mentioned, one hundred sixty (160) feet.**

Said land is shown as lot 6 on subdivision plan 24721C, drawn by Jack Turner, Surveyor, dated September 27, 1955, filed in the Land Registration Office at Boston, a copy of which is filed in Bristol County (S.D.) Registry of Deeds, in Land Registration Book 31, Page 107, with Certificate of Title No. 6163.

Being the same premises conveyed to this grator by deed registered with the Bristol County S.D. Registry of Deeds, Land Registration Division, as Certificate of Title No. 19518.

is & Michaud, LLC
neys at Law
William Street
Bedford, MA 02740

103107

COMMONWEALTH OF MASSACHUSETTS

Bristol County, ss.

On this 2nd day of September, 2008, before me, the undersigned notary public, personally appeared Cynthia Marie Goulart, proved to me through satisfactory evidence of identification, which were Massachusetts driver's licenses, to be the persons whose names are signed on the preceding or attached document, and acknowledged to me that they signed it voluntarily for its stated purposes.



[Signature]
Notary Public: Joseph L. Michaud
My Commission Expires: 12/19/2014

Date November 20, 2008

This is a true copy of an instrument
registered in the Bristol County (S.D.)
Registry of Deeds Land Court Dept. as

Document No. 103107 On September 2, 2008Attest *[Signature]* Asst. Recorder *(B)*

n.B. of 19518, Whitechapel (n.w.) Harvia (e.e.)
 Lot 6 pl 24721C

ATTY Michael
 172 William St
 N. B. Me 02740

4

103107
 So. Bristol Land Court
 09/02/08 01:35
 Meted on Ctf. 21895
 Book 124 Page 116
 Read on Ctf 19518 12.108 P. 39

#39

WHITELOCK ST.

1/13/09

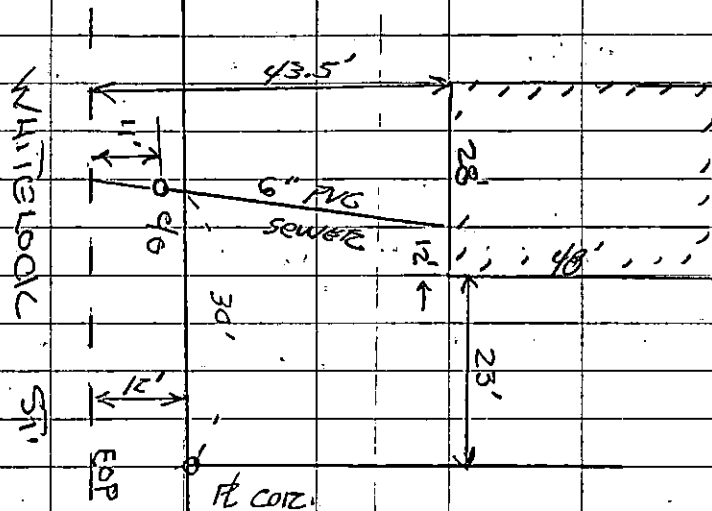
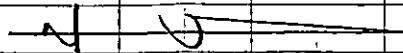
NEW DWELLING
SEWER TIE-IN

INSR: BOB BICKEL

SEWER PERMIT #24092

PROP. OWNER/BUILDER
TIED IN SEWER
UNDER DENNIS TRUCKING BOND

OWNER: BRIAN DURAN

PLOT 120 B LOT 577