



PERMIT NO.

CITY OF NEW BEDFORD
SEWER AND/OR STORM DRAIN PERMIT

DATE 5-28-08

24055

This certifies that permission is granted to

S+T Home Builders P.O. Box 80038 Dartmouth, MA 02748
Property Owner Address Tel. 774-930-1024

To connect a sewer and/or storm drain located at 2 Aranea Circle

Assessor's Plot 121 Lot 180, to the sewer and/or storm drain in Aranea Circle Street

12" Storm Drain 8" Sewer

To be laid in accordance with the conditions in this application and the City of New Bedford ordinances.

TYPE OF USE: RESIDENTIAL COMMERCIAL INDUSTRIAL FLOW 330 G.P.D.

If applicant other than actual property owner, attach Letter of Authorization from Property Owner.

Name Tel.

Mailing Address

The Bonded Contractor/Drain Layer authorized to perform this work is:

Pico Construction 135 Bryant Lane New Bedford

Name Address Tel. 508-509-0972

Type of Pipe Required: SDR 35 PVC

PERMIT EXPIRES ONE YEAR AFTER DATE OF ISSUE

- Requires separate connections for sewage and storm drain where applicable. Storm water cannot be discharged to a sanitary sewer.
 - All work must be inspected and approved by a D.P.I. inspector before backfilling.
 - If this connection is to be part of a private service shared jointly with other building owners, attach copy of Recorded Joint Maintenance Agreement.
 - Permits can be issued to Industrial and/or Commercial Applicants only upon receipt and approval by the Commissioner of Public Infrastructure of required plans and supplemental information.
 - In addition, a City-issued Industrial User Discharge Permit and/or a Sewer Extension/Connection Permit issued by the Commonwealth of Massachusetts D.E.P. shall be required by the City for Industrial Discharge into the sewer system.
- Industrial User Discharge Permit No. Date

Comm. Mass. Sewer Conn./Ext. Permit No. Date

A Filing and Inspection Fee of \$ 450, plus an Entrance Fee of \$ where applicable, must accompany this application.

Bank# Bank Five Check# 1477 Date 5-28-08 Receipt# 7861

Other requirements: 24 hour inspection notice @ 508-999-1527

Connection made to Sewer Part of jointly-shared private line YES ☒ NO
Storm Drain

Applicant agrees to abide by the above terms, as well as all pertinent ordinances of the City of New Bedford, and such other special rules as the Commissioner of Public Infrastructure and/or City Engineer may deem necessary

Quade M. Andrade
City Engineer

[Signature]
Signature of Property Owner or Representative

INSPECTOR'S REPORT

INSPECTED BY: Bob Bickel
DATE: 5/30/08
COMMENTS:

☒ APPROVED ☐ DISAPPROVED

See attached white copy of
SIGNATURE

inspectors report for
Signature.

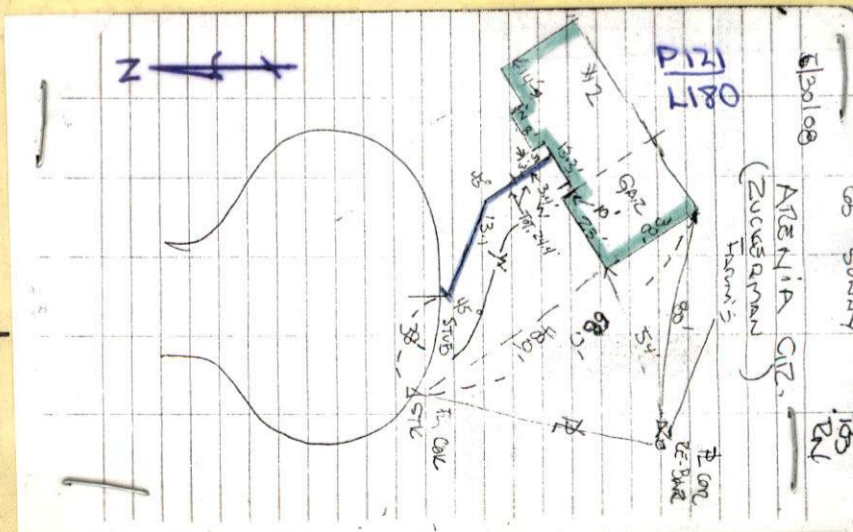



PERMIT NO.

24055

CITY OF NEW BEDFORD
SEWER AND/OR STORM DRAIN PERMIT

DATE 5-28-08

This certifies that permission is granted to

J+T Home Builders.....P.O. Box 80038 Dartmouth, MA 02748
Property Owner Address Tel. 774-930-1024

To connect a sewer and/or storm drain located at.....2 Aranea Circle.....

Assessor's Plot 121.....Lot 180....., to the sewer and/or storm drain in.....Aranea Circle.....Street
12" Storm Drain 8" Sewer

To be laid in accordance with the conditions in this application and the City of New Bedford ordinances.

TYPE OF USE: RESIDENTIAL COMMERCIAL INDUSTRIAL FLOW 330 G.P.D.

If applicant other than actual property owner, attach Letter of Authorization from Property Owner.

Name.....Tel.....

Mailing Address.....

The Bonded Contractor/Drain Layer authorized to perform this work is:

P.I.C.O. Construction.....135 Bryant Lane New Bedford

Name Address Tel. 508-509-0972

Type of Pipe Required:.....S.D.R. 35 PVC.....

PERMIT EXPIRES ONE YEAR AFTER DATE OF ISSUE

- Requires separate connections for sewage and storm drain where applicable. Storm water cannot be discharged to a sanitary sewer.
 - All work must be inspected and approved by a D.P.I. inspector before backfilling.
 - If this connection is to be part of a private service shared jointly with other building owners, attach copy of Recorded Joint Maintenance Agreement.
 - Permits can be issued to Industrial and/or Commercial Applicants only upon receipt and approval by the Commissioner of Public Infrastructure of required plans and supplemental information.
 - In addition, a City-issued Industrial User Discharge Permit and/or a Sewer Extension/Connection Permit issued by the Commonwealth of Massachusetts D.E.P. shall be required by the City for Industrial Discharge into the sewer system.
- Industrial User Discharge Permit No.....Date.....

Comm. Mass. Sewer Conn./Ext. Permit No.....Date.....

A Filing and Inspection Fee of \$.450, plus an Entrance Fee of \$..... where applicable, must accompany this application.

Bank# Bank Five Check# 1477 Date 5-28-08 Receipt# 7861

Other requirements: 24 hour inspection notice @ 508-999-1527.....

Connection made to Sewer Part of jointly-shared private line YES ☒ NO
Storm Drain

Applicant agrees to abide by the above terms, as well as all pertinent ordinances of the City of New Bedford, and such other special rules as the Commissioner of Public Infrastructure and/or City Engineer may deem necessary

Quate M. Andrade.....
City Engineer

[Signature].....
Signature of Property Owner or Representative

INSPECTOR'S REPORT

INSPECTED BY:.....

DATE:.....

COMMENTS:.....

APPROVED

DISAPPROVED

SIGNATURE

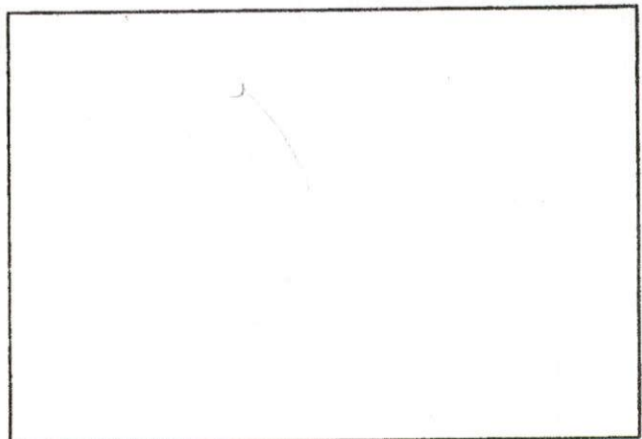

SKETCH PLAN



PERMIT NO.

CITY OF NEW BEDFORD
SEWER AND/OR STORM DRAIN PERMIT

DATE 5-28-08

24055

This certifies that permission is granted to

S+T Home Builders P.O. Box 80038 Dartmouth, MA 02748
Property Owner Address Tel. 774-930-1024

To connect a sewer and/or storm drain located at 2 Aranea Circle

Assessor's Plot 121 Lot 180, to the sewer and/or storm drain in Aranea Circle Street
15" Storm Drain 8" Sewer

To be laid in accordance with the conditions in this application and the City of New Bedford ordinances.

TYPE OF USE: RESIDENTIAL COMMERCIAL INDUSTRIAL FLOW 330 G.P.D.

If applicant other than actual property owner, attach Letter of Authorization from Property Owner.

Name..... Tel.....
Mailing Address.....

The Bonded Contractor/Drain Layer authorized to perform this work is:

Pico Construction 135 Bryant Lane New Bedford
Name Address Tel. 508-509-0972
Type of Pipe Required: S.D.R. 35 PVC

PERMIT EXPIRES ONE YEAR AFTER DATE OF ISSUE

- Requires separate connections for sewage and storm drain where applicable. Storm water cannot be discharged to a sanitary sewer.
 - All work must be inspected and approved by a D.P.I. inspector before backfilling.
 - If this connection is to be part of a private service shared jointly with other building owners, attach copy of Recorded Joint Maintenance Agreement.
 - Permits can be issued to Industrial and/or Commercial Applicants only upon receipt and approval by the Commissioner of Public Infrastructure of required plans and supplemental information.
 - In addition, a City-issued Industrial User Discharge Permit and/or a Sewer Extension/Connection Permit issued by the Commonwealth of Massachusetts D.E.P. shall be required by the City for Industrial Discharge into the sewer system.
- Industrial User Discharge Permit No..... Date.....

Comm. Mass. Sewer Conn./Ext. Permit No..... Date.....

A Filing and Inspection Fee of \$.450, plus an Entrance Fee of \$..... where applicable, must accompany this application.

Bank# Bank Five Check# 1477 Date 5-28-08 Receipt# 7861

Other requirements: 24 hour inspection notice @ 508-979-1527

Connection made to Sewer Part of jointly-shared private line YES ☒ NO
Storm Drain

Applicant agrees to abide by the above terms, as well as all pertinent ordinances of the City of New Bedford, and such other special rules as the Commissioner of Public Infrastructure and/or City Engineer may deem necessary

Quate M. Andrade
City Engineer

[Signature]
Signature of Property Owner or Representative

INSPECTOR'S REPORT

INSPECTED BY: [Signature]
DATE: 5/30/08
COMMENTS:

APPROVED

DISAPPROVED

SIGNATURE

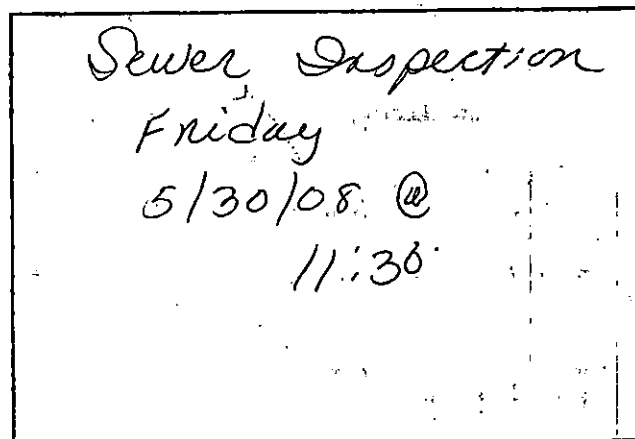

SKETCH PLAN

Rec'd 7/3/08



CITY OF NEW BEDFORD

1013

NO. 34 08

LICENSE NO. _____

DATE 1/11 2008

FOUNDATION PERMIT

MSBC Sect. 111.8 – Any permit issued shall be deemed abandoned and invalid unless the work authorized by it shall have been commenced within six (6) months after its issuance.

This certifies that J & T Home Builders, owner/contractor
has permission to Install Foundation
on # 2 Manuel Circle LOT 180

providing that the person accepting this permit shall in every respect conform to the terms of the application therefor on file in this office; to the provisions of the Statute of the Commonwealth and to the By-Laws of the City of New Bedford relating to the Inspection, Erection, Enlarging, Altering, Raising, Moving, Repairing or Tearing Down of a Building.

WIRING INSPECTOR

PLUMBING INSPECTOR

BUILDING INSPECTOR

ROUGH FINISH

YOUR AREA INSPECTOR IS:

TOM WELCH

- Tel. 979-1540 Between 8:00 AM – 9:00 AM

NOTICE: NOTIFY INSPECTOR 48 HOURS
IN ADVANCE OF APPLYING
SHEATING OR LATHING

OCCUPANCY PERMIT REQUIRED BEFORE OCCUPANCY

No Building or Structure shall be used or occupied until the Certificate of Use and Occupancy shall have been issued by the Building Commissioner – MSBC. Sect. 120.1 – N.B. Zoning Ord. Sect. 9-269

THIS CARD MUST BE DISPLAYED IN A CONSPICUOUS PLACE ON THE PREMISES
AND NOT TORN DOWN OR REMOVED UNTIL COMPLETION OF WORK

SUBJECT TO MASSACHUSETTS STATE
BUILDING CODE REQUIREMENTS

BUILDING INSPECTOR

1259

163

100

Argentina (Zucerman)

(20030302)

5354

