





PERMIT NO.

24052

CITY OF NEW BEDFORD  
SEWER AND/OR STORM DRAIN PERMIT

DATE 5/19/08

This certifies that permission is granted to

Bristol Pacific Homes 291 Middle St. Fall River Ma.  
Property Owner Address Tel. 508-509 9678

To connect a sewer and/or storm drain located at 155 Apple Tree Lane

Assessor's Plot 120 Lot 172, to the sewer and/or storm drain in Apple Tree Lane Street

To be laid in accordance with the conditions in this application and the City of New Bedford ordinances.

TYPE OF USE: ☒ RESIDENTIAL ☐ COMMERCIAL ☐ INDUSTRIAL FLOW 330 G.P.D.

If applicant other than actual property owner, attach Letter of Authorization from Property Owner.

Name \_\_\_\_\_ Tel. \_\_\_\_\_

Mailing Address \_\_\_\_\_

The Bonded Contractor/Drain Layer authorized to perform this work is:

J.B. Taragan Co Inc 21 East River Dr. Dartmouth Ma.  
Name Address Tel. \_\_\_\_\_

Type of Pipe Required: sdr 35 pvc

PERMIT EXPIRES ONE YEAR AFTER DATE OF ISSUE

- Requires separate connections for sewage and storm drain where applicable. Storm water cannot be discharged to a sanitary sewer.
- All work must be inspected and approved by a D.P.I. inspector before backfilling.
- If this connection is to be part of a private service shared jointly with other building owners, attach copy of Recorded Joint Maintenance Agreement.
- Permits can be issued to Industrial and/or Commercial Applicants only upon receipt and approval by the Commissioner of Public Infrastructure of required plans and supplemental information.
- In addition, a City-issued Industrial User Discharge Permit and/or a Sewer Extension/Connection Permit issued by the Commonwealth of Massachusetts D.E.P. shall be required by the City for Industrial Discharge into the sewer system.

Industrial User Discharge Permit No. \_\_\_\_\_ Date \_\_\_\_\_

Comm. Mass. Sewer Conn./Ext. Permit No. \_\_\_\_\_ Date \_\_\_\_\_

A Filing and Inspection Fee of \$450.00, plus an Entrance Fee of \$7 where applicable, must accompany this application.

Bank# Bank Five Check# 14261 Date 5/19/08 Receipt# 7848

Other requirements: 24 hr. inspection at 508-979-1527

Connection made to Sewer Part of jointly-shared private line YES NO  
Storm Drain

Applicant agrees to abide by the above terms, as well as all pertinent ordinances of the City of New Bedford, and such other special rules as the Commissioner of Public Infrastructure and/or City Engineer may deem necessary

Quarte M. Andrade  
Acting City Engineer

[Signature]  
Signature of Property Owner or Representative

INSPECTOR'S REPORT

INSPECTED BY: \_\_\_\_\_

DATE: \_\_\_\_\_

COMMENTS: \_\_\_\_\_

\_\_\_\_\_

\_\_\_\_\_

APPROVED \_\_\_\_\_ DISAPPROVED \_\_\_\_\_

SIGNATURE

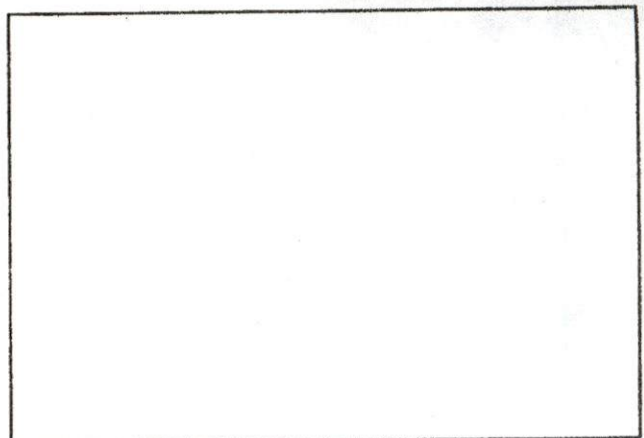

SKETCH PLAN



# CITY OF NEW BEDFORD

1022

NO. 210 08

LICENSE NO. \_\_\_\_\_

DATE 4/9 2008

## FOUNDATION PERMIT

MSBC Sect. 111.8 - Any permit issued shall be deemed abandoned and invalid unless the work authorized by it shall have been commenced within six (6) months after its issuance.

This certifies that Bristol Pacific Homes, owner/contractor  
has permission to install foundation 42x44  
on 155 Apple Tree Lane Lot 172

providing that the person accepting this permit shall in every respect conform to the terms of the application therefor on file in this office; to the provisions of the Statute of the Commonwealth and to the By-Laws of the City of New Bedford relating to the Inspection, Erection, Enlarging, Altering, Raising, Moving, Repairing or Tearing Down of a Building.

WIRING INSPECTOR

PLUMBING INSPECTOR

BUILDING INSPECTOR

\_\_\_\_\_  
\_\_\_\_\_  
\_\_\_\_\_

\_\_\_\_\_  
\_\_\_\_\_  
\_\_\_\_\_

\_\_\_\_\_  
\_\_\_\_\_  
\_\_\_\_\_

ROUGH FINISH

YOUR AREA INSPECTOR IS: Thomas Welch

Tel. 979-1540 Between 8:00 AM - 9:00 AM

NOTICE: NOTIFY INSPECTOR (48) HOURS  
IN ADVANCE OF APPLYING  
SHEATING OR LATHING

### OCCUPANCY PERMIT REQUIRED BEFORE OCCUPANCY

No Building or Structure shall be used or occupied until the Certificate of Use and Occupancy shall have been issued by the Building Commissioner - MSBC. Sect. 120.1 - N.B. Zoning Ord. Sect. 9-269

THIS CARD MUST BE DISPLAYED IN A CONSPICUOUS PLACE ON THE PREMISES  
AND NOT TORN DOWN OR REMOVED UNTIL COMPLETION OF WORK

SUBJECT TO MASSACHUSETTS STATE  
BUILDING CODE REQUIREMENTS

[Signature]  
BUILDING INSPECTOR

13

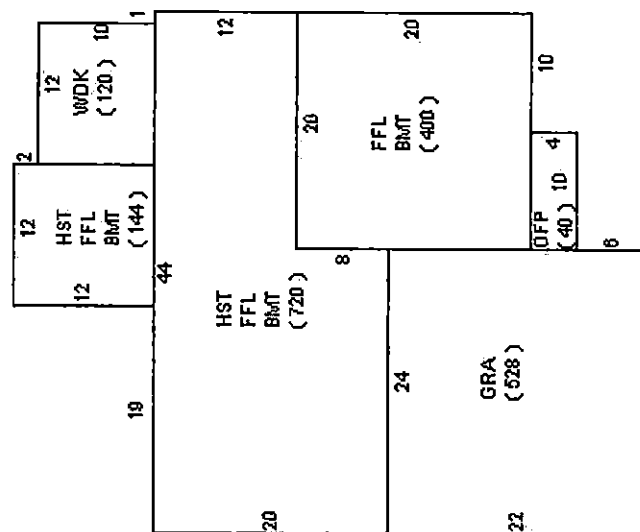

10' -





Inspector's Copy

PERMIT NO.

24052

CITY OF NEW BEDFORD  
SEWER AND/OR STORM DRAIN PERMIT

DATE 5/19/08

This certifies that permission is granted to

Bristol Pacific Homes 291 Middle St. Fall River Ma.  
Property Owner Address Tel. 508-509 9678

To connect a sewer and/or storm drain located at... 155 Apple Tree Lane.....

Assessor's Plot 120.....Lot 172....., to the sewer and/or storm drain in..... Apple Tree Lane..... Street

To be laid in accordance with the conditions in this application and the City of New Bedford ordinances.

TYPE OF USE: ☒ RESIDENTIAL ☐ COMMERCIAL ☐ INDUSTRIAL FLOW 330 G.P.D.

If applicant other than actual property owner, attach Letter of Authorization from Property Owner.

Name.....Tel.....

Mailing Address.....

The Bonded Contractor/Drain Layer authorized to perform this work is:

J.B. Saragan Co. Inc. 21 East River Dr. Dartmouth Ma.  
Name Address Tel.

Type of Pipe Required:..... sdn 3.5 pvc.....

PERMIT EXPIRES ONE YEAR AFTER DATE OF ISSUE

- Requires separate connections for sewage and storm drain where applicable. Storm water cannot be discharged to a sanitary sewer.
  - All work must be inspected and approved by a D.P.I. inspector before backfilling.
  - If this connection is to be part of a private service shared jointly with other building owners, attach copy of Recorded Joint Maintenance Agreement.
  - Permits can be issued to Industrial and/or Commercial Applicants only upon receipt and approval by the Commissioner of Public Infrastructure of required plans and supplemental information.
  - In addition, a City-issued Industrial User Discharge Permit and/or a Sewer Extension/Connection Permit issued by the Commonwealth of Massachusetts D.E.P. shall be required by the City for Industrial Discharge into the sewer system.
- Industrial User Discharge Permit No.....Date.....

Comm. Mass. Sewer Conn./Ext. Permit No.....Date.....

A Filing and Inspection Fee of \$450.00, plus an Entrance Fee of \$..... where applicable, must accompany this application.

Bank# Bank Five Check# 14261 Date 5/19/08 Receipt# 7848

Other requirements:..... 24 hr. inspection at 508-979-1527.....

Connection made to Sewer Part of jointly-shared private line YES NO  
Storm Drain

Applicant agrees to abide by the above terms, as well as all pertinent ordinances of the City of New Bedford, and such other special rules as the Commissioner of Public Infrastructure and/or City Engineer may deem necessary

Quarte M. Andrade  
Acting City Engineer

[Signature]  
Signature of Property Owner or Representative

INSPECTOR'S REPORT

INSPECTED BY: [Signature]  
DATE: 5/20/08  
COMMENTS: \_\_\_\_\_

APPROVED

DISAPPROVED

[Signature]  
SIGNATURE

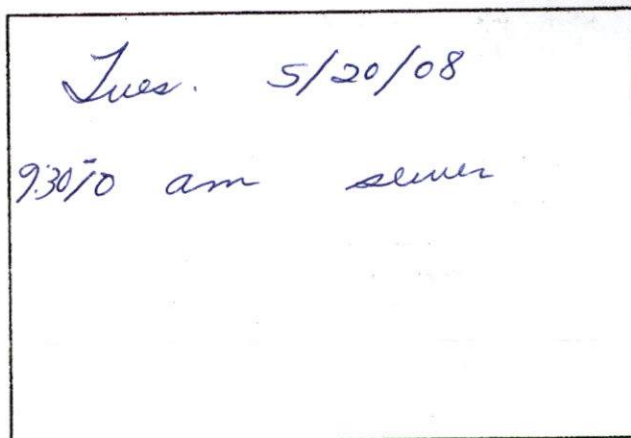

SKETCH PLAN

Rec'd 7/13/08



5/20/08

APPLE TREE LN.  
SEWER INSP.

RP

OK

HATHAWAY RD.

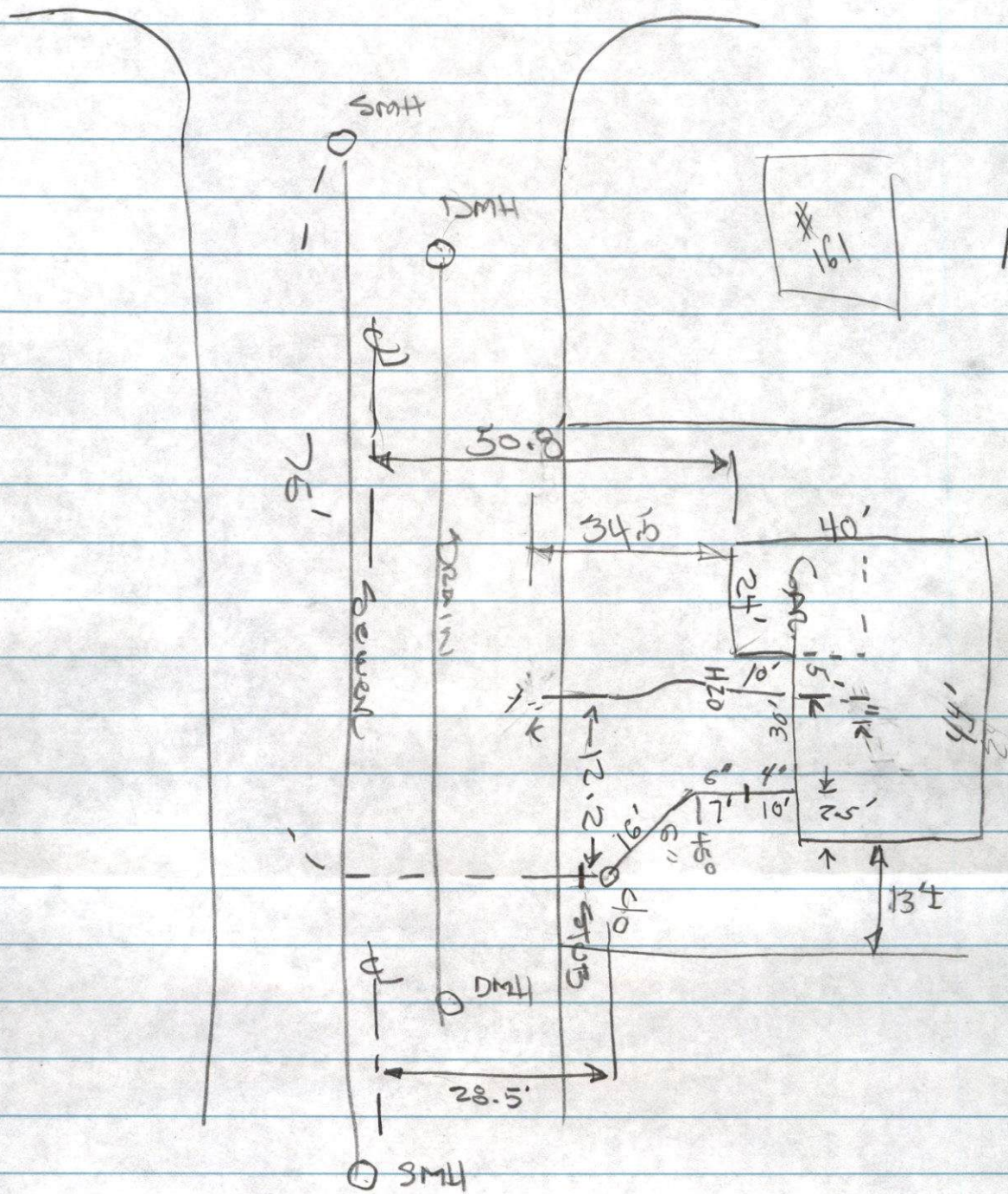



5/20/08

APPLE TREE LN.

(125)

HATHAWAY RD

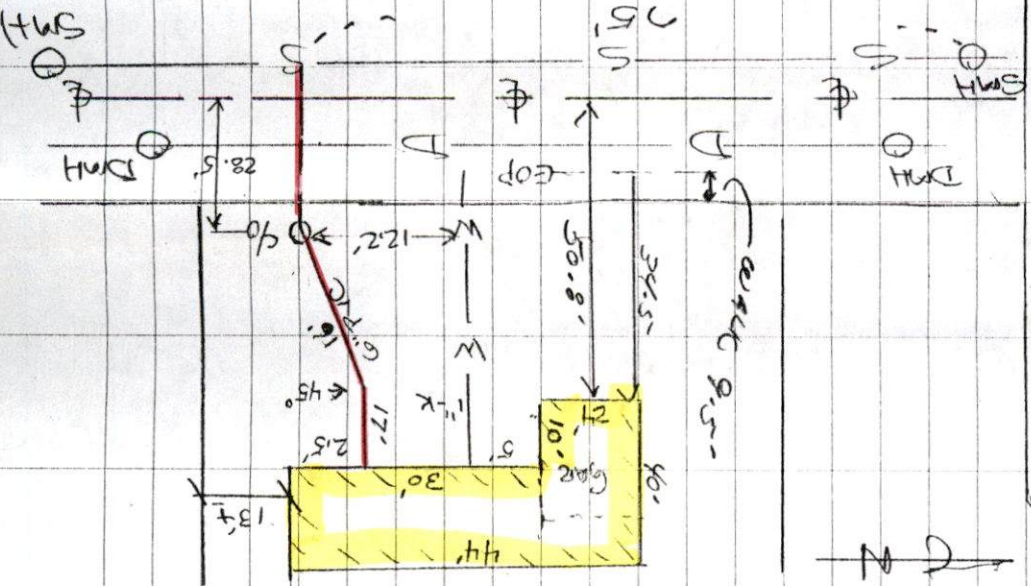

Permit # 24052

CONTRACTOR - LANAGAN

Plot 120 121 124

\*Submitted for  
Drafting 7/3/08