



PERMIT NO.

24031

CITY OF NEW BEDFORD
SEWER AND/OR STORM DRAIN PERMIT

DATE 12/18/07

This certifies that permission is granted to

Property Owner Joe DeSousa Jr. Home Builders P.O. Box 80038 Dartmouth 02748
Address Tel.

To connect a sewer and/or storm drain located at 48 Charlotte St.

Assessor's Plot 121 Lot 16.5 to the sewer and/or storm drain in 8" sewer 24" storm drain Street

To be laid in accordance with the conditions in this application and the City of New Bedford ordinances.
TYPE OF USE: ☒ RESIDENTIAL ☐ COMMERCIAL ☐ INDUSTRIAL FLOW 330 G.P.D.

If applicant other than actual property owner, attach Letter of Authorization from Property Owner.

Name Tel.
Mailing Address

The Bonded Contractor/Drain Layer authorized to perform this work is:

Pucc Construction 135 Bryant N.B. 508-509-0972
Name Address Tel.
Type of Pipe Required: sdn 35 pvc

PERMIT EXPIRES ONE YEAR AFTER DATE OF ISSUE

- Requires separate connections for sewage and storm drain where applicable. Storm water cannot be discharged to a sanitary sewer.
 - All work must be inspected and approved by a D.P.I. inspector before backfilling.
 - If this connection is to be part of a private service shared jointly with other building owners, attach copy of Recorded Joint Maintenance Agreement.
 - Permits can be issued to Industrial and/or Commercial Applicants only upon receipt and approval by the Commissioner of Public Infrastructure of required plans and supplemental information.
 - In addition, a City-issued Industrial User Discharge Permit and/or a Sewer Extension/Connection Permit issued by the Commonwealth of Massachusetts D.E.P. shall be required by the City for Industrial Discharge into the sewer system.
- Industrial User Discharge Permit No. Date

Comm. Mass. Sewer Conn./Ext. Permit No. Date

A Filing and Inspection Fee of \$150.00, plus an Entrance Fee of \$ where applicable, must accompany this application.

Bank# Bank Five Check# 1247 Date 12/18/07 Receipt# 7627

Other requirements: 24 hr. inspection at 508-979-1527

Connection made to Sewer Part of jointly-shared private line YES NO
Storm Drain

Applicant agrees to abide by the above terms, as well as all pertinent ordinances of the City of New Bedford, and such other special rules as the Commissioner of Public Infrastructure and/or City Engineer may deem necessary

Duane M. Andradel
Acting City Engineer mn

Signature of Property Owner or Representative

INSPECTOR'S REPORT

INSPECTED BY: _____
DATE: _____
COMMENTS: _____

APPROVED DISAPPROVED

SIGNATURE

SEE WHITE SHEET

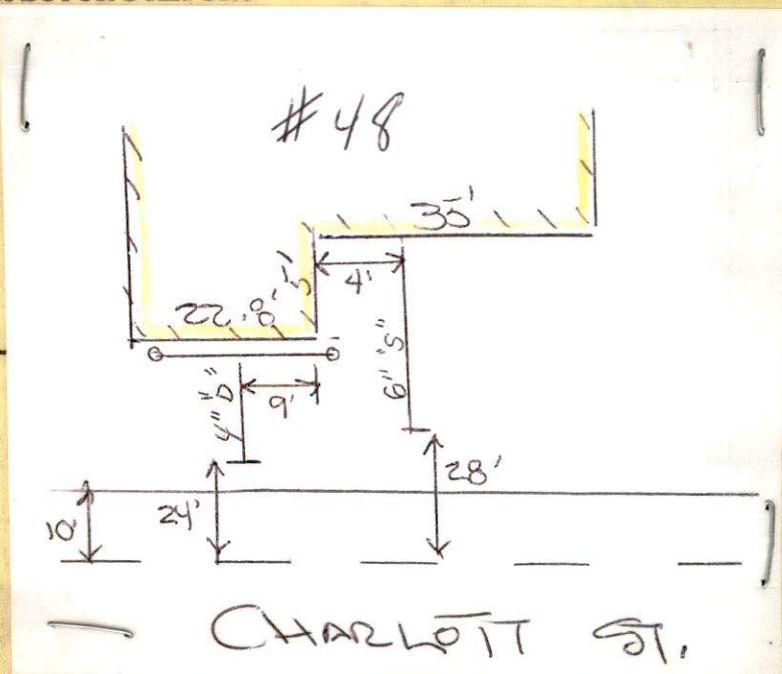



PERMIT NO.

24031

CITY OF NEW BEDFORD
SEWER AND/OR STORM DRAIN PERMIT

DATE 12/18/07

This certifies that permission is granted to

Jose DeSousa, Jr. I Home Builders PO Box 80038 Dartmouth 02748
Property Owner Address 48 Tel.

To connect a sewer and/or storm drain located at 64 Charlotte St.

Assessor's Plot 121 Lot 1658 to the sewer and/or storm drain in 8" sewer 24" storm drain Street

To be laid in accordance with the conditions in this application and the City of New Bedford ordinances.

TYPE OF USE: ☒ RESIDENTIAL ☐ COMMERCIAL ☐ INDUSTRIAL FLOW 330 G.P.D.

If applicant other than actual property owner, attach Letter of Authorization from Property Owner.

Name..... Tel.....

Mailing Address.....

The Bonded Contractor/Drain Layer authorized to perform this work is:

Pura Construction 135 Bryant St N B 508-509-0972
Name Address Tel.

Type of Pipe Required: sdv 35 pvc

PERMIT EXPIRES ONE YEAR AFTER DATE OF ISSUE

- Requires separate connections for sewage and storm drain where applicable. Storm water cannot be discharged to a sanitary sewer.
- All work must be inspected and approved by a D.P.I. inspector before backfilling.
- If this connection is to be part of a private service shared jointly with other building owners, attach copy of Recorded Joint Maintenance Agreement.
- Permits can be issued to Industrial and/or Commercial Applicants only upon receipt and approval by the Commissioner of Public Infrastructure of required plans and supplemental information.
- In addition, a City-issued Industrial User Discharge Permit and/or a Sewer Extension/Connection Permit issued by the Commonwealth of Massachusetts D.E.P. shall be required by the City for Industrial Discharge into the sewer system.

Industrial User Discharge Permit No..... Date.....

Comm. Mass. Sewer Conn./Ext. Permit No..... Date.....

A Filing and Inspection Fee of \$150.00 plus an Entrance Fee of \$..... where applicable, must accompany this application.

Bank# Bank Five Check# 1247 Date 12/18/07 Receipt# 7627

Other requirements: 24 hr inspection at 508-979-1527

Connection made to Sewer Part of jointly-shared private line YES NO
Storm Drain

Applicant agrees to abide by the above terms, as well as all pertinent ordinances of the City of New Bedford, and such other special rules as the Commissioner of Public Infrastructure and/or City Engineer may deem necessary

Quate M. Andrade
Acting City Engineer mn

[Signature]
Signature of Property Owner or Representative

INSPECTOR'S REPORT

INSPECTED BY: _____

DATE: _____

COMMENTS: _____

APPROVED

DISAPPROVED

[Signature]
SIGNATURE

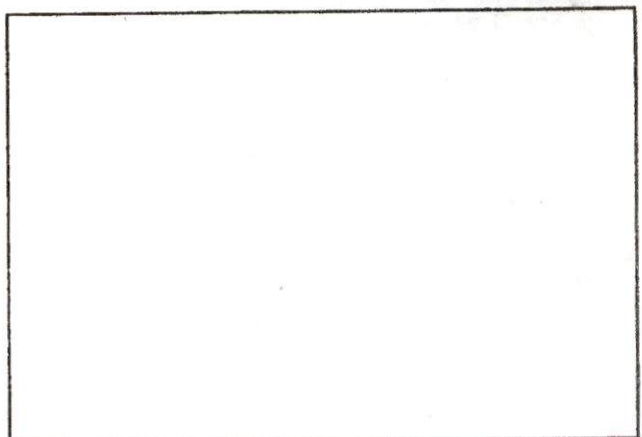

SKETCH PLAN



Inspector's Copy

PERMIT NO.

24031

CITY OF NEW BEDFORD
SEWER AND/OR STORM DRAIN PERMIT

DATE 12/18/07

This certifies that permission is granted to

Jose DeSouza Jr. I Home Builders P.O. Box 80038 Dartmouth 02748
Property Owner Address Tel.

To connect a sewer and/or storm drain located at 48 Charlotte St 24" storm drain

Assessor's Plot 121 Lot 162 to the sewer and/or storm drain in 8" sewer

To be laid in accordance with the conditions in this application and the City of New Bedford ordinances.

TYPE OF USE: ☒ RESIDENTIAL ☐ COMMERCIAL ☐ INDUSTRIAL FLOW 330 G.P.D.

If applicant other than actual property owner, attach Letter of Authorization from Property Owner.

Name Tel.

Mailing Address

The Bonded Contractor/Drain Layer authorized to perform this work is:

Pier Construction 135 Bryant Frank N.B. 508.509.0972

Name Address Tel.

Type of Pipe Required: sdr 35 pvc

PERMIT EXPIRES ONE YEAR AFTER DATE OF ISSUE

- Requires separate connections for sewage and storm drain where applicable. Storm water cannot be discharged to a sanitary sewer.
 - All work must be inspected and approved by a D.P.I. inspector before backfilling.
 - If this connection is to be part of a private service shared jointly with other building owners, attach copy of Recorded Joint Maintenance Agreement.
 - Permits can be issued to Industrial and/or Commercial Applicants only upon receipt and approval by the Commissioner of Public Infrastructure of required plans and supplemental information.
 - In addition, a City-issued Industrial User Discharge Permit and/or a Sewer Extension/Connection Permit issued by the Commonwealth of Massachusetts D.E.P. shall be required by the City for Industrial Discharge into the sewer system.
- Industrial User Discharge Permit No. Date

Comm. Mass. Sewer Conn./Ext. Permit No. Date

A Filing and Inspection Fee of \$1,500.00 plus an Entrance Fee of \$ where applicable, must accompany this application.

Bank# Bank Five Check# 1247 Date 12/18/07 Receipt# 7627

Other requirements: 24 hr. inspection at 508-979-1527

Connection made to Sewer Part of jointly-shared private line YES NO
Storm Drain

Applicant agrees to abide by the above terms, as well as all pertinent ordinances of the City of New Bedford, and such other special rules as the Commissioner of Public Infrastructure and/or City Engineer may deem necessary.

Duarte M. Andrade
Acting City Engineer

Signature of Property Owner or Representative

INSPECTOR'S REPORT

INSPECTED BY: RF

DATE: 12/19/07

COMMENTS:

APPROVED

DISAPPROVED

SIGNATURE

1 pm Wed.
12/19/07 inspection

SKETCH PLAN



CITY OF NEW BEDFORD

1008

NO. 232207

LICENSE NO. _____

DATE 12/10 2007

FOUNDATION PERMIT

MSBC Sect. 111.8 – Any permit issued shall be deemed abandoned and invalid unless the work authorized by it shall have been commenced within six (6) months after its issuance.

This certifies that St Home Builders, owner/contractor
has permission to Install Foundation
on 64 Charlotte St Plot 121, Lot 163

providing that the person accepting this permit shall in every respect conform to the terms of the application therefor on file in this office; to the provisions of the Statute of the Commonwealth and to the By-Laws of the City of New Bedford relating to the Inspection, Erection, Enlarging, Altering, Raising, Moving, Repairing or Tearing Down of a Building.

WIRING INSPECTOR

PLUMBING INSPECTOR

BUILDING INSPECTOR

ROUGH FINISH

YOUR AREA INSPECTOR IS:

Tom Welch

- Tel. 979-1540 Between 8:00 AM – 9:00 AM

NOTICE: NOTIFY INSPECTOR 48 HOURS
IN ADVANCE OF APPLYING
SHEATING OR LATHING

OCCUPANCY PERMIT REQUIRED BEFORE OCCUPANCY

No Building or Structure shall be used or occupied until the Certificate of Use and Occupancy shall have been issued by the Building Commissioner – MSBC. Sect. 120.1 – N.B. Zoning Ord. Sect. 9-269

THIS CARD MUST BE DISPLAYED IN A CONSPICUOUS PLACE ON THE PREMISES
AND NOT TORN DOWN OR REMOVED UNTIL COMPLETION OF WORK

SUBJECT TO MASSACHUSETTS STATE
BUILDING CODE REQUIREMENTS

[Signature]
BUILDING INSPECTOR

