



PERMIT NO.

24019

CITY OF NEW BEDFORD  
SEWER AND/OR STORM DRAIN PERMIT

DATE 11.2.07

This certifies that permission is granted to

Ana Reis (Trustee) *Dexter Realty Trust*  
3 Ledge Wood Blvd. Dartmouth MA 02747  
Property Owner Address #1505 & #1597 590 Tel. 508-995-0097  
*Private*To connect a sewer and/or storm drain located at *E.S. Braley Rd. - Town Line - Freetown*  
*Private*

Assessor's Plot 137 Lot 230 to the sewer and/or storm drain in Braley Rd. Street

To be laid in accordance with the conditions in this application and the City of New Bedford ordinances.

TYPE OF USE: RESIDENTIAL *condos* COMMERCIAL INDUSTRIAL FLOW 440 G.P.D.

If applicant other than actual property owner, attach Letter of Authorization from Property Owner.

Name *Sim Holdings* Tel. 508-995-0097  
Mailing Address 3 Ledge Wood Blvd. Dartmouth, MA 02747

The Bonded Contractor/Drain Layer authorized to perform this work is:

*W.C. Smith*  
Name *W.C. Smith* Address *21 East River Drive, No. Dartmouth 02747* Tel. 508-984-1668  
Type of Pipe Required: *SDR 35 PVC*

## PERMIT EXPIRES ONE YEAR AFTER DATE OF ISSUE

- Requires separate connections for sewage and storm drain where applicable. Storm water cannot be discharged to a sanitary sewer.
  - All work must be inspected and approved by a D.P.I. inspector before backfilling.
  - If this connection is to be part of a private service shared jointly with other building owners, attach copy of Recorded Joint Maintenance Agreement.
  - Permits can be issued to Industrial and/or Commercial Applicants only upon receipt and approval by the Commissioner of Public Infrastructure of required plans and supplemental information.
  - In addition, a City-issued Industrial User Discharge Permit and/or a Sewer Extension/Connection Permit issued by the Commonwealth of Massachusetts D.E.P. shall be required by the City for Industrial Discharge into the sewer system.
- Industrial User Discharge Permit No. \_\_\_\_\_ Date \_\_\_\_\_

Comm. Mass. Sewer Conn./Ext. Permit No. \_\_\_\_\_ Date \_\_\_\_\_

A Filing and Inspection Fee of \$150.00 plus an Entrance Fee of \$ \_\_\_\_\_ where applicable, must accompany this application.

Bank# *Fall River S & C* Check# *12899* Date *11/2/07* Receipt# *7564*Other requirements: *24 hr inspection at 508.97.91527*  
*see attached easement*Connection made to ☒ Sewer ☐ Storm Drain Part of jointly-shared private line ☒ YES ☐ NO

Applicant agrees to abide by the above terms, as well as all pertinent ordinances of the City of New Bedford, and such other special rules as the Commissioner of Public Infrastructure and/or City Engineer may deem necessary

*Quate M. Andrade*  
Acting City Engineer *mn*

Signature of Property Owner or Representative

## INSPECTOR'S REPORT

INSPECTED BY: *Signature & Sketch.*

DATE: \_\_\_\_\_

COMMENTS: \_\_\_\_\_

APPROVED

DIS/

SIGNATURE

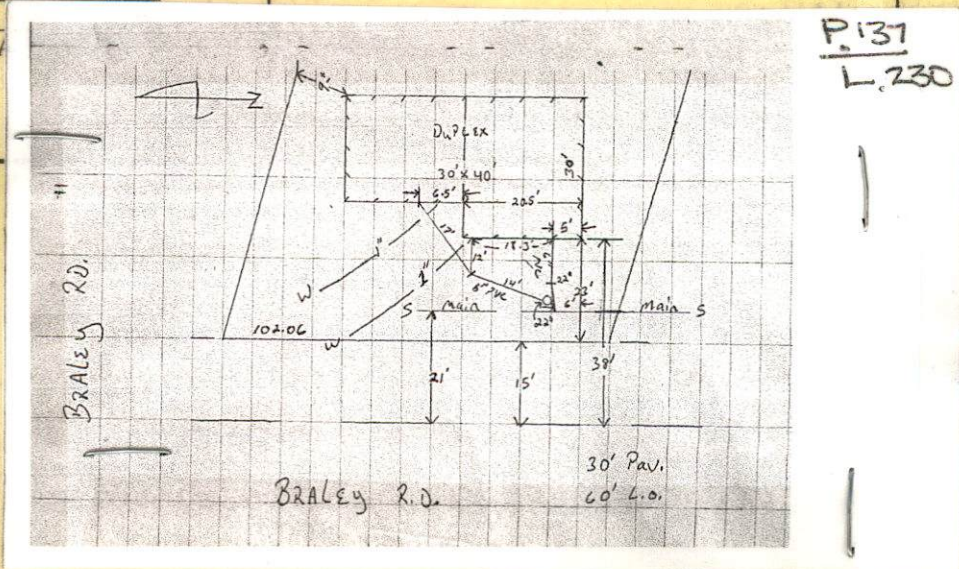





EXT #2 7-12-200  
EXT TO 5/2/2  
DATE 11-20

CITY OF NEW BEDFORD  
SEWER AND/OR STORM DRAIN PERMIT

NO. 24019

This certifies that permission is granted to Dexter Realty Trust  
Ana Reis (Trustee) 3 Hedge Wood Blvd. Daitmouth MA 0274  
Property Owner Address Tel. 508-995-0097  
private  
To connect a sewer and/or storm drain located at E.S. Braley Rd. S x town line  
Assessor's Plot 137 Lot 230 to the sewer and/or storm drain in Braley Rd.

To be laid in accordance with the conditions in this application and the City of New Bedford ordinances.  
TYPE OF USE: RESIDENTIAL COMMERCIAL INDUSTRIAL FLOW 440 G.P.D.

If applicant other than actual property owner, attach Letter of Authorization from Property Owner.  
Name J.M. Holdings Tel. 508-995-0097  
Mailing Address 3 Hedge Wood Blvd. Daitmouth, MA 02747  
The Bonded Contractor/Drain Layer authorized to perform this work is:  
J.B. Sanagan Co. Inc. 21 East River Drive No. Daitmouth 02747  
Name Address Tel. 508-984-10  
Type of Pipe Required: S.D.R. 35 PVC

PERMIT EXPIRES ONE YEAR AFTER DATE OF ISSUE

- Requires separate connections for sewage and storm drain where applicable. Storm water cannot be discharged to a sanitary sewer.
  - All work must be inspected and approved by a D.P.I. inspector before backfilling.
  - If this connection is to be part of a private service shared jointly with other building owners, attach copy of Recorded Joint Maintenance Agreement.
  - Permits can be issued to Industrial and/or Commercial Applicants only upon receipt and approval by the Commissioner of Public Infrastructure of required plans and supplemental information.
  - In addition, a City-issued Industrial User Discharge Permit and/or a Sewer Extension/Connection Permit issued by the Commonwealth of Massachusetts D.E.P. shall be required by the City for Industrial Discharge into the sewer system.
- Industrial User Discharge Permit No. \_\_\_\_\_ Date \_\_\_\_\_

Comm. Mass. Sewer Conn./Ext. Permit No. \_\_\_\_\_ Date \_\_\_\_\_  
A Filing and Inspection Fee of \$ 150 and an Entrance Fee of \$ \_\_\_\_\_ where applicable, must accompany this application

Bank# Fall River S & C Check# 12899 Date 11/2 Receipt# 756

Other requirements: 24 hr inspection at 508.9791527  
see attached easement

Connection made to Sewer Part of jointly-shared private line YES NO  
Storm Drain

Applicant agrees to abide by the above terms, as well as all pertinent ordinances of the City of New Bedford, and other special rules as the Commissioner of Public Infrastructure and/or City Engineer may deem necessary

Quante M. Andrade  
Acting City Engineer mn

Signature of Property Owner or Representative

INSPECTOR'S REPORT

INSPECTED BY: [Signature]  
DATE: 6-15-09  
COMMENTS: \_\_\_\_\_

APPROVED

DISAPPROVED

[Signature]  
SIGNATURE

SKETCH PLAN

Plotted  
Book

Rec'd  
7/1/09

ON Plot / NO CARD

P.2144A



EXT#12 7-12-2009  
EXT TO 5/2/2009  
DATE 11-2-07

PERMIT NO.  
24019

CITY OF NEW BEDFORD  
SEWER AND/OR STORM DRAIN PERMIT

This certifies that permission is granted to

Property Owner Dexter Realty Trust  
Ana Reis (Trustee) 3 Hedge Wood Blvd. Dartmouth MA 02747  
private 590 Tel. 508-995-0097

To connect a sewer and/or storm drain located at E.S. Braley Rd. 1 S X town line Grade freetown  
private  
Assessor's Plot 137 Lot 230, to the sewer and/or storm drain in Braley Rd. Street

To be laid in accordance with the conditions in this application and the City of New Bedford ordinances.

TYPE OF USE: RESIDENTIAL condos COMMERCIAL INDUSTRIAL FLOW 440 G.P.D.

If applicant other than actual property owner, attach Letter of Authorization from Property Owner.

Name Sim Holdings Tel. 508-995-0097  
Mailing Address 3 Hedge Wood Blvd. Dartmouth MA 02747  
The Bonded Contractor/Drain Layer authorized to perform this work is:  
J.B. Langan Co. Inc. 21 East River Drive No. Dartmouth 02747  
Name J.B. Langan Co. Inc. Address 21 East River Drive Tel. 508-989-1668  
Type of Pipe Required: SDR 35 PVC

PERMIT EXPIRES ONE YEAR AFTER DATE OF ISSUE

- Requires separate connections for sewage and storm drain where applicable. Storm water cannot be discharged to a sanitary sewer.
  - All work must be inspected and approved by a D.P.I. inspector before backfilling.
  - If this connection is to be part of a private service shared jointly with other building owners, attach copy of Recorded Joint Maintenance Agreement.
  - Permits can be issued to Industrial and/or Commercial Applicants only upon receipt and approval by the Commissioner of Public Infrastructure of required plans and supplemental information.
  - In addition, a City-issued Industrial User Discharge Permit and/or a Sewer Extension/Connection Permit issued by the Commonwealth of Massachusetts D.E.P. shall be required by the City for Industrial Discharge into the sewer system.
- Industrial User Discharge Permit No. \_\_\_\_\_ Date \_\_\_\_\_

Comm. Mass. Sewer Conn./Ext. Permit No. \_\_\_\_\_ Date \_\_\_\_\_  
A Filing and Inspection Fee of \$ 150.00 plus an Entrance Fee of \$ \_\_\_\_\_ where applicable, must accompany this application.

Bank# Fall River 5¢ Check# 12899 Date 11/2 Receipt# 7564

Other requirements: 24 hr inspection at 508.97.915.27  
see attached easement

Connection made to Sewer Part of jointly-shared private line YES NO  
Storm Drain

Applicant agrees to abide by the above terms, as well as all pertinent ordinances of the City of New Bedford, and such other special rules as the Commissioner of Public Infrastructure and/or City Engineer may deem necessary

Quante M. Andrade  
Acting City Engineer mn

[Signature]  
Signature of Property Owner or Representative

INSPECTOR'S REPORT

INSPECTED BY: \_\_\_\_\_  
DATE: \_\_\_\_\_  
COMMENTS: \_\_\_\_\_

APPROVED \_\_\_\_\_ DISAPPROVED \_\_\_\_\_

SIGNATURE

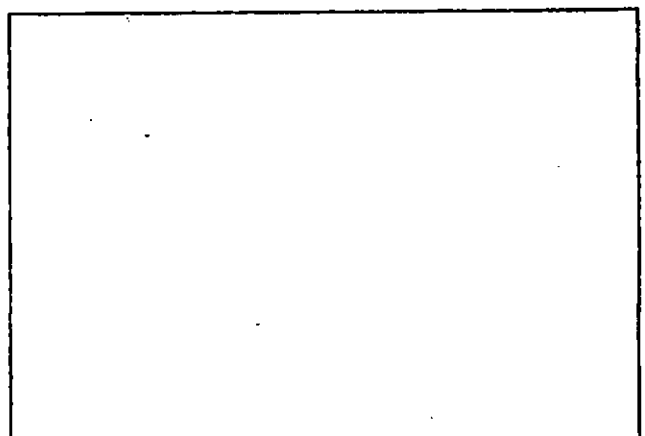

SKETCH PLAN





# CITY OF NEW BEDFORD

NO. 213707

LICENSE NO. 044954

DATE 11-1 2007

# FOUNDATION PERMIT

MSBC Sect. 111.8 - Any permit issued shall be deemed abandoned and invalid unless the work authorized by it shall have been commenced within six (6) months after its issuance.

This certifies that KENNETH E. STEEN, owner/contractor  
 has permission to Erect a Foundation \*  
 on plot 137 Lot 230 Braley Road Lot 5  
 providing that the person accepting this permit shall in every respect conform to the terms of the application therefor on file in this office; to the provisions of the Statute of the Commonwealth and to the By-Laws of the City of New Bedford relating to the Inspection, Erection, Enlarging, Altering, Raising, Moving, Repairing or Tearing Down of a Building.

WIRING INSPECTOR

PLUMBING INSPECTOR

BUILDING INSPECTOR \*

attached Conditions

YOUR AREA INSPECTOR IS:

Thomas Welch

ROUGH FINISH

Tel. 979-1540 Between 8:00 AM - 9:00 AM

NOTICE: NOTIFY INSPECTOR 48 HOURS

IN ADVANCE OF APPLYING  
SHEATING OR LATHING

## OCCUPANCY PERMIT REQUIRED BEFORE OCCUPANCY

No Building or Structure shall be used or occupied until the Certificate of Use and Occupancy shall have been issued by the Building Commissioner - MSBC. Sect. 120.1 - N.B. Zoning Ord. Sect. 9-269

THIS CARD MUST BE DISPLAYED IN A CONSPICUOUS PLACE ON THE PREMISES  
AND NOT TORN DOWN OR REMOVED UNTIL COMPLETION OF WORK

SUBJECT TO MASSACHUSETTS STATE  
BUILDING CODE REQUIREMENTS

Extend TO MAY 1, 2009 DDR

Danny D. Lawrence  
BUILDING INSPECTOR Deputy

508 9950401



**CITY OF NEW BEDFORD  
MASSACHUSETTS**

**D.P.I. -Engineering Division**

**1105 Shawmut Ave.**

**New Bedford, Ma. 02746**

**Tel: 508-991-6150**

**Fax: 508-961-9034**

991-6152

**Ronald Labelle  
Commissioner**

**Duarte M. Andrade,  
Acting City Engineer**

**To Whom It May Concern:**

I Ana M Reis, Trustee (Name) 3 Ledgewood Blvd, Dartmouth, MA (Mailing Address) being 02747

Owner of property located at Brasley Rd  
Plot 137, Lot 230 294, hereby agree to allow Ken Steen or  
Jim Holding (Name)

3 Ledgewood (Mailing Address) to act on my behalf including affixing my

signature in securing permit for:

☒ Sewer/Drain Service Permits  
☒ Water Service Permits  
☒ Driveway Installation Permits  
☐ Sidewalk Installation Permits

I further agree to conform to, and abide by, All City rules and ask regulations applicable to the permit (s) being applied for:

Name Ana M Reis, Trustee Signature  
3 Ledgewood Blvd, Dartmouth, Ma Address  
11/2/07 Date 508.958.8199 Telephone number  
02747

220-15

221 LPO 0239

## EASEMENT

I, KENNETH E. STEEN of New Bedford, Bristol County, Massachusetts, for consideration paid and in full consideration of One and 00/100 (\$1.00) Dollar, grant to KENNETH E. STEEN and JAMES E. HOLDING as tenants in common of 1399 Phillips Road, New Bedford, Bristol County, Massachusetts, an easement for the benefit of each Unit in Braley Woods Condominiums, said condominium created pursuant to Master Deed dated October 14, 1988 and recorded in the Bristol County (S.D.) Registry of Deeds on October 17, 1988 in Book 2219, Page 133, in and to a certain sewage pumping station and all forced mains, waste and pipelines and all other appurtenances thereto located on a lot of land being Lot 9 on a "Plan of Land in New Bedford, Massachusetts prepared for WRA Realty Inc. and David White Scale: 1" = 120' December 31, 1986 prepared by GHR Engineering Associates 75 Tauckin Hill Road New Bedford, MA 02745." and recorded with the Bristol County (S.D.) Registry of Deeds in Plan Book 1.15, Page 134.

For title see deed of David White dated September 15, 1987 and recorded in the Bristol County (S.D.) Registry of Deeds in Book 2048, Page 710.

IN WITNESS WHEREOF the said Kenneth E. Steen has hereunto set his hand and seal this 14th day of October, 1988.

Witness

Kenneth E. Steen

## COMMONWEALTH OF MASSACHUSETTS

Bristol, ss. Fall River October 14, 1988

Then personally appeared the above named Kenneth E. Steen and acknowledged the foregoing instrument to be his free act and deed before me.

Wilfred C. Driscoll, Jr.

Notary Public

My commission expires: 9/28/91

Received & Recorded Oct. 20 1988 at 11 hrs. 22 min. 4 sec.

Attest:

John E. [Signature]



1002

## CITY OF NEW BEDFORD

No. 213707LICENSE NO. 044954DATE 11-1 2007

## FOUNDATION PERMIT

MSBC Sect. 111.8 - Any permit issued shall be deemed abandoned and invalid unless the work authorized by it shall have been commenced within six (6) months after its issuance.

This certifies that Kenneth E. Steen, owner/contractor  
has permission to Erect a Foundation \*  
on plot 137 Lot 230 Braley Road Lot 5  
providing that the person accepting this permit shall in every respect conform to the terms of the application therefor on file in this office; to the provisions of the Statute of the Commonwealth and to the By-Laws of the City of New Bedford relating to the Inspection, Erection, Enlarging, Altering, Raising, Moving, Repairing or Tearing Down of a Building.

WIRING INSPECTOR

PLUMBING INSPECTOR

BUILDING INSPECTOR \*

attached Conditions

ROUGH FINISH

YOUR AREA INSPECTOR IS:

Thomas Welch

Tel. 979-1540 Between 8:00 AM - 9:00 AM

NOTICE: NOTIFY INSPECTOR 48 HOURS  
IN ADVANCE OF APPLYING  
SHEATING OR LATHING

## OCCUPANCY PERMIT REQUIRED BEFORE OCCUPANCY

No Building or Structure shall be used or occupied until the Certificate of Use and Occupancy shall have been issued by the Building Commissioner - MSBC. Sect. 120.1 - N.B. Zoning Ord. Sect. 9-269

THIS CARD MUST BE DISPLAYED IN A CONSPICUOUS PLACE ON THE PREMISES  
AND NOT TORN DOWN OR REMOVED UNTIL COMPLETION OF WORK

SUBJECT TO MASSACHUSETTS STATE  
BUILDING CODE REQUIREMENTS

Danny D. Romanos  
BUILDING INSPECTOR



NEW DUPLEX  
113-IN INSPECTION

9/15/09

W.P. / CORD

W.C. SMITH CONTR.  
R. B. CORD / INSP.

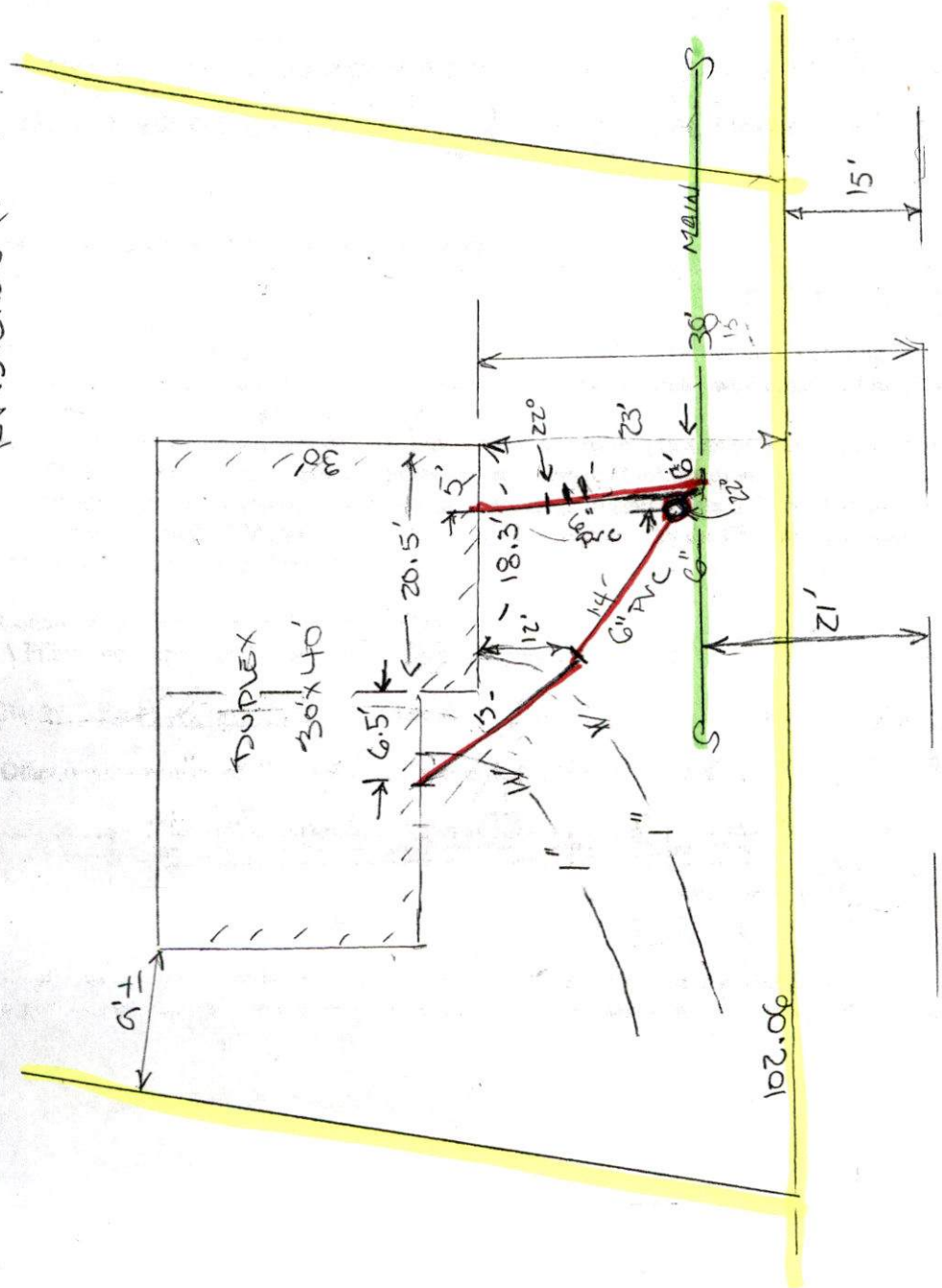

30' par.  
60' L.O.

BRANCHED RD.

44



BRALLEY RD.

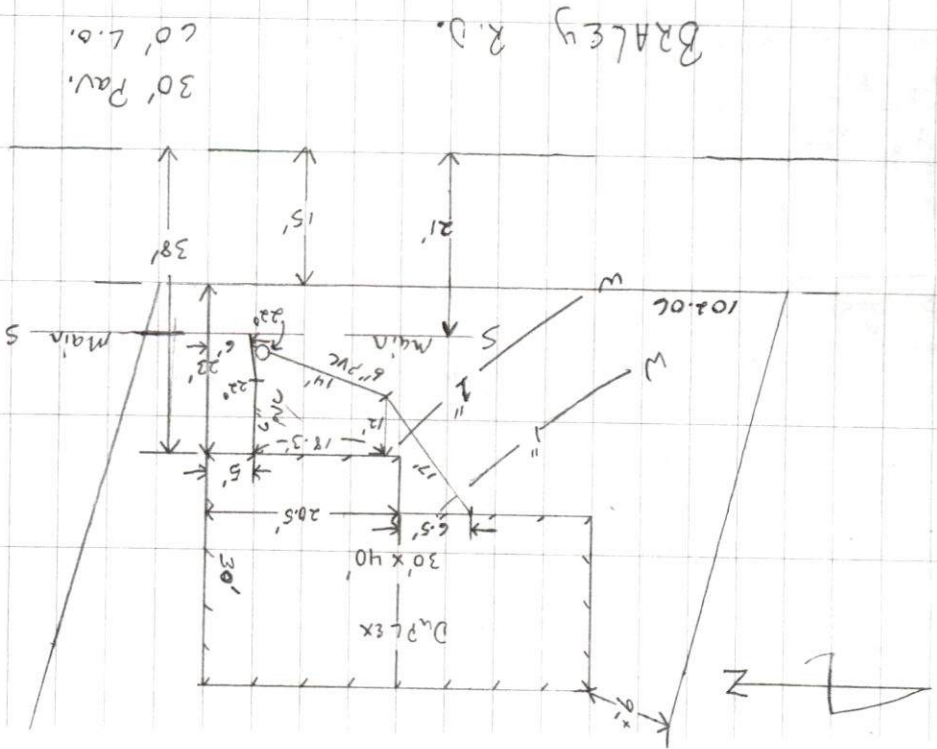

Submitted last week October 2009.

3

Sewer Inspection/Tie-in

@

BRALLEY RD.

Contractor: W.C. Smith

Inspector: R. Bichel

Permit #: <sup>24619</sup> ~~24019~~

Plot 137 Lot 230

Date: 6-15-09

Dwork extended this permit until 11/12/09 for 2nd time...

?

Submitted for Rec. 11/1/09