



PERMIT NO.  
23985

CITY OF NEW BEDFORD  
SEWER AND/OR STORM DRAIN PERMIT

DATE 8/1/07  
EXP 8/1/08

This certifies that permission is granted to

Property Owner: Tanya Leirion Address: 550 Hanks St. New Bedford, MA 02745 Tel: (508) 998-5362  
(508) 998-9567

To connect a sewer and/or storm drain located at Church St. (W.S.) 775' ± N.Y. Tacklin Hill Rd.

Assessor's Plot 77A Lot 38, to the sewer and/or storm drain in Church (10" S & 15" S.D.) Street

To be laid in accordance with the conditions in this application and the City of New Bedford ordinances.

TYPE OF USE: RESIDENTIAL COMMERCIAL INDUSTRIAL FLOW G.P.D.

If applicant other than actual property owner, attach Letter of Authorization from Property Owner.  
36x10 Addition to Daycare (2 Classrooms - 4 Bathrooms) at 575 Church St.

Name: N/A Tel:

Mailing Address:

The Bonded Contractor/Drain Layer authorized to perform this work is: 508-990-8447

Name: Chris Mendoza Address: 43 Chase Rd. N. Dartmouth Tel: 508-889-4247

Type of Pipe Required: PVC SDR 35 (16") for Sewer (10" Separation Between Water & Sewer Req'd.)

PERMIT EXPIRES ONE YEAR AFTER DATE OF ISSUE

- Requires separate connections for sewage and storm drain where applicable. Storm water cannot be discharged to a sanitary sewer.
- All work must be inspected and approved by a D.P.I. inspector before backfilling.
- If this connection is to be part of a private service shared jointly with other building owners, attach copy of Recorded Joint Maintenance Agreement.
- Permits can be issued to Industrial and/or Commercial Applicants only upon receipt and approval by the Commissioner of Public Infrastructure of required plans and supplemental information.
- In addition, a City-issued Industrial User Discharge Permit and/or a Sewer Extension/Connection Permit issued by the Commonwealth of Massachusetts D.E.P. shall be required by the City for Industrial Discharge into the sewer system.

Industrial User Discharge Permit No. N/A Date:

Comm. Mass. Sewer Conn./Ext. Permit No. N/A Date:

A Filing and Inspection Fee of \$ 150., plus an Entrance Fee of \$ N/A, where applicable, must accompany this application.

Bank# Citizens Bank Check# 488 Date 8/1/07 Receipt# 7344

Other requirements: 24 Hr. Notice for Inspection Required - Call (508) 991-6729.

Roof gutters must be tied into 15" surface drain in driveway or a Permit

Connection made to Sewer Part of jointly-shared private line YES (NO) Drywell/Leaching Basin must be installed on property (See attached drawing.)

Applicant agrees to abide by the above terms, as well as all pertinent ordinances of the City of New Bedford, and such other special rules as the Commissioner of Public Infrastructure and/or City Engineer may deem necessary

City Engineer: Deane M. C. Sullivan Signature of Property Owner or Representative: Tanya Leirion

INSPECTOR'S REPORT

INSPECTED BY: Kevin Cornell  
DATE: 9/18/07  
COMMENTS:

APPROVED Kevin Cornell DISA  
SIGNATURE

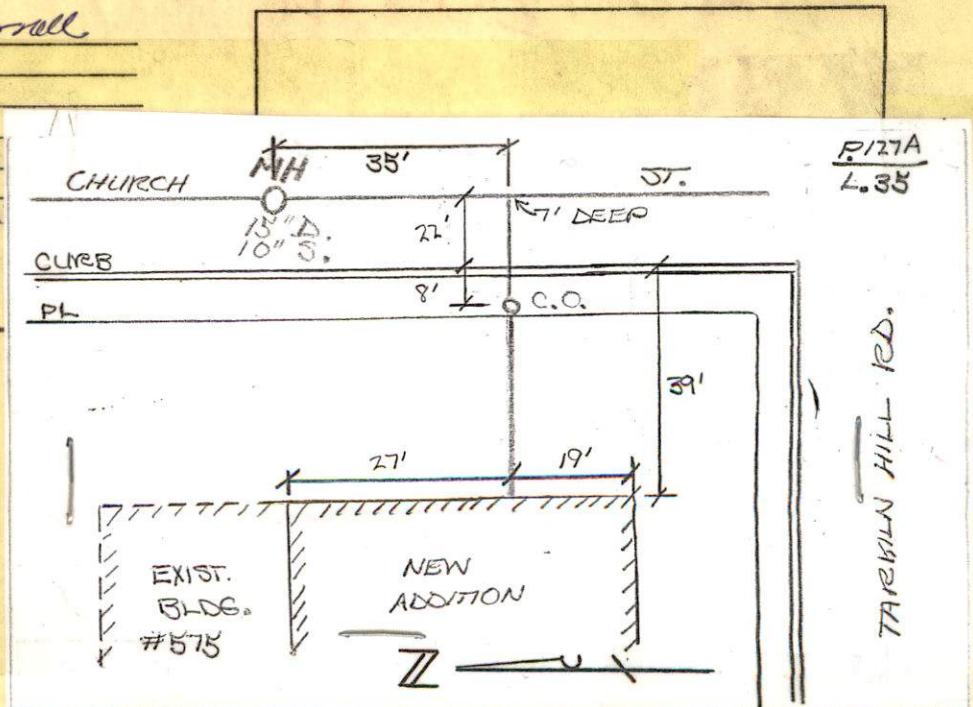





PERMIT NO.  
23985

CITY OF NEW BEDFORD  
SEWER AND/OR STORM DRAIN PERMIT

DATE 8/1/07  
EXP 8/1/08

This certifies that permission is granted to

James Leiriao 550 Hawes St. New Bedford MA 02745 (508) 995-5362  
Property Owner Address Tel. (508) 998-9567

To connect a sewer and/or storm drain located at Church St. (WS) 275' ± N X Dartmouth Hill Rd.

Assessor's Plot 177A Lot 35, to the sewer and/or storm drain in Church (10" S & 15" S.D.) Street

To be laid in accordance with the conditions in this application and the City of New Bedford ordinances.

TYPE OF USE: RESIDENTIAL COMMERCIAL INDUSTRIAL FLOW \_\_\_\_\_ G.P.D.

36x40 Addition to Daycare (2 Classrooms - 4 Bathrooms) at 575 Church St.  
If applicant other than actual property owner, attach Letter of Authorization from Property Owner.

Name N/A Tel. \_\_\_\_\_

Mailing Address \_\_\_\_\_

The Bonded Contractor/Drain Layer authorized to perform this work is:

Will call in. Chris Mendoza 45 Chase Rd. No. Dartmouth 508-889-4247

Name \_\_\_\_\_ Address \_\_\_\_\_ Tel. \_\_\_\_\_

Type of Pipe Required: PVC SDR 35 (6") for Sewer (10" Separation Between Water & Sewer Reg'd.)

PERMIT EXPIRES ONE YEAR AFTER DATE OF ISSUE

- Requires separate connections for sewage and storm drain where applicable. Storm water cannot be discharged to a sanitary sewer.
- All work must be inspected and approved by a D.P.I. inspector before backfilling.
- If this connection is to be part of a private service shared jointly with other building owners, attach copy of Recorded Joint Maintenance Agreement.
- Permits can be issued to Industrial and/or Commercial Applicants only upon receipt and approval by the Commissioner of Public Infrastructure of required plans and supplemental information.
- In addition, a City-issued Industrial User Discharge Permit and/or a Sewer Extension/Connection Permit issued by the Commonwealth of Massachusetts D.E.P. shall be required by the City for Industrial Discharge into the sewer system.

Industrial User Discharge Permit No. N/A Date \_\_\_\_\_

Comm. Mass. Sewer Conn./Ext. Permit No. N/A Date \_\_\_\_\_

A Filing and Inspection Fee of \$ 150., plus an Entrance Fee of \$ N/A, where applicable, must accompany this application.

Bank# Citizens Bank Check# 488 Date 8/1/07 Receipt# 7344

Other requirements: 24 Hr Notice for Inspection Required - Call (508) 991-6729.

Roof gutters must be tied into 15" surface drain in roadway or a Precast

Connection made to Sewer Part of jointly-shared private line YES (NO) Drywell/Leaching Basin must be installed on property (see attached drawing.)

Applicant agrees to abide by the above terms, as well as all pertinent ordinances of the City of New Bedford, and such other special rules as the Commissioner of Public Infrastructure and/or City Engineer may deem necessary

Quade M. Chudradlo, Jr.  
City Engineer

X. James Leiriao  
Signature of Property Owner or Representative

INSPECTOR'S REPORT

INSPECTED BY: \_\_\_\_\_

DATE: \_\_\_\_\_

COMMENTS: \_\_\_\_\_

APPROVED

DISAPPROVED

SIGNATURE

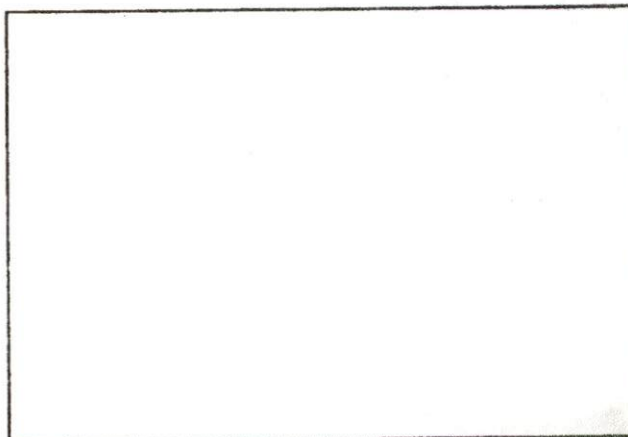

SKETCH PLAN





# CITY OF NEW BEDFORD

20406

NO. 4523

LICENSE NO. \_\_\_\_\_

DATE 4/17

20 07

## BUILDING PERMIT

MSBC Sect. 110.14 — Any permit issued shall be deemed abandoned and invalid unless the work authorized by it shall have been commenced within six (6) months after its issuance.

This certifies that D & P Contracting, owner/contractor  
has permission to Build addition 36 x 40  
on 575 Church St.

Providing that the person accepting this permit shall in every respect conform to the terms of the application therefore on file in this office; to the provisions of the statute of the Commonwealth and to the by-laws of the City of New Bedford relating to the inspection, erection, enlarging, altering, raising, moving, repairing, or tearing down of a building.

CITY DEPARTMENT/COMMISSION COMMENTS	BUILDING DEPARTMENT COMMENTS
<p>The following department/commission has expressed concern about the issuance of this permit. You are advised to contact that agency to resolve this matter.</p> <p>Department/Commission: _____</p> <p>Comments: _____</p>	

YOUR AREA INSPECTOR IS: \_\_\_\_\_ Tel. 979-1540 Between 8:00 AM — 9:00 AM

NOTICE: NOTIFY INSPECTOR 48 HOURS  
IN ADVANCE OF APPLYING  
SHEATHING OR LATHING

### OCCUPANCY PERMIT REQUIRED BEFORE OCCUPANCY

No Building or Structure shall be used or occupied until the Certificate of Use and Occupancy shall have been issued by the Building Commissioner — MSBC, Sect. 120.1 —

THIS CARD MUST BE DISPLAYED IN A CONSPICUOUS PLACE ON THE PREMISES  
AND NOT TORN DOWN OR REMOVED UNTIL COMPLETION OF WORK

SUBJECT TO MASSACHUSETTS STATE  
BUILDING CODE REQUIREMENTS



65°  
28

#575 CHURCH ST

PERMIT #23985

CONTRACTOR - CHRIS MENDOZA  
508-889-4247

9-18-07

TUES

SUNNY

