



PERMIT NO.

23970

CITY OF NEW BEDFORD
SEWER AND/OR STORM DRAIN PERMIT

DATE 6/20/07

This certifies that permission is granted to

NB Housing Authority 725 Pleasant St. NB 508.997.4852
Property Owner Address Tel.

To connect a sewer and/or storm drain located at 177 Mill St. 18.5' x 18.5' unit 6

Assessor's Plot 57 Lot 174, to the sewer and/or storm drain in Mill Street

To be laid in accordance with the conditions in this application and the City of New Bedford ordinances.

TYPE OF USE: ☒ RESIDENTIAL ☐ COMMERCIAL ☐ INDUSTRIAL FLOW 23952 G.P.D.

If applicant other than actual property owner, attach Letter of Authorization from Property Owner.

Name Joseph Woodall Tel. 508-520-9733

Mailing Address 182 Seaboard St. Norfolk, Ma.

The Bonded Contractor/Drain Layer authorized to perform this work is:

Joe Woodall & Sons Const. Co. Inc. 182 Seaboard St. Norfolk, Ma.

Name Address Tel.

Type of Pipe Required: sdr 35 pvc 508-520-9733

PERMIT EXPIRES ONE YEAR AFTER DATE OF ISSUE

- Requires separate connections for sewage and storm drain where applicable. Storm water cannot be discharged to a sanitary sewer.
- All work must be inspected and approved by a D.P.I. inspector before backfilling.
- If this connection is to be part of a private service shared jointly with other building owners, attach copy of Recorded Joint Maintenance Agreement.
- Permits can be issued to Industrial and/or Commercial Applicants only upon receipt and approval by the Commissioner of Public Infrastructure of required plans and supplemental information.
- In addition, a City-issued Industrial User Discharge Permit and/or a Sewer Extension/Connection Permit issued by the Commonwealth of Massachusetts D.E.P. shall be required by the City for Industrial Discharge into the sewer system.

Industrial User Discharge Permit No. Date

Comm. Mass. Sewer Conn./Ext. Permit No. Date

A Filing and Inspection Fee of \$150.00, plus an Entrance Fee of \$ where applicable, must accompany this application.

Bank# Sovereign Bank Check# 20745 Date 6/20/07 Receipt# 7237

Other requirements: 24 hr. inspection at 508-979-1527

Connection made to Sewer Part of jointly-shared private line YES NO
Storm Drain

Applicant agrees to abide by the above terms, as well as all pertinent ordinances of the City of New Bedford, and such other special rules as the Commissioner of Public Infrastructure and/or City Engineer may deem necessary

Duarte M. Andrade
Acting City Engineer

Signature of Property Owner or Representative

INSPECTOR'S REPORT

INSPECTED BY: Kevin Corneil

DATE: July - 2007

COMMENTS:

APPROVED

DIS

Kevin Corneil

SIGNATURE

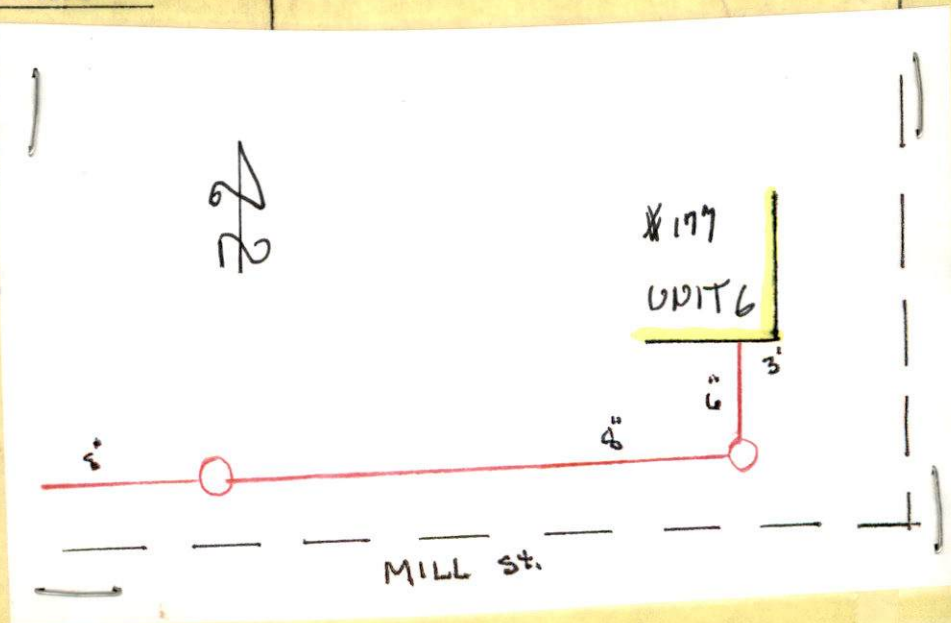



PERMIT NO.

23970

CITY OF NEW BEDFORD
SEWER AND/OR STORM DRAIN PERMIT

DATE 6/20/07

This certifies that permission is granted to

N.B. Housing Authority 725 Pleasant St NB 508.997.4852
Property Owner Address Tel.

To connect a sewer and/or storm drain located at 177 Mill St 185' e x Ash St unit 6

Assessor's Plot 57 Lot 174, to the sewer and/or storm drain in Mill Street

To be laid in accordance with the conditions in this application and the City of New Bedford ordinances.

TYPE OF USE: ☒ RESIDENTIAL ☐ COMMERCIAL ☐ INDUSTRIAL FLOW 23952 G.P.D.

If applicant other than actual property owner, attach Letter of Authorization from Property Owner.

Name Joseph Woodall Tel. 508-520-9733
Mailing Address 182 Sheehy St Norfolk Ma

The Bonded Contractor/Drain Layer authorized to perform this work is:

Joe Woodall & Sons Const. Co. Inc 182 Sheehy St Norfolk Ma
Name Address Tel. 508-520-9733
Type of Pipe Required: sd 3.5 pvc

PERMIT EXPIRES ONE YEAR AFTER DATE OF ISSUE

- Requires separate connections for sewage and storm drain where applicable. Storm water cannot be discharged to a sanitary sewer.
- All work must be inspected and approved by a D.P.I. inspector before backfilling.
- If this connection is to be part of a private service shared jointly with other building owners, attach copy of Recorded Joint Maintenance Agreement.
- Permits can be issued to Industrial and/or Commercial Applicants only upon receipt and approval by the Commissioner of Public Infrastructure of required plans and supplemental information.
- In addition, a City-issued Industrial User Discharge Permit and/or a Sewer Extension/Connection Permit issued by the Commonwealth of Massachusetts D.E.P. shall be required by the City for Industrial Discharge into the sewer system.

Industrial User Discharge Permit No. _____ Date _____

Comm. Mass. Sewer Conn./Ext. Permit No. _____ Date _____

A Filing and Inspection Fee of \$150.00 plus an Entrance Fee of \$ _____ where applicable, must accompany this application.

Bank# Sovereign Bank Check# 20745 Date 6/20/07 Receipt# 7237

Other requirements: 24 hr inspection at 508-979-1527

Connection made to Sewer Part of jointly-shared private line YES NO
Storm Drain

Applicant agrees to abide by the above terms, as well as all pertinent ordinances of the City of New Bedford, and such other special rules as the Commissioner of Public Infrastructure and/or City Engineer may deem necessary

Quate M. Andros
Acting City Engineer mn

Signature of Property Owner or Representative ✓

INSPECTOR'S REPORT

INSPECTED BY: _____
DATE: _____
COMMENTS: _____

APPROVED _____ DISAPPROVED _____

SIGNATURE

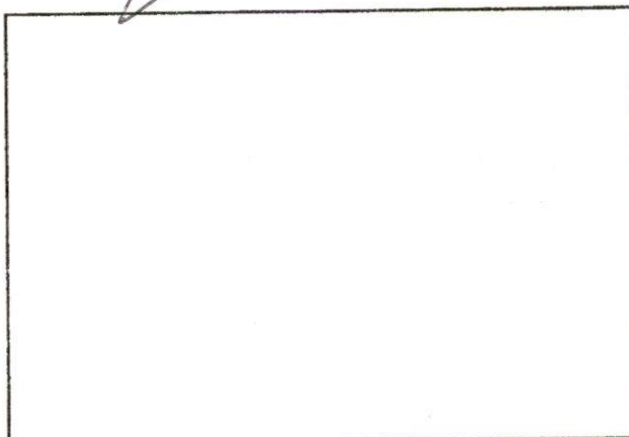

SKETCH PLAN

New Bedford Housing Authority

Modernization Office

725 Pleasant Street

New Bedford, Massachusetts 02740

JOSEPH S. FINNERTY
Executive DirectorTEL: 508-997-4852
FAX: 508-997-4825
TDD: 508-997-4874

April 30, 2007

Mr. Ronald LaBelle
Dept. of Public Infrastructure
1105 Shawmut Ave.
New Bedford, Ma 02740

Dear Mr. LaBelle,

I, Richard Walega of the New Bedford Housing Authority authorize Joe Woodall and Sons to acquire necessary permits for the site work for the Mill Street Housing Project.

Sincerely,

Richard Walega
Deputy Director of Modernization