



PERMIT NO.
23948

CITY OF NEW BEDFORD
SEWER AND/OR STORM DRAIN PERMIT

DATE 4/23/07

This certifies that permission is granted to

Stephen Souza 118 Irvington St. NB 508 998 6357
Property Owner Address Tel.

To connect a sewer and/or storm drain located at Whitelock St. n.s. 130' w. Mt Pleasant St.

Assessor's Plot 123B Lot 6.8, to the sewer and/or storm drain in manhole is stub line Street

To be laid in accordance with the conditions in this application and the City of New Bedford ordinances.

TYPE OF USE: ☒ RESIDENTIAL ☐ COMMERCIAL ☐ INDUSTRIAL FLOW 330 G.P.D.

If applicant other than actual property owner, attach Letter of Authorization from Property Owner.

Name Mailing Address Tel.

The Bonded Contractor/Drain Layer authorized to perform this work is:

Cardoso Contracting 95 R Main St Acushnet 508 998 5115
Name Address Tel.

Type of Pipe Required: SDR 35 PVC

PERMIT EXPIRES ONE YEAR AFTER DATE OF ISSUE

- Requires separate connections for sewage and storm drain where applicable. Storm water cannot be discharged to a sanitary sewer.
- All work must be inspected and approved by a D.P.I. inspector before backfilling.
- If this connection is to be part of a private service shared jointly with other building owners, attach copy of Recorded Joint Maintenance Agreement.
- Permits can be issued to Industrial and/or Commercial Applicants only upon receipt and approval by the Commissioner of Public Infrastructure of required plans and supplemental information.
- In addition, a City-issued Industrial User Discharge Permit and/or a Sewer Extension/Connection Permit issued by the Commonwealth of Massachusetts D.E.P. shall be required by the City for Industrial Discharge into the sewer system.

Industrial User Discharge Permit No. Date

Comm. Mass. Sewer Conn./Ext. Permit No. Date

A Filing and Inspection Fee of \$150, plus an Entrance Fee of \$202.5 where applicable, must accompany this application.

Bank# First Citizens Check# 5051 Date 4/23/07 Receipt# 7064

Other requirements: 24 hr inspection at 508-979-1527

Stub at prop. line (10' SW) Stub enters m.h.

Connection made to Sewer Part of jointly-shared private line YES ☒ NO
Storm Drain

Applicant agrees to abide by the above terms, as well as all pertinent ordinances of the City of New Bedford, and such other special rules as the Commissioner of Public Infrastructure and/or City Engineer may deem necessary

Duarte M. Andrade
Acting City Engineer

Stephen W. Souza
Signature of Property Owner or Representative

INSPECTOR'S REPORT

INSPECTED BY: Kevin Cornwell

DATE: 6/11/07

COMMENTS:

APPROVED

DISAPPROVED

Kevin S. Souza
SIGNATURE

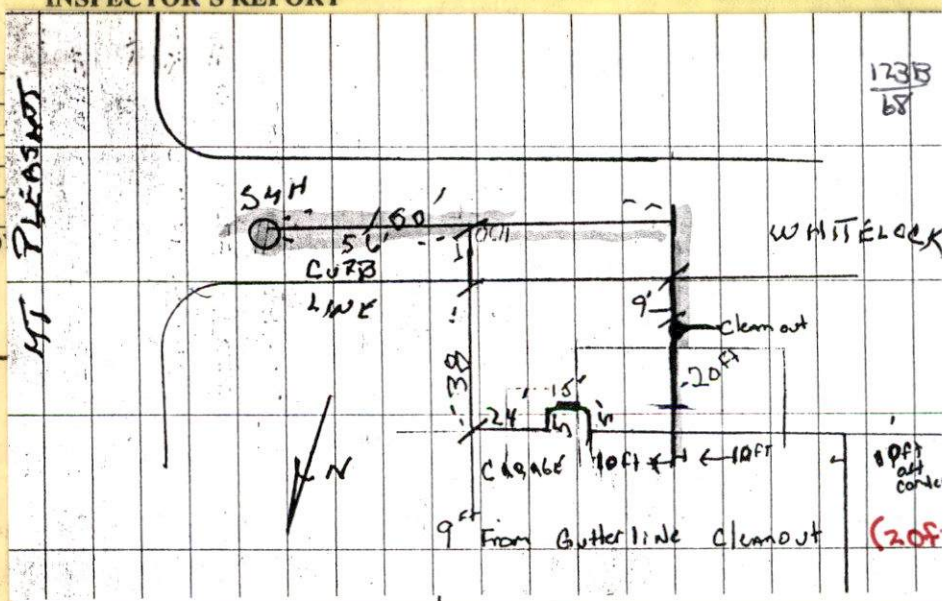

[illegible]

6/11/07 Sunny

⑤

Permit # 23948

Cardoso Contracting

Ass. Plot 123B Lot 68



PERMIT NO.
23948

CITY OF NEW BEDFORD
SEWER AND/OR STORM DRAIN PERMIT

DATE 4/23/07

This certifies that permission is granted to

Stephen Souza 118 Irvington St. NB 508 998 6357
Property Owner Address Tel.

To connect a sewer and/or storm drain located at Whitelock St. n.s. 130' w. Mt. Pleasant St.

Assessor's Plot 123B Lot 6.8, to the sewer and/or storm drain in manhole is stub line Street

To be laid in accordance with the conditions in this application and the City of New Bedford ordinances.

TYPE OF USE; ☒ RESIDENTIAL ☐ COMMERCIAL ☐ INDUSTRIAL FLOW 330 G.P.D.

If applicant other than actual property owner, attach Letter of Authorization from Property Owner.

Name Tel.

Mailing Address

The Bonded Contractor/Drain Layer authorized to perform this work is:

Cardoso Contracting 95 R. Main St Acushnet 508 998 5115
Name Address Tel.

Type of Pipe Required: SDR 35 PVC

PERMIT EXPIRES ONE YEAR AFTER DATE OF ISSUE

- Requires separate connections for sewage and storm drain where applicable. Storm water cannot be discharged to a sanitary sewer.
 - All work must be inspected and approved by a D.P.I. inspector before backfilling.
 - If this connection is to be part of a private service shared jointly with other building owners, attach copy of Recorded Joint Maintenance Agreement.
 - Permits can be issued to Industrial and/or Commercial Applicants only upon receipt and approval by the Commissioner of Public Infrastructure of required plans and supplemental information.
 - In addition, a City-issued Industrial User Discharge Permit and/or a Sewer Extension/Connection Permit issued by the Commonwealth of Massachusetts D.E.P. shall be required by the City for Industrial Discharge into the sewer system.
- Industrial User Discharge Permit No. Date

Comm. Mass. Sewer Conn./Ext. Permit No. Date

A Filing and Inspection Fee of \$150., plus an Entrance Fee of \$202.50 where applicable, must accompany this application.

Bank First Citizens Check# 5051 Date 4/23/07 Receipt# 7064

Other requirements: 24 hr inspection at 508-979-1527

Stub at prep. line (10' sw) Stub enters mh

Connection made to Sewer Part of jointly-shared private line YES ☒ NO
Storm Drain

Applicant agrees to abide by the above terms, as well as all pertinent ordinances of the City of New Bedford, and such other special rules as the Commissioner of Public Infrastructure and/or City Engineer may deem necessary

Duarte M. Andrade
Acting City Engineer mn

Stephen W. Souza
Signature of Property Owner or Representative

INSPECTOR'S REPORT

INSPECTED BY:

DATE:

COMMENTS:

APPROVED

DISAPPROVED

SIGNATURE

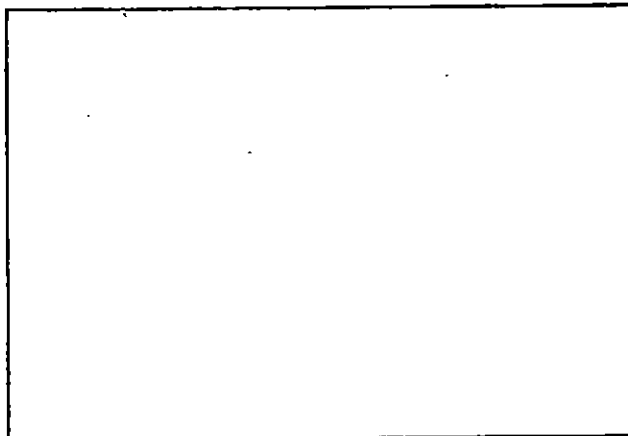

SKETCH PLAN



CITY OF NEW BEDFORD

923

NO. 237706

LICENSE NO. _____

DATE _____ 20____

FOUNDATION PERMIT

MSBC Sect. 111.8 – Any permit issued shall be deemed abandoned and invalid unless the work authorized by it shall have been commenced within six (6) months after its issuance.

This certifies that Kelly Sturtevant, owner/contractor
has permission to install foundation
on Whitelock St. Lots 68-71, 171-174

providing that the person accepting this permit shall in every respect conform to the terms of the application therefor on file in this office; to the provisions of the Statute of the Commonwealth and to the By-Laws of the City of New Bedford relating to the Inspection, Erection, Enlarging, Altering, Raising, Moving, Repairing or Tearing Down of a Building.

WIRING INSPECTOR

PLUMBING INSPECTOR

BUILDING INSPECTOR

Lots to be combined with plan recorded
at reg of deeds prior to building permit

ROUGH FINISH

YOUR AREA INSPECTOR IS: _____

– Tel. 979-1540 Between 8:00 AM – 9:00 AM

NOTICE: NOTIFY INSPECTOR 48 HOURS
IN ADVANCE OF APPLYING
SHEATING OR LATHING

OCCUPANCY PERMIT REQUIRED BEFORE OCCUPANCY

No Building or Structure shall be used or occupied until the Certificate of Use and Occupancy shall have been issued by the Building Commissioner – MSBC. Sect. 120.1 – N.B. Zoning Ord. Sect. 9-269

THIS CARD MUST BE DISPLAYED IN A CONSPICUOUS PLACE ON THE PREMISES
AND NOT TORN DOWN OR REMOVED UNTIL COMPLETION OF WORK

SUBJECT TO MASSACHUSETTS STATE
BUILDING CODE REQUIREMENTS

[Signature]
BUILDING INSPECTOR