



PERMIT NO.
23927

CITY OF NEW BEDFORD
SEWER AND/OR STORM DRAIN PERMIT

DATE 2/2/07

This certifies that permission is granted to

Idalina Oliveira 59 Acushnet Ave NB 508 994 2988
Property Owner Address Tel.

To connect a sewer and/or storm drain located at Acushnet Ave

Assessor's Plot 30 Lot 262, to the sewer and/or storm drain in Acushnet Ave Street

To be laid in accordance with the conditions in this application and the City of New Bedford ordinances.

TYPE OF USE: ☒ RESIDENTIAL ☐ COMMERCIAL ☐ INDUSTRIAL ☐ OTHER

If applicant other than actual property owner, attach Letter of Authorization from Property Owner.

Name John Rezendes Tel. 508-984-1668

Mailing Address 21 East River Dr Dartmouth MA

The Bonded Contractor/Drain Layer authorized to perform this work is:

J.B. Laganan Co. 21 East River Dr Dartmouth

Name Address Tel.

Type of Pipe Required: SDR 35 PVC

PERMIT EXPIRES ONE YEAR AFTER DATE OF ISSUE

- Requires separate connections for sewage and storm drain where applicable. Storm water cannot be discharged to a sanitary sewer.
 - All work must be inspected and approved by a D.P.I. inspector before backfilling.
 - If this connection is to be part of a private service shared jointly with other building owners, attach copy of Recorded Joint Maintenance Agreement.
 - Permits can be issued to Industrial and/or Commercial Applicants only upon receipt and approval by the Commissioner of Public Infrastructure of required plans and supplemental information.
 - In addition, a City-issued Industrial User Discharge Permit and/or a Sewer Extension/Connection Permit issued by the Commonwealth of Massachusetts D.E.P. shall be required by the City for Industrial Discharge into the sewer system.
- Industrial User Discharge Permit No. Date

Comm. Mass. Sewer Conn./Ext. Permit No. Date

A Filing and Inspection Fee of \$150.00 plus an Entrance Fee of \$ where applicable, must accompany this application.

Bank# 17852 Check# Date 2/5/07 Receipt# 6870

Other requirements: 24 hr inspection 508-979-1527

winter rules

Connection made to Sewer Part of jointly-shared private line YES NO

Storm Drain

Applicant agrees to abide by the above terms, as well as all pertinent ordinances of the City of New Bedford, and such other special rules as the Commissioner of Public Infrastructure and/or City Engineer may deem necessary

Duarte M. Andrade Acting City Engineer

Signature of Property Owner or Representative

INSPECTOR'S REPORT

INSPECTED BY: KEVIN CORNELL

DATE: 2-26-07

COMMENTS:

APPROVED DISAPPROVED

Kevin S. Cornell

SIGNATURE

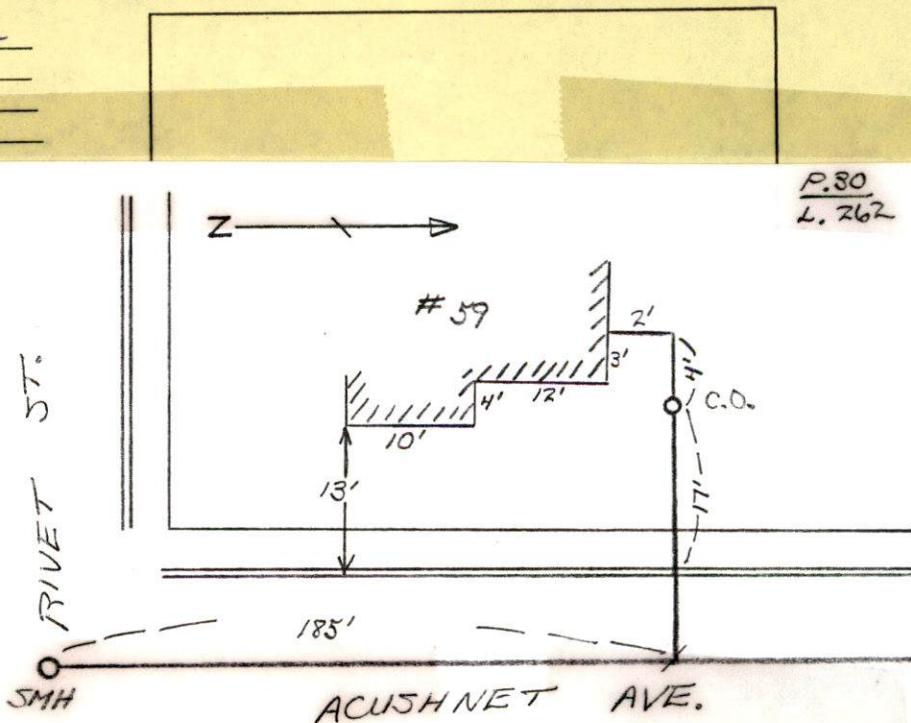



PERMIT NO.

23927

CITY OF NEW BEDFORD
SEWER AND/OR STORM DRAIN PERMIT

DATE 2/2/07

This certifies that permission is granted to

Idalina Oliveira 59 Acushnet Ave NB 508 994 2988
Property Owner Address Tel.

To connect a sewer and/or storm drain located at Acushnet Ave (sewer repair)

Assessor's Plot 30 Lot 262, to the sewer and/or storm drain in Acushnet Ave Street

To be laid in accordance with the conditions in this application and the City of New Bedford ordinances.

TYPE OF USE: ☒ RESIDENTIAL ☐ COMMERCIAL ☐ INDUSTRIAL ☐ OTHER

If applicant other than actual property owner, attach Letter of Authorization from Property Owner.

Name John Rezendes Tel 508-984-1668
Mailing Address 21 East River Dr Dartmouth MA

The Bonded Contractor/Drain Layer authorized to perform this work is:

J.B. Lanagan Co 21 East River Dr Dartmouth
Name Address Tel.

Type of Pipe Required: SDR 35 PVC

PERMIT EXPIRES ONE YEAR AFTER DATE OF ISSUE

- Requires separate connections for sewage and storm drain where applicable. Storm water cannot be discharged to a sanitary sewer.
 - All work must be inspected and approved by a D.P.I. inspector before backfilling.
 - If this connection is to be part of a private service shared jointly with other building owners, attach copy of Recorded Joint Maintenance Agreement.
 - Permits can be issued to Industrial and/or Commercial Applicants only upon receipt and approval by the Commissioner of Public Infrastructure of required plans and supplemental information.
 - In addition, a City-issued Industrial User Discharge Permit and/or a Sewer Extension/Connection Permit issued by the Commonwealth of Massachusetts D.E.P. shall be required by the City for Industrial Discharge into the sewer system.
- Industrial User Discharge Permit No. Date

Comm. Mass. Sewer Conn./Ext. Permit No. Date

A Filing and Inspection Fee of \$150.00 plus an Entrance Fee of \$ where applicable, must accompany this application.

Bank# 17852 Check# Date 2/5/07 Receipt# 6870

Other requirements: 24 hr inspection 508-979-1527

winter rules Relaying complete sewer service to house

Connection made to Sewer Abandon old service YES NO
Storm Drain Part of jointly-shared private line

Applicant agrees to abide by the above terms, as well as all pertinent ordinances of the City of New Bedford, and such other special rules as the Commissioner of Public Infrastructure and/or City Engineer may deem necessary

Quarte M. Andrade Acting City Engineer
Signature of Property Owner or Representative

INSPECTOR'S REPORT

INSPECTED BY:

DATE:

COMMENTS:

APPROVED

DISAPPROVED

SIGNATURE

SKETCH PLAN

SUNNY 20°

2-06-07 TUES

52

59 ACUSHNET AVE

PERMIT # 23927

CONTRACTOR: J.B. LAMAGAN

508-984-1668

