



PERMIT NO.

23926

CITY OF NEW BEDFORD  
SEWER AND/OR STORM DRAIN PERMIT

DATE 1/31/07

This certifies that permission is granted to

Walter Dasilva  
Cafe Funchal Real Est. 123 Church St. 508-990-1886  
Property Owner Address Tel.

To connect a sewer and/or storm drain located at (15" storm drain) Church St. and to c.b.

Assessor's Plot 102 Lot 129, to the sewer and/or storm drain in Church St. Street

To be laid in accordance with the conditions in this application and the City of New Bedford ordinances.

TYPE OF USE: RESIDENTIAL COMMERCIAL INDUSTRIAL OTHER restaurant

If applicant other than actual property owner, attach Letter of Authorization from Property Owner.

Name Michael Bachstein Tel.

Mailing Address 1289 Reed Rd. Dartmouth

The Bonded Contractor/Drain Layer authorized to perform this work is:

W.C. Smith 58 Ridgewood Rd. N.B. MA 508-9951449

Name Address Tel.

Type of Pipe Required: SDR 35 PVC

## PERMIT EXPIRES ONE YEAR AFTER DATE OF ISSUE

- Requires separate connections for sewage and storm drain where applicable. Storm water cannot be discharged to a sanitary sewer.
  - All work must be inspected and approved by a D.P.I. inspector before backfilling.
  - If this connection is to be part of a private service shared jointly with other building owners, attach copy of Recorded Joint Maintenance Agreement.
  - Permits can be issued to Industrial and/or Commercial Applicants only upon receipt and approval by the Commissioner of Public Infrastructure of required plans and supplemental information.
  - In addition, a City-issued Industrial User Discharge Permit and/or a Sewer Extension/Connection Permit issued by the Commonwealth of Massachusetts D.E.P. shall be required by the City for Industrial Discharge into the sewer system.
- Industrial User Discharge Permit No. .... Date .....

Comm. Mass. Sewer Conn./Ext. Permit No. .... Date .....

A Filing and Inspection Fee of \$150.00 plus an Entrance Fee of \$..... where applicable, must accompany this application.

Bank# Bank 5 Check# 2770 Date 1/31/07 Receipt# 6858

Other requirements: see attached plan

Connection made to Sewer Part of jointly-shared private line YES NO  
Storm Drain

Applicant agrees to abide by the above terms, as well as all pertinent ordinances of the City of New Bedford, and such other special rules as the Commissioner of Public Infrastructure and/or City Engineer may deem necessary

Acting City Engineer

Signature of Property Owner or Representative

## INSPECTOR'S REPORT

INSPECTED BY: \_\_\_\_\_

DATE: \_\_\_\_\_

COMMENTS: \_\_\_\_\_

APPROVED

DISAP

SIGNATURE

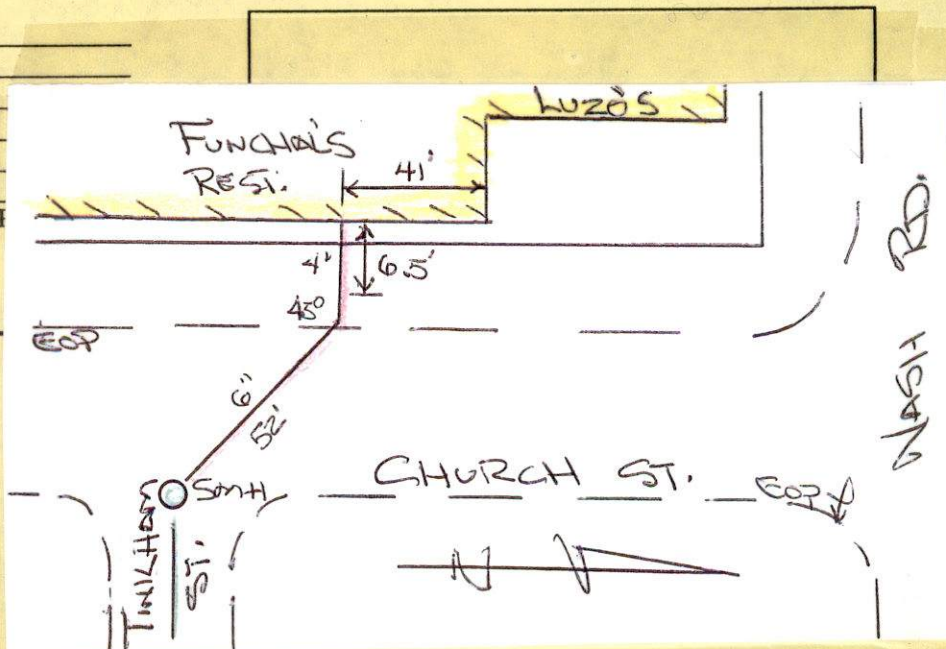



PERMIT NO.

CITY OF NEW BEDFORD  
SEWER AND/OR STORM DRAIN PERMIT

DATE 1/31/07

23926

This certifies that permission is granted to

Quarte DaSilva  
Cafe Funchal Real Est 123 Church St 508-990-1886  
Property Owner Address Tel.

To connect a sewer and/or storm drain located at (1.5" storm drain) Church St and to c.b.

Assessor's Plot 102 Lot 129, to the sewer and/or storm drain in Church St Street

To be laid in accordance with the conditions in this application and the City of New Bedford ordinances.

TYPE OF USE: RESIDENTIAL COMMERCIAL INDUSTRIAL OTHER restaurant

If applicant other than actual property owner, attach Letter of Authorization from Property Owner.

Name Michael Bachstein Tel. \_\_\_\_\_

Mailing Address 1289 Reed Rd Dartmouth

The Bonded Contractor/Drain Layer authorized to perform this work is:

W. C. Smith 58 Ridgewood Rd N.B. MA 508-9951449

Name Address Tel.

Type of Pipe Required: S.D.R. 35 PVC

PERMIT EXPIRES ONE YEAR AFTER DATE OF ISSUE

- Requires separate connections for sewage and storm drain where applicable. Storm water cannot be discharged to a sanitary sewer.
- All work must be inspected and approved by a D.P.I. inspector before backfilling.
- If this connection is to be part of a private service shared jointly with other building owners, attach copy of Recorded Joint Maintenance Agreement.
- Permits can be issued to Industrial and/or Commercial Applicants only upon receipt and approval by the Commissioner of Public Infrastructure of required plans and supplemental information.
- In addition, a City-issued Industrial User Discharge Permit and/or a Sewer Extension/Connection Permit issued by the Commonwealth of Massachusetts D.E.P. shall be required by the City for Industrial Discharge into the sewer system.

Industrial User Discharge Permit No. \_\_\_\_\_ Date \_\_\_\_\_

Comm. Mass. Sewer Conn./Ext. Permit No. \_\_\_\_\_ Date \_\_\_\_\_

A Filing and Inspection Fee of \$150.00 plus an Entrance Fee of \$ \_\_\_\_\_ where applicable, must accompany this application.

Bank# Bank 5 Check# 2770 Date 1/31/07 Receipt# 6858

Other requirements: see attached plan

Connection made to Sewer Part of jointly-shared private line YES NO  
Storm Drain

Applicant agrees to abide by the above terms, as well as all pertinent ordinances of the City of New Bedford, and such other special rules as the Commissioner of Public Infrastructure and/or City Engineer may deem necessary

Quarte M. Andrade  
Acting City Engineer mr

[Signature]  
Signature of Property Owner or Representative

INSPECTOR'S REPORT

INSPECTED BY: [Signature]  
DATE: 3/13/07  
COMMENTS: \_\_\_\_\_

APPROVED \_\_\_\_\_ DISAPPROVED \_\_\_\_\_

[Signature]  
SIGNATURE

Monday 3/12/07  
1 pm  
Lots of utilities in the way.  
He will call if not  
ready by 1 pm.

SKETCH PLAN



3/12/07 inspected

PERMIT NO.

CITY OF NEW BEDFORD  
SEWER AND/OR STORM DRAIN PERMIT

DATE 1/31/07

- 23926

This certifies that permission is granted to

Quarte DaSilva  
Cafe Funchal Real Est 123 Church St. 508-990-1886

Property Owner

Address

Tel.

to be relayed on Church St. from Tinkham St. to Bldg.  
To connect a sewer and/or storm drain located at... (15" storm drain) Church St. and to c.b.

Assessor's Plot 102 Lot 129, to the sewer and/or storm drain in... Church St. Street

To be laid in accordance with the conditions in this application and the City of New Bedford ordinances.

TYPE OF USE: RESIDENTIAL COMMERCIAL INDUSTRIAL OTHER restaurant

If applicant other than actual property owner, attach Letter of Authorization from Property Owner.

Name... Michael Bachstein Tel. ....

Mailing Address... 1289 Reed Rd. Dartmouth

The Bonded Contractor/Drain Layer authorized to perform this work is:

W.C. Smith 58 Ridgewood Rd. N.B. MA 508-9951449

Name

Address

Tel.

Type of Pipe Required: S.D.R. 35 P.V.C.

PERMIT EXPIRES ONE YEAR AFTER DATE OF ISSUE

- Requires separate connections for sewage and storm drain where applicable. Storm water cannot be discharged to a sanitary sewer.
  - All work must be inspected and approved by a D.P.I. inspector before backfilling.
  - If this connection is to be part of a private service shared jointly with other building owners, attach copy of Recorded Joint Maintenance Agreement.
  - Permits can be issued to Industrial and/or Commercial Applicants only upon receipt and approval by the Commissioner of Public Infrastructure of required plans and supplemental information.
  - In addition, a City-issued Industrial User Discharge Permit and/or a Sewer Extension/Connection Permit issued by the Commonwealth of Massachusetts D.E.P. shall be required by the City for Industrial Discharge into the sewer system.
- Industrial User Discharge Permit No. .... Date .....

Comm. Mass. Sewer Conn./Ext. Permit No. .... Date .....

A Filing and Inspection Fee of \$150.00, plus an Entrance Fee of \$... where applicable, must accompany this application.

Bank# Bank 5 Check# 2770 Date 1/31/07 Receipt# 6858

Other requirements: see attached plan

Connection made to Sewer Part of jointly-shared private line YES NO  
Storm Drain

Applicant agrees to abide by the above terms, as well as all pertinent ordinances of the City of New Bedford, and such other special rules as the Commissioner of Public Infrastructure and/or City Engineer may deem necessary

Quarte M. Andrade  
Acting City Engineer mn

[Signature]  
Signature of Property Owner or Representative

INSPECTOR'S REPORT

INSPECTED BY: \_\_\_\_\_

DATE: \_\_\_\_\_

COMMENTS: \_\_\_\_\_

\_\_\_\_\_

\_\_\_\_\_

APPROVED

DISAPPROVED

SIGNATURE

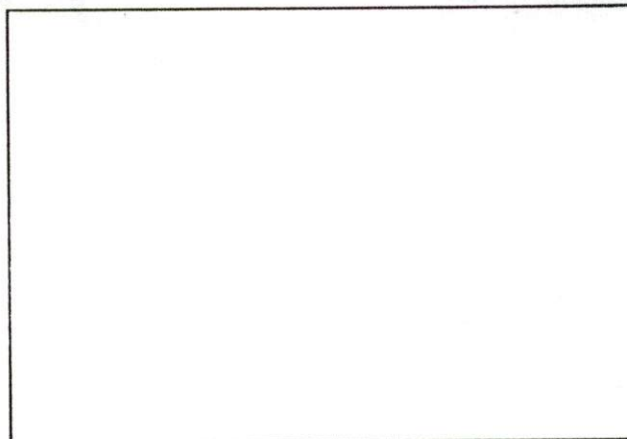

SKETCH PLAN

**Café Funchal**  
**1686 Acushnet Avenue**  
**New Bedford, MA 02746**  
**508-990-1886**

January 31, 2007

By Facsimile: 508-991-6152

ATTN: Mary

I, Duarte DaSilva, President of Café Funchal give authorization to Michael Bachstein to pull permits with regards to the development of the Church Street project.

Should you need any further information please feel free to call me at 508-509-1388.

Very truly yours,

  
Duarte DaSilva

DS

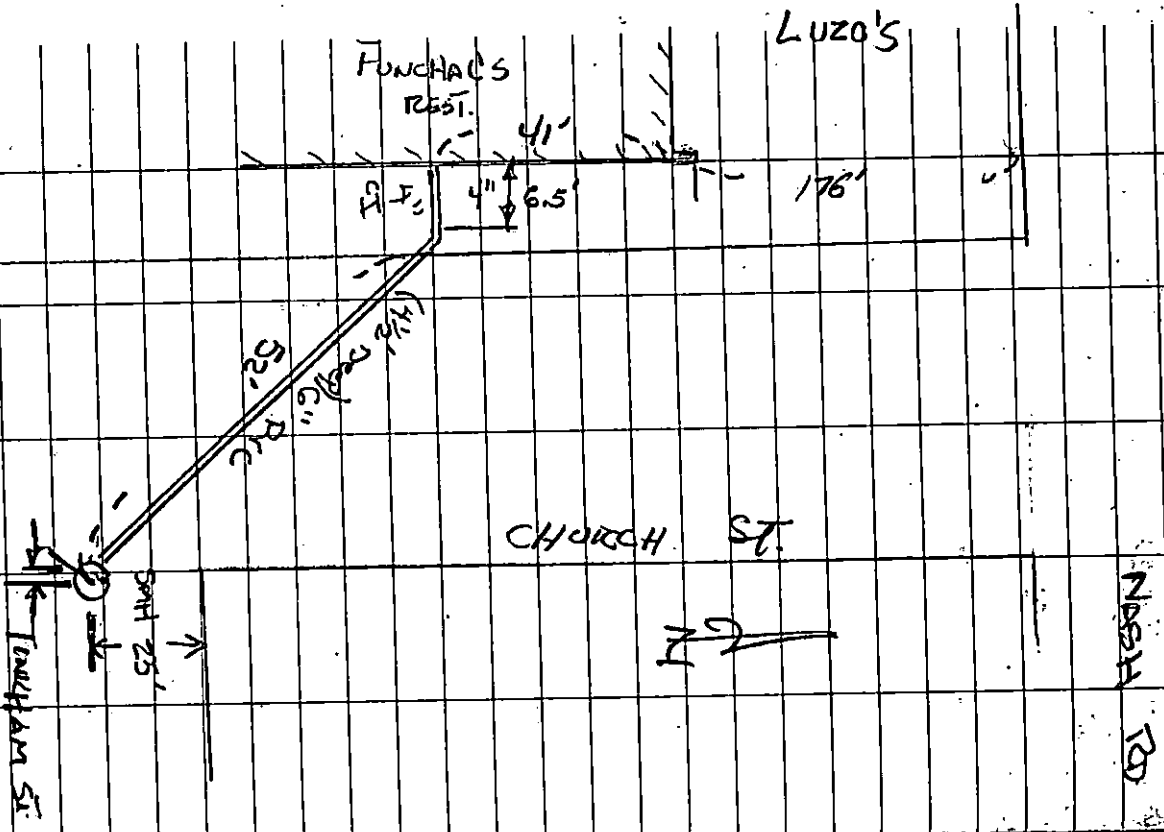

NASH RD

DATE FUNCHAL  
120 CHURCH ST.  
SEWER LINE IN  
ADDITION 230' NG  
CONTRACTOR W.C. SMITH

3/13/07  
BIB.die