



PERMIT NO.
23888

CITY OF NEW BEDFORD
SEWER AND/OR STORM DRAIN PERMIT

DATE 9/7/06

This certifies that permission is granted to

Walter Cunha 39 Pine Ridge St. NB 508 993 6849
Property Owner Address Tel.

To connect a sewer and/or storm drain located at stub at 39 Pine Ridge St.

Assessor's Plot 121 Lot 22, to the sewer and/or storm drain in Pine Ridge St. Street

To be laid in accordance with the conditions in this application and the City of New Bedford ordinances.

TYPE OF USE: ☒ RESIDENTIAL ☐ COMMERCIAL ☐ INDUSTRIAL ☐ OTHER

3309pd.

If applicant other than actual property owner, attach Letter of Authorization from Property Owner.

Name Tel.

Mailing Address

The Bonded Contractor/Drain Layer authorized to perform this work is:

Franklin Bros 4393 Acushnet Ave NB 508 998 8270

Name Address Tel.

Type of Pipe Required: SDR 35 PVC

PERMIT EXPIRES ONE YEAR AFTER DATE OF ISSUE

- Requires separate connections for sewage and storm drain where applicable. Storm water cannot be discharged to a sanitary sewer.
- All work must be inspected and approved by a D.P.I. inspector before backfilling.
- If this connection is to be part of a private service shared jointly with other building owners, attach copy of Recorded Joint Maintenance Agreement.
- Permits can be issued to Industrial and/or Commercial Applicants only upon receipt and approval by the Commissioner of Public Infrastructure of required plans and supplemental information.
- In addition, a City-issued Industrial User Discharge Permit and/or a Sewer Extension/Connection Permit issued by the Commonwealth of Massachusetts D.E.P. shall be required by the City for Industrial Discharge into the sewer system.

Industrial User Discharge Permit No. Date.

Comm. Mass. Sewer Conn./Ext. Permit No. Date.

A Filing and Inspection Fee of \$150.00 plus an Entrance Fee of \$550.00 where applicable, must accompany this application.

Bank# Citizens Bank Check# 708 Date 9/7/06 Receipt# 6625

Other requirements: 24 hr. inspection at 508 979 1527

Connection made to Sewer Part of jointly-shared private line YES NO
Storm Drain

Applicant agrees to abide by the above terms, as well as all pertinent ordinances of the City of New Bedford, and such other special rules as the Commissioner of Public Infrastructure and/or City Engineer may deem necessary

Duarte M. Andradef
Acting City Engineer

Gerda Cunha
Signature of Property Owner or Representative

INSPECTED BY: KEVIN COR
DATE: 11-02-06
COMMENTS:

APPROVED DISAPPR

Kevin J. Cor
SIGNATURE

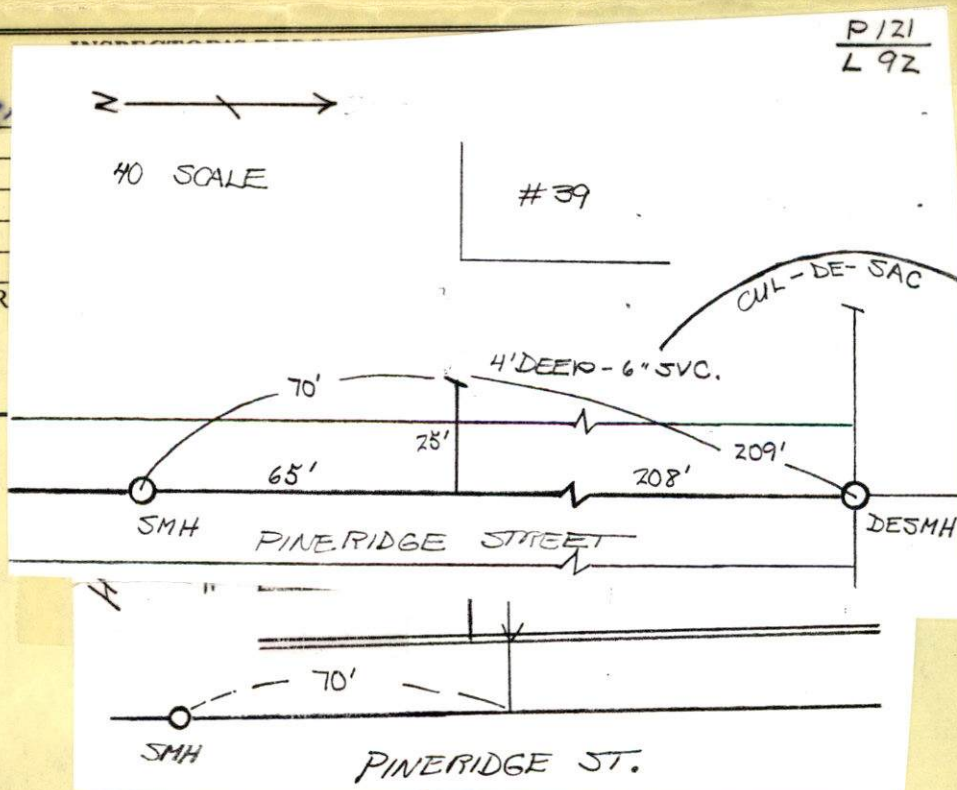

Zaid 45°

THURSDAY 18-02-06

(25)

#39 PINE RIDGE ST

PERMIT # 2388

CONTRACTOR # FRANKLIN BROS.

508-998-8270

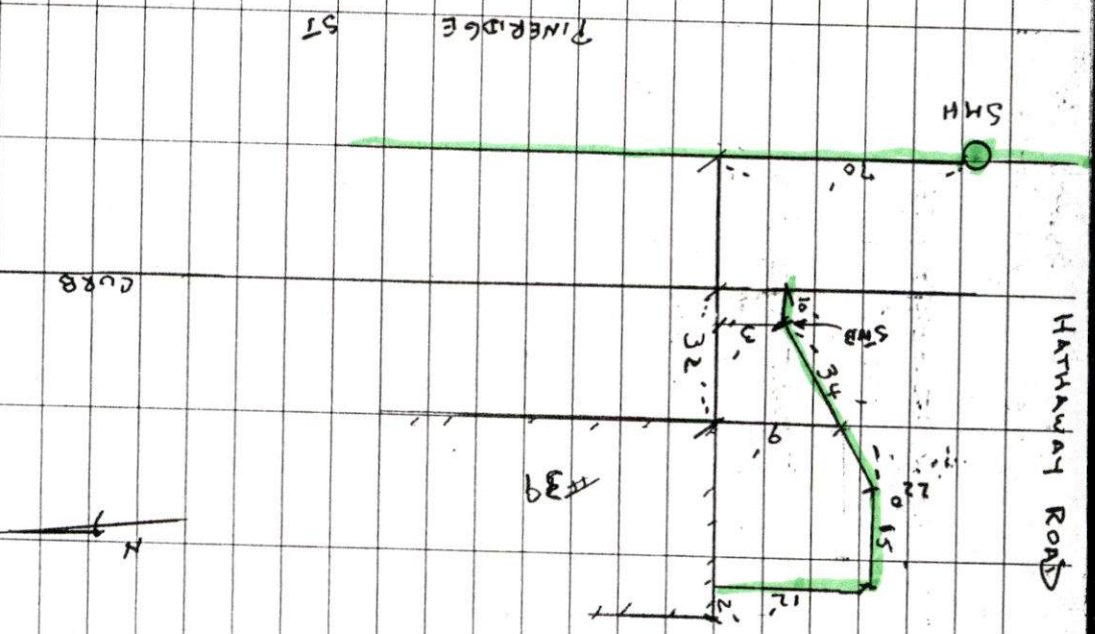



PERMIT NO.
23888

CITY OF NEW BEDFORD
SEWER AND/OR STORM DRAIN PERMIT

DATE 9/7/06

This certifies that permission is granted to

Walter Cunha 39 Pine Ridge St. NB 508 993 6849
Property Owner Address Tel.

To connect a sewer and/or storm drain located at stub at 39 Pine Ridge St.

Assessor's Plot 121 Lot 92, to the sewer and/or storm drain in Pine Ridge St. Street

To be laid in accordance with the conditions in this application and the City of New Bedford ordinances.

TYPE OF USE: ☒ RESIDENTIAL ☐ COMMERCIAL ☐ INDUSTRIAL ☐ OTHER

330 gpd.

If applicant other than actual property owner, attach Letter of Authorization from Property Owner.

Name.....Tel.....

Mailing Address.....

The Bonded Contractor/Drain Layer authorized to perform this work is:

Franklin Bros 4393 Acushnet Ave NB 508 998 8270
Name Address Tel.

Type of Pipe Required: SDR 35 PVC

PERMIT EXPIRES ONE YEAR AFTER DATE OF ISSUE

- Requires separate connections for sewage and storm drain where applicable. Storm water cannot be discharged to a sanitary sewer.
 - All work must be inspected and approved by a D.P.I. inspector before backfilling.
 - If this connection is to be part of a private service shared jointly with other building owners, attach copy of Recorded Joint Maintenance Agreement.
 - Permits can be issued to Industrial and/or Commercial Applicants only upon receipt and approval by the Commissioner of Public Infrastructure of required plans and supplemental information.
 - In addition, a City-issued Industrial User Discharge Permit and/or a Sewer Extension/Connection Permit issued by the Commonwealth of Massachusetts D.E.P. shall be required by the City for Industrial Discharge into the sewer system.
- Industrial User Discharge Permit No. Date

Comm. Mass. Sewer Conn./Ext. Permit No. Date

A Filing and Inspection Fee of \$150.00 plus an Entrance Fee of \$550.00 where applicable, must accompany this application.

Bank# Citizens Bank Check# 708 Date 9/7/06 Receipt# 6625

Other requirements: 24 hr inspection at 508 979 1527

Connection made to Sewer Part of jointly-shared private line YES NO
Storm Drain

Applicant agrees to abide by the above terms, as well as all pertinent ordinances of the City of New Bedford, and such other special rules as the Commissioner of Public Infrastructure and/or City Engineer may deem necessary

Quante M. Andrades
Acting City Engineer

Gerda Cunha
Signature of Property Owner or Representative

INSPECTOR'S REPORT

INSPECTED BY: _____
DATE: _____
COMMENTS: _____

APPROVED _____ DISAPPROVED _____

SIGNATURE

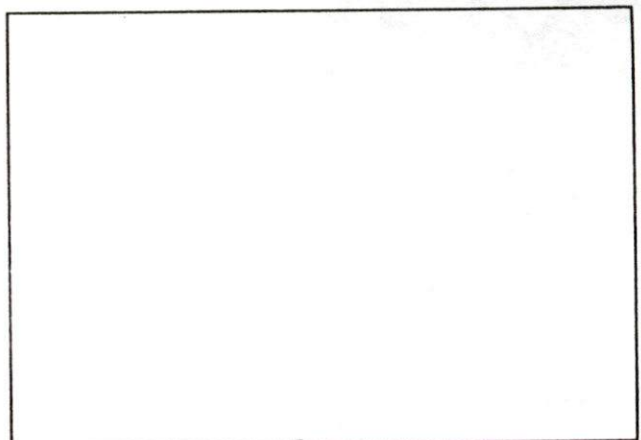

SKETCH PLAN

TRANSMISSION VERIFICATION REPORT

TIME : 09/08/2006 08:28
NAME : DPI WATER WASTEWATER
FAX : 5089916152
TEL : 5089916152

DATE, TIME	09/08 08:27
FAX NO. / NAME	3143
DURATION	00:00:47
PAGE(S)	01
RESULT	OK
MODE	STANDARD
	ECM

fixed to health

Carol Sherman

From: Sarah Porter
Sent: Thursday, September 07, 2006 6:02 PM
To: Carol Sherman
Subject: RE: SEWER TIE-IN

Carol,

39 Pine Ridge is all set - no conservation issues

Thank you

-----Original Message-----

From: Carol Sherman
Sent: Thursday, September 07, 2006 10:25 AM
To: Sarah Porter
Subject: SEWER TIE-IN

SARAH
THE PROPERTY OWNER OF 39 PINE RIDGE ST. WOULD LIKE TO CONNECT TO OUR SEWER SYSTEM. THE
PLOT IS #121 AND THE LOT IS 92.

MAY WE ISSUE A PERMIT?

THANKS FOR YOUR ASSISTANCE.

CAROL