

PERMIT NO.

23869

CITY OF NEW BEDFORD  
SEWER AND/OR STORM DRAIN PERMIT

DATE 7/27/06

This certifies that permission is granted to

ANDRE FEUDASZ 3863 ACUSHNET AVE NEW BEDFORD MA  
Property Owner Address Tel. 508-995-7310

To connect a sewer and/or storm drain located at ACUSHNET AVE STUB

Assessor's Plot 136 Lot 21, to the sewer and/or storm drain in ACUSHNET AVE Street

To be laid in accordance with the conditions in this application and the City of New Bedford ordinances.

TYPE OF USE: RESIDENTIAL COMMERCIAL INDUSTRIAL OTHER

If applicant other than actual property owner, attach Letter of Authorization from Property Owner.

Name Tel.

Mailing Address

The Bonded Contractor/Drain Layer authorized to perform this work is:

Duff Plumbing & Heating

Name Address Tel.

Type of Pipe Required: PVC SDR PIPE TO EXISTING STUB

PERMIT EXPIRES ONE YEAR AFTER DATE OF ISSUE

- Requires separate connections for sewage and storm drain where applicable. Storm water cannot be discharged to a sanitary sewer.
- All work must be inspected and approved by a D.P.I. inspector before backfilling.
- If this connection is to be part of a private service shared jointly with other building owners, attach copy of Recorded Joint Maintenance Agreement.
- Permits can be issued to Industrial and/or Commercial Applicants only upon receipt and approval by the Commissioner of Public Infrastructure of required plans and supplemental information.
- In addition, a City-issued Industrial User Discharge Permit and/or a Sewer Extension/Connection Permit issued by the Commonwealth of Massachusetts D.E.P. shall be required by the City for Industrial Discharge into the sewer system.

Industrial User Discharge Permit No. NA Date

Comm. Mass. Sewer Conn./Ext. Permit No. NA Date

A Filing and Inspection Fee of \$150, plus an Entrance Fee of \$750, where applicable, must accompany this application.

Bank# VB CREDIT UNION Check# 144121 Date 7-27-06 Receipt#

Other requirements: INSPECTION ONLY - ACUSHNET AVE SEWER EXT 2

STUB AT PROPERTY LINE 30 FT @ 25.00 = 750.00 + PERMIT 150.00

Connection made to Sewer Part of jointly-shared private line YES NO  
Storm Drain

Applicant agrees to abide by the above terms, as well as all pertinent ordinances of the City of New Bedford, and such other special rules as the Commissioner of Public Infrastructure and/or City Engineer may deem necessary

City Engineer

Signature of Property Owner or Representative

INSPECTOR'S REPORT

INSPECTED BY: KEVIN CORNELL

DATE: 7-28-06

COMMENTS:

APPROVED

DISAPPROVED

SIGNATURE

APBAUTO CT.

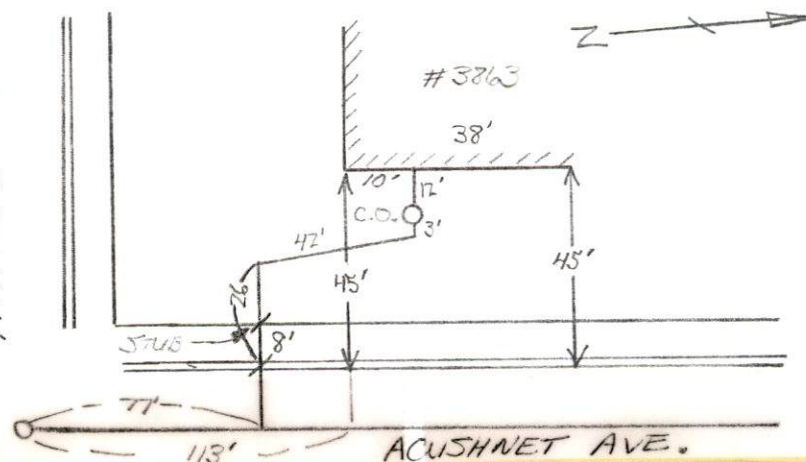

P. 136  
L. 21





PERMIT NO.  
23869

CITY OF NEW BEDFORD  
SEWER AND/OR STORM DRAIN PERMIT

DATE 7/27/06

This certifies that permission is granted to

ANDRE FELDASZ 3863 AUSHNET AVE New Bedford MA  
Property Owner Address Tel. 508-995-7310

To connect a sewer and/or storm drain located at AUSHNET AVE STUB

Assessor's Plot 36 Lot 98, to the sewer and/or storm drain in AUSHNET AVE Street

To be laid in accordance with the conditions in this application and the City of New Bedford ordinances.

TYPE OF USE: RESIDENTIAL COMMERCIAL INDUSTRIAL OTHER

If applicant other than actual property owner, attach Letter of Authorization from Property Owner.

Name Tel.

Mailing Address

The Bonded Contractor/Drain Layer authorized to perform this work is:

Duff Plumbing & Heating  
Name Address Tel.

Type of Pipe Required: PVC - SD PIPE TO EXISTING STUB

PERMIT EXPIRES ONE YEAR AFTER DATE OF ISSUE

- Requires separate connections for sewage and storm drain where applicable. Storm water cannot be discharged to a sanitary sewer.
- All work must be inspected and approved by a D.P.I. inspector before backfilling.
- If this connection is to be part of a private service shared jointly with other building owners, attach copy of Recorded Joint Maintenance Agreement.
- Permits can be issued to Industrial and/or Commercial Applicants only upon receipt and approval by the Commissioner of Public Infrastructure of required plans and supplemental information.
- In addition, a City-issued Industrial User Discharge Permit and/or a Sewer Extension/Connection Permit issued by the Commonwealth of Massachusetts D.E.P. shall be required by the City for Industrial Discharge into the sewer system.

Industrial User Discharge Permit No. N/A Date

Comm. Mass. Sewer Conn./Ext. Permit No. N/A Date

A Filing and Inspection Fee of \$150, plus an Entrance Fee of \$750 where applicable, must accompany this application.

Bank# VB CREDIT UNION Check# 144121 Date 7-27-06 Receipt#

Other requirements: INSPECTION ONLY - AUSHNET AVE SEWER EXT. 2

STUB AT PROPERTY LINE 30 FT C 25.00 = 750.00 + PERMIT 150.00

Connection made to Sewer Part of jointly-shared private line YES NO  
Storm Drain

Applicant agrees to abide by the above terms, as well as all pertinent ordinances of the City of New Bedford, and such other special rules as the Commissioner of Public Infrastructure and/or City Engineer may deem necessary

City Engineer

Signature of Property Owner or Representative

INSPECTOR'S REPORT

INSPECTED BY:  
DATE:  
COMMENTS:

APPROVED DISAPPROVED

SIGNATURE

SKETCH PLAN



ACUSHNET AVE

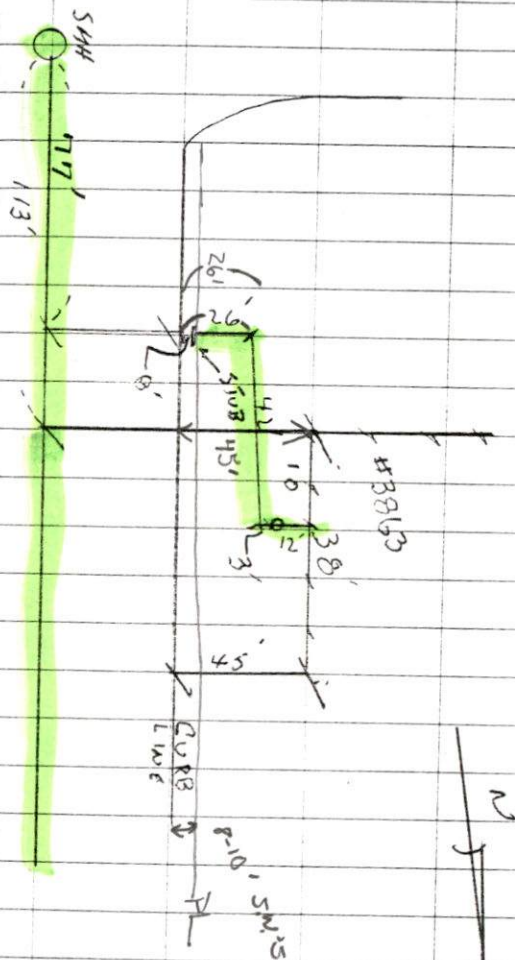

## CONTRACTOR A GAMES