

(66)

SUNNY 80°
7-28-06

FRIDAY

#199 ROWE ST

PERMIT #23866

CONTRACTOR - JOE AUGUST

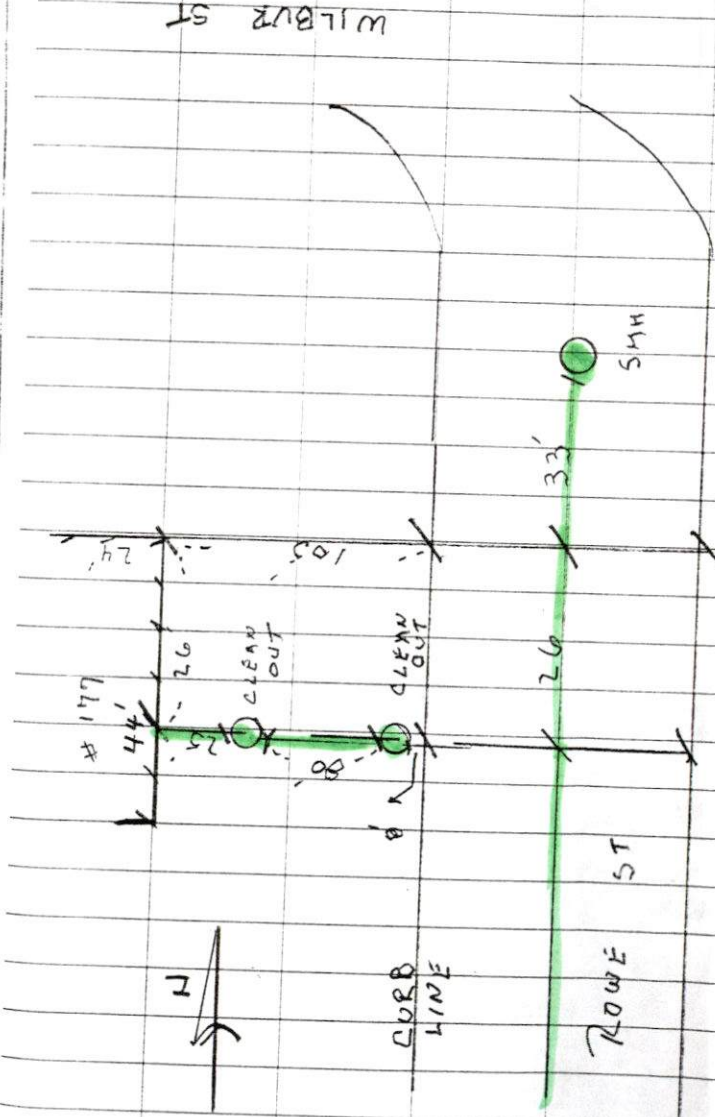



PERMIT NO.

- 23866

CITY OF NEW BEDFORD
SEWER AND/OR STORM DRAIN PERMIT

DATE 7/26/06

EXP. 7/26/07

This certifies that permission is granted to

James Mitchell 177 Rowe St NB, MA 508-996 9603
Property Owner Address Tel.

To connect a sewer and/or storm drain located at 177 Rowe St

Assessor's Plot 87 Lot 37, to the sewer and/or storm drain in Rowe St Street

To be laid in accordance with the conditions in this application and the City of New Bedford ordinances.

TYPE OF USE: RESIDENTIAL COMMERCIAL INDUSTRIAL OTHER 330 GPD

If applicant other than actual property owner, attach Letter of Authorization from Property Owner.

Name Tel.

Mailing Address

The Bonded Contractor/Drain Layer authorized to perform this work is:

Joe August

Name Address Tel.

Type of Pipe Required: PVC SDR-35

PERMIT EXPIRES ONE YEAR AFTER DATE OF ISSUE

- Requires separate connections for sewage and storm drain where applicable. Storm water cannot be discharged to a sanitary sewer.
 - All work must be inspected and approved by a D.P.I. inspector before backfilling.
 - If this connection is to be part of a private service shared jointly with other building owners, attach copy of Recorded Joint Maintenance Agreement.
 - Permits can be issued to Industrial and/or Commercial Applicants only upon receipt and approval by the Commissioner of Public Infrastructure of required plans and supplemental information.
 - In addition, a City-issued Industrial User Discharge Permit and/or a Sewer Extension/Connection Permit issued by the Commonwealth of Massachusetts D.E.P. shall be required by the City for Industrial Discharge into the sewer system.
- Industrial User Discharge Permit No. Date

Comm. Mass. Sewer Conn./Ext. Permit No. Date

A Filing and Inspection Fee of \$150, plus an Entrance Fee of \$279.30 where applicable, must accompany this application. 439.30

Bank# Sovereign Check# 644 Date 7/26/06 Receipt# 6473

Other requirements: Insp. Only - Connect to Stub at Prop Line

Abandon Septic System

Connection made to Sewer Storm Drain Part of jointly-shared private line YES NO

Applicant agrees to abide by the above terms, as well as all pertinent ordinances of the City of New Bedford, and such other special rules as the Commissioner of Public Infrastructure and/or City Engineer may deem necessary

Duarte M. Andrade Acting City Engineer James E. Mitchell Signature of Property Owner or Representative

INSPECTOR'S REPORT

INSPECTED BY:

DATE:

COMMENTS:

APPROVED

DISAPPROVED

SIGNATURE

SKETCH PLAN

7/26/06 Sent to May, Health Dept

Mary T. Neves

From: Sarah Porter
Sent: Thursday, March 16, 2006 11:17 AM
To: Mary T. Neves
Subject: RE: sewer permit

Rowe street is ok - no wetlands

-----Original Message-----

From: Mary T. Neves
Sent: Wednesday, March 15, 2006 11:31 AM
To: Sarah Porter
Subject: sewer permit

Hi,

The owner of 177 Rowe Street would like to tie into the sewer system. Plot 87 Lot 37

We have a stub to the property line.

May I issue this permit?

Thank you

Park/Cemetery Dept. employee