



PERMIT NO.

23841

CITY OF NEW BEDFORD
SEWER AND/OR STORM DRAIN PERMIT

DATE 6/8/06

This certifies that permission is granted to

Pedro Fernandes 15 Covell St. NB 508 998 9648
Property Owner Address Tel.

To connect a sewer and/or storm drain located at 1102 Marlborough St.

Assessor's Plot 132H Lot 348, to the sewer and/or storm drain in Marlborough Street

To be laid in accordance with the conditions in this application and the City of New Bedford ordinances.

TYPE OF USE: ☒ RESIDENTIAL ☐ COMMERCIAL ☐ INDUSTRIAL ☐ OTHER 1109pd.

If applicant other than actual property owner, attach Letter of Authorization from Property Owner.

Name..... Tel.....

Mailing Address.....

The Bonded Contractor/Drain Layer authorized to perform this work is:

Joe Luiz Dartmouth

Name Address Tel.

Type of Pipe Required: SDR 35 PVC

PERMIT EXPIRES ONE YEAR AFTER DATE OF ISSUE

- Requires separate connections for sewage and storm drain where applicable. Storm water cannot be discharged to a sanitary sewer.
- All work must be inspected and approved by a D.P.I. inspector before backfilling.
- If this connection is to be part of a private service shared jointly with other building owners, attach copy of Recorded Joint Maintenance Agreement.
- Permits can be issued to Industrial and/or Commercial Applicants only upon receipt and approval by the Commissioner of Public Infrastructure of required plans and supplemental information.
- In addition, a City-issued Industrial User Discharge Permit and/or a Sewer Extension/Connection Permit issued by the Commonwealth of Massachusetts D.E.P. shall be required by the City for Industrial Discharge into the sewer system.

Industrial User Discharge Permit No..... Date.....

Comm. Mass. Sewer Conn./Ext. Permit No..... Date.....

A Filing and Inspection Fee of \$150.00, plus an Entrance Fee of \$..... where applicable, must accompany this application.

Bank# First Citizens Check# 454003 Date 6/9/06 Receipt# 6329

Other requirements: 24 hr. inspection notice at 508 979 1527

Stub at property line.

Connection made to ☒ Sewer ☐ Storm Drain Part of jointly-shared private line YES ☒ NO

Applicant agrees to abide by the above terms, as well as all pertinent ordinances of the City of New Bedford, and such other special rules as the Commissioner of Public Infrastructure and/or City Engineer may deem necessary

Duarte M. Andrade Acting City Engineer mn Signature of Property Owner or Representative Pedro Fernandes

INSPECTOR'S REPORT

INSPECTED BY: Kevin J. Coyle

DATE: 6-13-06

COMMENTS:

APPROVED DISAPPROVED

Kevin J. Coyle Signature

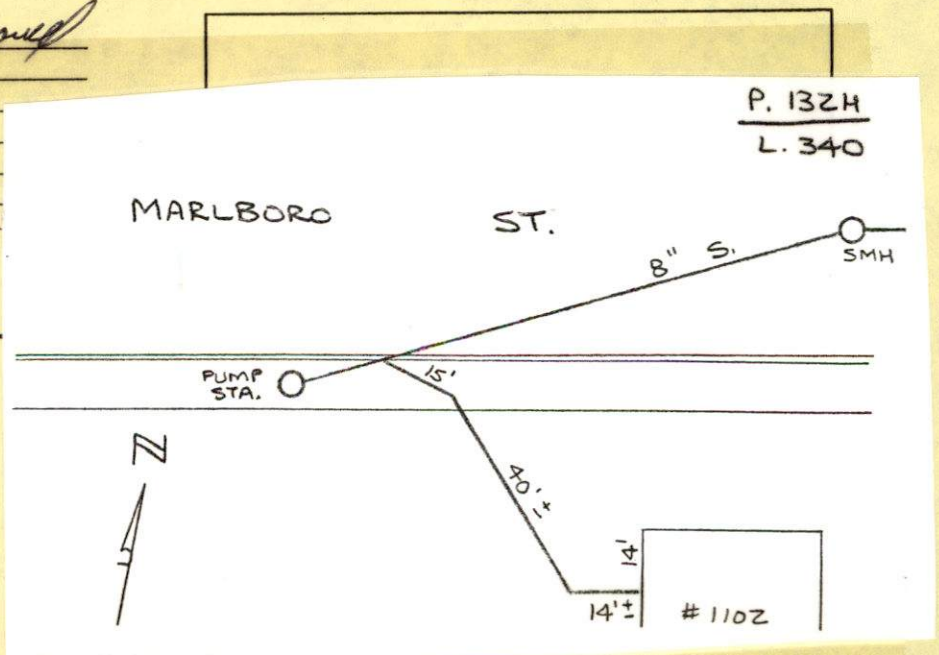



PERMIT NO.

23841

CITY OF NEW BEDFORD
SEWER AND/OR STORM DRAIN PERMIT

DATE 6/8/06

This certifies that permission is granted to

Pedro Fernandes 15 Covell St NB 508.998.9648
Property Owner Address Tel.

To connect a sewer and/or storm drain located at 1102 Marlborough St.

Assessor's Plot 132H Lot 348, to the sewer and/or storm drain in Marlborough Street

To be laid in accordance with the conditions in this application and the City of New Bedford ordinances.

TYPE OF USE: ☒ RESIDENTIAL ☐ COMMERCIAL ☐ INDUSTRIAL ☐ OTHER 110gpd.

If applicant other than actual property owner, attach Letter of Authorization from Property Owner.

Name..... Tel.....

Mailing Address.....

The Bonded Contractor/Drain Layer authorized to perform this work is:

Joe Luiz Pedro Fernandes Dartmouth
Name Address Tel.

Type of Pipe Required: SDR 35 PVC

PERMIT EXPIRES ONE YEAR AFTER DATE OF ISSUE

owner to pay for stub connection an
assessment fee once it has been
determined by the City.

- Requires separate connections for sewage and storm drain where applicable. Storm water cannot be discharged to a sanitary sewer.
- All work must be inspected and approved by a D.P.I. inspector before backfilling.
- If this connection is to be part of a private service shared jointly with other building owners, attach copy of Recorded Joint Maintenance Agreement.
- Permits can be issued to Industrial and/or Commercial Applicants only upon receipt and approval by the Commissioner of Public Infrastructure of required plans and supplemental information.
- In addition, a City-issued Industrial User Discharge Permit and/or a Sewer Extension/Connection Permit issued by the Commonwealth of Massachusetts D.E.P. shall be required by the City for Industrial Discharge into the sewer system.

Industrial User Discharge Permit No..... Date.....

Comm. Mass. Sewer Conn./Ext. Permit No..... Date.....

A Filing and Inspection Fee of \$150.00 plus an Entrance Fee of \$..... where applicable, must accompany this application.

Bank# First Citizens Check# 454003 Date 6/9/06 Receipt# 6329

Other requirements: 24 hr. inspection notice at 508.979.1527.

Stub at property line.

Connection made to ☒ Sewer ☐ Storm Drain Part of jointly-shared private line YES ☐ NO

Applicant agrees to abide by the above terms, as well as all pertinent ordinances of the City of New Bedford, and such other special rules as the Commissioner of Public Infrastructure and/or City Engineer may deem necessary

Duarte M. Andrade
Acting City Engineer mnPedro Fernandes
Signature of Property Owner or Representative

INSPECTOR'S REPORT

INSPECTED BY: _____

DATE: _____

COMMENTS: _____

APPROVED

DISAPPROVED

Pedro Fernandes
SIGNATURE

SKETCH PLAN



CITY OF NEW BEDFORD

16472

NO.

131005

LICENSE NO.

DATE

7/20

20

05

BUILDING PERMIT

MSBC Sect. 110.14 — Any permit issued shall be deemed abandoned and invalid unless the work authorized by it shall have been commenced within six (6) months after its issuance.

This certifies that PEDRO FERNANDES, owner/contractor
has permission to Build a S/F House
on Marlborough St. plot 13H - 342

Providing that the person accepting this permit shall in every respect conform to the terms of the application therefore on file in this office; to the provisions of the statute of the Commonwealth and to the by-laws of the City of New Bedford relating to the inspection, erection, enlarging, altering, raising, moving, repairing, or tearing down of a building.

CITY DEPARTMENT/COMMISSION COMMENTS	BUILDING DEPARTMENT COMMENTS
<p>The following department/commission has expressed concern about the issuance of this permit. You are advised to contact that agency to resolve this matter.</p> <p>Department/Commission: _____</p> <p>Comments: _____</p>	

YOUR AREA INSPECTOR IS:

Thomas Welch

Tel. 979-1540 Between 8:00 AM — 9:00 AM

NOTICE: NOTIFY INSPECTOR 48 HOURS
IN ADVANCE OF APPLYING
SHEATHING OR LATHING

OCCUPANCY PERMIT REQUIRED BEFORE OCCUPANCY

No Building or Structure shall be used or occupied until the Certificate of Use and Occupancy shall have been issued by the Building Commissioner — MSBC, Sect. 120.1 —

THIS CARD MUST BE DISPLAYED IN A CONSPICUOUS PLACE ON THE PREMISES
AND NOT TORN DOWN OR REMOVED UNTIL COMPLETION OF WORK

SUBJECT TO MASSACHUSETTS STATE
BUILDING CODE REQUIREMENTS

Danny D. Romanowicz
BUILDING INSPECTOR

(51)

6-13-06

1102 MARLBORO ST -
SEWER PERMIT # 23841

