



PERMIT NO.
23840

CITY OF NEW BEDFORD
SEWER AND/OR STORM DRAIN PERMIT

DATE 6/7/06
EXP. 6/7/07

This certifies that permission is granted to

Priscilla Imbriglio 898 Maplewood St. NB, MA 508-9986388
Property Owner Address Tel.

To connect a sewer and/or storm drain located at 898 Maplewood St.

Assessor's Plot 130A Lot 553, to the sewer and/or storm drain in Maplewood St. 2" F.m. Street

To be laid in accordance with the conditions in this application and the City of New Bedford ordinances.

TYPE OF USE: RESIDENTIAL COMMERCIAL INDUSTRIAL OTHER 220 GPD

If applicant other than actual property owner, attach Letter of Authorization from Property Owner.

Name..... Tel.....

Mailing Address.....

The Bonded Contractor/Drain Layer authorized to perform this work is:

R. J. Canessa P.O. Box 51643 NB
Name Address Tel.

Type of Pipe Required: 1 1/2" Sch. 40 508 763-4827

PERMIT EXPIRES ONE YEAR AFTER DATE OF ISSUE

- Requires separate connections for sewage and storm drain where applicable. Storm water cannot be discharged to a sanitary sewer.
- All work must be inspected and approved by a D.P.I. inspector before backfilling.
- If this connection is to be part of a private service shared jointly with other building owners, attach copy of Recorded Joint Maintenance Agreement.
- Permits can be issued to Industrial and/or Commercial Applicants only upon receipt and approval by the Commissioner of Public Infrastructure of required plans and supplemental information.
- In addition, a City-issued Industrial User Discharge Permit and/or a Sewer Extension/Connection Permit issued by the Commonwealth of Massachusetts D.E.P. shall be required by the City for Industrial Discharge into the sewer system.

Industrial User Discharge Permit No.....Date.....

Comm. Mass. Sewer Conn./Ext. Permit No.....Date.....

A Filing and Inspection Fee of \$ 150., plus an Entrance Fee of \$..... where applicable, must accompany this application.

Bank# Bank of Fall River Check# 530 Date 6/7/06 Receipt# 6318

Other requirements: Insp. Only - Connect to 2" Force Main, with curb stop at property line + grinder pump. Must Abandon Septic System.

Connection made to Sewer Part of jointly-shared private line YES NO
Storm Drain

Applicant agrees to abide by the above terms, as well as all pertinent ordinances of the City of New Bedford, and such other special rules as the Commissioner of Public Infrastructure and/or City Engineer may deem necessary

Quart M. Andrade (ms)
Acting City Engineer

Priscilla Imbriglio
Signature of Property Owner or Representative

INSPECTOR'S REPORT

INSPECTED BY: _____
DATE: _____
COMMENTS: _____

APPROVED _____ DISAPPROVED _____

SIGNATURE

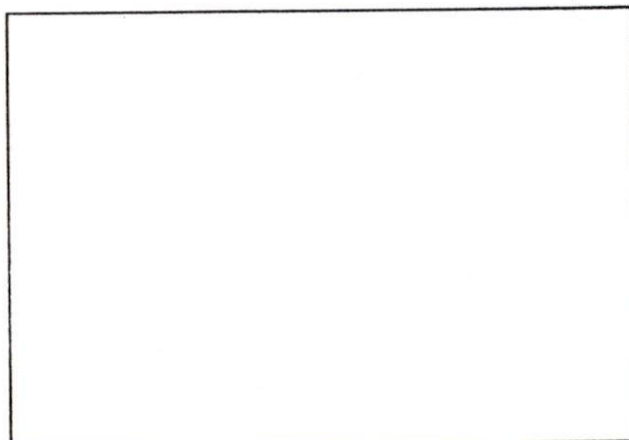

SKETCH PLAN

Mary T. Neves

From: Sarah Porter
Sent: Thursday, June 08, 2006 9:49 AM
To: Mary T. Neves
Subject: RE: sewer tie-in

Mary - they are all set to tie in - no wetland issues

Thank you

Sarah

-----Original Message-----

From: Mary T. Neves
Sent: Wednesday, June 07, 2006 11:02 AM
To: Sarah Porter
Subject: sewer tie-in

Hi Sarah,

The owner of 898 Maplewood St. would like to tie into the sewer system.

The plot is 130A and the lot is 553.

May we issue this permit?

Thanks for your help.

Mary

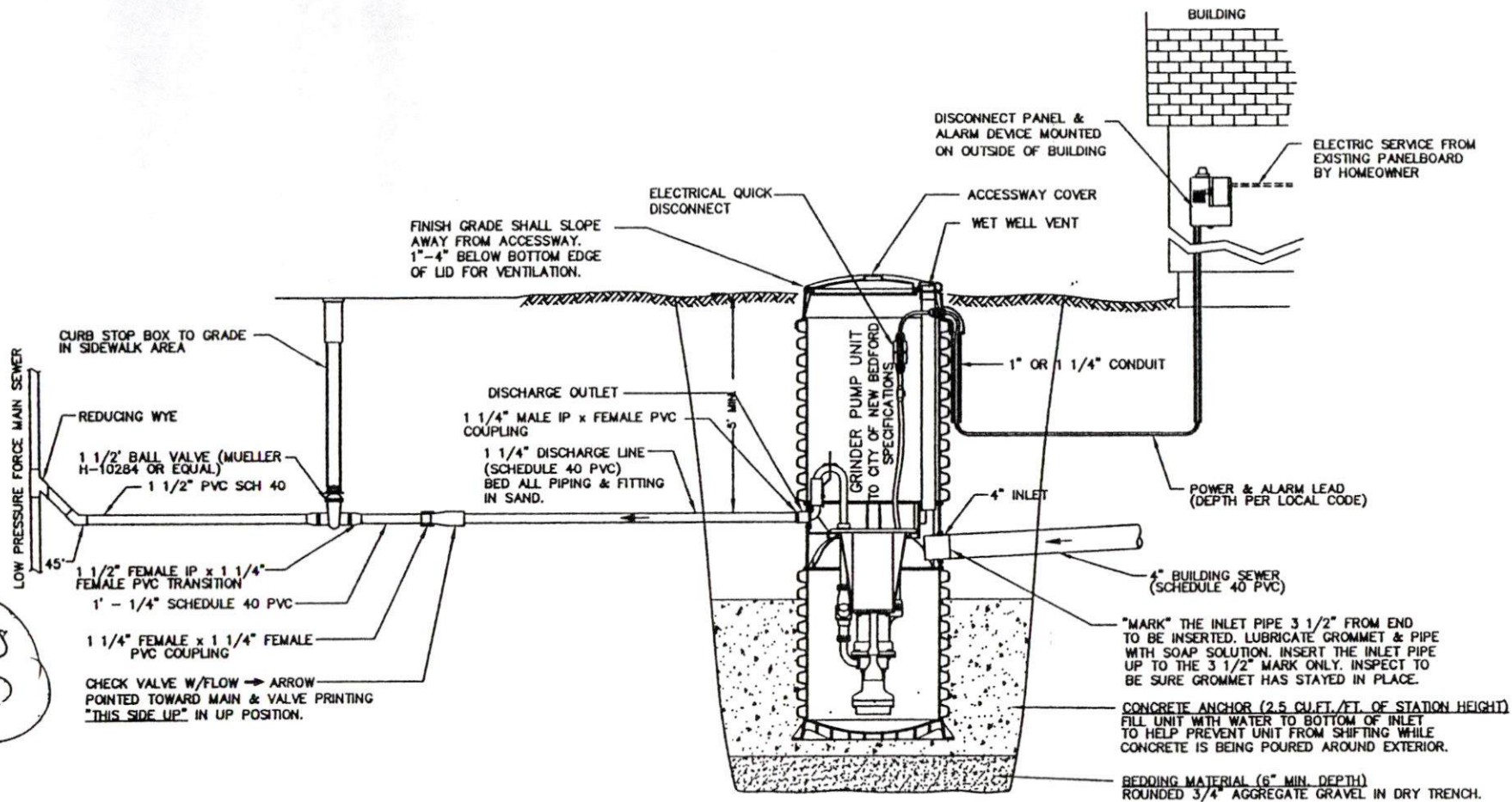

NOTES

1. DO NOT DROP, ROLL OR LAY TANK ON ITS SIDE. THIS WILL DAMAGE UNIT AND VOID THE WARRANTY.
2. THE UNIT SHOULD BE LEVELED, AND THE WET WELL FILLED WITH WATER, TO THE BOTTOM OF THE INLET, TO HELP PREVENT THE UNIT FROM SHIFTING WHILE THE CONCRETE IS BEING POURED.
3. "OATLEY" (DARK GREEN LABEL) ALL WEATHER CEMENT FOR PVC PIPE AND FITTINGS IS TO BE USED, EXCEEDS ASTM D-2564.
4. ELECTRICAL WIRING PER STATE AND LOCAL CODES.
5. 1 1/4" DIAMETER SCHEDULE 40 PRESSURE PIPE MUST HAVE MINIMUM PRESSURE RATING OF 370 PSI WITH A CELL CLASS OF 12454-B.

GRINDER PUMP DETAIL

NOT TO SCALE

#898 MAPLEWOOD ST
SEWER PERMIT #23840

CONTRACTOR #RJ CANESSA

508-763-4027

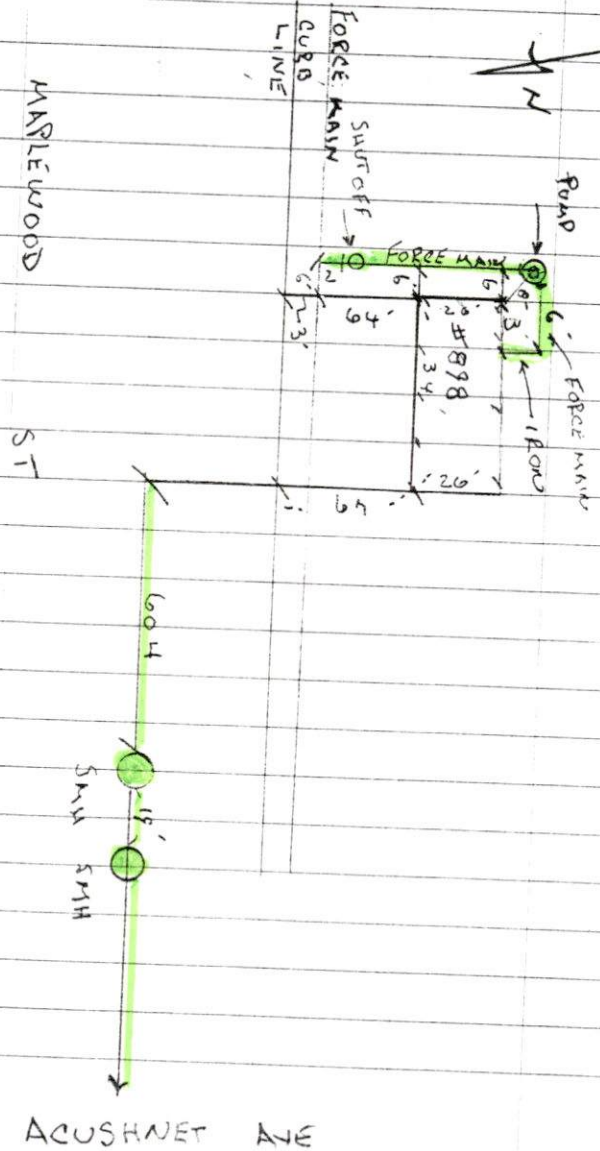

421
QSH
HOR