



PERMIT NO.

23823

CITY OF NEW BEDFORD
SEWER AND/OR STORM DRAIN PERMIT

DATE 5/2/06

This certifies that permission is granted to

Ralph Mulford 158 Chas. McCombs Blvd., N.B. 508 965 8355
Property Owner Address Tel.

To connect a sewer and/or storm drain located at 21 Schooner Ct.

Assessor's Plot 1306 Lot 232, to the sewer and/or storm drain in Schooner Ct. Street

To be laid in accordance with the conditions in this application and the City of New Bedford ordinances.

TYPE OF USE: ☒ RESIDENTIAL ☐ COMMERCIAL ☐ INDUSTRIAL ☐ OTHER 330 gpd

If applicant other than actual property owner, attach Letter of Authorization from Property Owner.

Name Tel.

Mailing Address.

The Bonded Contractor/Drain Layer authorized to perform this work is:

D.W. White Cons. 867 Middle Rd. Acushnet MA

Name Address Tel.

Type of Pipe Required: SDR 35 PVC 508 763 8868

PERMIT EXPIRES ONE YEAR AFTER DATE OF ISSUE

- Requires separate connections for sewage and storm drain where applicable. Storm water cannot be discharged to a sanitary sewer.
- All work must be inspected and approved by a D.P.I. inspector before backfilling.
- If this connection is to be part of a private service shared jointly with other building owners, attach copy of Recorded Joint Maintenance Agreement.
- Permits can be issued to Industrial and/or Commercial Applicants only upon receipt and approval by the Commissioner of Public Infrastructure of required plans and supplemental information.
- In addition, a City-issued Industrial User Discharge Permit and/or a Sewer Extension/Connection Permit issued by the Commonwealth of Massachusetts D.E.P. shall be required by the City for Industrial Discharge into the sewer system.

Industrial User Discharge Permit No. Date

Comm. Mass. Sewer Conn./Ext. Permit No. Date

A Filing and Inspection Fee of \$150.00 plus an Entrance Fee of \$ where applicable, must accompany this application.

Bank# bcp bank Check# 12279 Date 5/2/06 Receipt# 6058

Other requirements: 24 hr inspection 508 979 1527

Connection made to ☒ Sewer ☐ Storm Drain Part of jointly-shared private line YES ☒ NO

Applicant agrees to abide by the above terms, as well as all pertinent ordinances of the City of New Bedford, and such other special rules as the Commissioner of Public Infrastructure and/or City Engineer may deem necessary

Duane M. Anderson
Acting City Engineer

Signature of Property Owner or Representative

INSPECTOR'S REPORT

INSPECTED BY: SEE WHITE SHEET

DATE:

COMMENTS:

APPROVED

DISAPPR

SIGNATURE

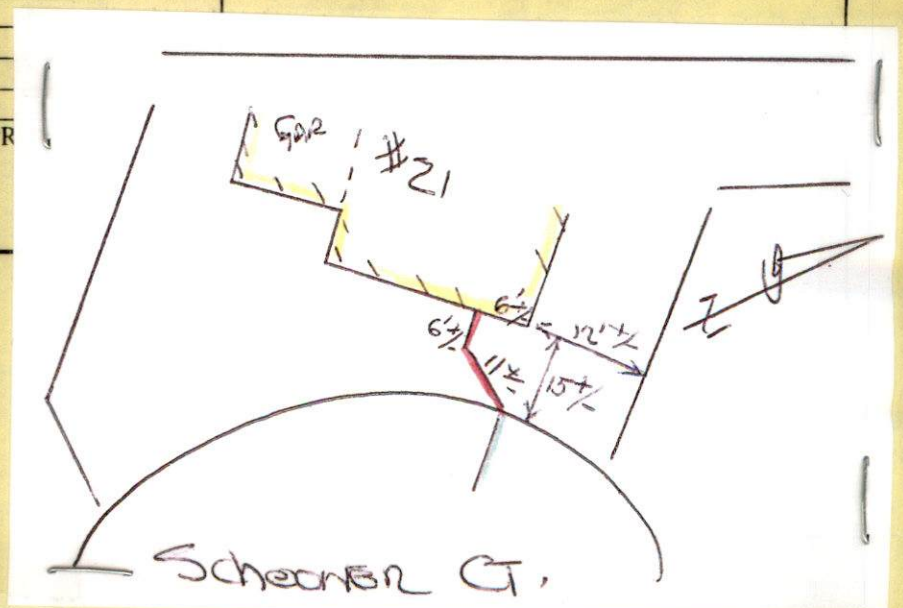



PERMIT NO.

23823

CITY OF NEW BEDFORD
SEWER AND/OR STORM DRAIN PERMIT

DATE 5/2/06

This certifies that permission is granted to

Ralph Mulford 158 Chas. McCombs Blvd, NB 508 965 8355
Property Owner Address Tel.

To connect a sewer and/or storm drain located at 21 Schooner Ct.

Assessor's Plot 130.6 Lot 232, to the sewer and/or storm drain in Schooner Ct Street

To be laid in accordance with the conditions in this application and the City of New Bedford ordinances.

TYPE OF USE: ☒ RESIDENTIAL ☐ COMMERCIAL ☐ INDUSTRIAL ☐ OTHER 330 gpd

If applicant other than actual property owner, attach Letter of Authorization from Property Owner.

Name Tel.

Mailing Address

The Bonded Contractor/Drain Layer authorized to perform this work is:

D.W. White Cons. 867 Middle Rd. Acushnet MA

Name Address Tel.

Type of Pipe Required: SDR 35 PVC 508 763 886 8

PERMIT EXPIRES ONE YEAR AFTER DATE OF ISSUE

- Requires separate connections for sewage and storm drain where applicable. Storm water cannot be discharged to a sanitary sewer.
- All work must be inspected and approved by a D.P.I. inspector before backfilling.
- If this connection is to be part of a private service shared jointly with other building owners, attach copy of Recorded Joint Maintenance Agreement.
- Permits can be issued to Industrial and/or Commercial Applicants only upon receipt and approval by the Commissioner of Public Infrastructure of required plans and supplemental information.
- In addition, a City-issued Industrial User Discharge Permit and/or a Sewer Extension/Connection Permit issued by the Commonwealth of Massachusetts D.E.P. shall be required by the City for Industrial Discharge into the sewer system.

Industrial User Discharge Permit No. Date

Comm. Mass. Sewer Conn./Ext. Permit No. Date

A Filing and Inspection Fee of \$150.00 plus an Entrance Fee of \$ where applicable, must accompany this application.

Bank# bcp bank Check# 12279 Date 5/2/06 Receipt# 6058

Other requirements: 24 hr. inspection 508 9791 527

Connection made to ☒ Sewer ☐ Storm Drain Part of jointly-shared private line YES ☒ NO

Applicant agrees to abide by the above terms, as well as all pertinent ordinances of the City of New Bedford, and such other special rules as the Commissioner of Public Infrastructure and/or City Engineer may deem necessary.

Quarto M. Andrade Acting City Engineer

Signature of Property Owner or Representative

INSPECTOR'S REPORT

INSPECTED BY:

DATE:

COMMENTS:

APPROVED

DISAPPROVED

SIGNATURE

SKETCH PLAN

Inspector's Copy



PERMIT NO.
23823

CITY OF NEW BEDFORD
SEWER AND/OR STORM DRAIN PERMIT

PLOTTED

DATE 5/2/06

This certifies that permission is granted to

Ralph Mulford 158 Chas. McCombs Blvd, NB 508 965 8355
Property Owner Address Tel.

To connect a sewer and/or storm drain located at 21 Schooner Ct.

Assessor's Plot 1306 Lot 232, to the sewer and/or storm drain in Schooner Ct Street

To be laid in accordance with the conditions in this application and the City of New Bedford ordinances.

TYPE OF USE: RESIDENTIAL COMMERCIAL INDUSTRIAL OTHER 330 gpd

If applicant other than actual property owner, attach Letter of Authorization from Property Owner.

Name Mailing Address Tel.

The Bonded Contractor/Drain Layer authorized to perform this work is:

D.W. White Cons. 867 Middle Rd. Acushnet MA

Name Address Tel.

Type of Pipe Required: S.D.R. 35 PVC 508 763 886 8

PERMIT EXPIRES ONE YEAR AFTER DATE OF ISSUE

- Requires separate connections for sewage and storm drain where applicable. Storm water cannot be discharged to a sanitary sewer.
- All work must be inspected and approved by a D.P.I. inspector before backfilling.
- If this connection is to be part of a private service shared jointly with other building owners, attach copy of Recorded Joint Maintenance Agreement.
- Permits can be issued to Industrial and/or Commercial Applicants only upon receipt and approval by the Commissioner of Public Infrastructure of required plans and supplemental information.
- In addition, a City-issued Industrial User Discharge Permit and/or a Sewer Extension/Connection Permit issued by the Commonwealth of Massachusetts D.E.P. shall be required by the City for Industrial Discharge into the sewer system.

Industrial User Discharge Permit No. Date.

Comm. Mass. Sewer Conn./Ext. Permit No. Date.

A Filing and Inspection Fee of \$150.00 plus an Entrance Fee of \$ where applicable, must accompany this application.

Bank# bap bank Check# 12279 Date 5/2/06 Receipt# 6058

Other requirements: 24 hr inspection 508 279 1527

Connection made to Sewer Storm Drain Part of jointly-shared private line YES NO

Applicant agrees to abide by the above terms, as well as all pertinent ordinances of the City of New Bedford, and such other special rules as the Commissioner of Public Infrastructure and/or City Engineer may deem necessary

Quarte M. Andrade Acting City Engineer

Signature of Property Owner or Representative

INSPECTOR'S REPORT

INSPECTED BY: KC
DATE: 5/11/06
COMMENTS:

APPROVED DISAPPROVED

SIGNATURE

Thursday 5/11/06
10 am

SKETCH PLAN



CITY OF NEW BEDFORD

NO. 696 06

LICENSE NO. 051422

DATE 4-27 2006

FOUNDATION PERMIT

MSBC Sect. 111.8 – Any permit issued shall be deemed abandoned and invalid unless the work authorized by it shall have been commenced within six (6) months after its issuance.

This certifies that Long Built Homes, Inc., owner/contractor
has permission to Install a Foundation
on 21 Schooner Court NOT 232 WHAWERS WOODS

providing that the person accepting this permit shall in every respect conform to the terms of the application therefor on file in this office; to the provisions of the Statute of the Commonwealth and to the By-Laws of the City of New Bedford relating to the Inspection, Erection, Enlarging, Altering, Raising, Moving, Repairing or Tearing Down of a Building.

WIRING INSPECTOR

PLUMBING INSPECTOR

BUILDING INSPECTOR

Thomas Welch

ROUGH FINISH

YOUR AREA INSPECTOR IS: _____

– Tel. 979-1540 Between 8:00 AM – 9:00 AM

NOTICE: NOTIFY INSPECTOR 48 HOURS
IN ADVANCE OF APPLYING
SHEATING OR LATHING

OCCUPANCY PERMIT REQUIRED BEFORE OCCUPANCY

No Building or Structure shall be used or occupied until the Certificate of Use and Occupancy shall have been issued by the Building Commissioner – MSBC. Sect. 120.1 – N.B. Zoning Ord. Sect. 9-269

THIS CARD MUST BE DISPLAYED IN A CONSPICUOUS PLACE ON THE PREMISES
AND NOT TORN DOWN OR REMOVED UNTIL COMPLETION OF WORK

SUBJECT TO MASSACHUSETTS STATE
BUILDING CODE REQUIREMENTS

Danny P. Romanowicz
BUILDING INSPECTOR

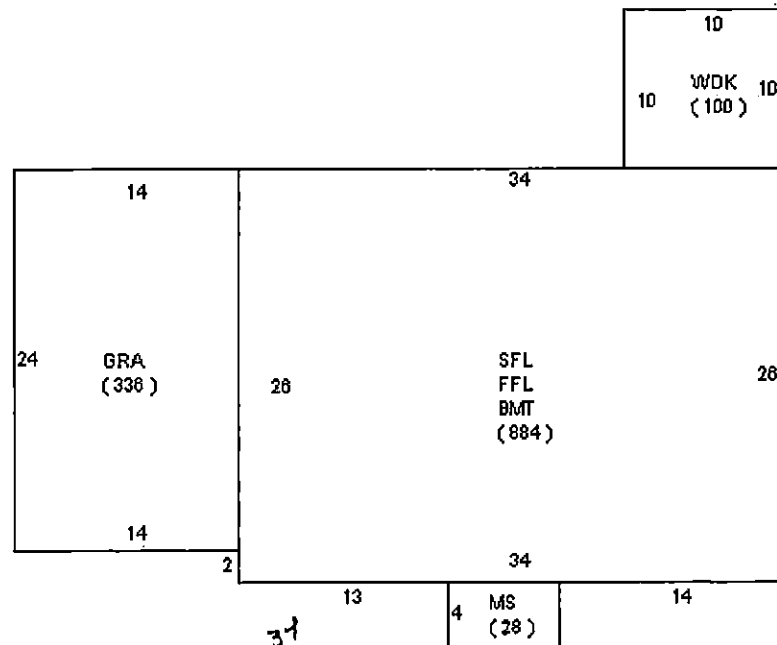

LOT 8
14,941 sq.ft.
0.34 acres
PLAND AREA=
10,221 sq.ft.

8,247 SF

LOT 8
12,900 sq.ft.
0.30 acres
UPLAND AREA=
9,322 sq.ft.

LOT 4
8,366 sq.ft.
0.19 acres
UPLAND AREA=
6,410 sq.ft.

LOT 3
9,057 sq.ft.
0.21 acres
UPLAND AREA=
6,747 sq.ft.

1"=50'

LOT 7
9,534 sq.ft.
0.22 acres

LOT 6
8,562 sq.ft.
0.20 acres

LOT 7
8,741 sq.ft.
0.20 acres

START=87.36
CENTER OF CUL DE SAC

WHALE'S WOODS BLVD.

PT = 3+65.72
L=187.85
R=120.00
T=80°08'41"

LOT 60
10,453 sq.ft.
0.24 acres

LOT 61
18,772 sq.ft.
0.43 acres

CBW/DH

MAP 130 G
LOT 182

S 80°44'10" E 200.00'

CBW/DH