



PERMIT NO.

23806

CITY OF NEW BEDFORD
SEWER AND/OR STORM DRAIN PERMIT

DATE 3/23/06

This certifies that permission is granted to

Property Owner Ramon Silva 27 James St. NB 508.615.3006
Address #71 Walden St. Tel.

To connect a sewer and/or storm drain located at 100' s x Maxfield in Walden St.

Assessor's Plot 58 Lot 170, to the sewer and/or storm drain in 8" sewer main on Walden Street

To be laid in accordance with the conditions in this application and the City of New Bedford ordinances.

TYPE OF USE: ☒ RESIDENTIAL ☐ COMMERCIAL ☐ INDUSTRIAL ☐ OTHER 660 gpd

If applicant other than actual property owner, attach Letter of Authorization from Property Owner.

Name..... Tel.....

Mailing Address.....

The Bonded Contractor/Drain Layer authorized to perform this work is:

Farland Enterprises Inc. 32 Commons Rd Aquinnat 508.998.8652

Name..... Address..... Tel.....

Type of Pipe Required: SDR 35 PVC

PERMIT EXPIRES ONE YEAR AFTER DATE OF ISSUE

- Requires separate connections for sewage and storm drain where applicable. Storm water cannot be discharged to a sanitary sewer.
 - All work must be inspected and approved by a D.P.I. inspector before backfilling.
 - If this connection is to be part of a private service shared jointly with other building owners, attach copy of Recorded Joint Maintenance Agreement.
 - Permits can be issued to Industrial and/or Commercial Applicants only upon receipt and approval by the Commissioner of Public Infrastructure of required plans and supplemental information.
 - In addition, a City-issued Industrial User Discharge Permit and/or a Sewer Extension/Connection Permit issued by the Commonwealth of Massachusetts D.E.P. shall be required by the City for Industrial Discharge into the sewer system.
- Industrial User Discharge Permit No..... Date.....

Comm. Mass. Sewer Conn./Ext. Permit No..... Date.....

A Filing and Inspection Fee of \$150.00 plus an Entrance Fee of \$..... where applicable, must accompany this application.

Bank# (Flect) America Check# 1283 Date 3/23/06 Receipt# 5906

Other requirements: 24 hr inspection at 508.979.1527, water and
sewer must be in apart

Connection made to Sewer Part of jointly-shared private line YES ☒ NO
Storm Drain

Applicant agrees to abide by the above terms, as well as all pertinent ordinances of the City of New Bedford, and such other special rules as the Commissioner of Public Infrastructure and/or City Engineer may deem necessary

Duarte M. Andrade
Acting City Engineer mn

[Signature]
Signature of Property Owner or Representative

INSPECTOR'S REPORT

INSPECTED BY: KEVIN CORWELL
DATE: 5-23-06
COMMENTS:

APPROVED DISAPPI

Kevin S Corwell
SIGNATURE

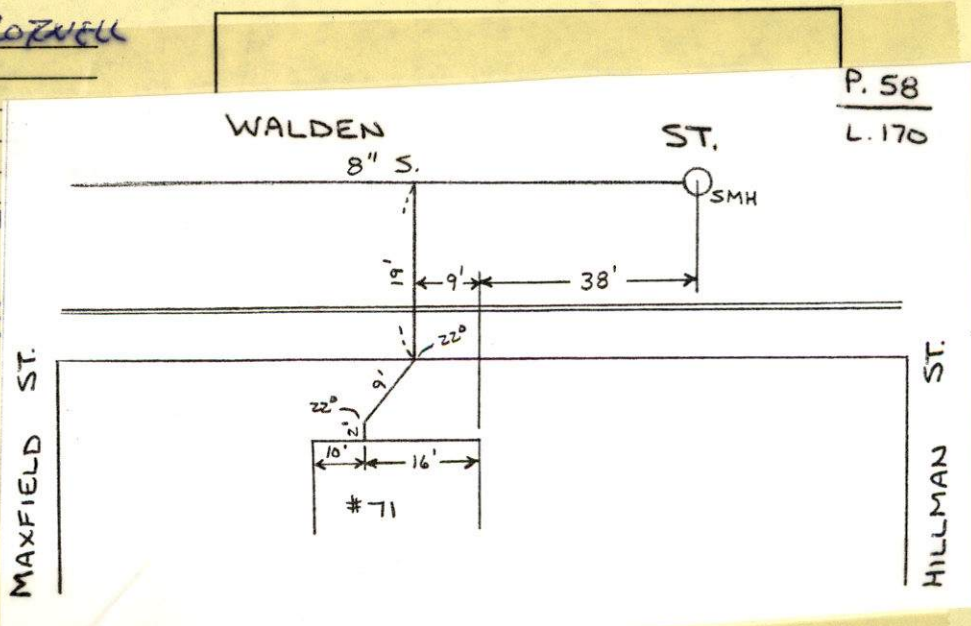



PERMIT NO.

CITY OF NEW BEDFORD
SEWER AND/OR STORM DRAIN PERMIT

DATE 3/23/06

23806

This certifies that permission is granted to

Ramon Silva 27 James St. NB 508.615.3006
Property Owner Address Tel.

To connect a sewer and/or storm drain located at 100' s x Maxfield in Walden St

Assessor's Plot 58 Lot 170, to the sewer and/or storm drain in 8" sewer main on Walden Street

To be laid in accordance with the conditions in this application and the City of New Bedford ordinances.

TYPE OF USE: ☒ RESIDENTIAL ☐ COMMERCIAL ☐ INDUSTRIAL ☐ OTHER 660 gpd

If applicant other than actual property owner, attach Letter of Authorization from Property Owner.

Name..... Tel.....
Mailing Address.....

The Bonded Contractor/Drain Layer authorized to perform this work is:

Farland Enterprises Inc. 32 Commons Rd Acushnet 508.998.8650
Name Address Tel.

Type of Pipe Required: SDR 35 PVC

PERMIT EXPIRES ONE YEAR AFTER DATE OF ISSUE

- Requires separate connections for sewage and storm drain where applicable. Storm water cannot be discharged to a sanitary sewer.
- All work must be inspected and approved by a D.P.I. inspector before backfilling.
- If this connection is to be part of a private service shared jointly with other building owners, attach copy of Recorded Joint Maintenance Agreement.
- Permits can be issued to Industrial and/or Commercial Applicants only upon receipt and approval by the Commissioner of Public Infrastructure of required plans and supplemental information.
- In addition, a City-issued Industrial User Discharge Permit and/or a Sewer Extension/Connection Permit issued by the Commonwealth of Massachusetts D.E.P. shall be required by the City for Industrial Discharge into the sewer system.

Industrial User Discharge Permit No..... Date.....

Comm. Mass. Sewer Conn./Ext. Permit No..... Date.....

A Filing and Inspection Fee of \$150.00 plus an Entrance Fee of \$- where applicable, must accompany this application.

Bank# (Fleet) Bank America Check# 1283 Date 3/23/06 Receipt# 5906

Other requirements: 24 hr inspection at 508.979.1527, water and sewer must be 10' apart

Connection made to Sewer Part of jointly-shared private line YES ☒ NO
Storm Drain

Applicant agrees to abide by the above terms, as well as all pertinent ordinances of the City of New Bedford, and such other special rules as the Commissioner of Public Infrastructure and/or City Engineer may deem necessary

Quante M. Andrade
Acting City Engineer mn

[Signature]
Signature of Property Owner or Representative

INSPECTOR'S REPORT

INSPECTED BY: _____
DATE: _____
COMMENTS: _____

APPROVED _____ DISAPPROVED _____

SIGNATURE

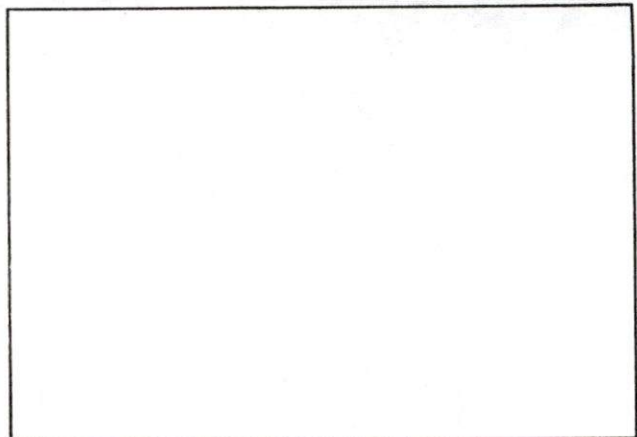

SKETCH PLAN



CITY OF NEW BEDFORD

NO. **46-06**LICENSE NO. **083729**

DATE

11/11/200617.734
20 **06**

BUILDING PERMIT

MSBC Sect. 110.14 — Any permit issued shall be deemed abandoned and invalid unless the work authorized by it shall have been commenced within six (6) months after its issuance.

This certifies that Ramon D. Silva / Go Modular Inc., owner/contractor
has permission to Erect a Duplex 26'x46' (Modular)
on Walden Street plot 58 lot 170

Providing that the person accepting this permit shall in every respect conform to the terms of the application therefore on file in this office; to the provisions of the statute of the Commonwealth and to the by-laws of the City of New Bedford relating to the inspection, erection, enlarging, altering, raising, moving, repairing, or tearing down of a building.

CITY DEPARTMENT/COMMISSION COMMENTS	BUILDING DEPARTMENT COMMENTS
<p>The following department/commission has expressed concern about the issuance of this permit. You are advised to contact that agency to resolve this matter.</p> <p>Department/Commission: _____</p> <p>Comments: _____</p>	

YOUR AREA INSPECTOR IS:

J. Despres

Tel. 979-1540 Between 8:00 AM — 9:00 AM

NOTICE: NOTIFY INSPECTOR 48 HOURS
IN ADVANCE OF APPLYING
SHEATHING OR LATHING

OCCUPANCY PERMIT REQUIRED BEFORE OCCUPANCY

No Building or Structure shall be used or occupied until the Certificate of Use and Occupancy shall have been issued by the Building Commissioner — MSBC, Sect. 120.1 —

THIS CARD MUST BE DISPLAYED IN A CONSPICUOUS PLACE ON THE PREMISES
AND NOT TORN DOWN OR REMOVED UNTIL COMPLETION OF WORK

SUBJECT TO MASSACHUSETTS STATE
BUILDING CODE REQUIREMENTS

Ramon D. Romanowicz
BUILDING INSPECTOR

THOMAS STREET

MAXFIELD STREET



MAP 58
LOT 171

MAP 58
LOT 169

MAP 58
LOT 172

41.0'
MAP 58
LOT 170
AREA = 3,321 Sq.Ft.

MAP 58
LOT 167

PROPOSED
26' X 46'
DUPLEX
TOF = 108.0
FBF = 100.25
FFF = 109.1+/-

EXISTING WATER SERVICE
TO BE UTILIZED IF FEASIBLE
IF NOT USE 3/4" TYPE K COPPER
SERVICE WITH SHUT OFF

PROPOSED 8" SDR 35
CL = 0.02 (MIN) L = 28.0'

BENCHMARK
DH SET IN SW
EL = 100.00 (ASSUMED)

8" WATER

SEWER

WALDEN STREET

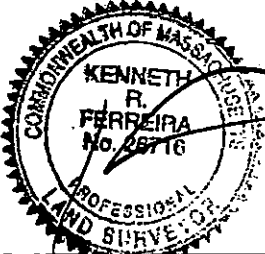

KENNETH R. FERREIRA, R.E. DATE

68 #

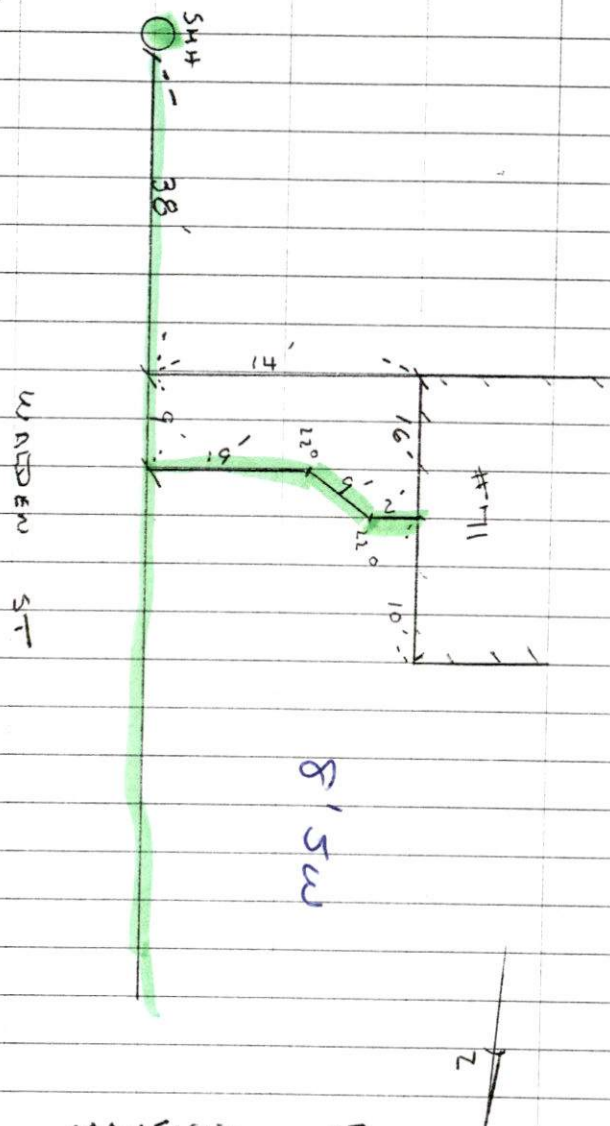

MAXFIELD ST

(46)

SEWER PERMIT # 23006

CONTRACTOR - FARLAND ENTERPRISES

508-998-8652

