



PERMIT NO.
23798

CITY OF NEW BEDFORD
SEWER AND/OR STORM DRAIN PERMIT

DATE 3/7/06

This certifies that permission is granted to

Ralph M. Mulford 158 Chas. McCombs Blvd. N.B.
Property Owner Address Tel. n.e.c. Mate Dr./
Whalers' Woods Blvd.

To connect a sewer and/or storm drain located at 44 Mate Dr.

Assessor's Plot 1306 Lot 235, to the sewer and/or storm drain in Mate Dr. Street

To be laid in accordance with the conditions in this application and the City of New Bedford ordinances.

TYPE OF USE: ☒ RESIDENTIAL ☐ COMMERCIAL ☐ INDUSTRIAL ☐ OTHER

If applicant other than actual property owner, attach Letter of Authorization from Property Owner.

Name..... Tel.....

Mailing Address.....

The Bonded Contractor/Drain Layer authorized to perform this work is:

D.W. White Const. 867 Middle Rd. Acushnet MA

Name Address Tel.

Type of Pipe Required: SDR 35 PVC 763 8868

PERMIT EXPIRES ONE YEAR AFTER DATE OF ISSUE

- Requires separate connections for sewage and storm drain where applicable. Storm water cannot be discharged to a sanitary sewer.
- All work must be inspected and approved by a D.P.I. inspector before backfilling.
- If this connection is to be part of a private service shared jointly with other building owners, attach copy of Recorded Joint Maintenance Agreement.
- Permits can be issued to Industrial and/or Commercial Applicants only upon receipt and approval by the Commissioner of Public Infrastructure of required plans and supplemental information.
- In addition, a City-issued Industrial User Discharge Permit and/or a Sewer Extension/Connection Permit issued by the Commonwealth of Massachusetts D.E.P. shall be required by the City for Industrial Discharge into the sewer system.

Industrial User Discharge Permit No..... Date.....

Comm. Mass. Sewer Conn./Ext. Permit No..... Date.....

A Filing and Inspection Fee of \$150.00, plus an Entrance Fee of \$..... where applicable, must accompany this application.

Bank# bcp bank Check# 11284 Date 3/7/06 Receipt# 5774

Other requirements: 24 hr. inspection notice 508-979-1527

Connection made to ☒ Sewer ☐ Storm Drain Part of jointly-shared private line YES ☐ NO

Applicant agrees to abide by the above terms, as well as all pertinent ordinances of the City of New Bedford, and such other special rules as the Commissioner of Public Infrastructure and/or City Engineer may deem necessary

Duarte M. Andrade
Acting City Engineer mn

Ralph M. Mulford
Signature of Property Owner or Representative

INSPECTOR'S REPORT

INSPECTED BY: KEVIN CORNELL

DATE: 3-09-06

COMMENTS:

APPROVED ☒

DISAPPROVED ☐

Kevin J Cornell
SIGNATURE

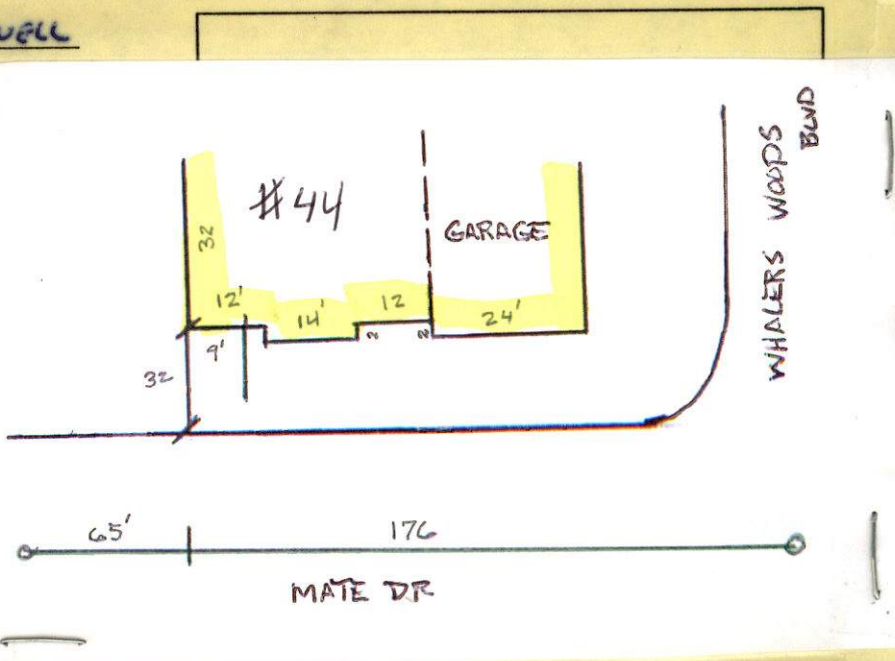



PERMIT NO.
23798

CITY OF NEW BEDFORD
SEWER AND/OR STORM DRAIN PERMIT

DATE **3/7/06**

This certifies that permission is granted to

Ralph Mulford 158 Chas. McCombs Blvd. NB
Property Owner Address Tel.

To connect a sewer and/or storm drain located at **44 Mate Dr.** n.e.c. Mate Dr./
Whalers' Woods Blvd.

Assessor's Plot **130 G Lot 235**, to the sewer and/or storm drain in **Mate Dr.** Street

To be laid in accordance with the conditions in this application and the City of New Bedford ordinances.

TYPE OF USE: ☒ RESIDENTIAL ☐ COMMERCIAL ☐ INDUSTRIAL ☐ OTHER

If applicant other than actual property owner, attach Letter of Authorization from Property Owner.

Name..... Tel.....

Mailing Address.....

The Bonded Contractor/Drain Layer authorized to perform this work is:

D.W. White Const. 867 Middle Rd. Acushnet MA

Name Address Tel.

Type of Pipe Required: **SDR 3.5 PVC** 763 8868

PERMIT EXPIRES ONE YEAR AFTER DATE OF ISSUE

- Requires separate connections for sewage and storm drain where applicable. Storm water cannot be discharged to a sanitary sewer.
 - All work must be inspected and approved by a D.P.I. inspector before backfilling.
 - If this connection is to be part of a private service shared jointly with other building owners, attach copy of Recorded Joint Maintenance Agreement.
 - Permits can be issued to Industrial and/or Commercial Applicants only upon receipt and approval by the Commissioner of Public Infrastructure of required plans and supplemental information.
 - In addition, a City-issued Industrial User Discharge Permit and/or a Sewer Extension/Connection Permit issued by the Commonwealth of Massachusetts D.E.P. shall be required by the City for Industrial Discharge into the sewer system.
- Industrial User Discharge Permit No.....Date.....

Comm. Mass. Sewer Conn./Ext. Permit No.....Date.....

A Filing and Inspection Fee of \$**150.00** plus an Entrance Fee of \$..... where applicable, must accompany this application.

Bank# **b cp bank** Check# **11284** Date **3/7/06** Receipt# **5774**

Other requirements: **24 hr. inspection notice 508-979-1527**

Connection made to Sewer Part of jointly-shared private line YES NO
Storm Drain

Applicant agrees to abide by the above terms, as well as all pertinent ordinances of the City of New Bedford, and such other special rules as the Commissioner of Public Infrastructure and/or City Engineer may deem necessary

Duarte M. Andrade
Acting City Engineer mn

Ralph Mulford
Signature of Property Owner or Representative

INSPECTOR'S REPORT

INSPECTED BY: _____
DATE: _____
COMMENTS: _____

APPROVED _____ DISAPPROVED _____

SIGNATURE

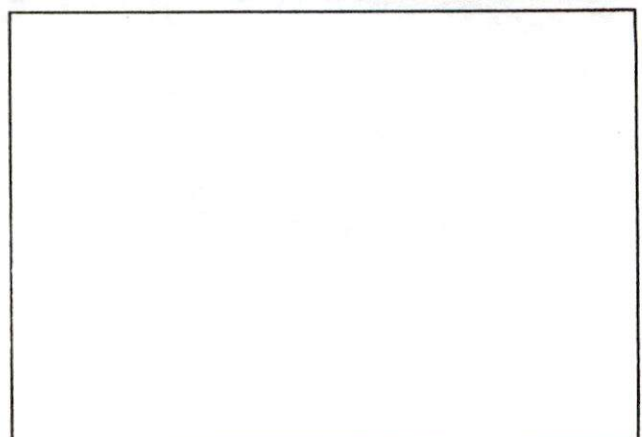

SKETCH PLAN



PERMIT NO.
23798

CITY OF NEW BEDFORD
SEWER AND/OR STORM DRAIN PERMIT

DATE 3/7/06

This certifies that permission is granted to

Ralph Mulford 158 Chas. McCombs Blvd. NB
Property Owner Address Tel. n.e.c. Mate Dr./

To connect a sewer and/or storm drain located at 44 Mate Dr. Whalers' Woods Blvd

Assessor's Plot 130.G Lot 235, to the sewer and/or storm drain in Mate Dr. Street

To be laid in accordance with the conditions in this application and the City of New Bedford ordinances.

TYPE OF USE: ☒ RESIDENTIAL ☐ COMMERCIAL ☐ INDUSTRIAL ☐ OTHER

If applicant other than actual property owner, attach Letter of Authorization from Property Owner.

Name Tel.

Mailing Address

The Bonded Contractor/Drain Layer authorized to perform this work is:

D.W. White Const. 867 Middle Rd. Acushnet MA

Name Address Tel.

Type of Pipe Required: SDR 35 PVC 763.8868

PERMIT EXPIRES ONE YEAR AFTER DATE OF ISSUE

- Requires separate connections for sewage and storm drain where applicable. Storm water cannot be discharged to a sanitary sewer.
 - All work must be inspected and approved by a D.P.I. inspector before backfilling.
 - If this connection is to be part of a private service shared jointly with other building owners, attach copy of Recorded Joint Maintenance Agreement.
 - Permits can be issued to Industrial and/or Commercial Applicants only upon receipt and approval by the Commissioner of Public Infrastructure of required plans and supplemental information.
 - In addition, a City-issued Industrial User Discharge Permit and/or a Sewer Extension/Connection Permit issued by the Commonwealth of Massachusetts D.E.P. shall be required by the City for Industrial Discharge into the sewer system.
- Industrial User Discharge Permit No. Date

Comm. Mass. Sewer Conn./Ext. Permit No. Date

A Filing and Inspection Fee of \$150.00 plus an Entrance Fee of \$ where applicable, must accompany this application.

Bank# b cp bank Check# 11284 Date 3/7/06 Receipt# 5774

Other requirements: 24 hr inspection notice 598-979-1527

Connection made to ☒ Sewer ☐ Storm Drain Part of jointly-shared private line YES ☐ NO

Applicant agrees to abide by the above terms, as well as all pertinent ordinances of the City of New Bedford, and such other special rules as the Commissioner of Public Infrastructure and/or City Engineer may deem necessary

Duarte M. Andrade
Acting City Engineer mn

Signature of Property Owner or Representative

INSPECTOR'S REPORT

INSPECTED BY:

DATE:

COMMENTS:

APPROVED

DISAPPROVED

SIGNATURE

Thursday 3/9/06
1 pm inspection

SKETCH PLAN

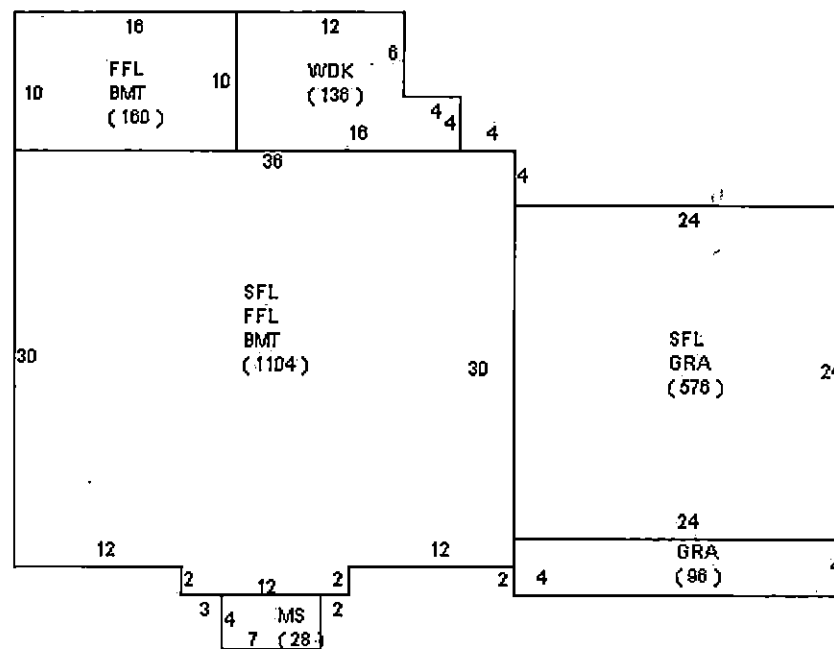

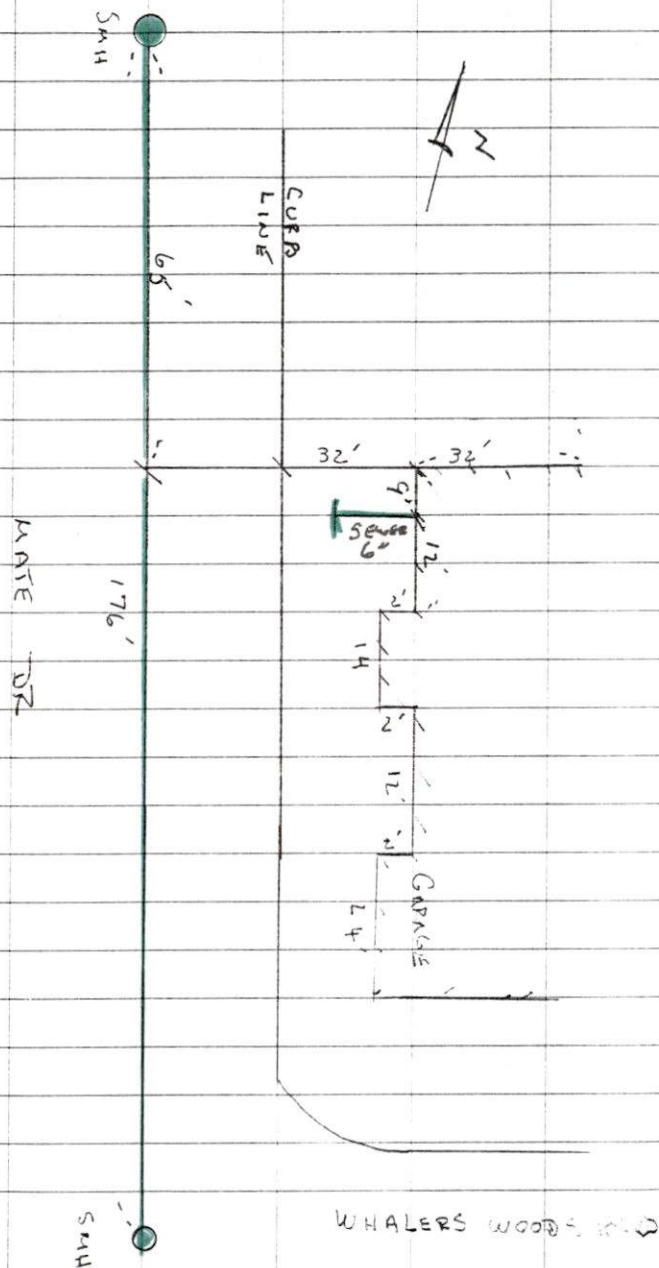

3-09-06 40° CLOUDY/RAIN (14)
THURSDAY

44 MATE DR / WHALEYS WOODS BLVD

PLOT 1306 LOT 235
PERMIT # 23798

CONTRACTOR - D.W. WHITE