



PERMIT NO.  
**23793**

CITY OF NEW BEDFORD  
SEWER AND/OR STORM DRAIN PERMIT

DATE 2/14/06

This certifies that permission is granted to

S.P.L. Dev. LLC 513 Church St. NB 02745 508.889.0074  
Property Owner Address Tel.

To connect a sewer and/or storm drain located at Nellie Rd. east of #147 Nellie Rd.

Assessor's Plot 1.21 Lot 1.87, to the sewer and/or storm drain in Nellie Rd. Street

To be laid in accordance with the conditions in this application and the City of New Bedford ordinances.

TYPE OF USE: ☒ RESIDENTIAL ☐ COMMERCIAL ☐ INDUSTRIAL ☐ OTHER

330 gpd

If applicant other than actual property owner, attach Letter of Authorization from Property Owner.

Name.....Tel.....

Mailing Address.....

The Bonded Contractor/Drain Layer authorized to perform this work is:

Rios Asphalt 4.716 Norville Rd. Dartmouth 508.996.0735  
Name Address Tel.

Type of Pipe Required: sdn 3.5 pvc

PERMIT EXPIRES ONE YEAR AFTER DATE OF ISSUE

- Requires separate connections for sewage and storm drain where applicable. Storm water cannot be discharged to a sanitary sewer.
  - All work must be inspected and approved by a D.P.I. inspector before backfilling.
  - If this connection is to be part of a private service shared jointly with other building owners, attach copy of Recorded Joint Maintenance Agreement.
  - Permits can be issued to Industrial and/or Commercial Applicants only upon receipt and approval by the Commissioner of Public Infrastructure of required plans and supplemental information.
  - In addition, a City-issued Industrial User Discharge Permit and/or a Sewer Extension/Connection Permit issued by the Commonwealth of Massachusetts D.E.P. shall be required by the City for Industrial Discharge into the sewer system.
- Industrial User Discharge Permit No.....Date.....

Comm. Mass. Sewer Conn./Ext. Permit No.....Date.....

A Filing and Inspection Fee of \$150.00, plus an Entrance Fee of \$..... where applicable, must accompany this application.

Bank# Citizens-Union Check# 168 Date 2/7/06 Receipt# 5732

Other requirements: 24 hr inspection notice at 508.996.150

Connection made to Sewer Part of jointly-shared private line YES ☒ NO  
Storm Drain

Applicant agrees to abide by the above terms, as well as all pertinent ordinances of the City of New Bedford, and such other special rules as the Commissioner of Public Infrastructure and/or City Engineer may deem necessary

Duarte M. Andrade  
Acting City Engineer

[Signature]  
Signature of Property Owner or Representative

INSPECTOR'S REPORT

INSPECTED BY: \_\_\_\_\_  
DATE: \_\_\_\_\_  
COMMENTS: \_\_\_\_\_

APPROVED \_\_\_\_\_ DISAPPROVED \_\_\_\_\_

SIGNATURE

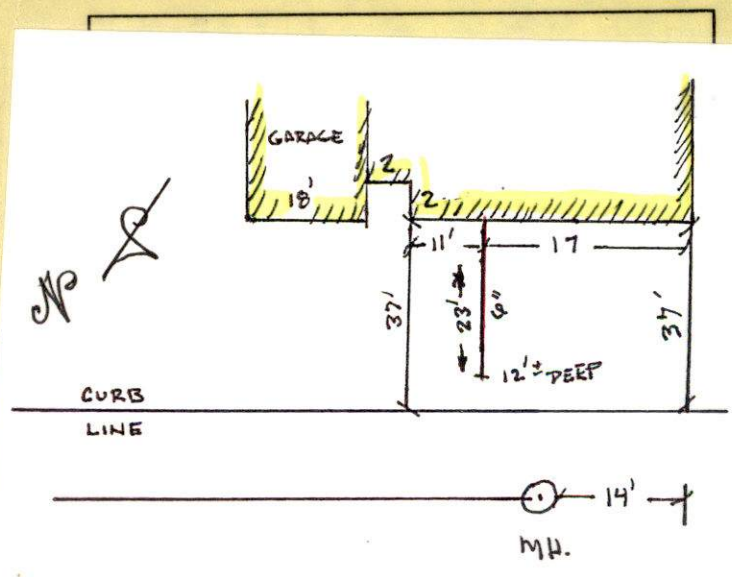



PERMIT NO.

23793

CITY OF NEW BEDFORD  
SEWER AND/OR STORM DRAIN PERMIT

DATE 2/14/06

This certifies that permission is granted to

S.P.L. Dev. LLC 513 Church St. NB 02745 508.889.0074  
Property Owner Address Tel.

To connect a sewer and/or storm drain located at 147 #142 Nellie Rd. east of #147 Nellie Rd.

Assessor's Plot 121 Lot 187, to the sewer and/or storm drain in Nellie Rd. Street

To be laid in accordance with the conditions in this application and the City of New Bedford ordinances.

TYPE OF USE: ☒ RESIDENTIAL ☐ COMMERCIAL ☐ INDUSTRIAL ☐ OTHER

330 gpd

If applicant other than actual property owner, attach Letter of Authorization from Property Owner.

Name Tel.

Mailing Address

The Bonded Contractor/Drain Layer authorized to perform this work is:

Reis Asphalt 476 Newville Rd. Dartmouth 508.996.0735  
Name Address Tel.

Type of Pipe Required: sdn 3.5 pvc

## PERMIT EXPIRES ONE YEAR AFTER DATE OF ISSUE

- Requires separate connections for sewage and storm drain where applicable. Storm water cannot be discharged to a sanitary sewer.
- All work must be inspected and approved by a D.P.I. inspector before backfilling.
- If this connection is to be part of a private service shared jointly with other building owners, attach copy of Recorded Joint Maintenance Agreement.
- Permits can be issued to Industrial and/or Commercial Applicants only upon receipt and approval by the Commissioner of Public Infrastructure of required plans and supplemental information.
- In addition, a City-issued Industrial User Discharge Permit and/or a Sewer Extension/Connection Permit issued by the Commonwealth of Massachusetts D.E.P. shall be required by the City for Industrial Discharge into the sewer system.

Industrial User Discharge Permit No. Date

Comm. Mass. Sewer Conn./Ext. Permit No. Date

A Filing and Inspection Fee of \$150.00 plus an Entrance Fee of \$7 where applicable, must accompany this application.

Bank# Citizens-Union Check# 168 Date 2/7/06 Receipt# 5732

Other requirements: 24 hr inspection notice at 508.991.6150

Connection made to ☒ Sewer ☐ Storm Drain Part of jointly-shared private line YES ☒ NO

Applicant agrees to abide by the above terms, as well as all pertinent ordinances of the City of New Bedford, and such other special rules as the Commissioner of Public Infrastructure and/or City Engineer may deem necessary

Quarte M. Raduadej  
Acting City Engineer mn

Signature of Property Owner or Representative

## INSPECTOR'S REPORT

INSPECTED BY: \_\_\_\_\_

DATE: \_\_\_\_\_

COMMENTS: \_\_\_\_\_

\_\_\_\_\_

\_\_\_\_\_

APPROVED

DISAPPROVED

SIGNATURE

SKETCH PLAN

43



# CITY OF NEW BEDFORD

856

NO. 43-06

LICENSE NO. \_\_\_\_\_

DATE 1-11-2006

## FOUNDATION PERMIT

MSBC Sect. 111.8 – Any permit issued shall be deemed abandoned and invalid unless the work authorized by it shall have been commenced within six (6) months after its issuance.

This certifies that James E. Blanchard, owner/contractor  
has permission to CONSTRUCT FOUNDATION 28' X 34' w/ attached 16' X 22' garage  
on lot 187 Nellie Road

providing that the person accepting this permit shall in every respect conform to the terms of the application therefor on file in this office; to the provisions of the Statute of the Commonwealth and to the By-Laws of the City of New Bedford relating to the Inspection, Erection, Enlarging, Altering, Raising, Moving, Repairing or Tearing Down of a Building.

WIRING INSPECTOR

PLUMBING INSPECTOR

BUILDING INSPECTOR

YOUR AREA INSPECTOR IS:

THOMAS WELSH

- Tel. 979-1540 Between 8:00 AM – 9:00 AM

ROUGH FINISH

NOTICE: NOTIFY INSPECTOR 48 HOURS  
IN ADVANCE OF APPLYING  
SHEATING OR LATHING

### OCCUPANCY PERMIT REQUIRED BEFORE OCCUPANCY

No Building or Structure shall be used or occupied until the Certificate of Use and Occupancy shall have been issued by the Building Commissioner – MSBC. Sect. 120.1 – N.B. Zoning Ord. Sect. 9-269

THIS CARD MUST BE DISPLAYED IN A CONSPICUOUS PLACE ON THE PREMISES  
AND NOT TORN DOWN OR REMOVED UNTIL COMPLETION OF WORK

SUBJECT TO MASSACHUSETTS STATE  
BUILDING CODE REQUIREMENTS

[Signature]  
BUILDING INSPECTOR

4-3-06 Monday

Survey 50°

(24)

LUCKERFARM - SEWER INSPECTION  
LOT #121 LOT #187

PERMIT #23793 X M1

CONTRACTOR - RES ASPHALT  
588-996-0735

