



PERMIT NO.  
23781

CITY OF NEW BEDFORD  
SEWER AND/OR STORM DRAIN PERMIT

DATE 12/20/05

This certifies that permission is granted to

Property Owner Peter Georgopoulos Address 874 Purchase St. NB Tel. 508-992-6553  
To connect a sewer and/or storm drain located at Elm Street sewer connection on private property (line was existing)  
Assessor's Plot 53 Lot 73 to the sewer and/or storm drain in Elm Street

To be laid in accordance with the conditions in this application and the City of New Bedford ordinances.

TYPE OF USE: RESIDENTIAL COMMERCIAL INDUSTRIAL ☒ OTHER

If applicant other than actual property owner, attach Letter of Authorization from Property Owner.

Name Stanley Cieplik Tel. 508-997-5357  
Mailing Address 193 R. Pope's Island NB  
The Bonded Contractor/Drain Layer authorized to perform this work is:  
W.C. Smith & Sons 58 Ridgewood Rd. N.B. 508-995-1449  
Name Address Tel.  
Type of Pipe Required: SDR 35 PVC

PERMIT EXPIRES ONE YEAR AFTER DATE OF ISSUE

- Requires separate connections for sewage and storm drain where applicable. Storm water cannot be discharged to a sanitary sewer.
  - All work must be inspected and approved by a D.P.I. inspector before backfilling.
  - If this connection is to be part of a private service shared jointly with other building owners, attach copy of Recorded Joint Maintenance Agreement.
  - Permits can be issued to Industrial and/or Commercial Applicants only upon receipt and approval by the Commissioner of Public Infrastructure of required plans and supplemental information.
  - In addition, a City-issued Industrial User Discharge Permit and/or a Sewer Extension/Connection Permit issued by the Commonwealth of Massachusetts D.E.P. shall be required by the City for Industrial Discharge into the sewer system.
- Industrial User Discharge Permit No. .... Date .....

Comm. Mass. Sewer Conn./Ext. Permit No. .... Date .....

A Filing and Inspection Fee of \$150.00 plus an Entrance Fee of \$..... where applicable, must accompany this application.

Bank#  Sovereign  Check#  28822  Date  12/16/05  Receipt#  5642

Other requirements:  24 hr. inspection notice at 508-991-6151, per attached plan, permission to work beyond moratorium required, install mh on Elm St

Connection made to  Sewer  Part of jointly-shared private line YES ☒ NO  
 Storm Drain

Applicant agrees to abide by the above terms, as well as all pertinent ordinances of the City of New Bedford, and such other special rules as the Commissioner of Public Infrastructure and/or City Engineer may deem necessary

Duarte M. Andrade   
Acting City Engineer  mn

S.P.C.   
Signature of Property Owner or Representative

INSPECTOR'S REPORT

INSPECTED BY:  KEVIN CORWELL   
DATE:  1-12-06   
COMMENTS: \_\_\_\_\_

☒ APPROVED ☐ DISAPPROVED

Kevin J. Corwell   
SIGNATURE

SEE PLANS ATTACHED  
TO PERMIT

SKETCH PLAN



PURCHASE ST

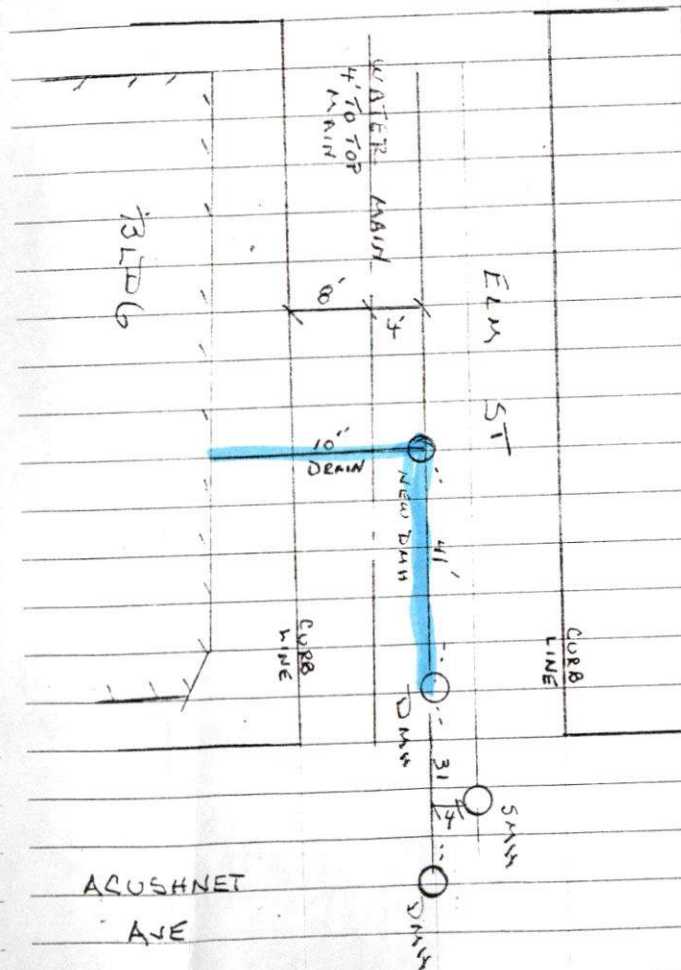

1-12-00 THURSDAY 50° (8)  
SUNNY

ELM ST / PLOT #53 LOT #73  
SEWER DRAW INSPECTION

PERMIT #23781

CONTRACTOR - W.C. SMITH  
508-995-1449

PROJECT: \_\_\_\_\_ PROJECT NO: \_\_\_\_\_  
 SUBJECT: \_\_\_\_\_  
 CALCULATED BY: \_\_\_\_\_ DATE: \_\_\_\_\_  
 CHECKED BY: \_\_\_\_\_ DATE: \_\_\_\_\_

# Sewer Plan

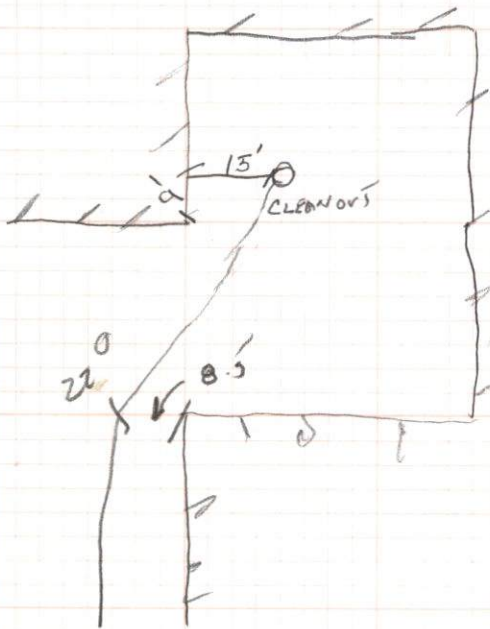

94 Feet

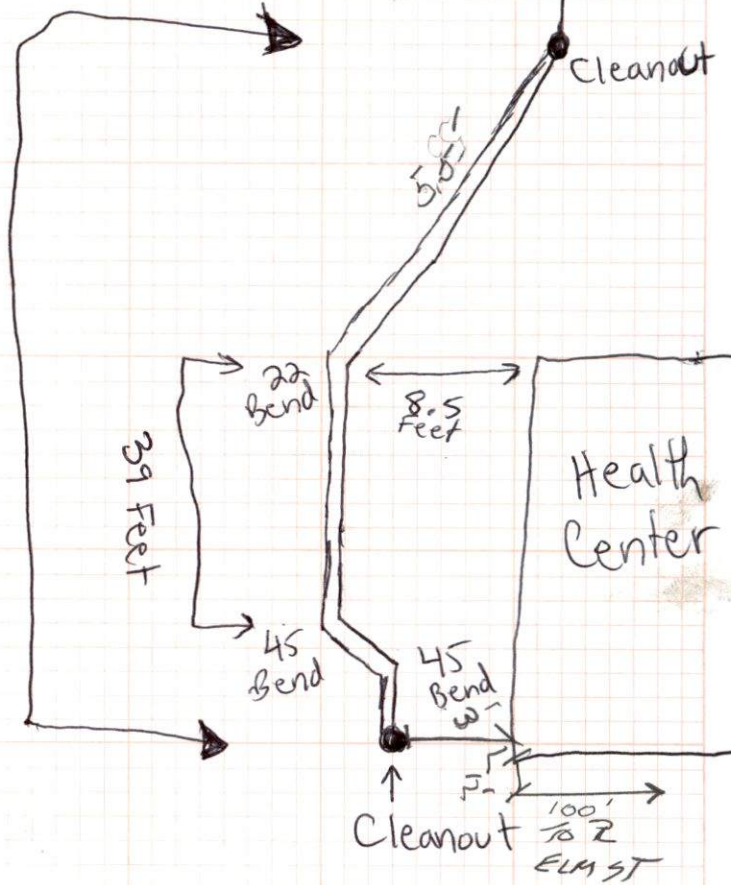





PERMIT NO.

23781

CITY OF NEW BEDFORD  
SEWER AND/OR STORM DRAIN PERMIT

DATE 12/20/05

This certifies that permission is granted to

Peter Georgeopoulos 874 Purchase St. NB 508-992-6553  
Property Owner Address Tel.

To connect a sewer and/or storm drain located at Elm Street sewer connection on private property (line was existing.)

Assessor's Plot 53 Lot 73, to the sewer and/or storm drain in Elm Street

To be laid in accordance with the conditions in this application and the City of New Bedford ordinances.

TYPE OF USE: RESIDENTIAL COMMERCIAL INDUSTRIAL ☒ OTHER

If applicant other than actual property owner, attach Letter of Authorization from Property Owner.

Name Stanley Cieplik Tel. 508-997-5357

Mailing Address 193 R. Pope's Island NB

The Bonded Contractor/Drain Layer authorized to perform this work is:

W.C. Smith & Sons 58 Ridgewood Rd. NB 508-995-1449  
Name Address Tel.

Type of Pipe Required: SDR 35 PVC

## PERMIT EXPIRES ONE YEAR AFTER DATE OF ISSUE

- Requires separate connections for sewage and storm drain where applicable. Storm water cannot be discharged to a sanitary sewer.
  - All work must be inspected and approved by a D.P.I. inspector before backfilling.
  - If this connection is to be part of a private service shared jointly with other building owners, attach copy of Recorded Joint Maintenance Agreement.
  - Permits can be issued to Industrial and/or Commercial Applicants only upon receipt and approval by the Commissioner of Public Infrastructure of required plans and supplemental information.
  - In addition, a City-issued Industrial User Discharge Permit and/or a Sewer Extension/Connection Permit issued by the Commonwealth of Massachusetts D.E.P. shall be required by the City for Industrial Discharge into the sewer system.
- Industrial User Discharge Permit No. .... Date .....

Comm. Mass. Sewer Conn./Ext. Permit No. .... Date .....

A Filing and Inspection Fee of \$150.00, plus an Entrance Fee of \$... where applicable, must accompany this application.

Bank# Sovereign Check# 28822 Date 12/16/05 Receipt# 5642

Other requirements: 24 hr. inspection notice at 508-991-6151, per attached plan, permission to work beyond moratorium required, install mh on Elm St.

Connection made to ☒ Sewer ☒ Storm Drain Part of jointly-shared private line YES ☒ NO

Applicant agrees to abide by the above terms, as well as all pertinent ordinances of the City of New Bedford, and such other special rules as the Commissioner of Public Infrastructure and/or City Engineer may deem necessary

Duarte M. Andrade/  
Acting City Engineer mn

Signature of Property Owner or Representative

## INSPECTOR'S REPORT

INSPECTED BY: \_\_\_\_\_  
DATE: \_\_\_\_\_  
COMMENTS: \_\_\_\_\_

APPROVED

DISAPPROVED

SIGNATURE

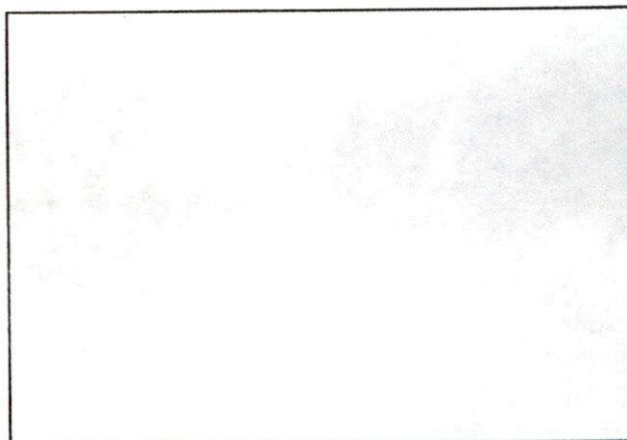

SKETCH PLAN



Greater New Bedford  
Community Health Center, Inc.



Accredited by  
the Joint Commission on  
Accreditation of Healthcare  
Organizations

## Property Owner Affidavit

We, Greater New Bedford Community Health Center, as Owner of the subject property at:

**Property Owner**

874 Purchase Street, New Bedford, Massachusetts hereby authorize

**Property Location**

Gary J. Mesango or Stanley P. Cieplik of Bufftree Building Co, Inc. may act on our behalf, in all matters relative to this building permit application.

**Peter C. Georgeopoulos**

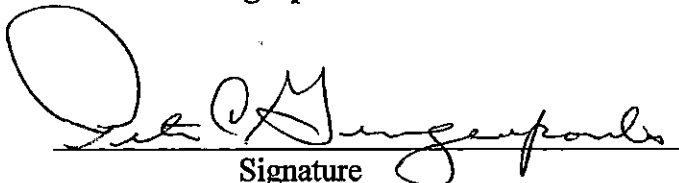
  
Signature

**Executive Vice President and Project Director**

12/16/05