



PERMIT NO.
23764

CITY OF NEW BEDFORD
SEWER AND/OR STORM DRAIN PERMIT

DATE 10/27/05

This certifies that permission is granted to

Faith LaBrice 1041 Sassaquin Ave. NB. 508-995-2182
Property Owner Address Tel.

To connect a sewer and/or storm drain located at Sassaquin Ave. 130' s. of Marton Ave.
Assessor's Plot 136A Lot 238, to the sewer and/or storm drain in Sassaquin Ave. Street
12" storm drain 8" sewer

To be laid in accordance with the conditions in this application and the City of New Bedford ordinances.

TYPE OF USE: ☒ RESIDENTIAL ☐ COMMERCIAL ☐ INDUSTRIAL ☐ OTHER 3309pd

If applicant other than actual property owner, attach Letter of Authorization from Property Owner.

Name..... Tel.....
Mailing Address.....

The Bonded Contractor/Drain Layer authorized to perform this work is:

Menard Bros 307 County Rd. Wareham MA 508 9954022
Name Address Tel.
Type of Pipe Required: SDR 35 PVC

PERMIT EXPIRES ONE YEAR AFTER DATE OF ISSUE

- Requires separate connections for sewage and storm drain where applicable. Storm water cannot be discharged to a sanitary sewer.
 - All work must be inspected and approved by a D.P.I. inspector before backfilling.
 - If this connection is to be part of a private service shared jointly with other building owners, attach copy of Recorded Joint Maintenance Agreement.
 - Permits can be issued to Industrial and/or Commercial Applicants only upon receipt and approval by the Commissioner of Public Infrastructure of required plans and supplemental information.
 - In addition, a City-issued Industrial User Discharge Permit and/or a Sewer Extension/Connection Permit issued by the Commonwealth of Massachusetts D.E.P. shall be required by the City for Industrial Discharge into the sewer system.
- Industrial User Discharge Permit No..... Date.....

Comm. Mass. Sewer Conn./Ext. Permit No..... Date.....

A Filing and Inspection Fee of \$150.00, plus an Entrance Fee of \$..... where applicable, must accompany this application.

Bank# First Fed. Check# 1168 Date 10/27/05 Receipt# 5545

Other requirements: 24 hr. inspection notice at 508-979-1527
flowable fill

Connection made to Sewer Part of jointly-shared private line YES ☒ NO
Storm Drain

Applicant agrees to abide by the above terms, as well as all pertinent ordinances of the City of New Bedford, and such other special rules as the Commissioner of Public Infrastructure and/or City Engineer may deem necessary

Quante M. Andis
Acting City Engineer

[Signature]
Signature of Property Owner or Representative

INSPECTOR'S REPORT

INSPECTED BY: [Signature]
DATE: 12-07-05
COMMENTS:

☒ APPROVED ☐ DISAPPROVED

[Signature]
SIGNATURE

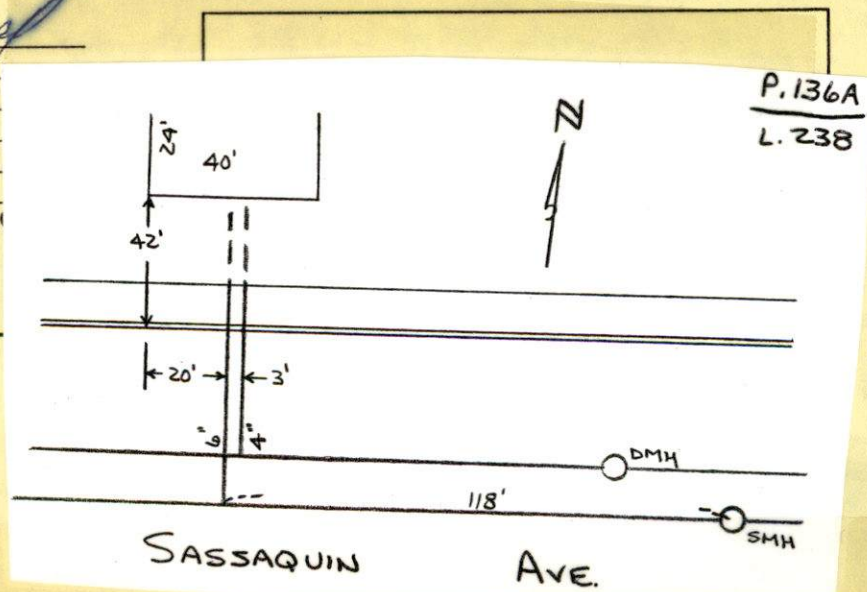

SUNNY 25

12-07-05 WEDNESDAY

SASSAQUIN AVE - PLOT 136 A LOT 238

SEWER / DRAIN INSP

PERMIT # 23764

CONTRACTOR - MENARD BROS

508-985-4022

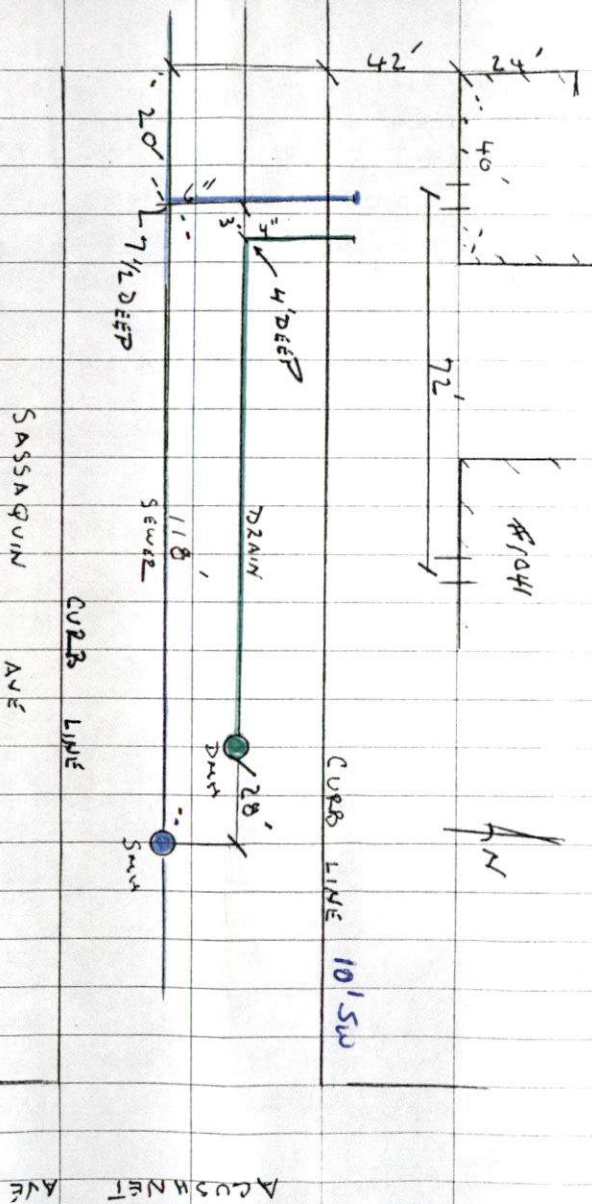



PERMIT NO.

23764

CITY OF NEW BEDFORD
SEWER AND/OR STORM DRAIN PERMIT

DATE 10/27/05

This certifies that permission is granted to

Faith LaBrie 1041 Sassaguin Ave. NB 508-995-2182
Property Owner Address Tel.To connect a sewer and/or storm drain located at Sassaguin Ave 130' E of Marton Ave
12" storm drain 8" sewer
Assessor's Plot 136 A Lot 238, to the sewer and/or storm drain in Sassaguin Ave Street

To be laid in accordance with the conditions in this application and the City of New Bedford ordinances.

TYPE OF USE: ☒ RESIDENTIAL ☐ COMMERCIAL ☐ INDUSTRIAL ☐ OTHER 3309pd

If applicant other than actual property owner, attach Letter of Authorization from Property Owner.

Name..... Tel.....

Mailing Address.....

The Bonded Contractor/Drain Layer authorized to perform this work is:

Menard Bros 307 County Rd Warrham MA 508-995-0222
Name Address Tel.

Type of Pipe Required: S.D.R. 35 PVC

PERMIT EXPIRES ONE YEAR AFTER DATE OF ISSUE

- Requires separate connections for sewage and storm drain where applicable. Storm water cannot be discharged to a sanitary sewer.
 - All work must be inspected and approved by a D.P.I. inspector before backfilling.
 - If this connection is to be part of a private service shared jointly with other building owners, attach copy of Recorded Joint Maintenance Agreement.
 - Permits can be issued to Industrial and/or Commercial Applicants only upon receipt and approval by the Commissioner of Public Infrastructure of required plans and supplemental information.
 - In addition, a City-issued Industrial User Discharge Permit and/or a Sewer Extension/Connection Permit issued by the Commonwealth of Massachusetts D.E.P. shall be required by the City for Industrial Discharge into the sewer system.
- Industrial User Discharge Permit No.....Date.....

Comm. Mass. Sewer Conn./Ext. Permit No.....Date.....

A Filing and Inspection Fee of \$150.00, plus an Entrance Fee of \$..... where applicable, must accompany this application.

Bank# First Fed. Check# 1168 Date 10/27/05 Receipt# 5545

Other requirements: 24 hr. inspection notice at 508-979-1527

flowable fill

Connection made to Sewer Part of jointly-shared private line YES ☒ NO
Storm Drain

Applicant agrees to abide by the above terms, as well as all pertinent ordinances of the City of New Bedford, and such other special rules as the Commissioner of Public Infrastructure and/or City Engineer may deem necessary

Quate M. Andradef
Acting City Engineer mr

Signature of Property Owner or Representative

INSPECTOR'S REPORT

INSPECTED BY: _____

DATE: _____

COMMENTS: _____

APPROVED

DISAPPROVED

SIGNATURE

SKETCH PLAN



Duarte M. Andrade,
Acting City Engineer

CITY OF NEW BEDFORD MASSACHUSETTS

Engineering Department, Rm. 303

133 William Street

New Bedford, Ma. 02740

Tel: 508-979-1527

Fax: 508-961-3043

To Whom It May Concern:

I Faith F. LaBrie, 1041 Sassaguin Ave., being
(Name) (Mailing Address)

Owner of property located at 1041 Sassaguin Ave

Plot 136A, Lot 238, hereby agree to allow Crane Modular
(Name)

93 Songbird Dr. Dart MA. to act on my behalf including affixing my
(Mailing Address)

signature in securing permit for:

☒ Sewer/Drain Service Permits
☐ Water Service Permits
☐ Driveway Installation Permits
☐ Sidewalk Installation Permits

I further agree to conform to, and abide by, All City rules and ask regulations applicable to the permit (s) being applied for:

Name Faith F. LaBrie
Signature

1041 Sassaguin Ave.
Address

10/26/05 508-995-2188
Date Telephone number

Sassaguin Ave. (NS) 130' Ex Morton Ave.