



PERMIT NO.

CITY OF NEW BEDFORD
SEWER AND/OR STORM DRAIN PERMIT

DATE 10/14/05

23758

This certifies that permission is granted to

Randall Santos 980 Reckham Rd. N.B. 508 998 3535
Property Owner Address Tel. (1032)

To connect a sewer and/or storm drain located at 450' east of Acushnet Ave. on Sheffield St.

Assessor's Plot 132H Lot 173, to the sewer and/or storm drain in 1032 Sheffield Street

To be laid in accordance with the conditions in this application and the City of New Bedford ordinances.

TYPE OF USE: ☒ RESIDENTIAL ☐ COMMERCIAL ☐ INDUSTRIAL ☐ OTHER

330g p.d

If applicant other than actual property owner, attach Letter of Authorization from Property Owner.

Name..... Tel.....

Mailing Address.....

The Bonded Contractor/Drain Layer authorized to perform this work is:

R. J. Canessa P.O. Box 51643 N.B. 508 763 4827

Name..... Address..... Tel.....

Type of Pipe Required: SDR 35 PVC SDR 35 PVC

PERMIT EXPIRES ONE YEAR AFTER DATE OF ISSUE

- Requires separate connections for sewage and storm drain where applicable. Storm water cannot be discharged to a sanitary sewer.
- All work must be inspected and approved by a D.P.I. inspector before backfilling.
- If this connection is to be part of a private service shared jointly with other building owners, attach copy of Recorded Joint Maintenance Agreement.
- Permits can be issued to Industrial and/or Commercial Applicants only upon receipt and approval by the Commissioner of Public Infrastructure of required plans and supplemental information.
- In addition, a City-issued Industrial User Discharge Permit and/or a Sewer Extension/Connection Permit issued by the Commonwealth of Massachusetts D.E.P. shall be required by the City for Industrial Discharge into the sewer system.

Industrial User Discharge Permit No..... Date.....

Comm. Mass. Sewer Conn./Ext. Permit No..... Date.....

A Filing and Inspection Fee of \$150.00 plus an Entrance Fee of \$..... where applicable, must accompany this application.

to be paid at later date

Bank# Sovereign Check# 156 Date 3/30/06 Receipt# 5932

24 hr. inspection 508 979 1527

Other requirements: City to install stub to property line

cost for stub to be paid by owner and assessment fee once determined by City

Connection made to

Sewer

Storm Drain

Part of jointly-shared private line

YES

NO

Applicant agrees to abide by the above terms, as well as all pertinent ordinances of the City of New Bedford, and such other special rules as the Commissioner of Public Infrastructure and/or City Engineer may deem necessary

Dorote M. Andros

Acting City Engineer

Signature of Property Owner or Representative

INSPECTOR'S REPORT

INSPECTED BY: Kevin S. Connel

DATE: 4-12-06

COMMENTS:

☒ APPROVED

☐ DISAPPROVE

Kevin S. Connel
SIGNATURE

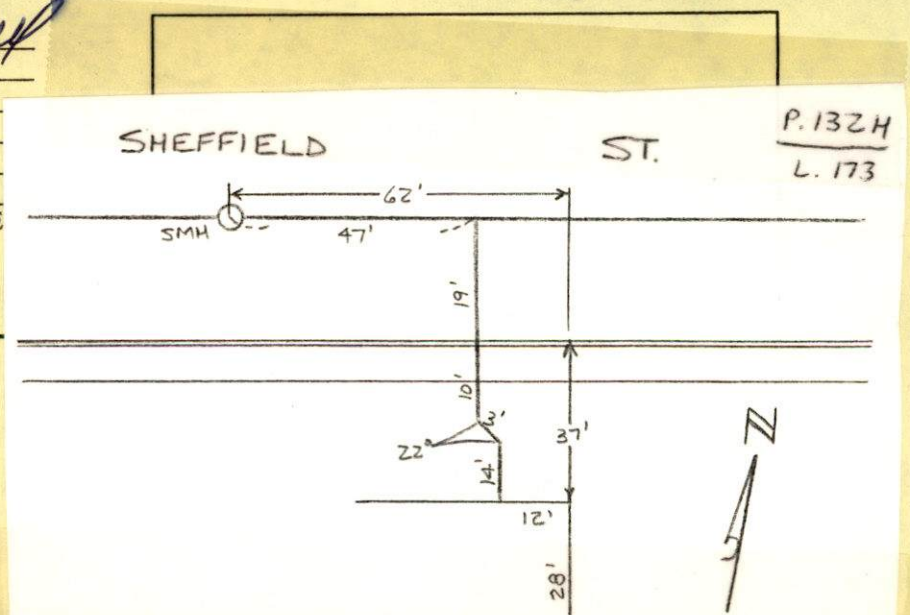

19' stub

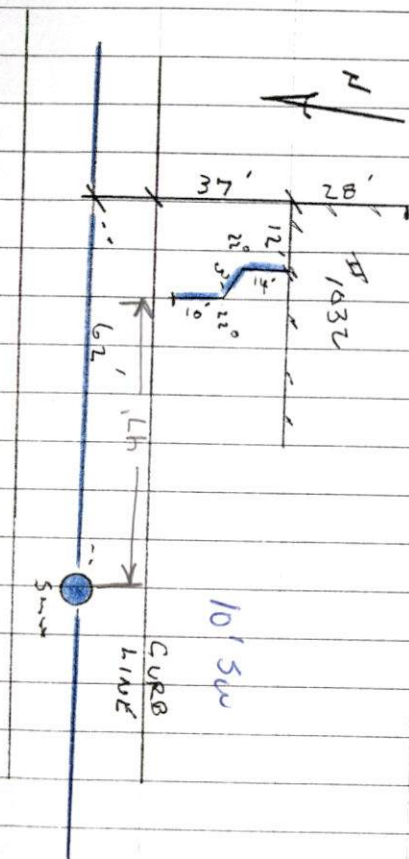

BARTLETT ST

30

PERMIT # 23758



PERMIT NO.

23758

CITY OF NEW BEDFORD
SEWER AND/OR STORM DRAIN PERMIT

DATE 10/14/05

This certifies that permission is granted to

Randall Santos 980 Reckham Rd. N.B. 508 998 3535
Property Owner Address Tel. (1032)To connect a sewer and/or storm drain located at 450' east of Acushnet Ave. on Sheffield St
Assessor's Plot 132H Lot 173, to the sewer and/or storm drain in 1032 Sheffield Street

To be laid in accordance with the conditions in this application and the City of New Bedford ordinances.

TYPE OF USE: ☒ RESIDENTIAL ☐ COMMERCIAL ☐ INDUSTRIAL ☐ OTHER

330g pd

If applicant other than actual property owner, attach Letter of Authorization from Property Owner.

Name..... Tel.....

Mailing Address.....

The Bonded Contractor/Drain Layer authorized to perform this work is:

R. J. Canessa P.O. Box 51643 N.B. 508 743 4827
Name Address Tel.

Type of Pipe Required: SDR 35 PVC SDR 35 PVC

PERMIT EXPIRES ONE YEAR AFTER DATE OF ISSUE

- Requires separate connections for sewage and storm drain where applicable. Storm water cannot be discharged to a sanitary sewer.
- All work must be inspected and approved by a D.P.I. inspector before backfilling.
- If this connection is to be part of a private service shared jointly with other building owners, attach copy of Recorded Joint Maintenance Agreement.
- Permits can be issued to Industrial and/or Commercial Applicants only upon receipt and approval by the Commissioner of Public Infrastructure of required plans and supplemental information.
- In addition, a City-issued Industrial User Discharge Permit and/or a Sewer Extension/Connection Permit issued by the Commonwealth of Massachusetts D.E.P. shall be required by the City for Industrial Discharge into the sewer system.

Industrial User Discharge Permit No.....Date.....

Comm. Mass. Sewer Conn./Ext. Permit No.....Date.....

A Filing and Inspection Fee of \$150.00 plus an Entrance Fee of \$..... where applicable, must accompany this application.

to be paid at later date

Bank# Sovereign Check# 156 Date 3/30/06 Receipt# 5932

24 hr. inspection 508 979 1527

Other requirements: City to install stub to property line.

cost for stub to be paid by owner and assessment fee once determined by City

Connection made to Sewer Part of jointly-shared private line YES NO

Storm Drain

Applicant agrees to abide by the above terms, as well as all pertinent ordinances of the City of New Bedford, and such other special rules as the Commissioner of Public Infrastructure and/or City Engineer may deem necessary

Durante M. Andrade Jr.
Acting City Engineer mn

Signature of Property Owner or Representative

INSPECTOR'S REPORT

INSPECTED BY: _____

DATE: _____

COMMENTS: _____

APPROVED

DISAPPROVED

SIGNATURE

SKETCH PLAN

RANDALL J. SANTOS
980 PECKMAN RD.
NEW BEDFORD, MA 02745

5-7515/110
13200165796

156

DATE 3/30/06

PAY TO THE
ORDER OF

CITY OF NEW BEDFORD

\$ 150.00

ONE HUNDRED FIFTY \$ and 00/100

DOLLARS



Security Features
Included.
Details on Back.



Sovereign Bank

sovereignbank.com

MEMO

SEWER TIE IN

[Signature]

MP

⑆0⑆1⑆075⑆50⑆ ⑆3200⑆65796⑆ 0⑆58

SHAYSTONE

Nº 5932

CITY OF NEW BEDFORD
ENGINEERING DEPARTMENT

3/30 2006

TO Randall Santos

for 1032 Sheffield St

sewer permit 23758
stub fee and assessment
to be paid by owner once it is
determined by City.

ACCOUNT 6001-439-44201-000

DEPOSIT \$ 150.00

The City Ordinances require that before this work is undertaken,
the estimated cost of the same must be deposited with the City Treasurer.

50' WIDE
PUBLIC - PAVED
SHEFFIELD STREET

REBAR W/CAP
SET

REFER. PLAT 132H
8,500 S.F. +/-

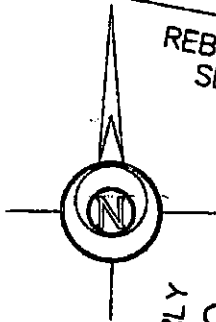

NOW OR FORMERLY
JOSE M. FERRO
&
ANA DEJESUS FERRO

REBAR W/CAP
SET

NOW OR FORMERLY
JOSE M. FERRO
&
ANA DEJESUS FERRO

WAYNE F. DUBOIS & JUDITH A. DUBOIS
AS-BUILT FOUNDATION PLAN
NEW BEDFORD, MA

50' WIDE
NOT CONSTRUCTED
OTIS STREET

SER. No. 33069 SIZE / DATE 6/30/2009

R.
JUN

REGISTER

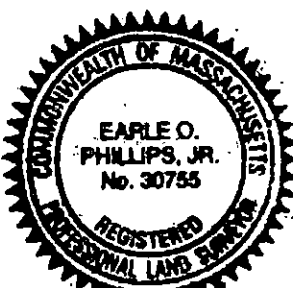

FOR INSPECTION ONLY A 24 HOUR
NOTICE IS REQUIRED AND THE
CONTRACTOR/APPLICANT IS
REQUIRED TO NOTIFY THE D.P.L.
@ 508 979-1550 Press 3 Repair
PERMIT EXPIRES 1 YEAR

WATER

P.132H/2.173

LOCATION SHEFFIELD ST WY OTIS ST

OWNER RANDALL J SANTOS

METER LOCATION INSIDE CELLAR WALL