



PERMIT NO.
23754

CITY OF NEW BEDFORD
SEWER AND/OR STORM DRAIN PERMIT

DATE 10/3/05

This certifies that permission is granted to

Fernando Debois 789 Mt. Pleasant St. NB 02745
Property Owner Address Tel.

To connect a sewer and/or storm drain located at sidewalk - install 70' of 12" pipe
modify catch basin
Assessor's Plot 123A Lot 3, to the sewer and/or storm drain in Mt. Pleasant St. Street

To be laid in accordance with the conditions in this application and the City of New Bedford ordinances.

TYPE OF USE: RESIDENTIAL ☒ COMMERCIAL INDUSTRIAL OTHER

If applicant other than actual property owner, attach Letter of Authorization from Property Owner.

Name..... Tel.....
Mailing Address.....

The Bonded Contractor/Drain Layer authorized to perform this work is:

Site Systems Corp. 102 Ratch St. PO Box 10773 NB
Name Address Tel.
Type of Pipe Required: SDR 35 PVC 508-991-4106

PERMIT EXPIRES ONE YEAR AFTER DATE OF ISSUE

- Requires separate connections for sewage and storm drain where applicable. Storm water cannot be discharged to a sanitary sewer.
 - All work must be inspected and approved by a D.P.I. inspector before backfilling.
 - If this connection is to be part of a private service shared jointly with other building owners, attach copy of Recorded Joint Maintenance Agreement.
 - Permits can be issued to Industrial and/or Commercial Applicants only upon receipt and approval by the Commissioner of Public Infrastructure of required plans and supplemental information.
 - In addition, a City-issued Industrial User Discharge Permit and/or a Sewer Extension/Connection Permit issued by the Commonwealth of Massachusetts D.E.P. shall be required by the City for Industrial Discharge into the sewer system.
- Industrial User Discharge Permit No..... Date.....

Comm. Mass. Sewer Conn./Ext. Permit No..... Date.....
A Filing and Inspection Fee of \$150.00 plus an Entrance Fee of \$..... where applicable, must accompany this application.

Bank# Slade's Ferry Check# 1437 Date 10/3/05 Receipt# 5444

Other requirements: 24 hr. inspection notice, work must be done in
accordance with attached plan

Connection made to Sewer Part of jointly-shared private line YES ☒ NO
Storm Drain

Applicant agrees to abide by the above terms, as well as all pertinent ordinances of the City of New Bedford, and such other special rules as the Commissioner of Public Infrastructure and/or City Engineer may deem necessary

Quante M. Andrade
Acting City Engineer

Fernando Debois
Signature of Property Owner or Representative

INSPECTOR'S REPORT

INSPECTED BY: Kevin J. Connel
DATE: 12-05-05
COMMENTS:

APPROVED DISAPPROVED

Kevin J. Connel
SIGNATURE

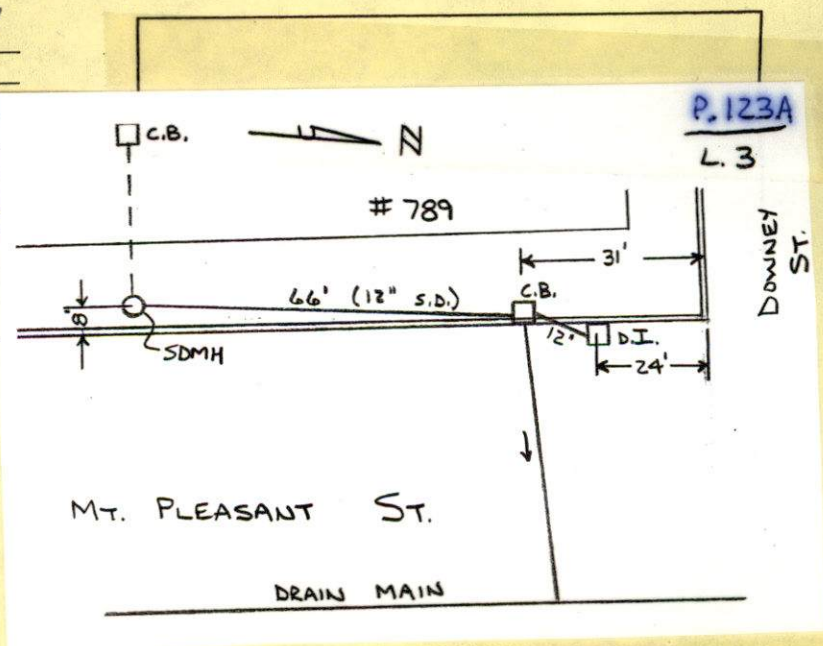

12-05-05

CLOUDY 30°

#789 PLEASANT ST-DRAIN WSP

PERMIT #23754

CONTRACTOR- REIS ASPHALT

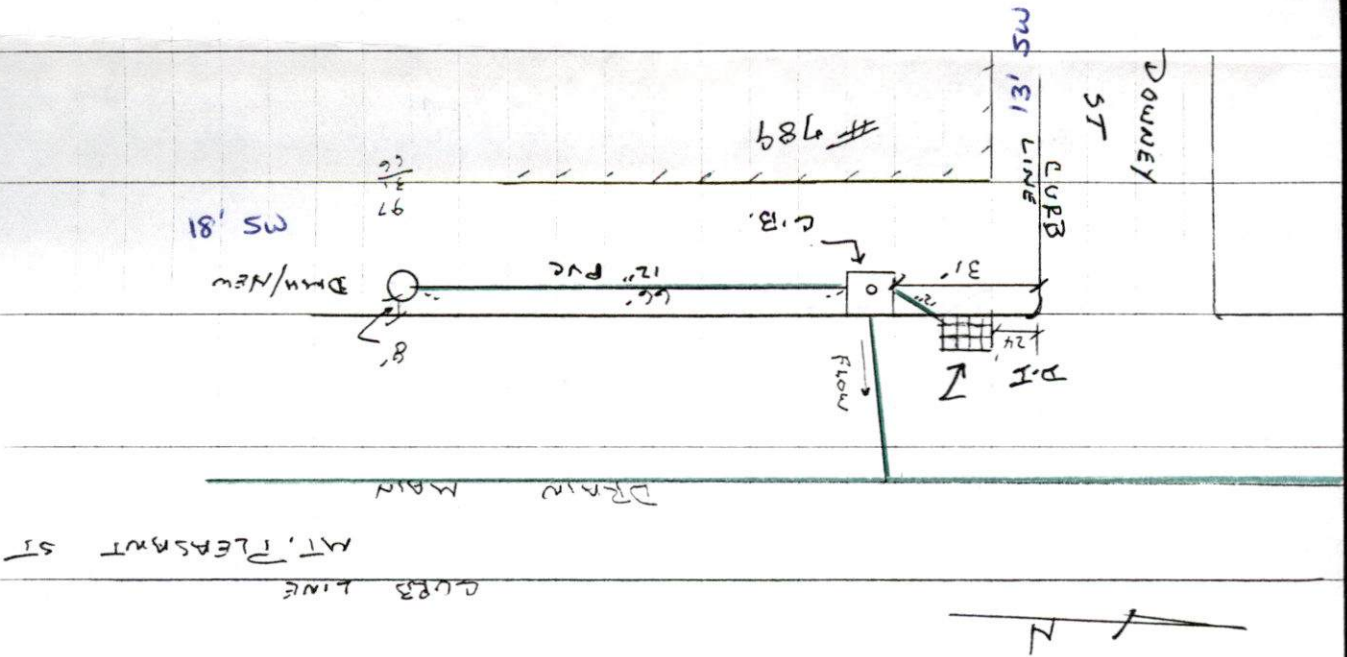



PERMIT NO.

23754

CITY OF NEW BEDFORD
SEWER AND/OR STORM DRAIN PERMIT

DATE 10/3/05

This certifies that permission is granted to

Fernanda Dubois 789 Mt. Pleasant St. NB. 02745
Property Owner Address Tel.

To connect a sewer and/or storm drain located at sidewalk - install 70' of 12" pipe
Assessor's Plot 123A Lot 3, to the sewer and/or storm drain in 789 Mt. Pleasant St. Street

To be laid in accordance with the conditions in this application and the City of New Bedford ordinances.

TYPE OF USE: RESIDENTIAL ☒ COMMERCIAL INDUSTRIAL OTHER

If applicant other than actual property owner, attach Letter of Authorization from Property Owner.

Name..... Tel.....

Mailing Address.....

The Bonded Contractor/Drain Layer authorized to perform this work is: Reis Asphalt

Site Systems Corp. 102 Rte 1 St. PO Box 10713 NB
Name Address Tel.

Type of Pipe Required: SDR 35 PVC 508-991-4106

PERMIT EXPIRES ONE YEAR AFTER DATE OF ISSUE

- Requires separate connections for sewage and storm drain where applicable. Storm water cannot be discharged to a sanitary sewer.
- All work must be inspected and approved by a D.P.I. inspector before backfilling.
- If this connection is to be part of a private service shared jointly with other building owners, attach copy of Recorded Joint Maintenance Agreement.
- Permits can be issued to Industrial and/or Commercial Applicants only upon receipt and approval by the Commissioner of Public Infrastructure of required plans and supplemental information.
- In addition, a City-issued Industrial User Discharge Permit and/or a Sewer Extension/Connection Permit issued by the Commonwealth of Massachusetts D.E.P. shall be required by the City for Industrial Discharge into the sewer system.

Industrial User Discharge Permit No..... Date.....

Comm. Mass. Sewer Conn./Ext. Permit No..... Date.....

A Filing and Inspection Fee of \$150.00 plus an Entrance Fee of \$..... where applicable, must accompany this application.

Bank# Slade's Ferry Check# 1437 Date 10/3/05 Receipt# 5444

Other requirements: 24 hr. inspection notice, work must be done in
accordance with attached plan

Connection made to Sewer Part of jointly-shared private line YES ☒ NO
Storm Drain

Applicant agrees to abide by the above terms, as well as all pertinent ordinances of the City of New Bedford, and such other special rules as the Commissioner of Public Infrastructure and/or City Engineer may deem necessary

Quante M. Andrade
Acting City Engineer

Fernanda Dubois
Signature of Property Owner or Representative

INSPECTOR'S REPORT

INSPECTED BY: _____
DATE: _____
COMMENTS: _____

APPROVED _____ DISAPPROVED _____

SIGNATURE

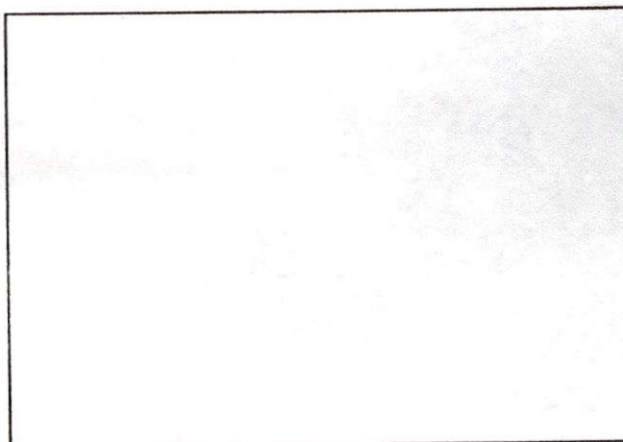

SKETCH PLAN